

Chaplin Crescent from Oriole Parkway to Avenue Road: Closed to Westbound Traffic

Watermain Construction on Chaplin Crescent

Expected Westbound Lane Closure Start Date: June 27, 2011.
Expected Westbound Lane Closure Completion Date: July 29, 2011.

Construction Details

The Construction Update sent to you on November 17, 2010, contained a schedule which showed that watermain construction on Chaplin Crescent would take place from October, 2010 to August, 2011. This work will now commence on June 27, 2011 with the installation of several vertical wells that will serve to lower the groundwater along this street. Once the groundwater is lowered, the next steps include:

- Excavate a proposed shaft No. 20 at Oriole Park (see map on reverse).
- Excavate a tunnel from the proposed shaft No. 20 at Oriole Park towards the proposed shaft No. 20A at Avenue Road.
- Excavate the proposed shaft No. 20A at Avenue Road.
- Deliver the steel watermain pipes to the site and lower them into the tunnel.
- Weld the pipes together inside the shafts and tunnel.
- Deliver concrete to the site and pump it into the tunnel to encase the steel pipes.
- Backfill shaft No. 20A at Avenue Road and restore the road with asphalt paving.

It is expected that all of the above work will be completed by February, 2012.

Chaplin Crescent Closed to Westbound Traffic – June 27, 2011 to July 29, 2011

Chaplin Crescent will be closed to westbound traffic between Oriole Parkway and Avenue Road for the installation of the dewatering system, commencing on June 27, 2011 and ending on July 29, 2011. Southbound traffic on Highbourne Road will not be able to turn right onto Chaplin Crescent. Advance traffic warning signs will be posted in the area to advise of these restrictions.

Access to driveways along Chaplin Crescent may be temporarily restricted during working hours and will be reinstated at the end of each working day. The Contractor will provide advance notice to property owners for coordination of driveway access.

TTC stops for westbound buses along Chaplin Crescent between Oriole Parkway and Avenue Road will be temporarily relocated and those buses will use Oxtown Avenue instead. Emergency response agencies and the City's office responsible for garbage and recycling collection will be advised of the road restriction.

Recycling and garbage collection will not be affected. Please follow your normal routine.

Parking

The City will be installing "NO PARKING" signs along Chaplin Crescent from Oriole Parkway to Avenue Road. To complete construction as quickly as possible, the City will arrange for a tow truck to remove any vehicles that are inadvertently parked on this portion of the street.

Work Hours

Work will generally be carried out between 7:00 a.m. to 7:00 p.m., Monday to Friday, but occasionally it will be necessary to carry out work in the evenings and on weekends. The City of Toronto Noise By-law (111-2003) will be complied with throughout the duration of this work.

Area Map

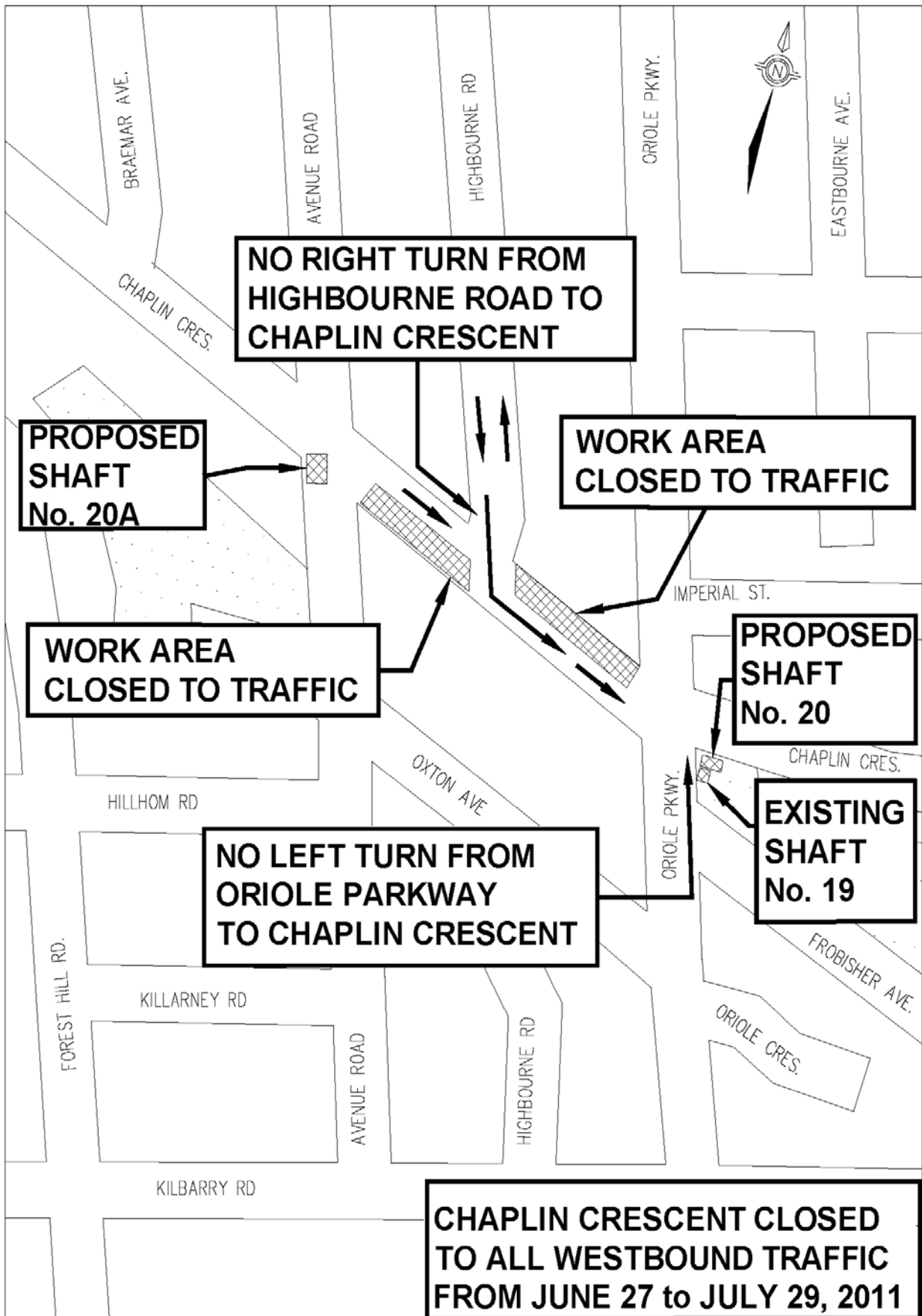

Need more information?

For more information about Watermain Construction on Avenue Road, visit our website at:
www.toronto.ca/involved/projects/avenue_watermain

We welcome your questions, comments and suggestions.

Jeff Flewelling
Project Manager

416-392-6628
jflewel@toronto.ca

Date issued: June 20, 2011.
Contract Number: 09FS-70WS