

**Activity (Project) Title:** Bathurst St. & Cpr Bridge north of Dupont

**Activity (Contract) Number**(e.g., T-10-97 or T-00-00-11): 08FS-02S

**Emergency Contact (24 Hours/Day, 7 Days/Week):**

Company: Grasca/Torbridge Carmen Giardino 416 464-2326

Phone Numbers(specify type): Gabriel 416 881-4205 ( Torbridge )

**Toronto Inspector:** Gary Boyd ( Aecom ) 416 881-5135 cell

Phone Numbers(specify type):

**Traffic Restriction:**

<b>Location</b>		<b>Diagram and/or Description</b>
Road	Bathurst St.	See Attached drawing.  Bathurst St. will be open SB and NB with one lane in each direction from the TTC Hillcrest Gate to Dupont. North of the Hillcrest Gate will be returned to normal traffic including the Davenport intersection. The intersection at Bridgeman will remain closed at Bathurst to east and west traffic.
From	Dupont to Davenport	
<b>Schedule Date</b>		
From: Wed. Aug 12/09	To: Nov.30/09	
<b>Restriction</b>		show total lanes, lanes closed & traffic directions <b>↑N</b>
<b>Time Period</b>	<b>Days Active</b>	
All day and night .	All Days	<b>Restriction Operation*</b>
<b>Daily Restriction Time (24 hour clock):</b>		Vehicle Lane: 1-NB & 1SB on west side
From:		Cross Street: Dupont
		Bicycle Lanes: N/A
		Sidewalks: West side open.

**Significance:**  High  Medium  Low

On Wed. Aug.12/09 with the use of pay duty police , Bathurst St. will be reconfigured to one NBL and one SBL all on the west side of the street north of Dupont and south of the Hillcrest Gate. This will remain in effect until Nov.30/09. All new signage will be in place prior to this switch.

**Submitted By:**

Name: Gary Boyd Phone: 416 881-5135

Company: AECOM Fax: 416 588-4099

Signature: Gary Boyd Date/Time: Aug. 07/09 2pm.

\* See Description List for Available Selection

**Fax to Central Dispatch 392-3749**

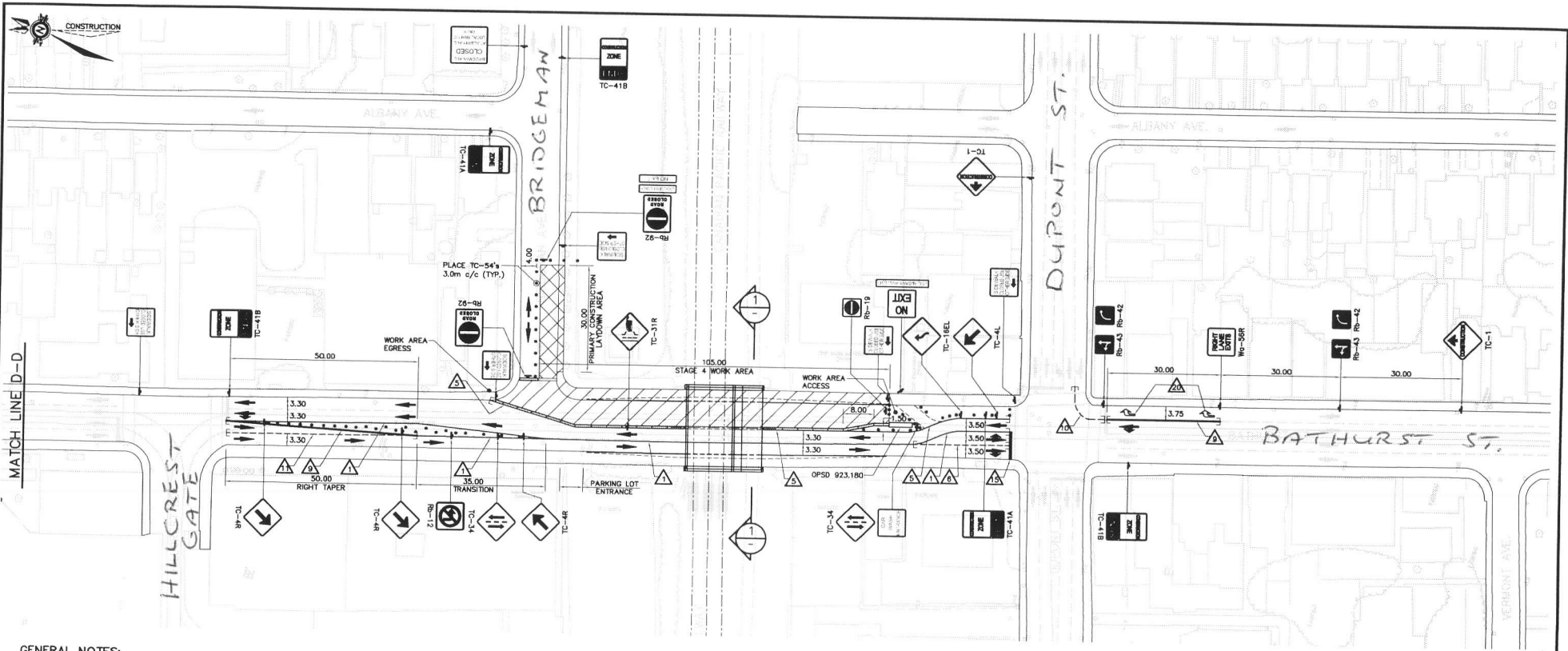

PLAN  
SCALE: 1:500

**GENERAL NOTES:**

1. THE CONTRACTOR IS TO OBLITERATE ALL EXISTING PAVEMENT MARKINGS AS REQUIRED TO STAGE TRAFFIC.
2. ALL TEMPORARY LANE CLOSURES TO BE IN ACCORDANCE WITH THE ONTARIO TRAFFIC MANUAL BOOK 7 - TEMPORARY CONDITIONS.
3. ALL TRAFFIC CONTROL BARRELS TO BE TC-54 (100cm) FLEXIBLE DRUMS SPACED AT 3.0m CENTRE TO CENTRE, UNLESS NOTED OTHERWISE.
4. TEMPORARY CONCRETE BARRIER SURROUNDING THE WORK AREA SHALL HAVE TEMPORARY CHAINLINK FENCE MOUNTED ATOP THE BARRIER AS PER OPSD 972.131. CHAINLINK FENCING SHALL CLOSE OFF WORK AREA AT BOTH ENDS IN ORDER TO ENSURE PROPER PROTECTION AND SECURITY.

**LEGEND:**

- TC-1 SIGNS TO BE PLACED AT CORRECT DISTANCE TO CONSTRUCTION ZONE ON ALL APPROACHES - TYPICAL
- WORKING AREA
- CONSTRUCTION LAYDOWN AREA
- TEMPORARY CONCRETE BARRIER MOUNTED WITH CHAINLINK FENCING (OPSD 972.131)
- TEMPORARY TRAFFIC CONTROL SIGN
- TC-54 TRAFFIC CONTROL BARRELS
- TRAFFIC FLOW
- TEMPORARY PAVEMENT SYMBOLS

PAVEMENT MARKINGS LEGEND	
1	SOLID YELLOW, 10cm
2	SOLID DOUBLE YELLOW, 10cm
3	363 BROKEN YELLOW, 10cm
4	SOLID YELLOW, 20cm
5	SOLID WHITE, 10cm
6	333 BROKEN WHITE, 10cm
7	363 BROKEN WHITE, 10cm
8	393 BROKEN WHITE, 10cm
9	SOLID WHITE, 20cm
10	111 BROKEN WHITE, 10cm
11	333 BROKEN WHITE, 20cm
12	333 BROKEN WHITE, 30cm
13	SOLID WHITE, 30cm
14	SOLID WHITE, 45cm
15	SOLID WHITE, 60cm
20	SYMBOLS
LIMITS OF MARKINGS	

**NOTES:**

1. 333, 363, 393, DENOTES PAVEMENT MARKING SPACING (E. 3m LINE, 3m GAP, 3m LINE)
2. DENOTES PAVEMENT MARKING (PAINT)
3. DENOTES PAVEMENT MARKING, TEMPORARY (PAINT)
4. DENOTES PAVEMENT MARKING, TEMPORARY REMOVABLE (TAPE)
5. DENOTES PAVEMENT MARKING, DURABLE (THERMO PLASTIC)
6. ALL MARKINGS MUST CONFORM TO M.U.T.C.D. SECTION C.

WEST

EAST

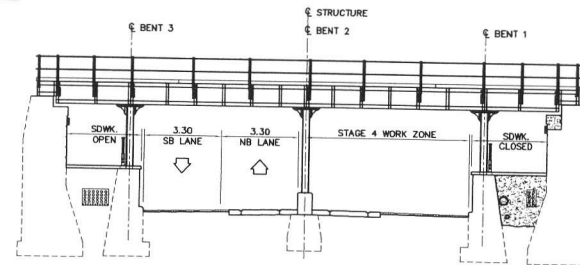

SECTION  
SCALE 1:100



METRIC  
ALL DIMENSIONS SHOWN HERE ARE IN METERS UNLESS OTHERWISE NOTED

TORONTO TRANSPORTATION SERVICES

UMA AECOM

No.	DATE	ISSUED FOR	REVISIONS	INITIAL	SIGNED
1	09/01/05	ISSUED FOR CONSTRUCTION			D.W.
0	09/05/06	ISSUED FOR TENDER			D.W.



TECHNICAL SERVICES  
Engineering Services - Works Facilities & Structures

JOHN MENDE, P. ENG.  
DIRECTOR, TRANSPORTATION  
INFRASTRUCTURE MANAGEMENT

TONY PAGNANELLI, P. ENG.  
DIRECTOR, ENGINEERING SERVICES  
WORKS FACILITIES AND STRUCTURES

STRUCTURES & EXPRESSWAYS

**BATHURST STREET**

SUBWAY AT CP NORTH TORONTO SUB. MILE 3.48  
BRIDGE REHABILITATION

TRAFFIC STAGING - STAGE IV

DESIGN:	K.L.	DRAFTING:	A.B.	CHECK:	D.W.	CONTRACT No.:	065-025
SCALE:	AS SHOWN		DRAWING NUMBER:	065-TS3841-7			
DATE:	APRIL 2008				SHEET No. 53		