

Gerrard Street East Streetcar Track Replacement 2006

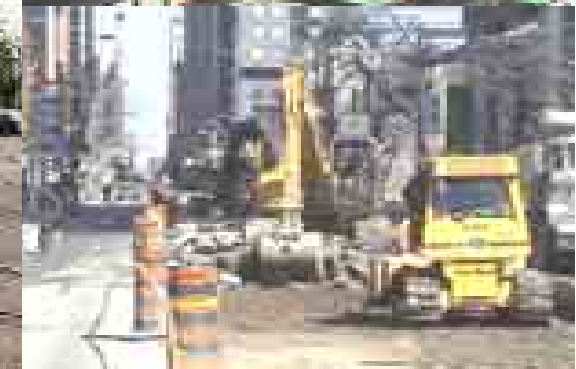
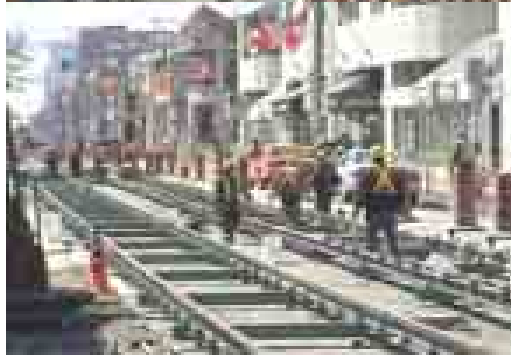

Project Summary

- Gerrard Street East from Coxwell Avenue to Enderby Road.
- Track reconstruction, overhead wire replacement, and some roadway resurfacing and sidewalk repairs.
- Time Line for all work (including preparatory rail welding)
Schedule: March 27 to Early June 2006

Presentation Overview

- Stages of Construction
- Transit Service during construction
- Traffic Management Plan
- Communications - Staying Informed
- Question & Answer Session

Construction Staging

- Stage 1: Rail Welding and Storage
- Stage 2: Excavation - Old Track
- Stage 3: Installation - New Track
- Stage 4: Road Resurfacing and sidewalk repairs
- Stage 5: Resumption of streetcars

Stage 1: Rail Welding/Storage

- Location: On Gerrard Street East from (30 metres) east of Main Street to Malvern Avenue:
Scheduled for: March 27 to April 3.
- Welding work and rail storage is conducted within the 2 centre lanes.
- The rail remains stored in a pile at this location. The pile depletes as the replacement of rail along Gerrard Street progresses.

Stage 1: Rail Welding/Storage

- Welding station set-up
- Standard lengths of rail (39 ft) are welded into strings 300 ft long



Impact During Rail Welding

- **Traffic and parking restrictions**
 - One lane of traffic in each direction.
 - No left turns or through traffic at physical limits.
 - No parking
- **Work Hours/Noise**
 - 7 a.m. to 7 p.m.
- **TTC service:**
 - No impact on the 135 Gerrard bus route.

Impact Of Rail Storage

- **Rail storage and traffic and parking restrictions:**
 - The strings of rail will remain stored in a pile on Gerrard Street, east of Main Street.
 - Restrictions remain in place at physical limits of the rail pile.
- **TTC service:**
 - No impact on the 135 Gerrard bus route.
- **Rail Installation; night work:**
 - The new rail is dragged/pulled from storage pile for installation. This is conducted after the Contractor has completed its shift.
 - Efforts made to minimize the noise past the hour of 11p.m.

Rail Dragged/Pulled

- Rail is dragged or pulled from rail pile for installation when new concrete base is poured and when contractor has completed shift.
- This activity may continue into the early morning hours.



Stage 2: Track Excavation

- **Scheduled start date:**
 - April 3
- **Starting locations for excavation**
 - Location 1: Gerrard Street East @ Coxwell, eastward
 - Location 2: Gerrard Street East @ Woodbine eastward

Track Work Impact

- **Traffic Restrictions**

- No eastbound traffic in active work zones
- No parking in and beyond active work zones

- **Work Hours/Noise**

- Excavation: generally 7 a.m. to 7 p.m., with exception at Woodbine intersection – 24 hrs/day operation.
- Track work is carried out over 3 shifts: day, afternoon and nights.

Stage 2: Track Excavation

- Concrete breaker is followed closely by backhoe during excavation



Stage 2: Track Excavation

- One traffic lane remains open during excavation.
- Construction vehicles and materials occupy the other lane.



Limiting Impact of Construction

- Weld rails into 300 foot lengths in advance of the project
- Excavation is coordinated with track installation to maintain a steady progress of work.
- Signalized intersections will be completed within a 72 hour period, with partial road closures in order to reduce traffic disruption.
- **The Woodbine Ave. and Gerrard Street intersection will have a partial closure over a weekend, Friday to Monday with work activity around-the-clock.**

Features of the New Tracks

- Technology increases life cycle of rails to 25 yrs. and reduces the need for regular track maintenance.
- Continuously welded rail eliminates the use of rail joints, providing a smooth operation.
- Rubber sleeve isolates rail from concrete and helps reduce noise and vibration.

Stage 3: New Track Installation

- Compaction of infill soil to prepare for base concrete



Stage 3: New Track Installation

- Concrete base is poured to prepare for new track installation



Stage 3: New Track Installation

- Long rail strings are positioned on steel ties.
- Followed by welding and grinding the long rail strings together.



Stage 3: New Track Installation

- Installing synthetic rubber sleeve and suspended rail fasteners



Stage 3: New Track Installation

- Adjusting and setting the line and elevation of the rail



Stage 3: New Track Installation

- After track is installed to specific requirements, track is ready for second concrete infill pour



Stage 3: New Track Installation

- The second concrete infill pour .
- The final (top) concrete pour will be the roadway surface.



Stage 3: New Track Installation

- The final (top) concrete pour.



Transit Service Changes

- Phase 1: No service changes during Rail Welding/Storage
- Phase 2: Service changes during Construction - Effective Monday, April 3.
- Subsequent service changes occur as construction progresses eastward, i.e. 92 Woodbine South bus.

Existing TTC Service



Rail Welding/Storage



Service Diversion For Duration of Work

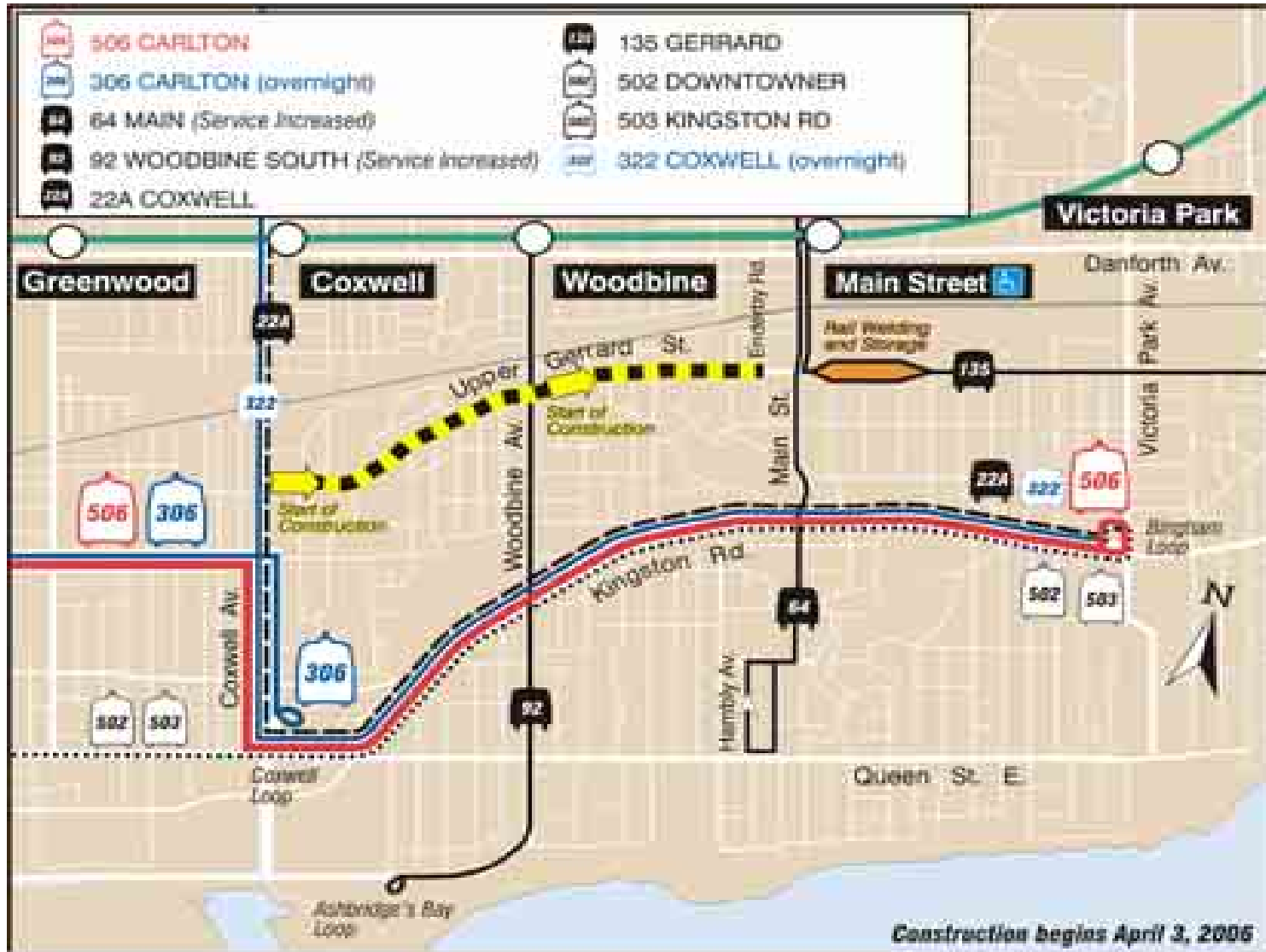

Service Diversion - Woodbine/Gerrard Intersection Work

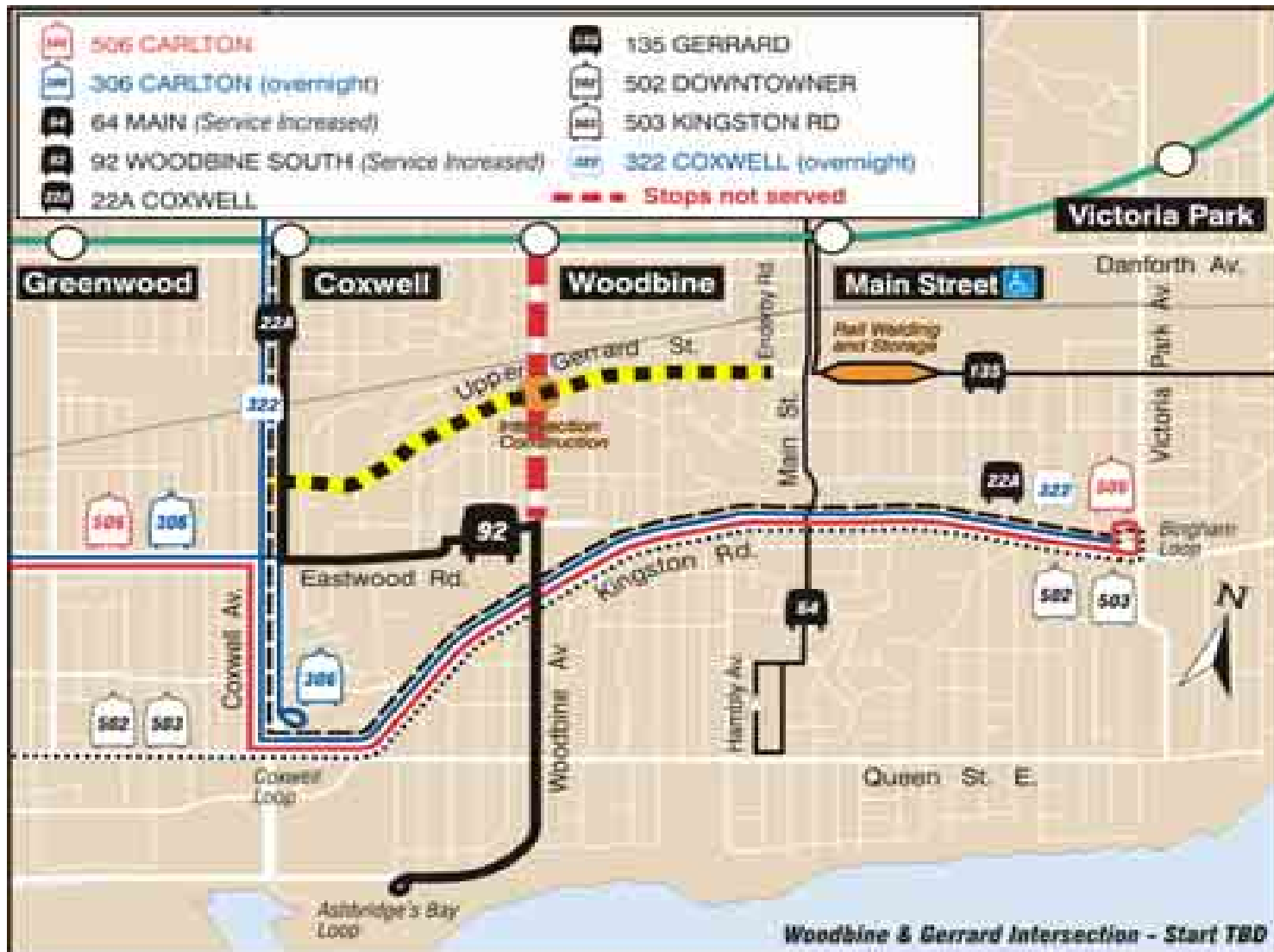

Traffic Management Plan

- Road restrictions
- Convert one-way streets to temporary two-way
- Emergency vehicle access
- Parking displacement
- Construction/traffic signage

Traffic Map

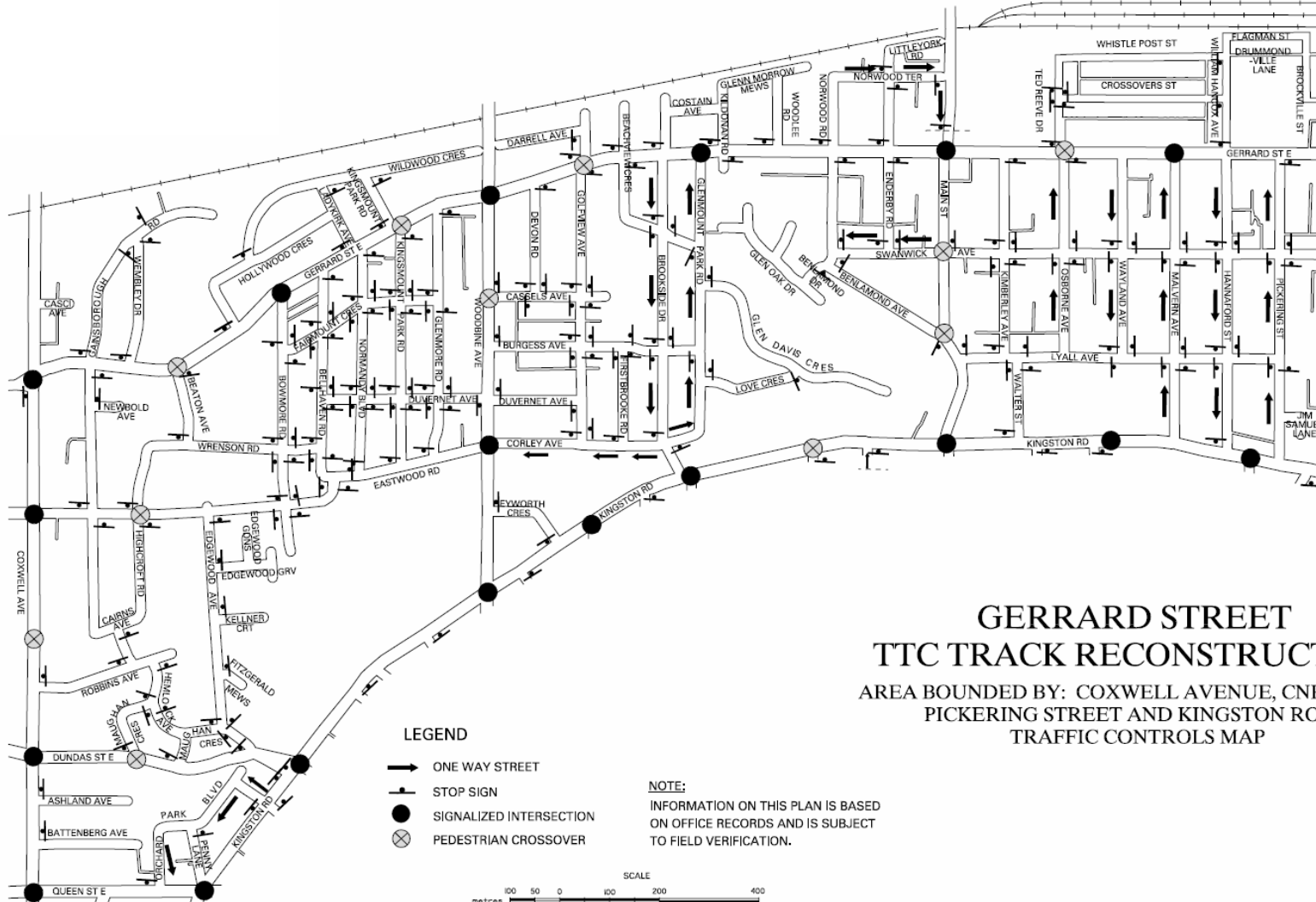

Traffic Impact

- Road restrictions – One (1) westbound lane will be maintained throughout construction. Closure of eastbound lane on Gerrard Street.
- Access - Maintained to properties on north side of Gerrard St.
Properties on south side of Gerrard that are blocked by work zone will have access to temporary parking permits.
Access will be disrupted for no more than three (3) weeks.
Emergency for medical reasons – coordinate with on-site City inspector.
- Parking - Maintained on all side streets.
- Deliveries - Deliveries in work zone need to be made from side streets or coordinated with City inspector.
- Increased traffic volumes on north-south streets

Limiting Traffic Impact

- Eastbound local traffic will be re-opened in segments as work proceeds.
- Where possible, local traffic will remain open in BOTH directions outside of active work zones.
- Conversion of one-way streets to temporary two-way:
Brookside Drive, south of Gerrard Street
Glenmount Park Road, south of Gerrard Street

Traffic Management

Closure Staging for Eastbound Traffic

- At Coxwell Avenue and at Woodbine Avenue on Gerrard Street, eastbound traffic will be directed north to Danforth Avenue or south to Kingston Road.

Traffic Management

Conversion of one-way streets to temporary two-way

- Brookside Drive, between Gerrard St and Beachview Cres
Glenmount Park Drive, between Gerrard St and Beachview Cres
- Conversion will occur one to three days before excavation approaches street.
- Existing parking will remain on these streets.
- The project team has worked closely with Toronto Fire, Police and EMS to ensure safe service for the community.

Traffic Management Parking Displacement

- All existing parking on side streets will be maintained.
- Displaced parking during construction:
Gerrard Street, south side, within work zones
- Properties on south side of Gerrard that are blocked by work zone will have access to temporary parking permits.

Traffic Management

- Increased traffic volumes on north-south streets that intersect Kingston Road at traffic signals.
- City staff will monitor traffic volumes at the signalized intersections to identify possible traffic signal timing changes to help improve traffic flow, if required.
- Traffic operations on Kingston Road and implement alterations to parking restrictions, if required.

Stage 4 - Road Resurfacing/Sidewalk Work

- What to expect
- Timeframe
- One lane of traffic will be maintained in each direction.
- Enbridge Gas main replacement commences June 2006.

Stage 5 - Resumption of streetcars

- Scheduled for early June 2006 or when all roadway resurfacing completed.



Communication Mediums

- City of Toronto website: www.toronto.ca/involved
- 24-Hour Comment Line: **416-397-7777**
- Direct contact: Josie Giordano **416-338-2859**
- City Construction Inspector on-site

Communication Mediums

For TTC Service and Schedule Information:

- TTC website: **www.ttc.ca**
- TTC Information Line: **416-393-4636 (INFO)**
- Project related matters: D. Sinagoga **416-393-2197**
- TTY: **416-481-2523**

Communication Mediums

- Construction Notices by mail, email, and handouts
- Transit notices - handed out on TTC vehicles, posted on transit stops and at subway stations
- Project particulars posted on website
- Transit ads in Metro Today newspaper
- Transit Reporter - periodic T.V. and radio announcements
- Information provided to local community newspapers