

Authority: North York Community Council Item NY9.1,  
as adopted by City of Toronto Council on October 29 and  
30, 2019

**CITY OF TORONTO**

**Bill 486**

**BY-LAW -2020**

**To adopt Amendment 468 to the Official Plan for the City of Toronto respecting the certain lands on the north side of Eglinton Avenue West between Croham Road And Sanderstead Avenue.**

Whereas authority is given to Council under the Planning Act, R.S.O. 1990, c.P. 13, as amended, to pass this By-law; and

Whereas Council of the City of Toronto has provided adequate information to the public and has held at least one public meeting in accordance with the Planning Act;

The Council of the City of Toronto enacts:

1. The attached Amendment 468 to the Official Plan is hereby adopted pursuant to the Planning Act, as amended.

Enacted and passed on June , 2020.

Frances Nunziata,  
Speaker

Ulli S. Watkiss,  
City Clerk

(Seal of the City)

**AMENDMENT 468 TO THE OFFICIAL PLAN**

**CERTAIN LANDS ON THE NORTH SIDE OF EGLINTON AVENUE WEST  
BETWEEN CROHAM ROAD AND SANDERSTEAD AVENUE**

The Official Plan of the City of Toronto is amended as follows:

1. Chapter 7, Site and Area Specific Policies, Site and Area Specific Policy No. 474 is amended with respect to the certain lands on the north side of Eglinton Avenue West between Croham Road and Sanderstead Avenue by deleting sub-policy (a) (i) and replacing it with the following:

“(a) (i) a public lane and/or a publicly accessible private lane.”

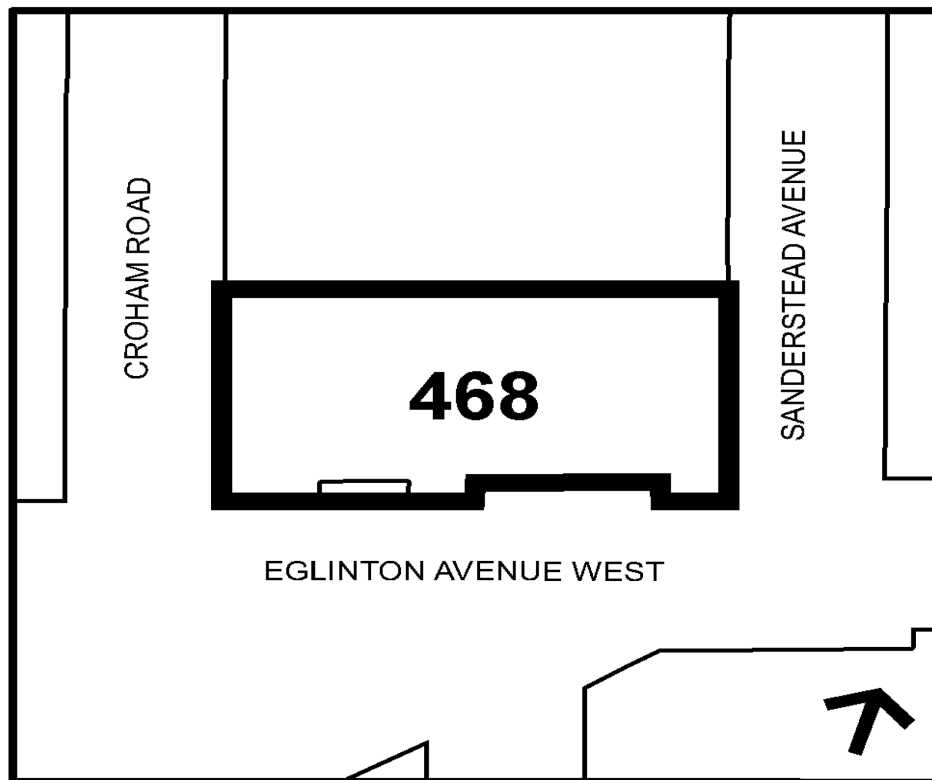

2. Chapter 7, Site and Area Specific Policies, Site and Area Specific Policy 476 is amended with respect to the certain lands on the north side of Eglinton Avenue West between Croham Road and Sanderstead Avenue by replacing on Plan 2 the “New Public Lane” requirement for the lands between Croham Avenue and Sanderstead Avenue with a “New Publicly Accessible Private Lane” requirement for the lands between Croham Avenue and Sanderstead Avenue as follows:

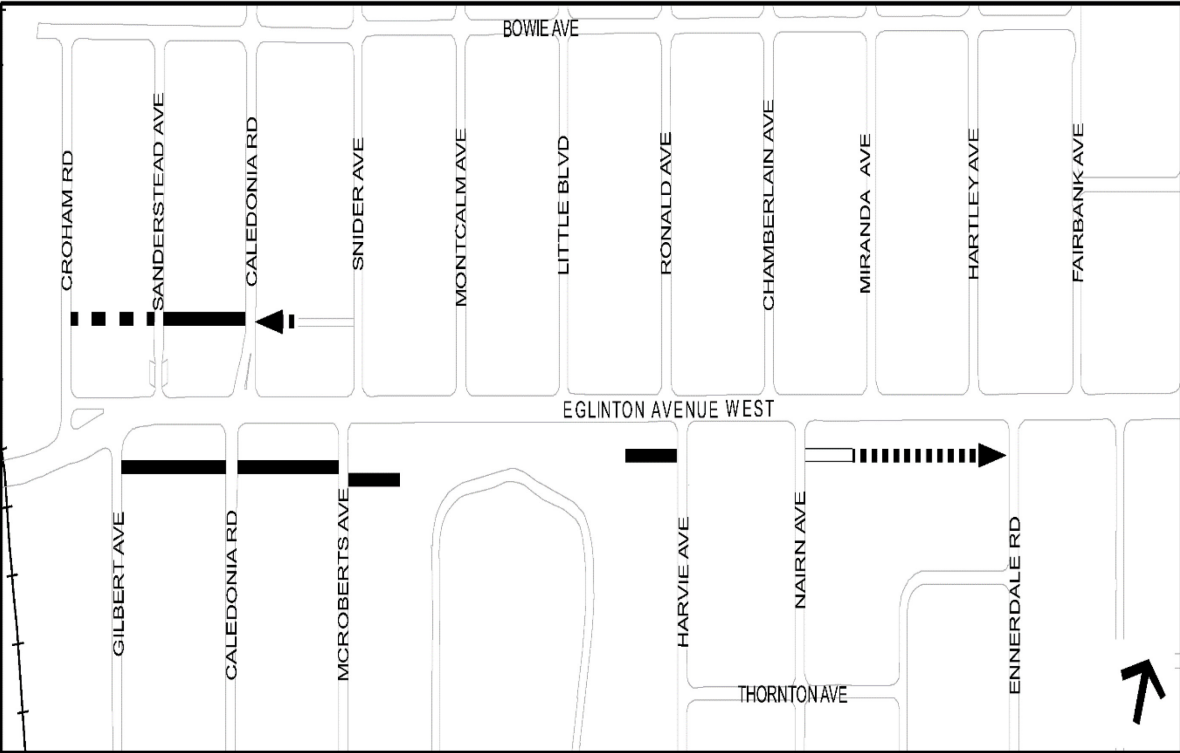

Plan 2

- ▶ Extension of Existing Public Lane
- New Public Lane
- ■ ■ New Publicly Accessible Private Lane