

Authority: Toronto Community Council Report No. 7, Clause No. 54,  
as adopted by City of Toronto Council on May 11 and 12, 1999  
Enacted by Council: May 12, 1999

**CITY OF TORONTO**

**BY-LAW No. 282-1999**

**To designate the property at 337 Jarvis Street (Samuel Platt House)  
as being of architectural and historical value or interest.**

WHEREAS authority was granted by Council to designate the property at No. 337 Jarvis Street as being of architectural and historical value or interest; and

WHEREAS the *Ontario Heritage Act* authorizes the Council of a municipality to enact by-laws to designate real property, including all the buildings and structures thereon, to be of historical or architectural value or interest; and

WHEREAS the Council of the City of Toronto has caused to be served upon the owners of the land and premises known as No. 337 Jarvis Street and upon the Ontario Heritage Foundation, Notice of Intention to designate the property and has caused the Notice of Intention to be published in a newspaper having a general circulation in the municipality as required by the *Ontario Heritage Act*; and

WHEREAS the reasons for designation are set out in Schedule "B" to this by-law; and

WHEREAS no notice of objection to the proposed designation was served upon the Clerk of the municipality;

The Council of the City of Toronto HEREBY ENACTS as follows:

1. The property at No. 337 Jarvis Street, more particularly described and shown on Schedule "A" to this by-law, is designated as being of architectural and historical value or interest.
2. The City Solicitor is authorized to cause a copy of this by-law to be registered against the property described in Schedules "A" and "C" to this by-law in the proper Land Registry Office.
3. The City Clerk is authorized to cause a copy of this by-law to be served upon the owners of the property at No. 337 Jarvis Street and upon the Ontario Heritage Foundation and to cause notice of this by-law to be published in a newspaper having general circulation in the City of Toronto as required by the *Ontario Heritage Act*.

ENACTED AND PASSED this 12th day of May, A.D. 1999.

CASE OOTES,  
Deputy Mayor

NOVINA WONG,  
City Clerk

(Corporate Seal)

**SCHEDULE “A” TO BY-LAW No. 282-1999**

In the City of Toronto and Province of Ontario, being composed of part of Park Lot 6 in Concession 1 from the Bay, in the Geographic Township of York, designated as PART 1 on Plan 64R-14680 deposited in the Land Registry Office for the Metropolitan Toronto Registry Division (No. 64).

The easterly limit of Jarvis Street as confirmed under the Boundaries Act by Plan BA-1893 (CT488073).

The hereinbefore described lands being delineated by heavy outline on Plan SYE2922 dated April 23, 1999, as set out in Schedule “C”.

**SCHEDULE "B" TO BY-LAW No. 282-1999**

Heritage Property Report

Samuel Platt House  
337 Jarvis Street

October 1996

Table of Contents:

Basic Building Data

Historical Background

Architectural Description

Context

Summary

Sources Consulted

Attachments:

I Short Statement of Reasons for Designation

II Location Map

III Photographs

-----

Heritage Property Report

Basic Building Data:

Address: 337 Jarvis Street (east side of Jarvis Street, north of Gerrard Street East)

Ward: 6

Current Name: Toronto Baptist Seminary

Historical Name: Samuel Platt House

Construction Date: 1849-1850

Architect: none found

Contractor/Builder: none found

Additions/

Alterations: porch and one-storey wing added; window sash altered

Original Owner: Samuel Platt

Original Use: residential

Current Use\*: educational

Heritage Category: Neighbourhood Heritage Property (Category C)

Recording Date: October 1996

Recorder: HPD:KA

\*this does not refer to permitted use(s) as defined in the Zoning By-law

### Historical Background:

When Toronto was founded as the Town of York in 1793, the area north of Queen Street was divided into a series of park lots which were distributed to government officials. William Jarvis, the first Provincial Secretary for Upper Canada, received a lot directly north of the townsite where his heirs developed a country estate called “Hazelburn”. In 1845, architect John Howard was engaged to divide Jarvis's lot into a residential subdivision entered via a tree-lined avenue named Jarvis Street. While the upper reaches of the street attracted the leading Toronto families of the period, the area to the south was developed by successful, but less prominent residents.

In 1849, Samuel Platt acquired a vacant site on the east side of Jarvis Street, one lot north of Gerrard Street East. Born in Northern Ireland in 1812, Platt immigrated to Canada in 1827. After working as a clerk at Enoch Turner's brewery for four years, Platt erected a distillery at Berkeley and Front Streets. Platt served as a councillor for St. Lawrence Ward from 1845 to 1851, followed by a two-year stint as an alderman for St. David's Ward in 1853 and 1854. In 1872, Platt was one of four citizens appointed to the Water Commission, which supervised the construction of the City's waterworks before disbanding in 1877. As a Conservative candidate, Platt was elected to represent the federal riding of East Toronto in 1873 and 1878. During the 1870s, Platt also served as a director of the Consumer' Gas Company. James Austin, president of the gas company, was Platt's neighbour on Jarvis Street (south of Gerrard) prior to constructing a new house, “Spadina”, on the Davenport Hill.

The Platt House was completed in 1850 and occupied by Samuel Platt until his death in 1886. His widow, Elizabeth Lockett Platt, resided there until 1916 when the property was acquired by Frank D. Read, a clerk for the Canadian National Railway. The Toronto Baptist Seminary began its continuing occupancy of the site in 1927. The Samuel Platt House is significant as one of the oldest remaining buildings on Jarvis Street.

### Architectural Description:

The Samuel Platt House displays features identified with the Neoclassical style, which was prominent in Ontario residential architecture during the mid 19th century. Incorporating forms based on Antiquity, the style was inspired by the archaeological finds in 18th century Italy and the adaptation of Roman motifs in the architectural pattern books of English architect Robert Adam.

The Samuel Platt House rises two stories above a stone foundation with a brick base course. Constructed of brick and trimmed with stone, the building is covered by a low-pitched truncated hip roof with extended eaves and four end chimneys. The principal (west) facade is symmetrically organized with three bays. In the lower storey, the central entrance features a flat-headed opening with a flat multi-paned transom and three-quarter-length sidelights. The Classical porch, with a gable roof, columns and a name band, is a later addition. On either side of the entrance, a single three-part flat-headed window opening has a sliding sash window, lintel and corbelled sill. The windows and doors are decorated with banded Classical pilasters. In the upper floor, three windows are set in segmental-headed openings with moulded enframements and a continuous sill.

The side walls (north and south) have segmental-headed window openings. On the rear (east) wall, a large semi-circular window opening is centred above a ground-level entrance with a transom and sidelights. The other window openings are flat-headed. A two-storey addition is attached to the northeast corner of the building (this addition is not included in the Reasons for Designation).

Important interior features are the cornice mouldings in the centre hall and two principal rooms (north and south) on the first floor.

Context:

The Samuel Platt House is located on the east side of Jarvis Street, directly north of Gerrard Street East. On the south, Jarvis Street Baptist Church (1874-1875) occupies the northeast corner of Jarvis and Gerrard Streets. To the east, Allan Gardens fills most of the block bounded by Jarvis, Gerrard, Sherbourne and Carlton Streets. North of the Samuel Platt House and beyond the park, St. Andrew's Presbyterian Church (1878) stands at the southeast corner of Jarvis and Carlton Streets. All of the above-noted properties are listed on the City of Toronto Inventory of Heritage Properties.

On the opposite (west) side of Jarvis Street, between Gerrard and Carlton Streets, the semi-detached house form buildings at No. 280 (1891), No. 288-290 (1890) and No. 314 (1865) and the Frontenac Arms Hotel (1930) at No. 300 are also included on the Inventory of Heritage Properties.

Summary:

The property at 337 Jarvis Street is identified for architectural and historical reasons. Completed in 1850 for Samuel Platt, a brewer and politician, the former residence is one of the earliest surviving buildings on Jarvis Street. Located on the east side of Jarvis Street, north of Gerrard Street East, the Samuel Platt House is distinguished by its Neoclassical design.

Sources Consulted:

Assessment Rolls, City of Toronto. 1849 ff.

City of Toronto Directories. 1850-1851 ff.

*Goad's Fire Insurance Atlas*. 1894.

*History of Toronto and the County of York*. Vol. II. C. Blakett Robinson, 1885.

MacRae, Marion, and Anthony Adamson. *The Ancestral Roof. Domestic Architecture of Upper Canada*. Clarke Irwin, 1963.

McHugh, Patricia. *Toronto Architecture. A City Guide*. 2nd ed. McClelland and Stewart, 1989.

Middleton, J. E. *The Municipality of Toronto*. Vol. II. Dominion Publishing Company, 1923.

Thompson, Austin Seton. *Jarvis Street*. Personal Library Publishers, 1980.

Kathryn Anderson/October 1996

-----

## Attachment I

### Short Statement of Reasons for Designation

#### Samuel Platt House

337 Jarvis Street

The property at 337 Jarvis Street is designated for architectural and historical reasons. The house was constructed in 1849-1850 for Samuel Platt, a brewer and politician whose family retained the property until 1916. The Toronto Baptist Seminary has occupied the site since 1927.

The Samuel Platt House is a surviving example of the Neoclassical style. Rising two stories beneath a truncated hip roof with extended eaves and four end chimneys, the house is constructed of brick with stone detailing. Important exterior elements are the segmental-headed window openings on all walls, the entrances with transoms and sidelights on the principal (west) and rear (east) facades and, on the west wall, the tripartite window openings and Classical detailing of the window enframements and pilasters. Important interior features are the cornice mouldings in the centre hall and two principal rooms on the first floor.

Located on the east side of Jarvis Street, north of Gerrard Street East, the Samuel Platt House is one of the earliest surviving buildings on Jarvis Street. Its age and Classical appearance reflect the early development of the street as Toronto's most fashionable mid-19th century neighbourhood.

**SCHEDULE "C" TO BY-LAW No. 282-1999**

SCHEDULE "C"

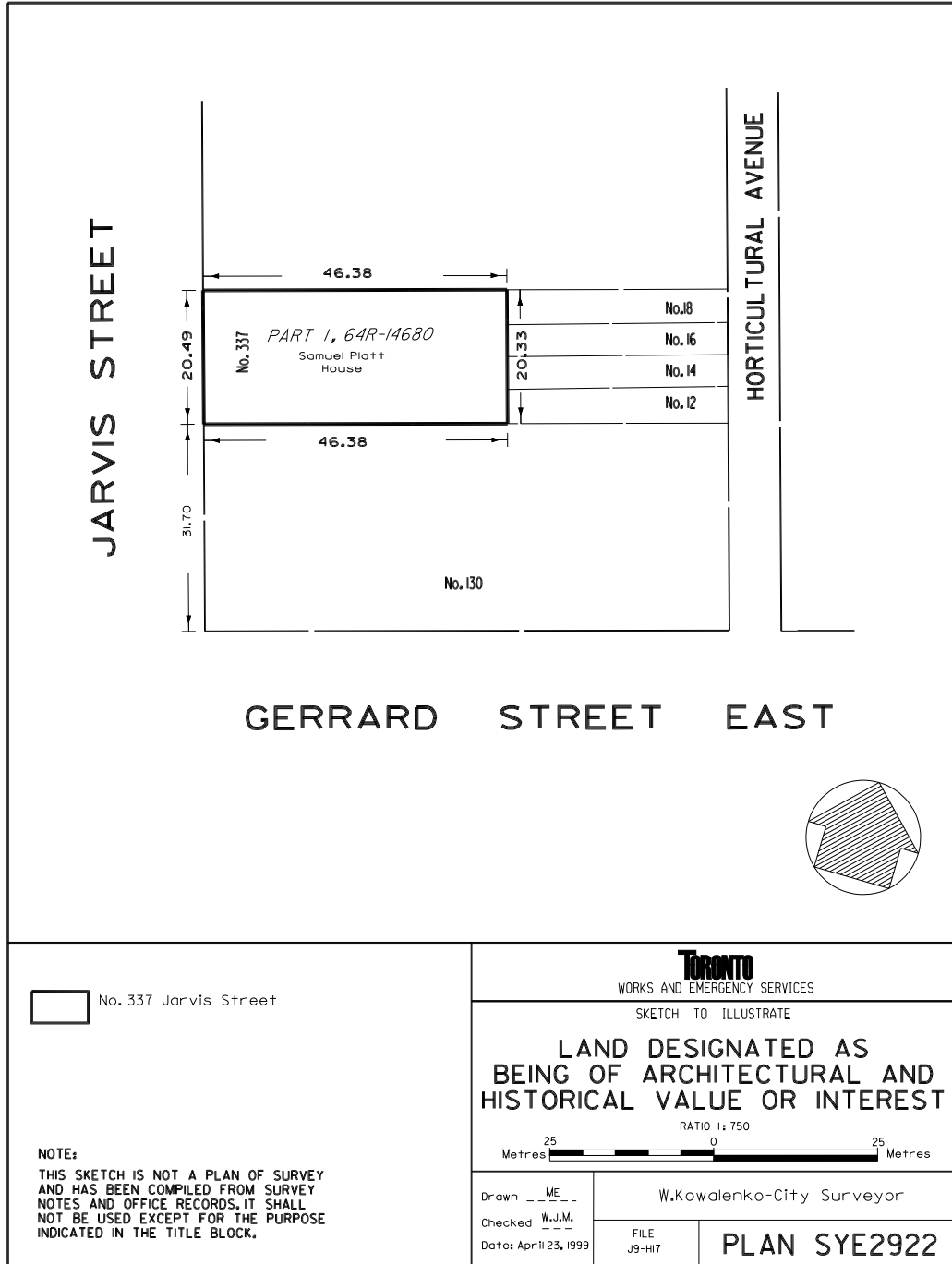

No. 337 Jarvis Street

**NOTE:**  
THIS SKETCH IS NOT A PLAN OF SURVEY AND HAS BEEN COMPILED FROM SURVEY NOTES AND OFFICE RECORDS, IT SHALL NOT BE USED EXCEPT FOR THE PURPOSE INDICATED IN THE TITLE BLOCK.

**Toronto**  
WORKS AND EMERGENCY SERVICES

SKETCH TO ILLUSTRATE

**LAND DESIGNATED AS  
BEING OF ARCHITECTURAL AND  
HISTORICAL VALUE OR INTEREST**

RATIO 1: 750  
Metres Metres

Drawn ME  
Checked W.J.M.  
Date: Apr 11 23, 1999

W.Kowalenko-City Surveyor

FILE  
J9-H17

**PLAN SYE2922**

SYE2922