

Authority: Toronto Community Council Report No. 9, Clause No. 5,
as adopted by City of Toronto Council on July 6, 7, and 8, 1999
Enacted by Council: July 8, 1999

CITY OF TORONTO

BY-LAW No. 404-1999

**To amend Zoning By-law No. 438-86, as amended, respecting lands within the
Nordheimer Ravine.**

The Council of the City of Toronto HEREBY ENACTS as follows:

1. Section 12(2) of Zoning By-law No. 438-86, being “A By-law To regulate the use of land and the erection, use, bulk, height, spacing of and other matters relating to buildings and structures and to prohibit certain uses of lands and the erection and use of certain buildings and structures in various areas of the City of Toronto”, as amended, is further amended by adding the following exception:

323. No person shall, on a *lot* that abuts or is located wholly or partially within the Ravine Impact Area of the Nordheimer Ravine, as shown outlined by heavy lines on the maps at the end of this exception, use or erect a building, structure or addition for any purpose, other than those required for flood and/or erosion protection or those related to federal, provincial or municipal infrastructure, unless the building, structure or addition is set back not less than 10.0 metres from the Ravine Impact Area, provided that;

- (i) any building or structure existing within the Ravine Impact Area on July 6, 1999, may be replaced, provided that the replacement building or structure does not have any greater gross floor area or *height* and is in the same position relative to the *lot* lines as the building or structure it replaces; and
- (ii) an addition may be made to a building or structure existing on July 6, 1999 that is not set back 10.0 metres from the Ravine Impact Area, provided it is no closer to the Ravine Impact Area than any existing wall of the existing building or structure.

ENACTED AND PASSED this 8th day of July, A.D. 1999.

CASE OOTES,
Deputy Mayor

NOVINA WONG,
City Clerk

(Corporate Seal)

MAP 1 of 3

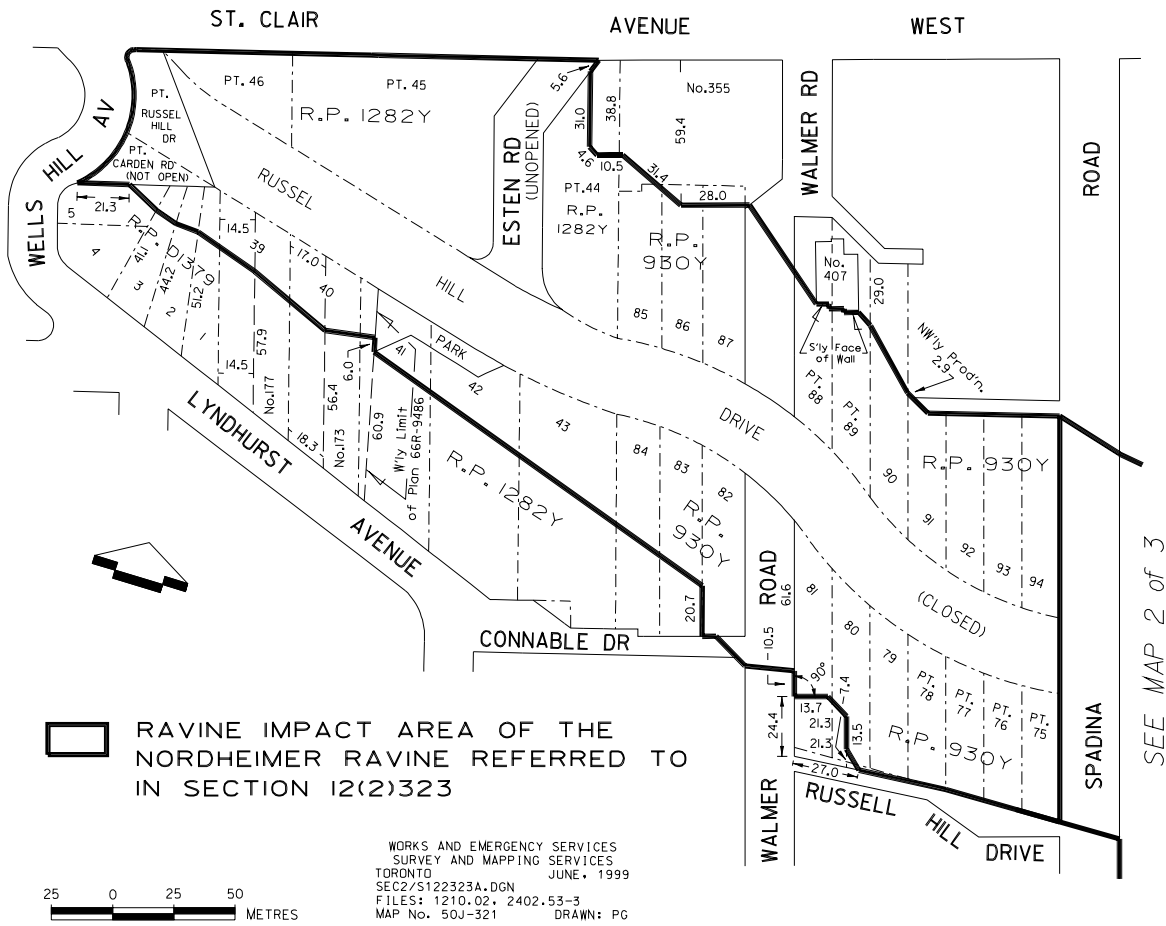

RAVINE IMPACT AREA OF THE NORDHEIMER RAVINE REFERRED TO IN SECTION 12(2)323



WORKS AND EMERGENCY SERVICES
 SURVEY AND MAPPING SERVICES
 TORONTO JUNE, 1999
 SEC2/S122323A-DGN
 FILES: 1210.02 - 2402.53-3
 MAP No. 50J-321 DRAWN: PG

SEE MAP 2 of 3

MAP 3 of 3

