

Authority: Toronto Community Council Report No. 6, Clause No. 5,
as adopted by City of Toronto Council on April 11, 12 and 13, 2000
Enacted by Council: April 13, 2000

CITY OF TORONTO

BY-LAW No. 207-2000

**To amend the General Zoning By-law No. 438-86
of the former City of Toronto with respect to lands known as Nos. 1, 3,
and 5, Elmsley Place and No. 70 and part of No. 50 St. Joseph Street.**

The Council of the City of Toronto HEREBY ENACTS as follows:

1. Section 12(2)310(a) of By-Law No. 438-86, being “A by-law to regulate the use of land and the erection, use, bulk, height, spacing of and other matters relating to buildings and structures and to prohibit certain uses of lands and the erection and use of certain buildings and structures in various areas of the City of Toronto”, as amended, is further amended by:

- (1) deleting Map 30 and substituting the attached Map 31;
- (2) adding the attached Map 30;
- (3) deleting from paragraph (a) the number “ 29” and substituting the number “30”;
- (4) deleting from paragraph 1(a) and (1)(d)(i) the number “29” and substituting the number “30”;
- (5) deleting from paragraph (2) (a) the number “30” and substituting the number “31”; and
- (6) adding a new paragraph (d), as follows:

“(d) Lands defined by Map 30

A university residence is permitted on the lands defined on Map 30, provided:

- (i) the number of the *dwelling rooms* or *dwelling units* does not exceed 179, and the total *residential gross floor area* and *non-residential gross floor area* does not exceed 7,647.0 square metres; and
- (ii) a minimum of 30 *parking spaces* are provided on or within 300 metres of the *university residence*”.

ENACTED AND PASSED this 13th day of April, A.D. 2000.

CASE OOTES,
Deputy Mayor

NOVINA WONG,
City Clerk

(Corporate Seal)

MAP 31

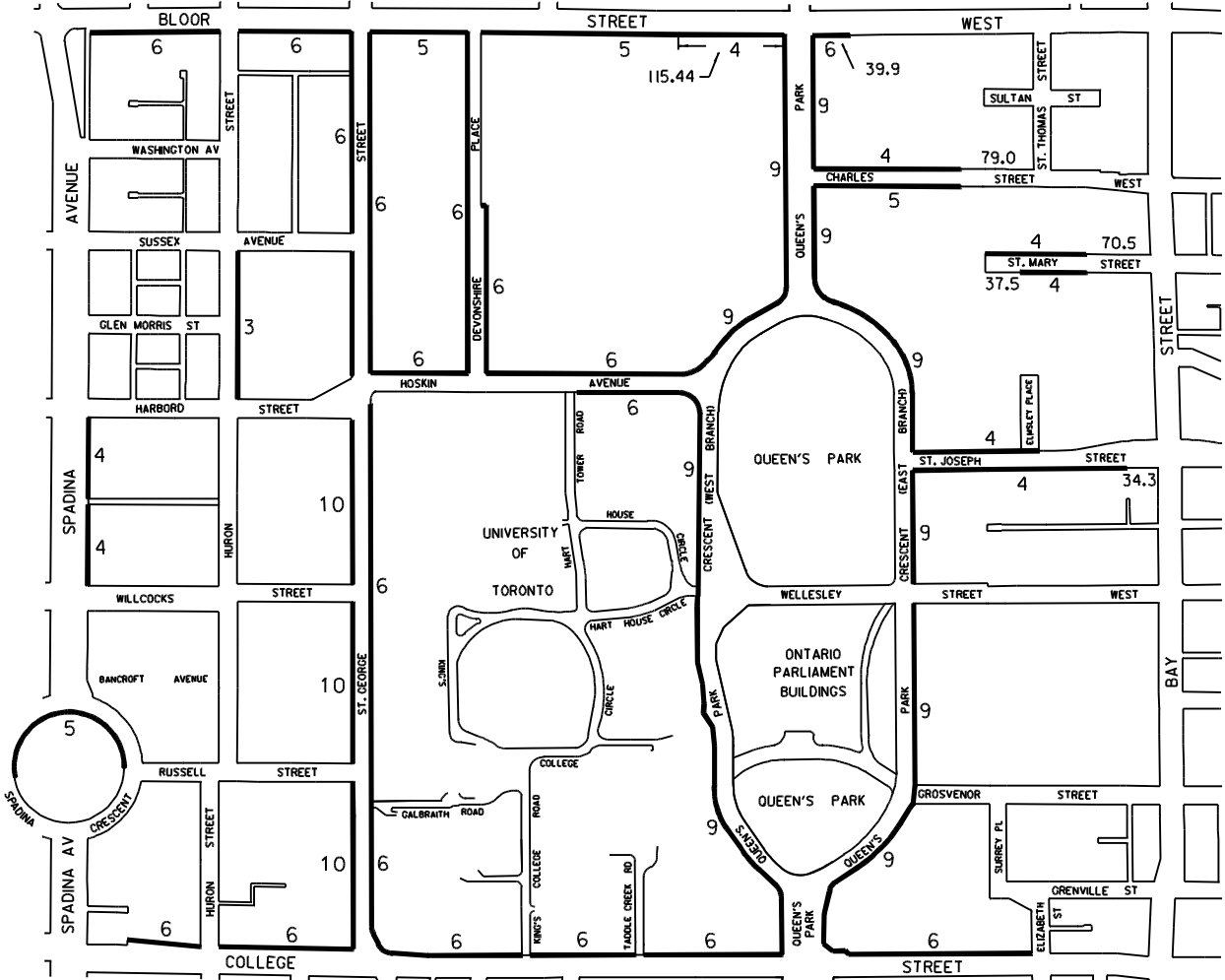

— REQUIRED SETBACK LINES REFERRED TO IN SECTION 12(2)310(d)

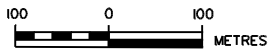

WORKS AND EMERGENCY SERVICES
 SURVEY AND MAPPING SERVICES
 TORONTO MARCH, 2000
 SEC2/S310M31.DGN
 FILE: DRAWN: D.R.
 MAP Nos. 50H-322, 50H-323