

Authority: Toronto Community Council Report No. 16, Clause No. 6,
as adopted by City of Toronto Council on October 3, 4 and 5, 2000
Enacted by Council: October 5, 2000

CITY OF TORONTO

BY-LAW No. 699-2000

**To adopt an amendment to the Official Plan of the former
City of Toronto respecting lands known as 15 Temple Avenue.**

WHEREAS City Council at its meeting of February 1, 2, and 3, 2000 established the Parkdale Pilot Project for the purpose, in part, of regularising the numerous bachelorette buildings in the Parkdale area; and

WHEREAS the owner of the lands known municipally as 15 Temple Avenue have applied for consideration in accordance with the Project process; and

WHEREAS the application meets the regularisation criteria and thus it is appropriate to amend the Official Plan and General Zoning By-law to permit the existing use; and

WHEREAS the Council of the City of Toronto has had referred to it a proposed Official Plan Amendment and a proposed Zoning By-law respecting the site; and

WHEREAS the Council of the City of Toronto conducted a public meeting under Sections 17 and 34 of the *Planning Act*, R.S.O. 1990, c.P. 13, as amended regarding the proposed Official Plan Amendment and proposed Zoning By-law; and

WHEREAS the Council of the City of Toronto, at its meeting held on October 3, 4 and 5, 2000, determined to amend the Official Plan and Zoning By-law for the former City of Toronto;

The Council of the City of Toronto HEREBY ENACTS as follows:

1. The text and map annexed hereto as Schedule "A" are hereby adopted as an amendment to the Official Plan for the former City of Toronto.
2. This is Official Plan Amendment No. 169.

ENACTED AND PASSED this 5th day of October, A.D. 2000.

CASE OOTES,
Deputy Mayor

NOVINA WONG,
City Clerk

(Corporate Seal)

SCHEDULE “A”

1. Section 18 of the Official Plan for the former City of Toronto is amended by adding Section 18.513 and Map 18.513 as follows:

“18.513 Lands known as 15 Temple Avenue

Notwithstanding any of the provisions of this Plan, Council may pass by-laws respecting the lands shown on Map 18.513 to permit the erection and use of a *residential* building having a gross floor area of 1.32 times the area of the *lot*, provided that appropriate regard is had for the effect of the building upon the stability and general residential amenity and physical character of the *Residence Area*, and surrounding areas”.

MAP 18.513

TEMPLE AVENUE

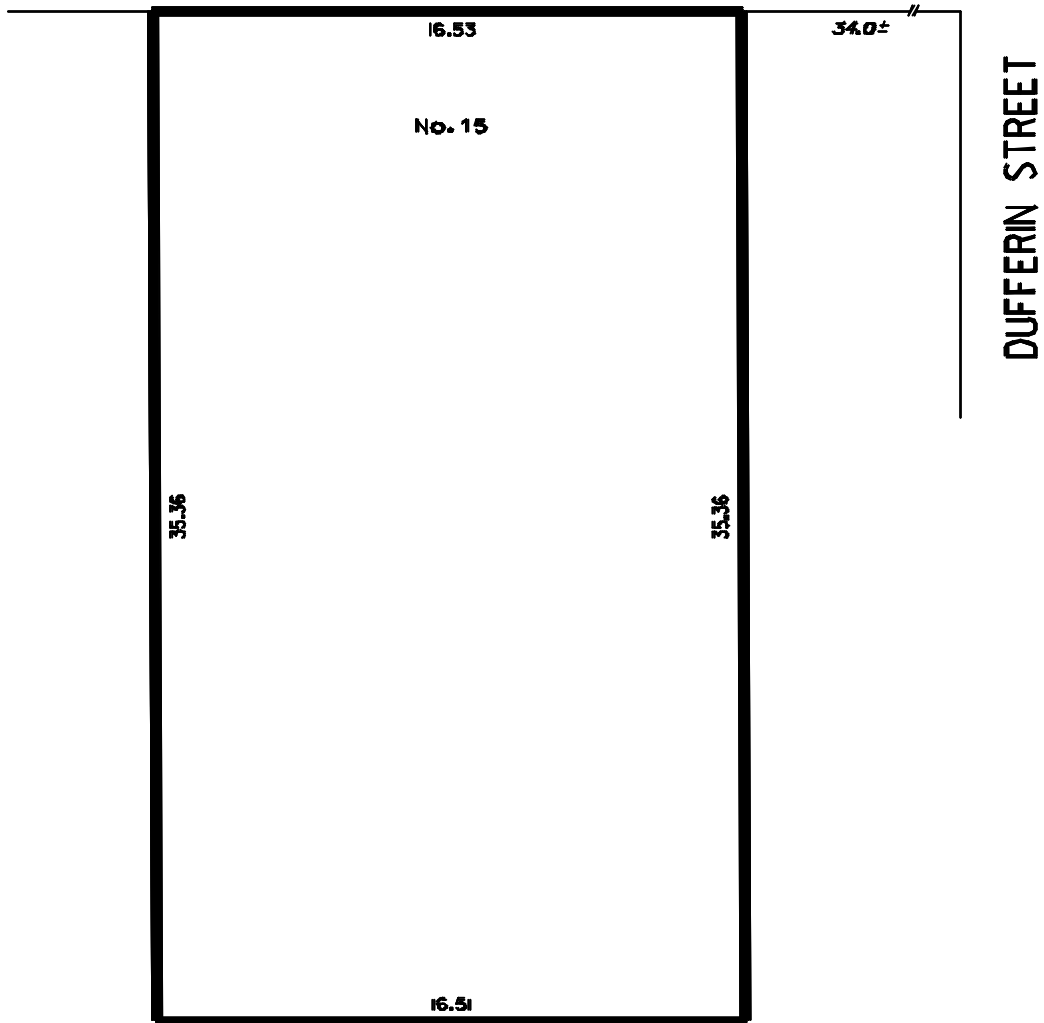

PARTS 3, 4 AND 5, PLAN 63R-3904



WORKS AND EMERGENCY SERVICES
SURVEY AND MAPPING SERVICES
TORONTO SEPTEMBER, 2000
DP400/18513-04N
FILE# T13-22
MAP No. 480-325 DRAWN: PG