

Authority: North York Community Council Report No. 15, Clause No. 21,  
as adopted by City of Toronto Council on December 16 and 17, 1998  
Enacted by Council: March 8, 2001

**CITY OF TORONTO**

**BY-LAW No. 164-2001**

**To amend City of North York By-law No. 7625 in respect of lands  
municipally known as 129 Finch Avenue East.**

WHEREAS authority is given to Council by Section 34 of the Planning Act, R.S.O. 1990, c.P. 13, as amended, to pass this By-law; and whereas Council of the City of Toronto has provided adequate information to the public and has held at least one public meeting in accordance with the Planning Act;

The Council of the City of Toronto HEREBY ENACTS as follows:

1. Schedules "B" and "C" of By-law No. 7625 are amended in accordance with Schedule "1" of the by-law.
2. Section 64.17 of By-law No. 7625 is amended by adding the following subsection:

**64.17(30) RM2(30)**

**EXCEPTION REGULATIONS**

- (a) The requirements of Section 64.17(19) of By-law No. 7625, as amended (RM2(19)) shall apply.
- (b) Notwithstanding (a) and (b) of Section 64.17(19) of By-law No. 7625, as amended, the following shall apply:
  - (i) The maximum gross floor area shall be 620 m<sup>2</sup>.
  - (ii) The minimum lot frontage shall be 6.8 metres for each semi-detached dwelling unit and 13.7 metres for each semi-detached dwelling.

ENACTED AND PASSED this 8th day of March, A.D. 2001.

CASE OOTES,  
Deputy Mayor

NOVINA WONG,  
City Clerk

(Corporate Seal)

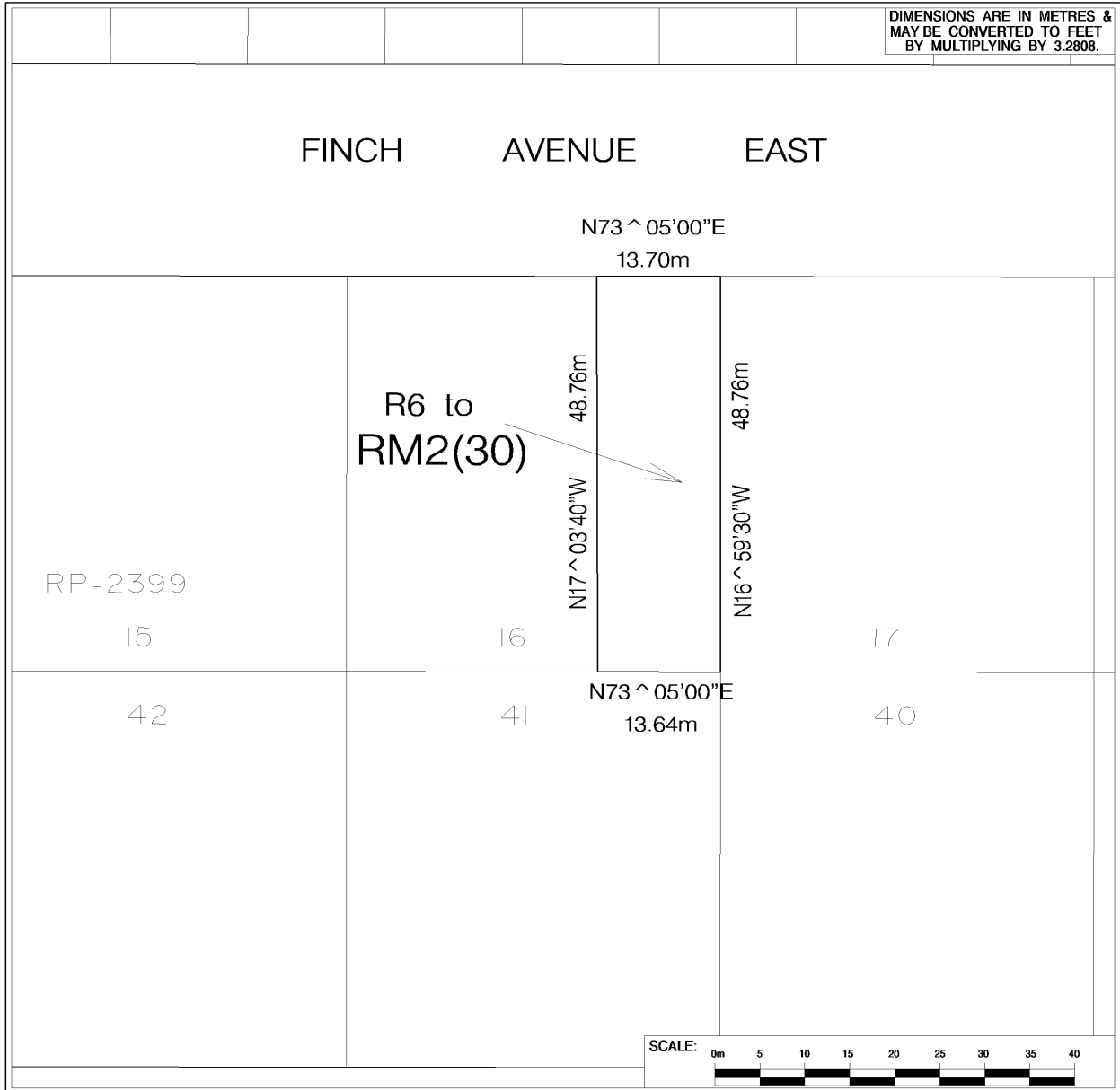

<b>This is Schedule " 1 " to By-Law _____</b> <b>passed the _____ day of _____, 19 ____</b>					 City Planning Division North District
(Sgd.) _____ CLERK	(Sgd.) _____ MAYOR	<input type="checkbox"/> SUBJECT PROPERTY			
<b>Location: Pt of Lot 16 R.P. 2399</b>					
<b>File No. UDZ-98-21</b>	<b>Prepared by: G.P.</b>	<b>Approved by: R.L.</b>	<b>Date: NOV. 9/98</b>	<b>Filename: SBL2943/3755</b>	
Source: Zoning, By-Law, Lot Line, Street Line and Street Name Data - North York Planning Department. Street lines represent street dedications/road allowances and do not represent actual as-built curb lines of streets.					