

Authority: Humber York Community Council Report No. 2, Clause No. 9,
as adopted by City of Toronto Council on February 13, 14 and 15, 2002
Enacted by Council: February 15, 2002

CITY OF TORONTO

BY-LAW No. 115-2002

To amend the Zoning By-law No. 438-86 of the former City of Toronto in respect of the lands known as 62 Brock Avenue.

WHEREAS City Council at its meeting of February 1, 2 and 3, 2000 established the Parkdale Pilot Project for the purpose, among others, of regularizing the numerous bachelorette and rooming house buildings in the Parkdale area; and

WHEREAS the owner of the lands known municipally as 62 Brock Avenue has applied for consideration in accordance with the Project process; and

WHEREAS the application meets the criteria and thus it is appropriate to amend the General Zoning By-law to permit the proposed use; and

WHEREAS the Council of the City of Toronto has had referred to it a proposed Zoning By-law respecting the site; and

WHEREAS the Council of the City of Toronto conducted a public meeting under Section 34 of the *Planning Act*, R.S.O. 1990, c.P. 13, as amended, regarding the proposed Zoning By-law; and

WHEREAS the Council of the City of Toronto, at its meeting held on February 13, 14 and 15, 2002, determined to amend the Zoning By-law for the former City of Toronto;

The Council of the City of Toronto HEREBY ENACTS as follows:

EXEMPT PROVISIONS

- (1) Subject to the requirements of this by-law, none of the following provisions of By-law No. 438-86 being “A by-law to regulate the use of land and the erection, use, bulk, height, spacing of and other matters relating to buildings and structures and to prohibit certain uses for lands and the erection and use of certain buildings and structures in various areas of the City of Toronto” as amended, shall apply to prevent the erection or use of a *converted house* on those lands outlined by heavy lines on Map 1:

PARKING

- (a) Section 4(4) b

MINIMUM UNIT SIZE

- (b) Section 6(2) 1(iv)

DENSITY

- (c) Section 6(3) Part I 1

BUILDING ENVELOPE

- (d) Section 6(3) Part II 3(ii) Chart A
- (e) Section 6(3) Part II 4
- (f) Section 6(3) Part II 5

SUBSTITUTE PROVISIONS

- (2) No person shall erect or use a *converted house* on those lands outlined by heavy lines on Map 1 unless:

PARKING

- (a) no less than two *parking spaces* are provided and maintained on the *lot*;

NUMBER OF UNITS

- (b) no more than thirteen *dwelling units*, eight of which may be *bachelor dwelling units* and five of which may be *dwelling units* containing two or more *habitable rooms*, are provided within the *converted house*;

MINIMUM UNIT SIZE

- (c) the average of the floor areas of the *dwelling units* is not less than 25.45 square metres;
- (d) the floor area of any individual *dwelling unit* is not less than 21.0 square metres;

DENSITY

- (e) the *residential gross floor area* of the *converted house* does not exceed 472.5 square metres;

BUILDING ENVELOPE

- (f) no portion of the *converted house* is located otherwise than wholly within the *building envelope*, exclusive of those building elements set out in Section 6(3) Part II 8 Chart provisions A, B, C, E, L and N, and in Section 6(2) 5(a) (iv) F, of By-law No. 438-86 of the former City of Toronto, as amended;

- (g) the building *depth* does not exceed 20.57 metres;
- (h) the side yard setback on the south side of the building is not less than 2.9 metres; and
- (i) the rear yard setback is not less than 6.6 metres.

DEFINITIONS

- (3) For the purpose of this by-law:
 - (i) *building envelope* means the area shaded by diagonal lines on Map 1.

GENERAL

- (4) With the exception of any defined terms to the extent modified by this by-law, all other provisions of By-law No. 438-86 of the former City of Toronto, as amended, continue to apply.

ENACTED AND PASSED this 15th day of February, A.D. 2002.

CASE OOTES,
Deputy Mayor

ULLI S. WATKISS
City Clerk

(Corporate Seal)

MAP 1

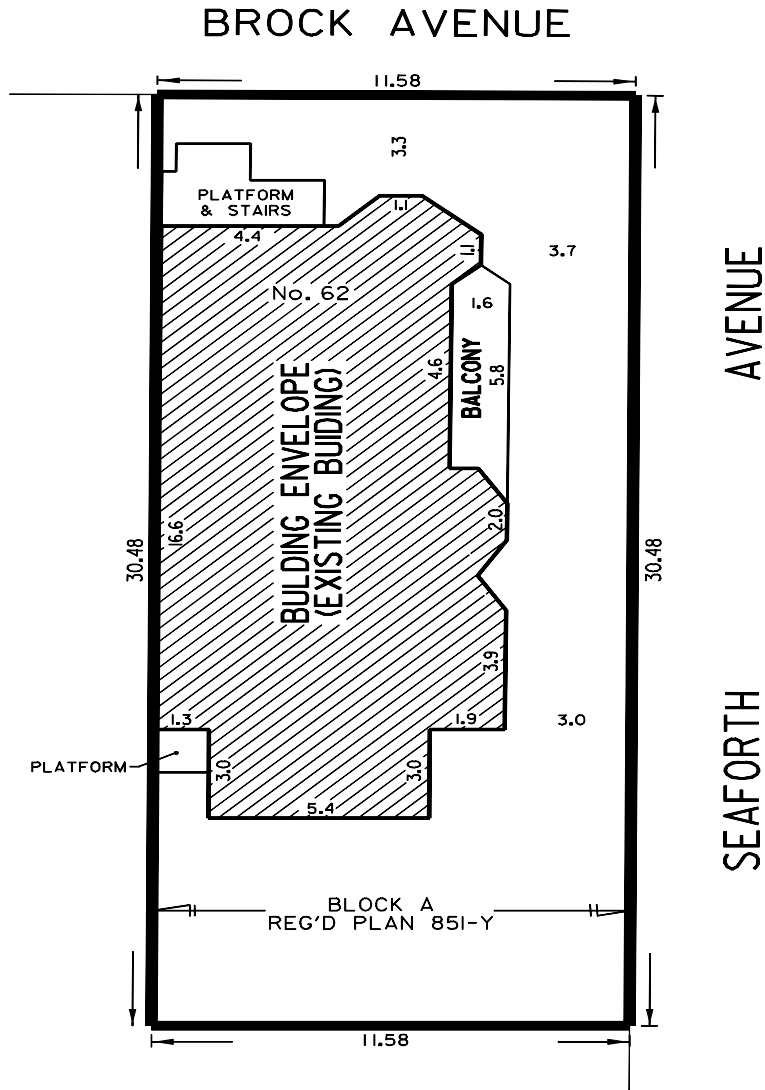

WORKS AND EMERGENCY SERVICES
 SURVEY AND MAPPING SERVICES
 TORONTO FEBRUARY, 2002
 BLO2/62BROCK1.DGN
 FILES: 2402.84
 MAP No. 48H-313 DRAWN: WL