

Authority: Toronto and East York Community Council Report No. 6, Clause No. 6,  
as adopted by City of Toronto Council on July 20, 21 and 22, 2004  
Enacted by Council: July 22, 2004

**CITY OF TORONTO**

**BY-LAW No. 718-2004**

**To adopt Amendment No. 303 to the Official Plan for the former City of Toronto with respect to lands known municipally as 1 to 29 Musgrave Street; 600 Victoria Park Avenue; 2234 to 2276 Gerrard Street East; 2284 to 2316 Gerrard Street East; and 2236 to 2366 Gerrard Street East.**

WHEREAS authority is given to Council under the *Planning Act*, R.S.O. 1990, c.P. 13, as amended, to pass this By-law; and

WHEREAS Council of the City of Toronto has provided adequate information to the public and has held at least one public meeting in accordance with the *Planning Act*;

The Council of the City of Toronto HEREBY ENACTS as follows:

1. The text and map annexed hereto as Schedule "A" are hereby adopted as an amendment to the Official Plan for the former City of Toronto.
2. This is Official Plan Amendment No. 303.

ENACTED AND PASSED this 22nd day of July, A.D. 2004.

DAVID R. MILLER,  
Mayor

ULLI S. WATKISS  
City Clerk

(Corporate Seal)

**SCHEDULE “A”**

1. Map 1 of Part I of the Official Plan for the City of Toronto entitled “Generalized Land Use City of Toronto” is amended by:
  - (1) deleting the designation shown for the lands delineated on Map 1 of 2 attached to and forming part of this by-law and inserting in substitution for such designation, the designation “Low Density Mixed Commercial-Residential Areas”; and
  - (2) deleting the designation shown for the lands delineated on Map 2 of 2 attached to and forming part of this by-law and inserting in substitution for such designation, the designation “Low Density Residence Areas”.
2. Section 19.13 of the Official Plan Part II for the East of Main, is amended by replacing Map A with a new Map A, in which the previous *Mixed Industrial-Residential Area* is redesignated as *Low Density Residence Area* and in which the previous *Restricted Industrial Areas* is redesignated with the symbol that refers to the Official Plan Part I.

MAP 1 of 2

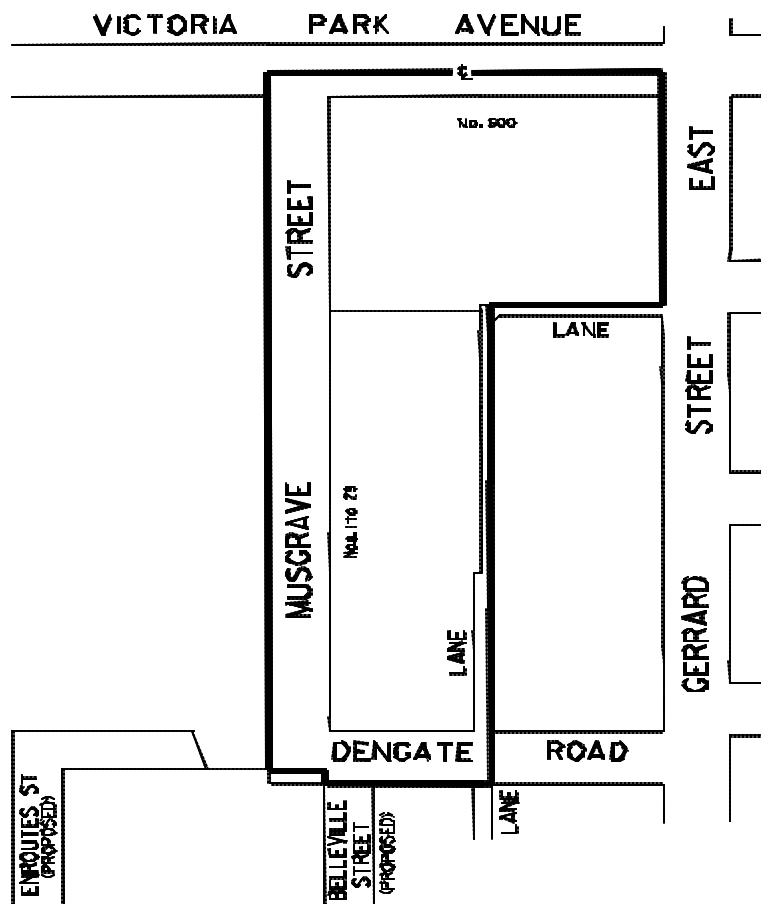

 LOW DENSITY MIXED  
COMMERCIAL-RESIDENTIAL AREA



WORKS AND EMERGENCY SERVICES  
SURVEY AND MAPPING SERVICES  
TORONTO JUNE, 2004  
PAGE 4 / MAIN1.DGN  
FILE # 2402-55  
WSP No. 24M-524 DRAWN: D.R.

## MAP 2 of 2

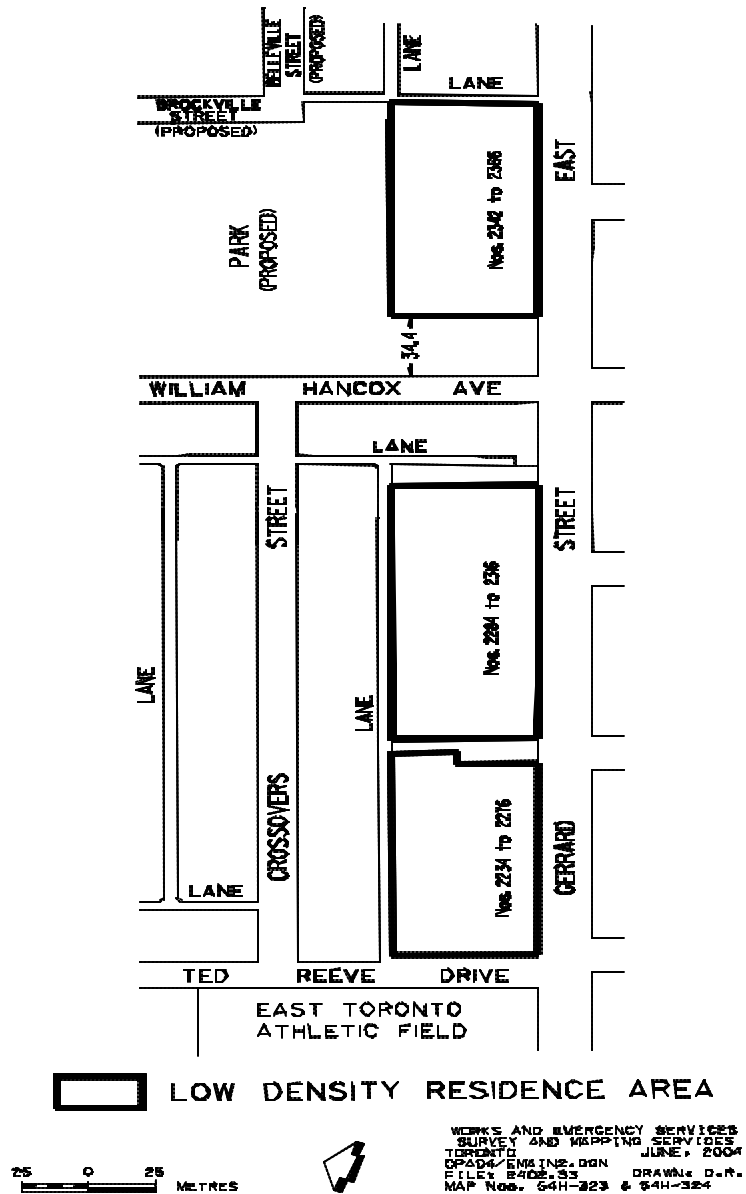

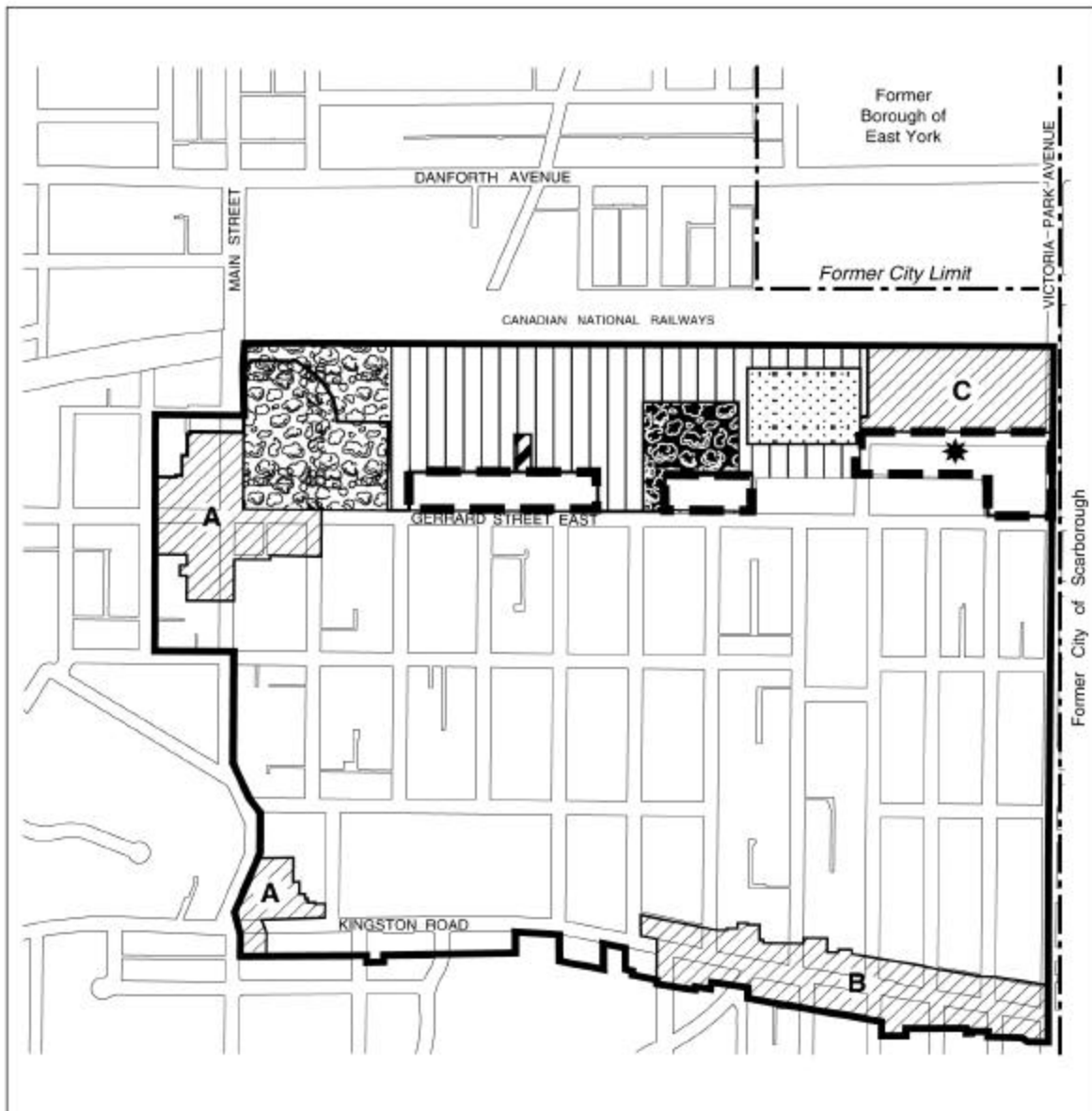

**Toronto** Urban Development Services  
Draft Official Plan

2234 - 2276, 2284 - 2316, 2336 - 2366 Gerrard St East,  
1-29 Musgrave St, & 600 Victoria Park Ave

19.13 East of Main Part II Plan Map A

File # WPS 703005

Areas of Amendment	Medium Density Residence Area	Local Park
Low Density Residence Area	Mixed Commercial-Residential Area 'A' & 'B'	Holding Designation
Low Density Residence Area 'A'	District Park	Refer to Official Plan Part 1

↑  
Not to Scale  
06/08/04