

Authority: Toronto and East York Community Council Item 17.8,  
as adopted by City of Toronto Council on July 15, 16 and 17, 2008  
Enacted by Council: September 25, 2008

**CITY OF TORONTO**

**BY-LAW No. 951-2008**

**To designate the Riverdale Phase 1 Heritage Conservation District.**

WHEREAS City Council has authorized the establishment of the Riverdale Phase 1 Heritage Conservation District and has authorized the adoption of the Riverdale Phase 1 Conservation District Plan;

The Council of the City of Toronto HEREBY ENACTS as follows:

1. The area outlined by the heavy lines shown on the map attached as Schedule “A” to this by-law is designated as a heritage conservation district under Part V of the *Ontario Heritage Act*, R.S.O. 1990, chapter O.18.
2. The heritage conservation district plan for the Riverdale Phase 1 Heritage Conservation District prepared by City of Toronto Heritage Preservation Services, dated May 2008 is adopted.
3. A copy of the heritage character statement and heritage conservation district plan is available for inspection at the office of Heritage Preservation Services, Planning Division, Suite A17, City Hall, 100 Queen Street West, Toronto, Ontario. It is also available on the City’s website @ [www.toronto.ca/heritage-preservation\\_districts.htm](http://www.toronto.ca/heritage-preservation_districts.htm).

ENACTED AND PASSED this 25th day of September, A.D. 2008.

SANDRA BUSSIN,  
Speaker

ULLI S. WATKISS  
City Clerk

(Corporate Seal)

SCHEDULE "A"

SCHEDULE "A"

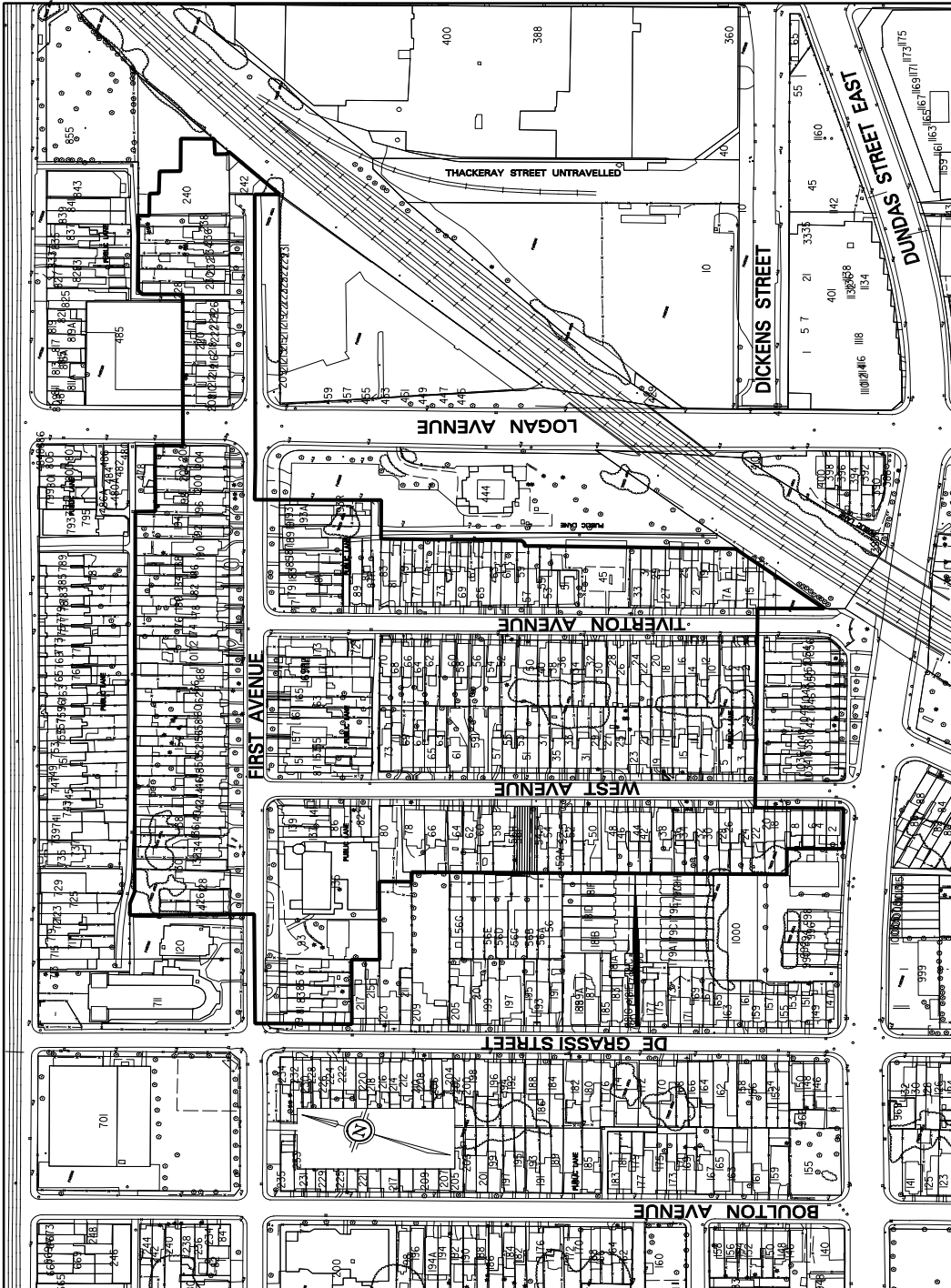

**Toronto**  
 TECHNICAL SERVICES DIVISION  
 SURVEY & MAPPING SERVICES

NOTE:  
 THIS SKETCH IS NOT  
 A PLAN OF SURVEY  
 AND HAS BEEN COMPILED  
 FROM SURVEY NOTES AND  
 OFFICE RECORDS. IT SHALL  
 NOT BE USED EXCEPT FOR  
 THE PURPOSE INDICATED  
 IN THE TITLE BLOCK

PROPERTY INFORMATION SHEET  
 RIVERDALE HERITAGE CONSERVATION DISTRICT  
 LAND DESIGNATED AS BEING OF CULTURAL HERITAGE VALUE AND INTEREST

WARD 30 - TORONTO-DANFORTH  
 DATE: APRIL 21, 2008

PREPARED BY: DWAYNE PITT  
 CHECKED BY: JOHN HOUSE

SKETCH No. PS-2008-062