

Authority: Item TE13.1, as adopted by Toronto and East York Community Council on January 19, 2016 under the delegated authority of Sections 27-149B and 27-152 of City of Toronto Municipal Code Chapter 27, Council Procedures

CITY OF TORONTO

BY-LAW No. 41-2016

To authorize the naming of a public lane located west of Jarvis Street, extending southerly from Shuter Street to Richard Bigley Lane, as "Harbour Light Lane".

Whereas pursuant to § 27-152E(5) of City of Toronto Municipal Code Chapter 27, Council Procedures, Toronto and East York Community Council has the authority to pass a by-law naming the public lane;

The Toronto and East York Community Council enacts:

1. In the City of Toronto and Province of Ontario, in the Land Titles Division of the Toronto Registry Office (No. 66), being composed of:

FIRSTLY:

PIN 21098-0233(LT)

Parts of Lots 6, 7, 8, 9, 10, 11, 12, 13, 14, 15, 16 and 17 on the west side of Jarvis Street, Section A, Plan 10A designated as PART 1 on Plan 66R-23316.

SECONDLY:

Part of PIN 21098-0193(LT)

Part of the Unnamed Lane Plan 10A Toronto lying to the east of Lots 1-17 Section A Plan 10A Toronto; Part of Lot 13 on the east side of Mutual Street Section A Plan 10A Toronto designated as PART 2 on Plan 63R-3770; Part of Lots 2 Plan 28E Toronto designated as PART 2 on Plan 63R-2895; Part of Lot 4 Plan 28E Toronto designated as PART 2 on Plan 63R-4909; Parts of Lots 1, 2, 3, 4, 5, 6, 7, 8, 9 and 10 on the east side of Mutual Street Section A Plan 10A Toronto designated as PARTS 1 and 2 on Plan 63R-2726; Part of Lot 1 on the east side of Mutual Street Section A Plan 10A Toronto as in EP63527.

and shown as PART 1 on the sketch attached to this By-law is named "Harbour Light Lane".

Enacted and passed on January 19, 2016.

Mike Layton,
Chair

Ulli S. Watkiss,
City Clerk

(Seal of the City)

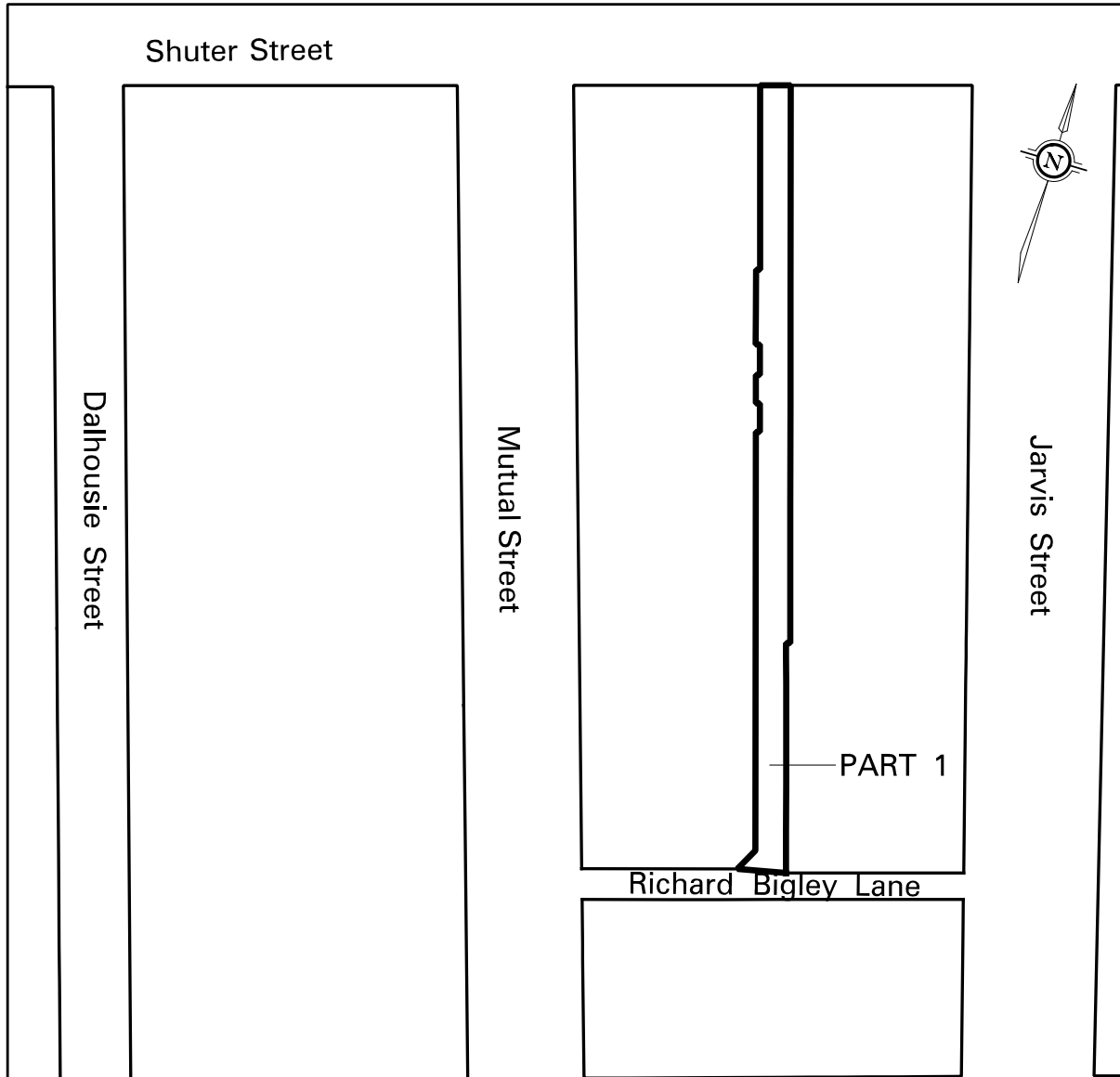

Queen Street East



ENGINEERING & CONSTRUCTION SERVICES
 ENGINEERING SUPPORT SERVICES
 LAND & PROPERTY SURVEYS

NOTE:
 THIS SKETCH HAS BEEN
 COMPILED FROM OFFICE
 RECORDS, MEASUREMENTS
 ARE APPROXIMATE

CHECK BY JOHN HOUSE

PREPARED BY: DWAYNE PITT

WARD 27 – TORONTO CENTRE-ROSEDALE
 DATE: OCTOBER 21, 2015

PROPERTY INFORMATION SHEET

NAMING OF A PUBLIC LANE LOCATED
 SOUTH OF SHUTER STREET BETWEEN
 JARVIS STREET AND MUTUAL STREET

SKETCH No. PS-2015-127