

2007 Capital Works Projects
Locations Requiring a Highway Alteration By-law

Installation of Lay-by

Ward	Street	At	Description of Highway Alteration	Rationale
1	Martin Grove Rd	Brunello Gate	New bus bay at Brunello Gate	Safety and Operational Improvement

Installation of Sidewalk

Ward	Street	From	To	Description of Highway Alteration	Rationale
1	Woodbine Downs Blvd (W. Side)	Finch Ave W	Carrier Dr	535 m of new sidewalk	Pedestrian safety improvement
2	Galaxy Blvd (E. Side)	International Blvd	Mimico Creek Bridge	511.8 m of new sidewalk	Pedestrian safety improvement
3	Princess Margaret Blvd (S. Side)	Lloyd Manor Rd	TTC Bus Stop	15 m of new sidewalk	Pedestrian safety improvement
5	Stephen Dr	Whitworth Ave (73 Stephen Dr)	Berry Rd (opp of Cloverhill Rd)	600 m of new sidewalk	Pedestrian safety improvement
11	Jane St (W. Side)	Eglinton Ave W	974 Jane St (opp Lambton Ave)	320 m of new sidewalk	Pedestrian safety improvement

Realignment of Intersections

Ward	Street	At	Description of Highway Alteration	Rationale
2	Kipling Ave	Hinton Rd	Radius modifications for new traffic signals	Safety and Operational Improvement
2	Kipling Ave	Snaresbrook Drive	Radius modifications for new traffic signals	Safety and Operational Improvement
7	Weston Rd N	Sheppard Ave W	Remove WBRT channelized island	Safety and Operational Improvement
11	Jane St	Outlook Ave	Remove WBRT channelized island	Safety and Operational Improvement
11	Weston Rd N	Knob Hill Dr	Construct new NBR T lane	Safety and Operational Improvement
12	Ingram Dr	Kincourt St	Radius modifications for new traffic signals	Safety and Operational Improvement

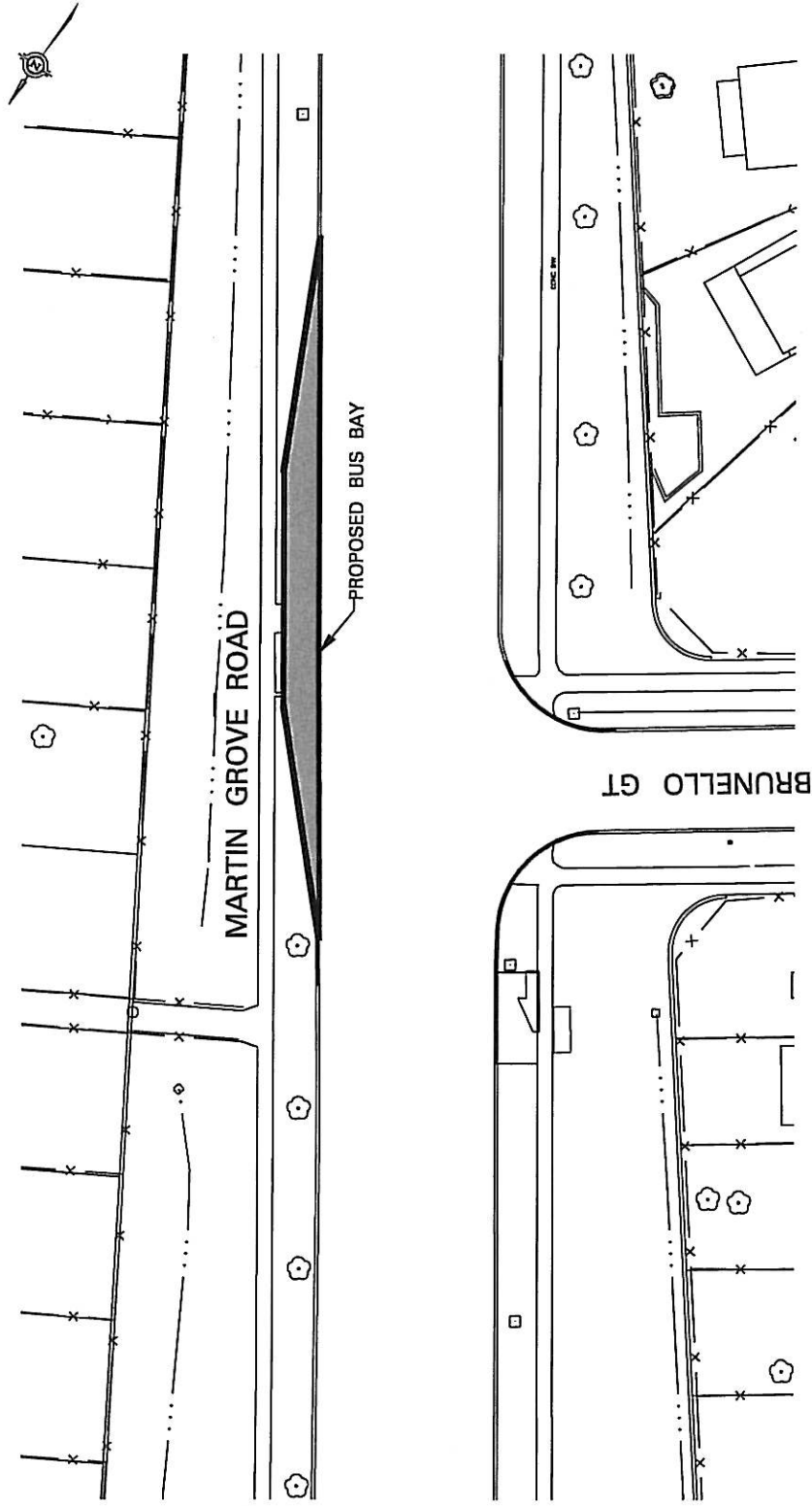

Technical Services

MARTIN GROVE ROAD

PROPOSED BUS BAY
AT BRUNELLO GATE

DRAWING
NUMBER

SK-2066

DATE: 06 06 2007

SCALE: N.T.S.

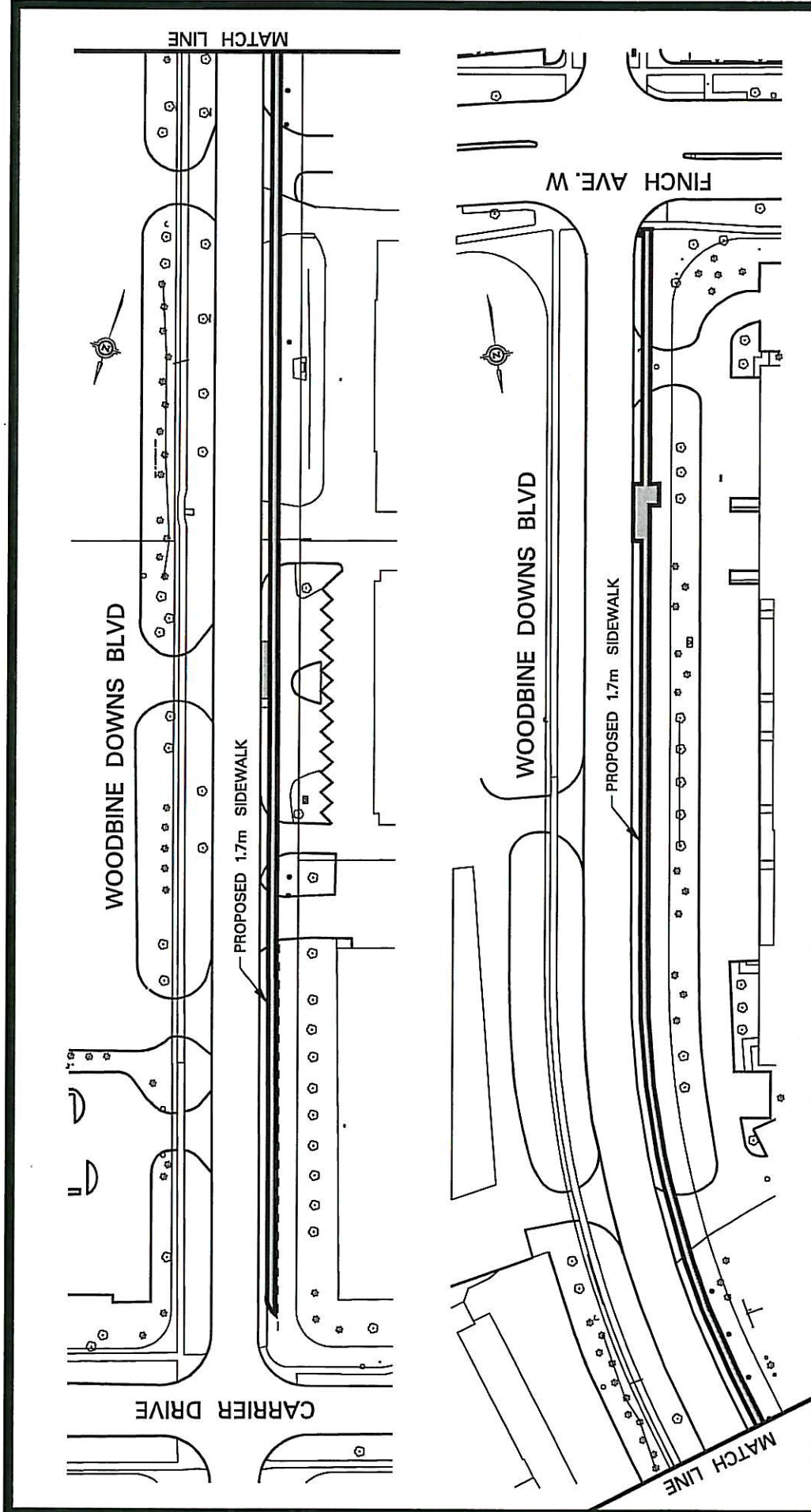

Technical Services

WOODBINE DOWNS BOULEVARD (WEST SIDE)

PROPOSED 1.7m SIDEWALK

FROM CARRIER DRIVE TO FINCH AVENUE W.

DRAWING NUMBER **SK-2815**

DATE: 06 05 2007

SCALE: N.T.S.

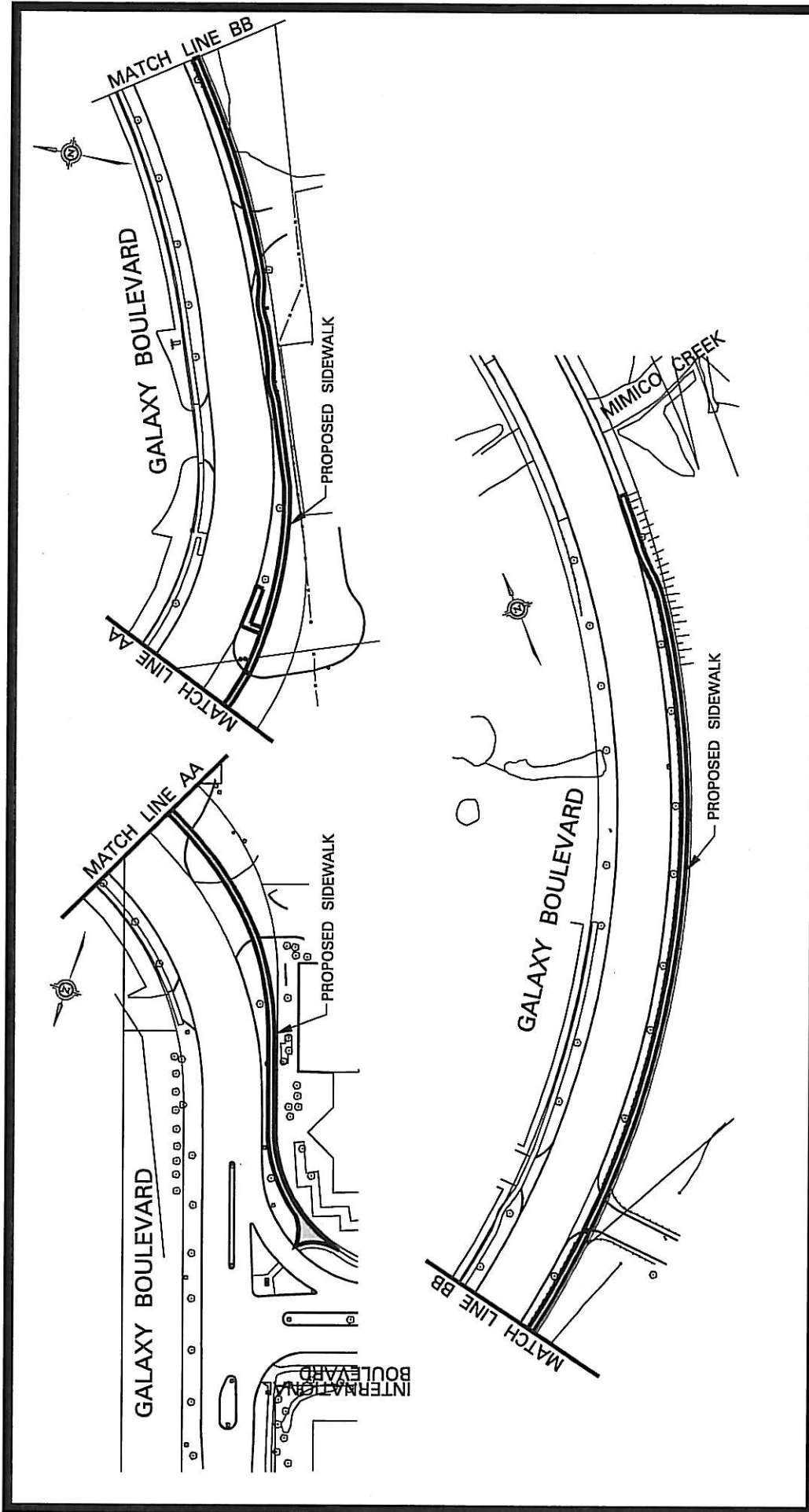

Technical Services

GALAXY BOULEVARD

PROPOSED SIDEWALK

FROM INTERNATIONAL BOULEVARD TO MIMICO CREEK BRIDGE

DRAWING
NUMBER

SK-1653

DATE: 06 06 2007

SCALE: N.T.S.

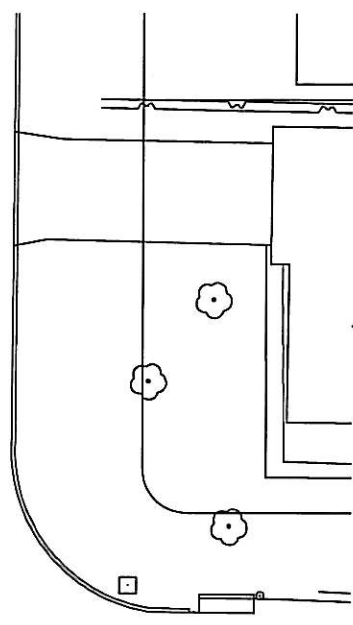
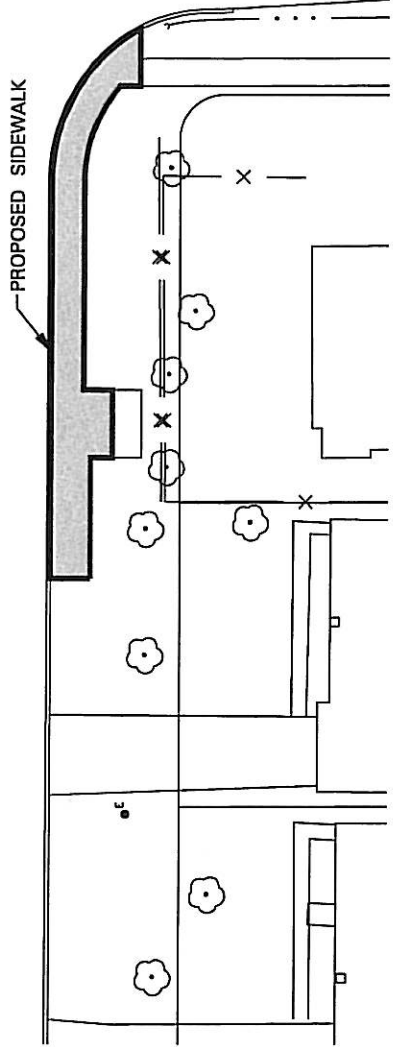
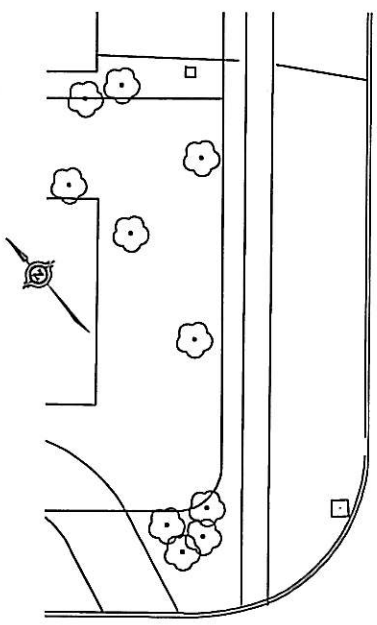
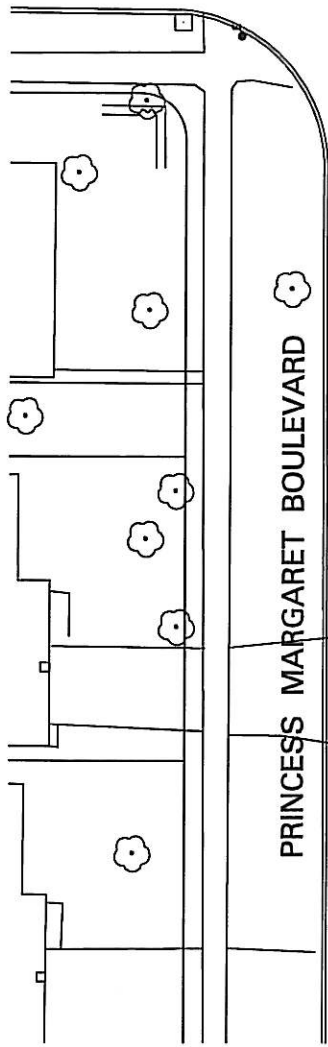

Technical Services

PRINCESS MARGARET BOULEVARD (SOUTH SIDE)

PROPOSED SIDEWALK

FROM LLOYD MANOR ROAD TO TTC BUS STOP

DRAWING NUMBER **SK-2301**

DATE: 06 06 2007 SCALE: N.T.S.

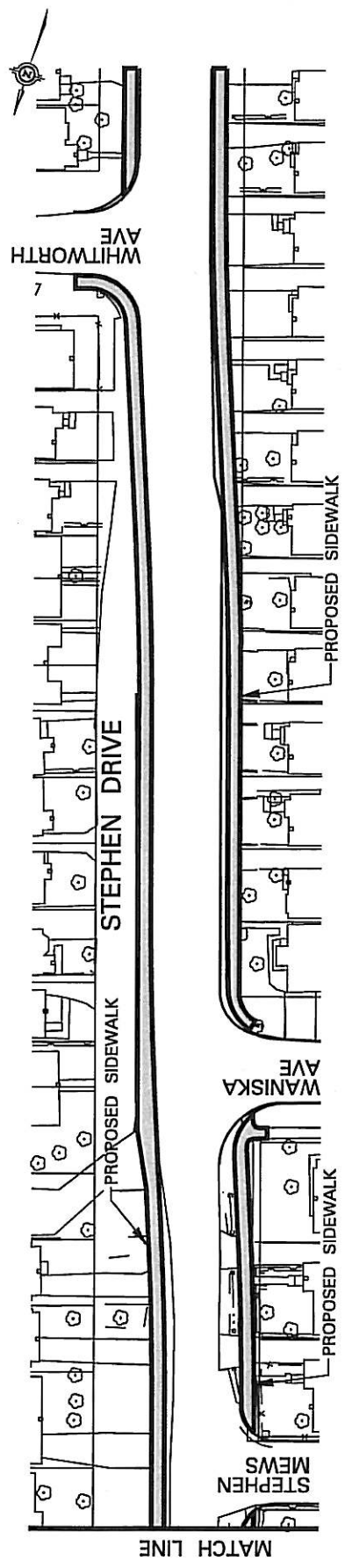
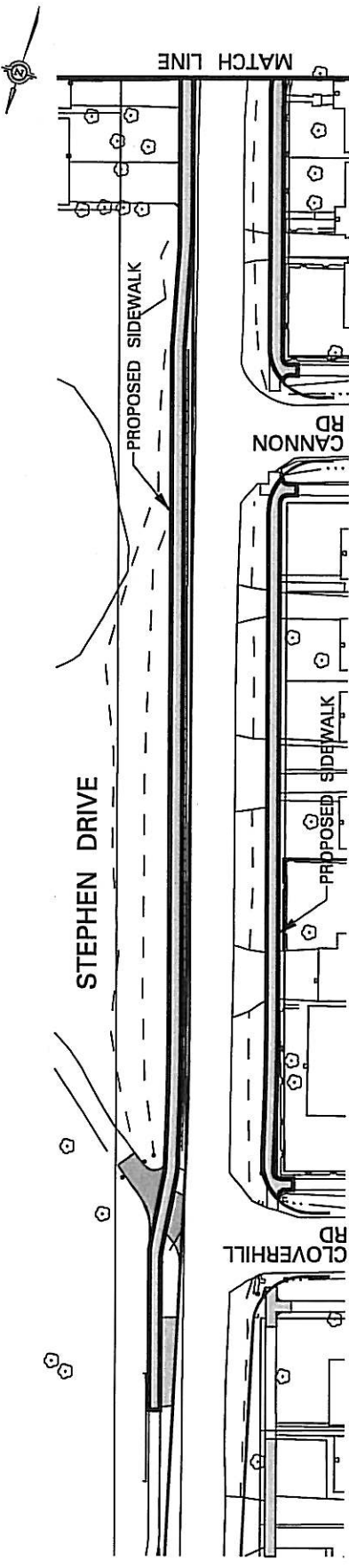

Technical Services

STEPHEN DRIVE

PROPOSED SIDEWALK

FROM WHITWORTH AVENUE TO BERRY ROAD (OPP. OF CLOVERHILL ROAD)

DRAWING NUMBER **SK-2528**

DATE: 06 06 2007

SCALE: N.T.S.



JANE STREET

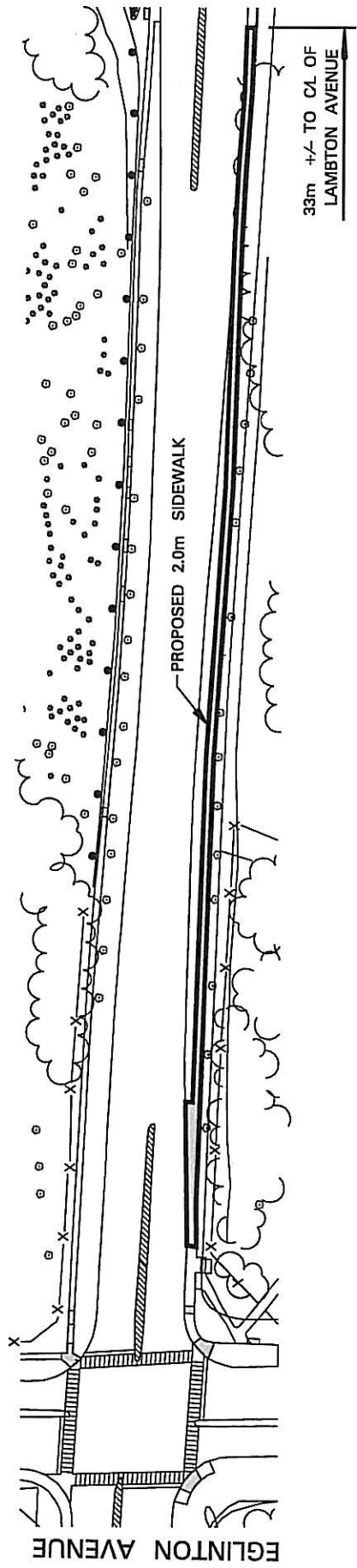

33m +/- TO CL OF LAMBTON AVENUE

PROPOSED 2.0m SIDEWALK

EGLINTON AVENUE

Toronto Technical Services

JANE STREET
 PROPOSED 2.0m SIDEWALK
 FROM NORTH OF LAMBTON AVENUE TO EGLINTON AVENUE WEST

DRAWING NUMBER **SK-694**

DATE: 05 29 2007 SCALE: N.T.S.

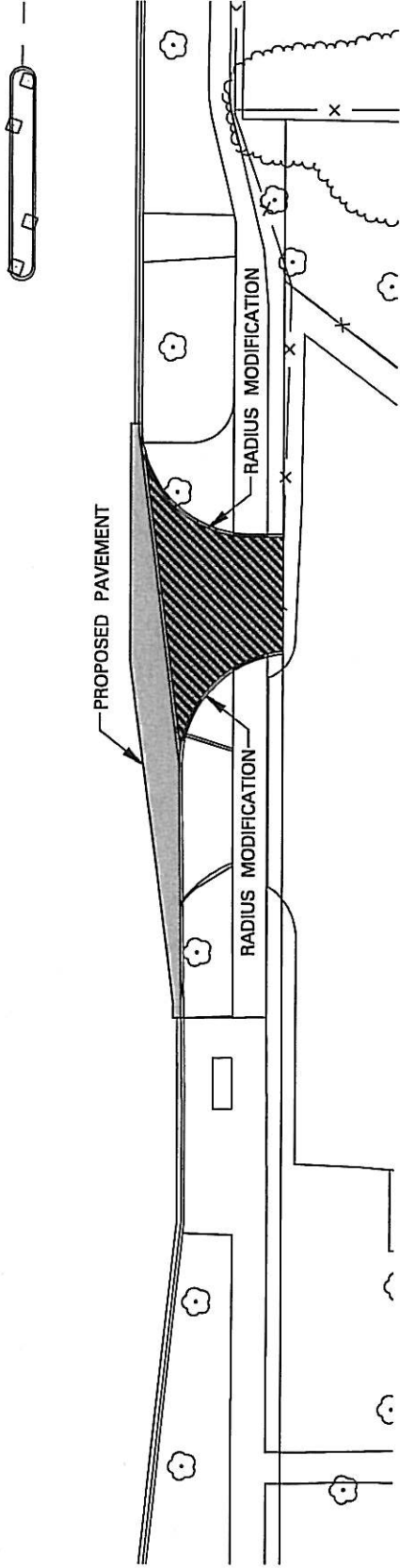
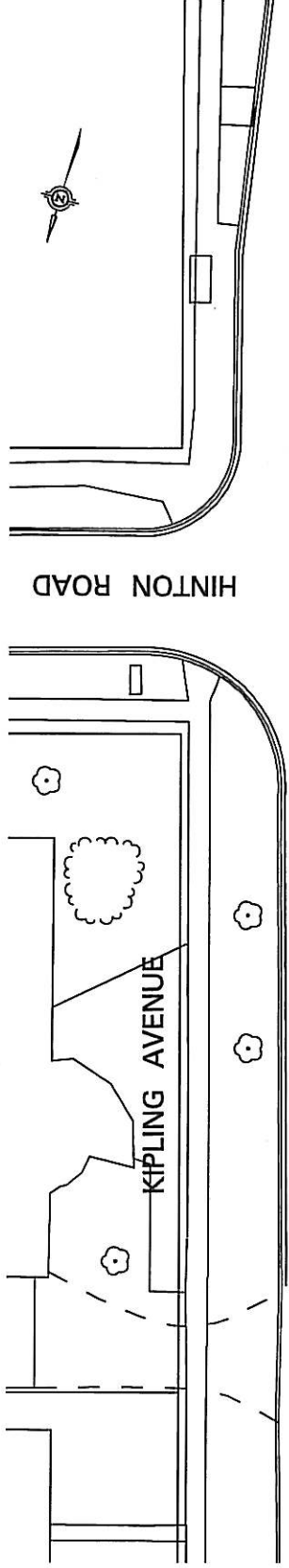

Toronto Technical Services

KIPLING AVENUE
 RADIUS MODIFICATIONS FOR NEW TRAFFIC SIGNALS
 AT KIPLING AVENUE AND HINTON ROAD INTERSECTION

DRAWING NUMBER **SK-1935**

DATE: 06 06 2007 SCALE: N.T.S.

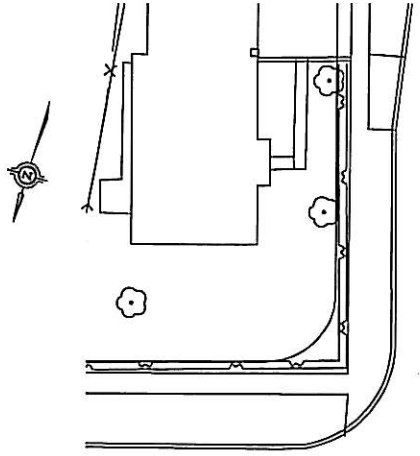

SNARESBROOK DRIVE

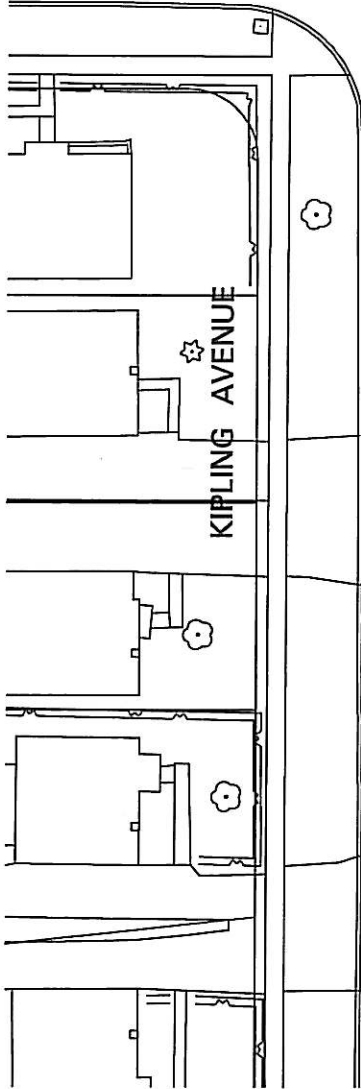

KIPLING AVENUE

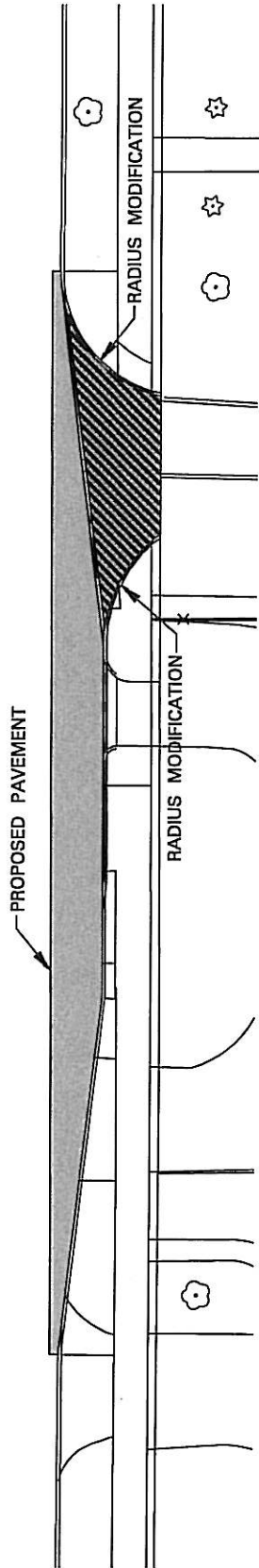

Technical Services

KIPLING AVENUE
 RADIUS MODIFICATIONS FOR NEW TRAFFIC SIGNALS
 AT KIPLING AVENUE AND SNARESBROOK DRIVE INTERSECTION

DRAWING NUMBER **SK-1935**

DATE: 06 06 2007 SCALE: N.T.S.

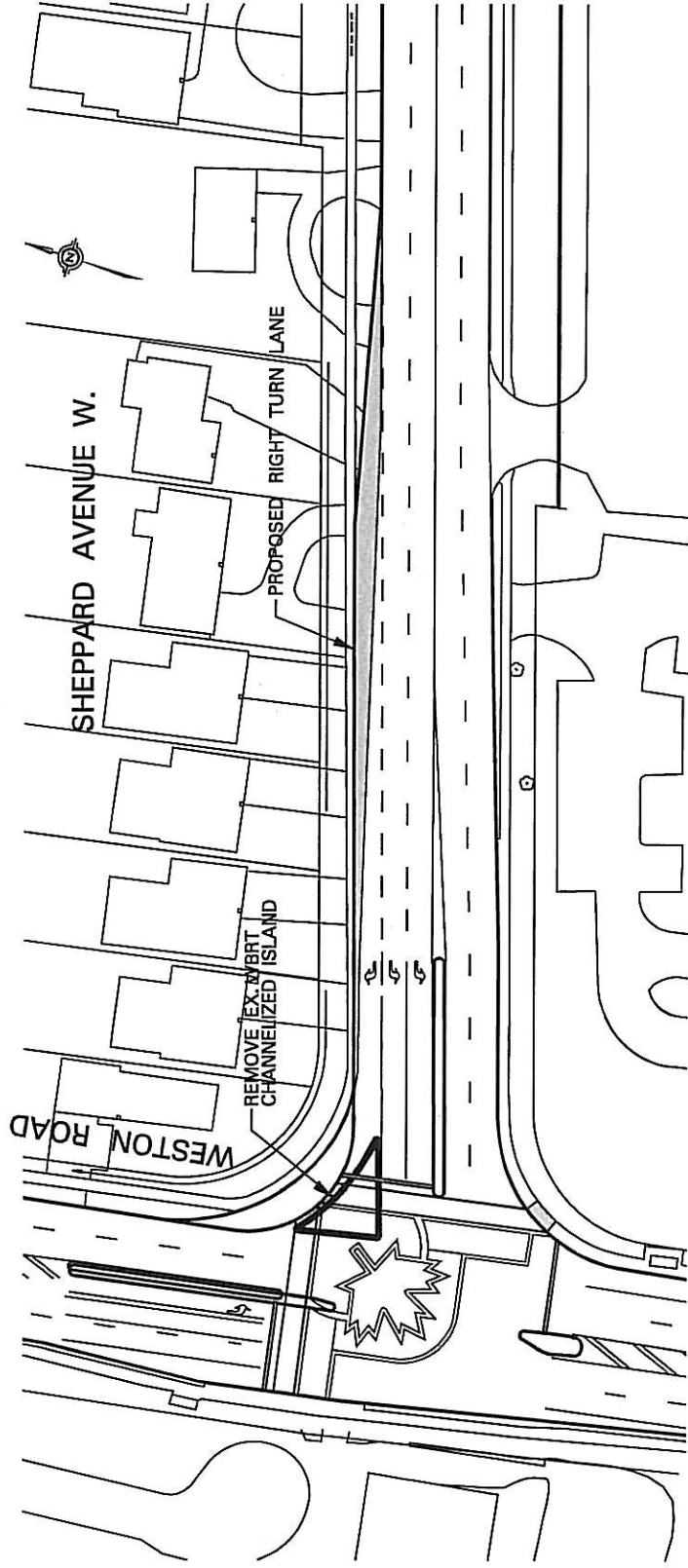

Toronto Technical Services

WESTON ROAD
 REMOVE WBRT CHANNELIZED ISLAND
 AT WESTON ROAD AND SHEPPARD AVENUE

DRAWING NUMBER **SK-694** DATE: 05 29 2007 SCALE: N.T.S.

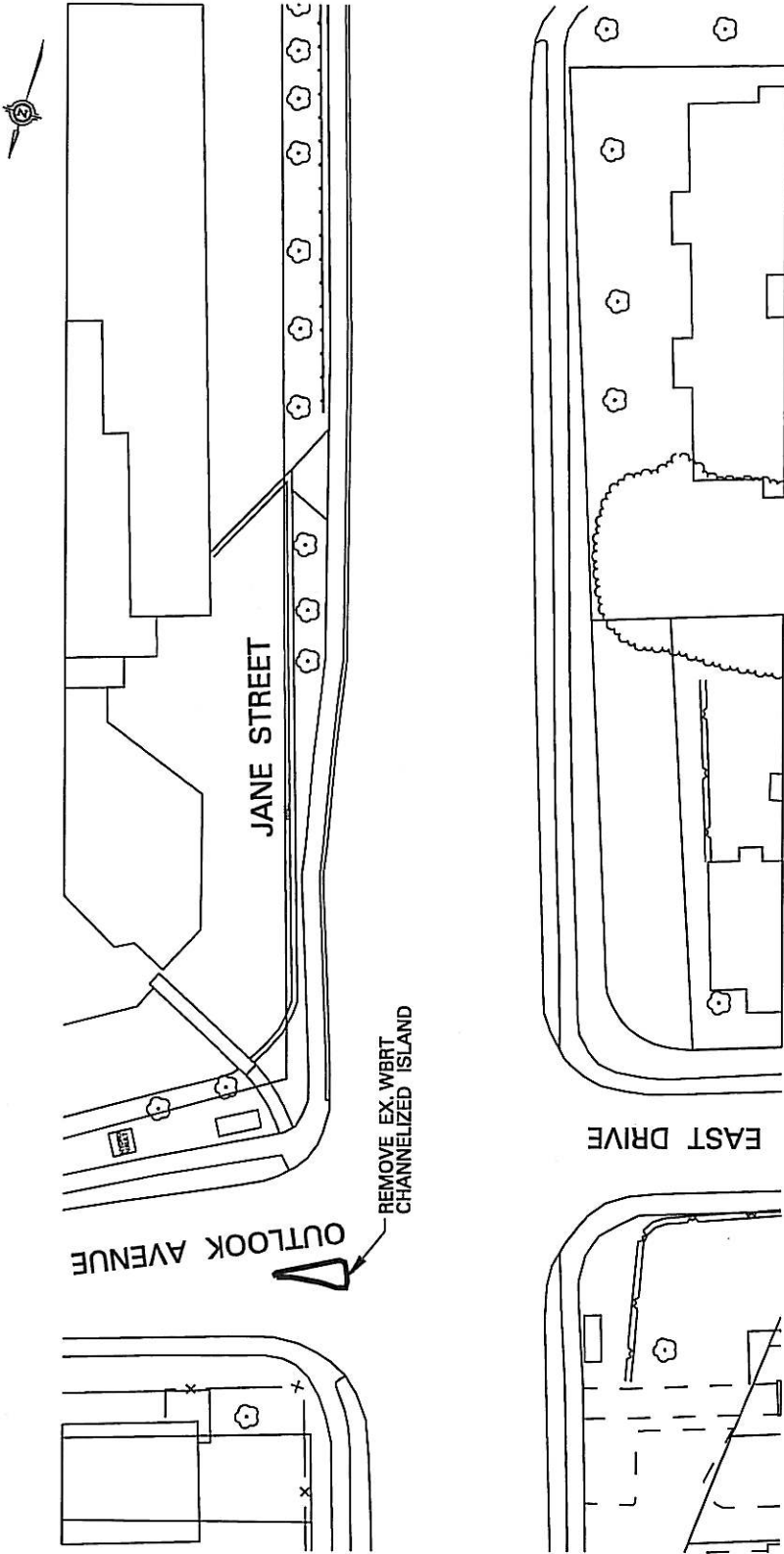

Toronto Technical Services

JANE STREET
 REMOVE WBRT CHANNELIZED ISLAND
 AT JANE STREET AND OUTLOOK AVENUE

DRAWING NUMBER **SK-694**

DATE: 06 06 2007 SCALE: N.T.S.

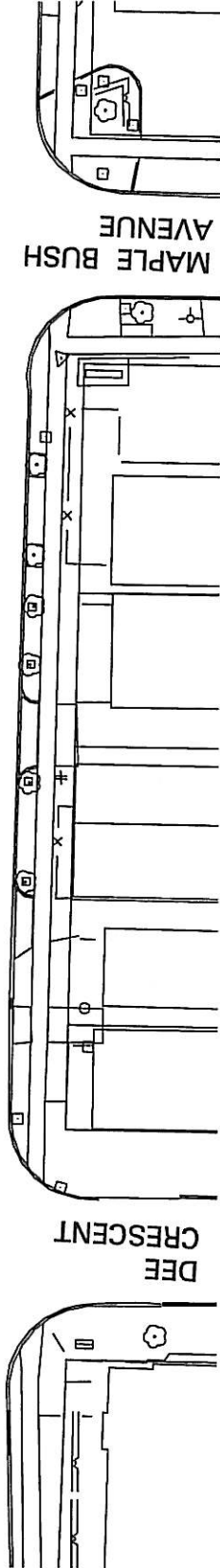
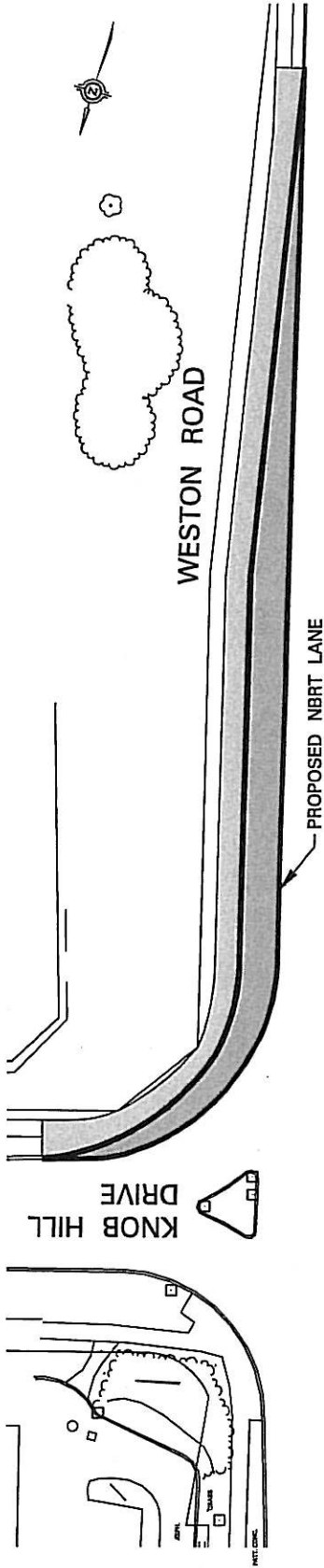

Toronto Technical Services

WESTON ROAD
 PROPOSED NBRT LANE
 AT WESTON ROAD AND KNOB HILL DR INTERSECTION

DRAWING NUMBER **SK-952** DATE: 06 06 2007 SCALE: N.T.S.

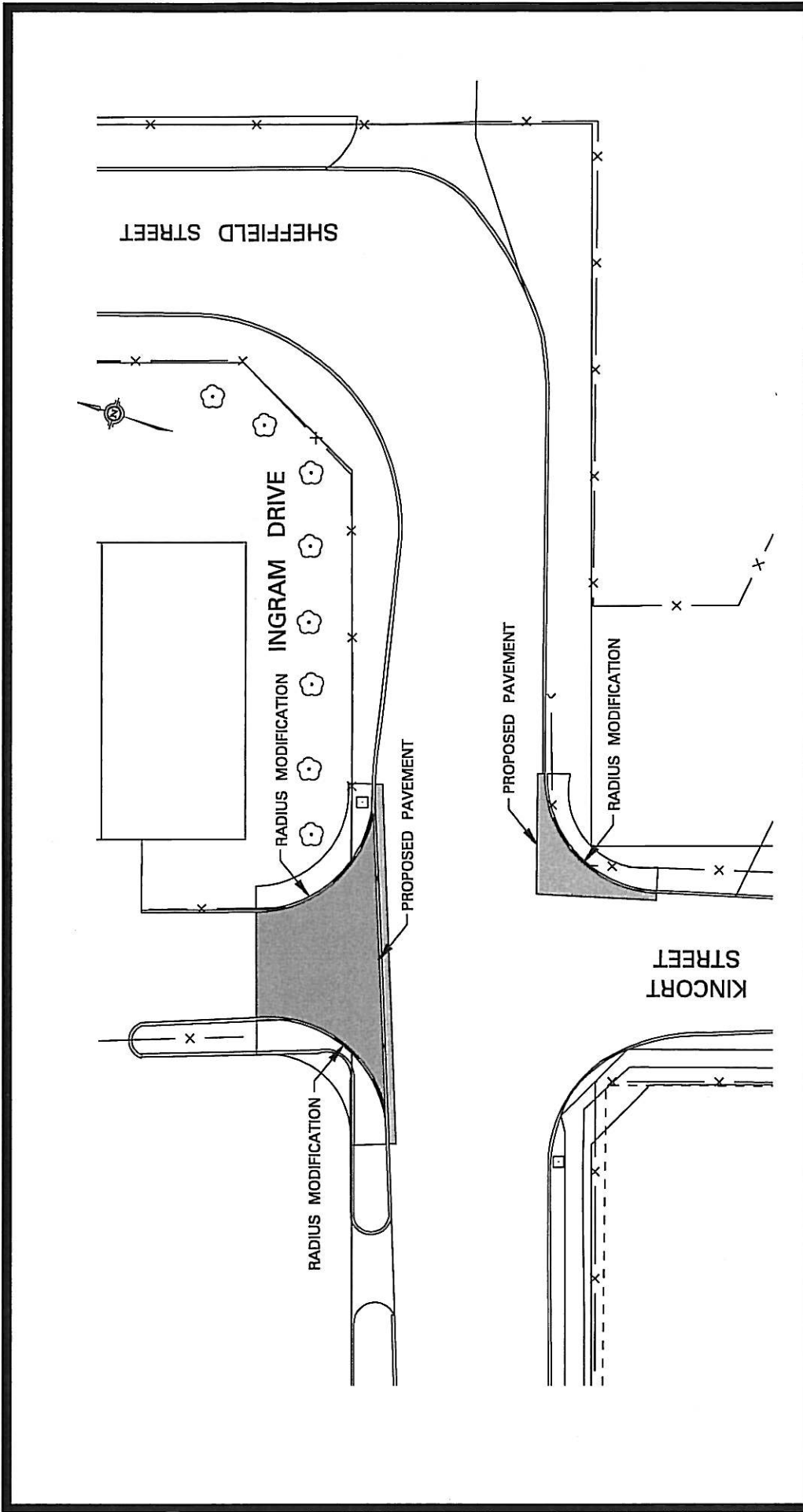

Toronto Technical Services

INGRAM DRIVE

RADIUS MODIFICATIONS FOR NEW TRAFFIC SIGNALS
 AT INGRAM DRIVE AND KINCORT STREET INTERSECTION

DRAWING NUMBER **SK-5892**

DATE: 06 06 2007 SCALE: N.T.S.