

NAIRN PARK

HARVIE AVENUE

HARVIE AVENUE

8.9m

27.0m

9.0m

ROCHDALE AVENUE

7.5m

**LEGEND**



PROPOSED DAY CARE PICK-UP / DROP-OFF  
AREA TO OPERATE FOR 10 MINUTES,  
8:00am - 9:30am & 3:30pm - 5:30pm MON - FRI

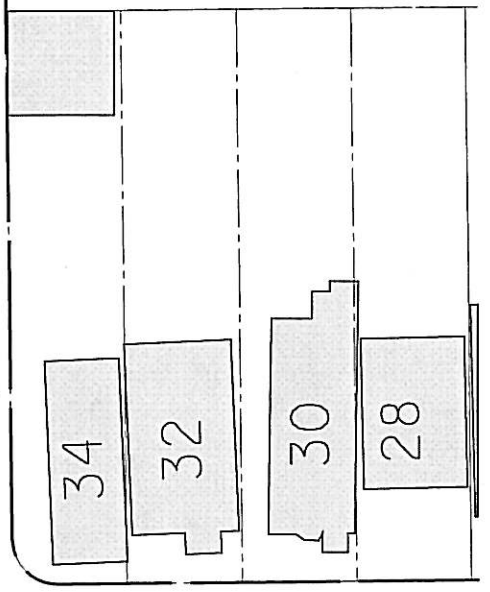
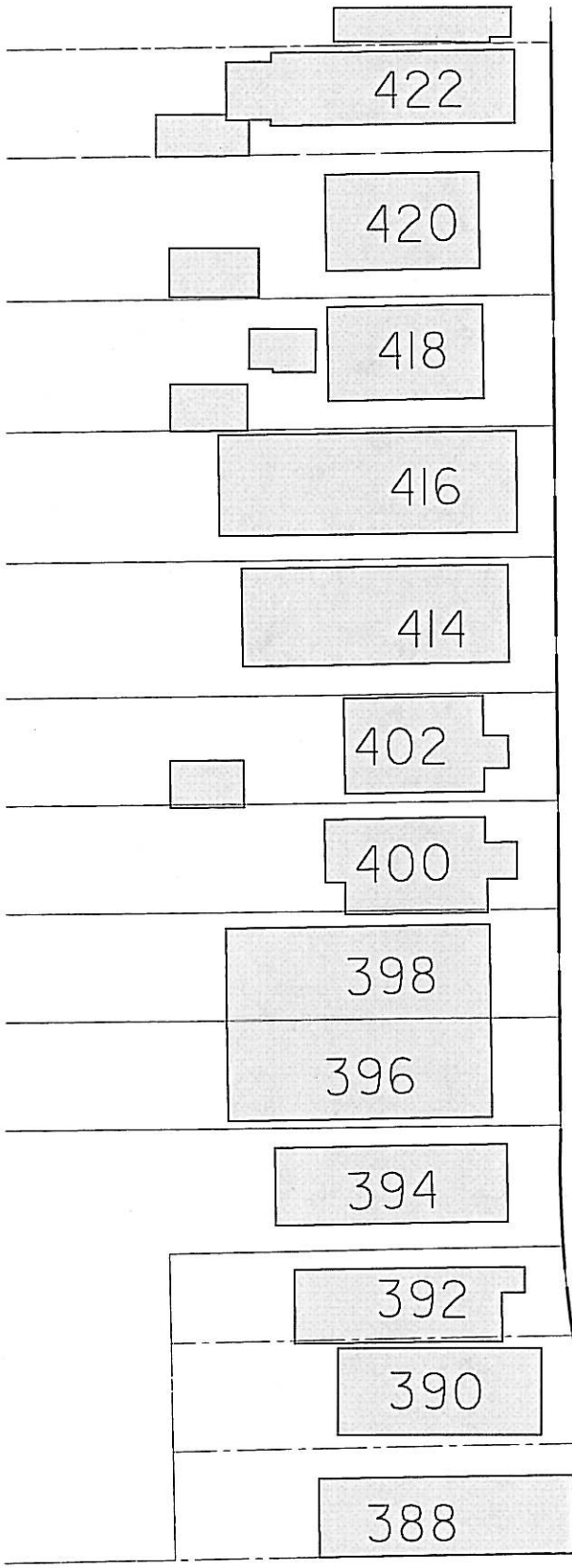

# HARVIE AVENUE NORTH OF ROCHDALE AVENUE PROPOSED DAY CARE PICK-UP / DROP-OFF AREA

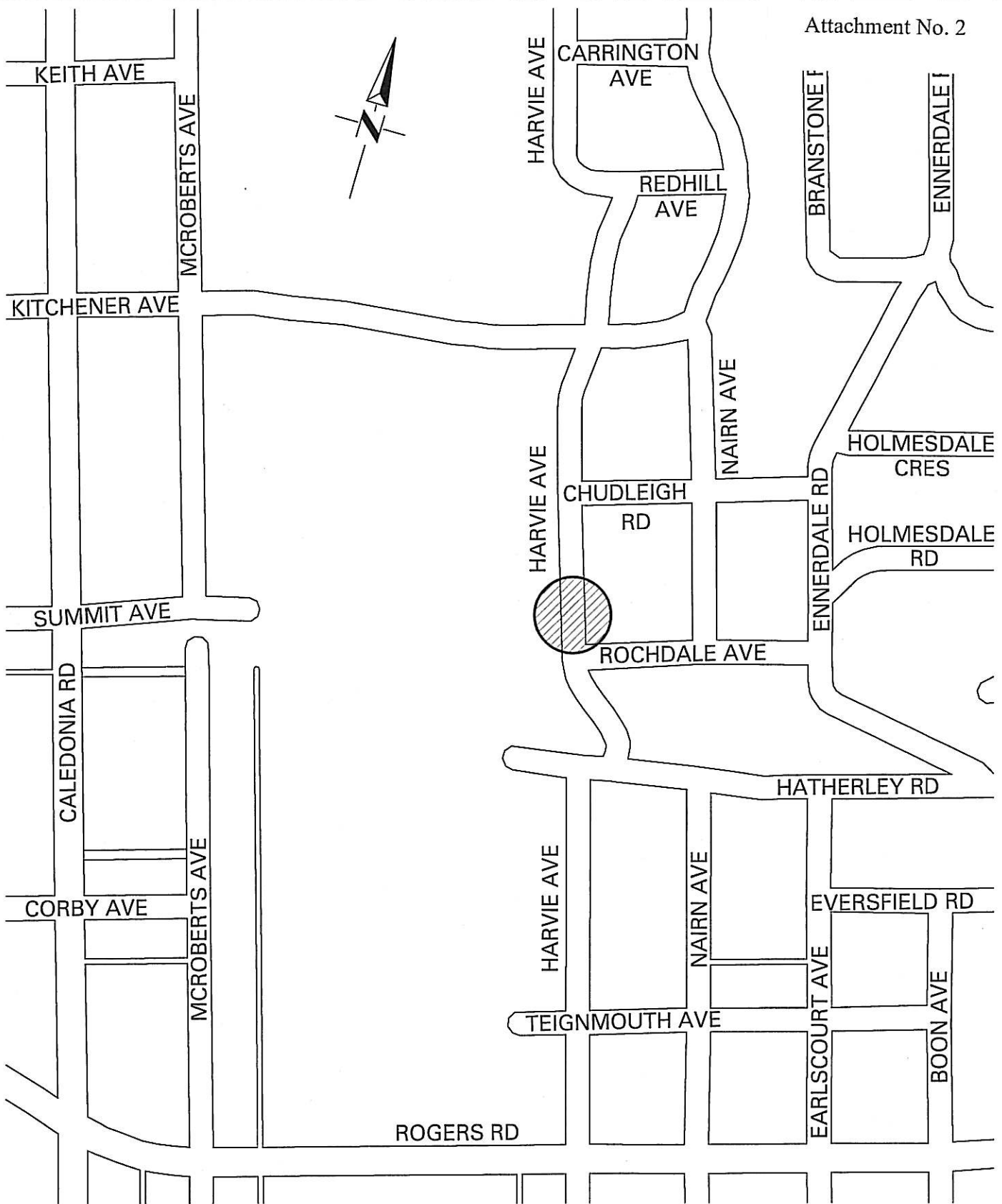

# HARVIE AVENUE NORTH OF ROCHDALE AVENUE LOCATION PLAN

