

NOTE :

EVERY ATTEMPT WILL BE MADE TO UTILIZE EXISTING POLES FOR SPEED HUMP SIGNS, HOWEVER IT MAY BE NECESSARY TO INSTALL NEW POLES FOR THESE SIGNS.

SPEED HUMPS MAY NOT BE CONSTRUCTED EXACTLY IN THE LOCATIONS SHOWN DUE TO FIELD CONDITIONS.



LEGEND

- PROPOSED SPEED HUMP
- TRAFFIC CONTROL SIGNAL
- ALL-WAY STOP SIGN
- A
- B

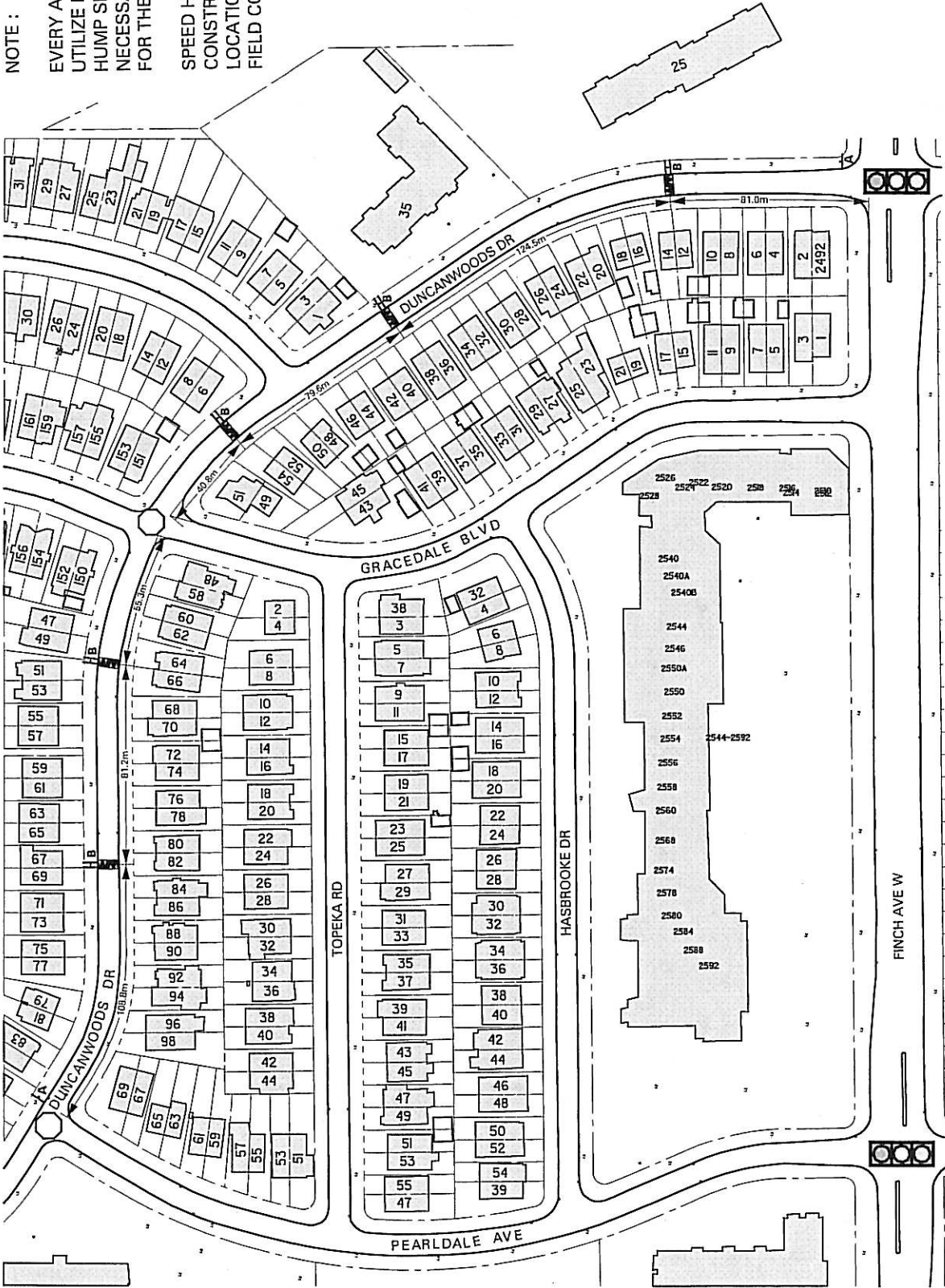

DUNCANWOODS DRIVE:
PEARLDALE AVENUE - FINCH AVENUE WEST
PROPOSED SPEED HUMP LOCATIONS



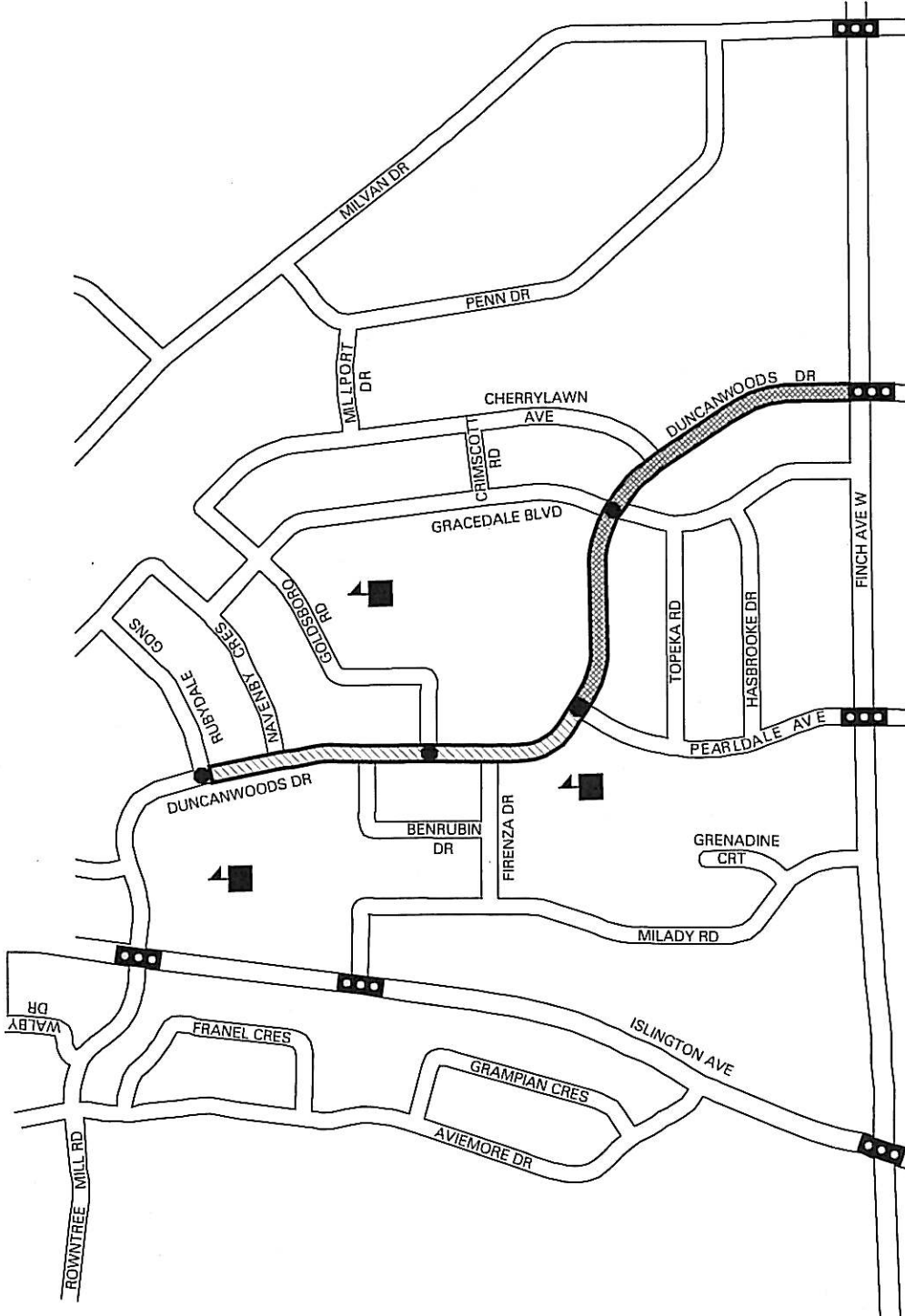

- EXISTING SPEED HUMPS AREA
- PROPOSED SPEED HUMPS AREA

- ALL-WAY STOPS
- TRAFFIC CONTROL SIGNAL

DUNCANWOODS DRIVE AREA MAP

