

Appendix "C"

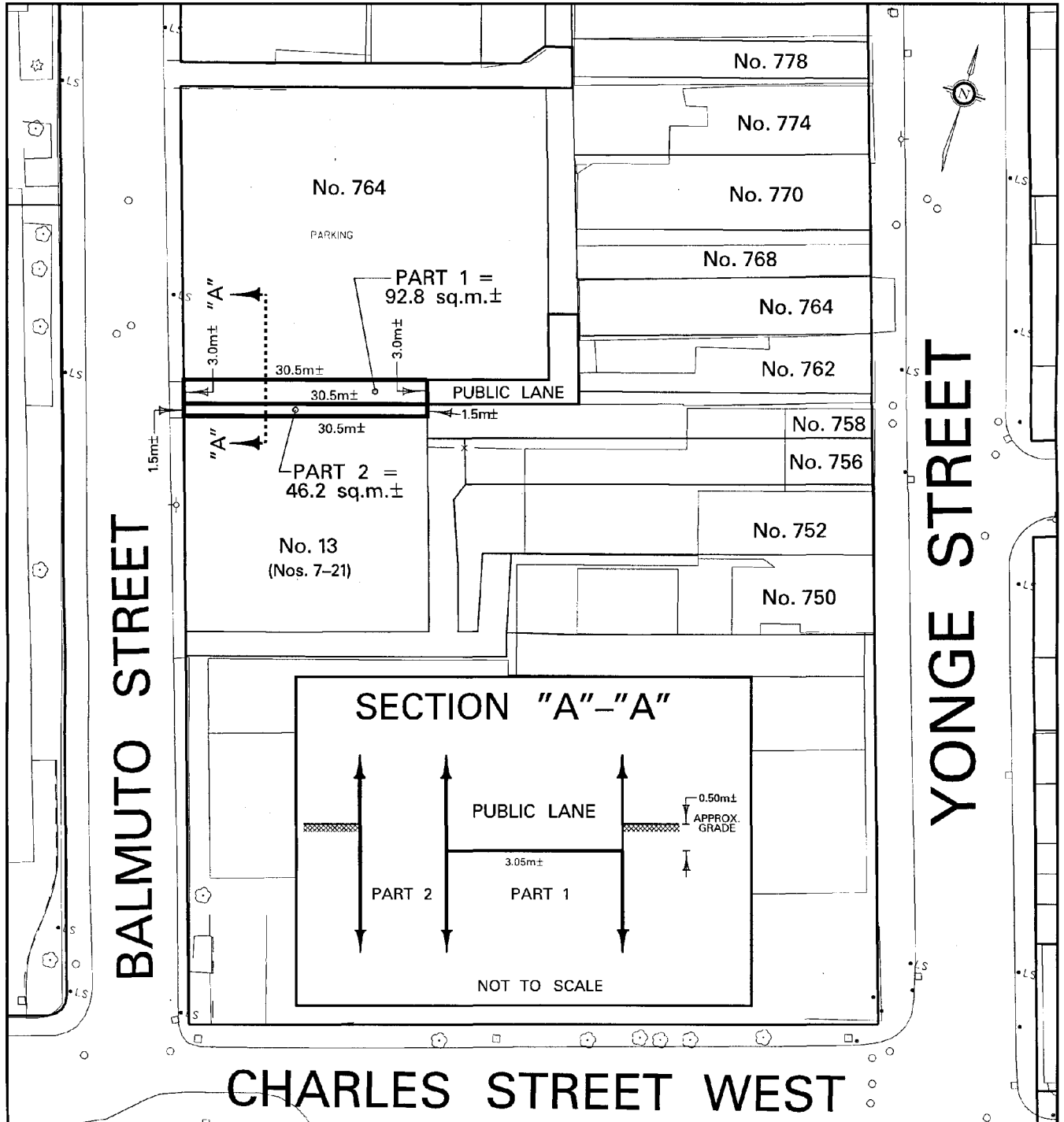

Toronto

TECHNICAL SERVICES DIVISION
SURVEY & MAPPING SERVICES

NOTE:

THIS SKETCH HAS BEEN COMPILED FROM OFFICE RECORDS.

NOT TO SCALE

PROPERTY INFORMATION SHEET

PROPOSED CLOSURE AND SALE OF THE
BELOW GRADE PORTION OF THE PUBLIC LANE
, ABUTTING Nos. 7-21 BALMUTO STREET

WARD 27 - TORONTO CENTRE-ROSEDALE

DATE: AUG. 28, 2006

SKETCH No. PS-2006-111