

JANE ST

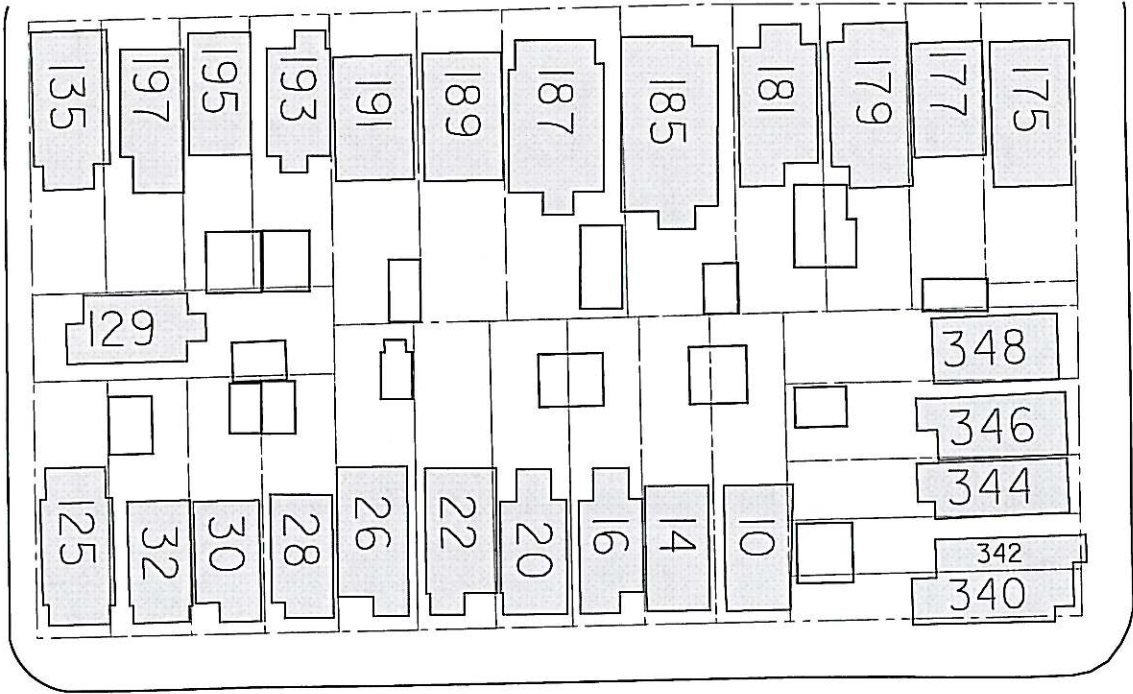

NELLES AVE

ARMADALE AVE

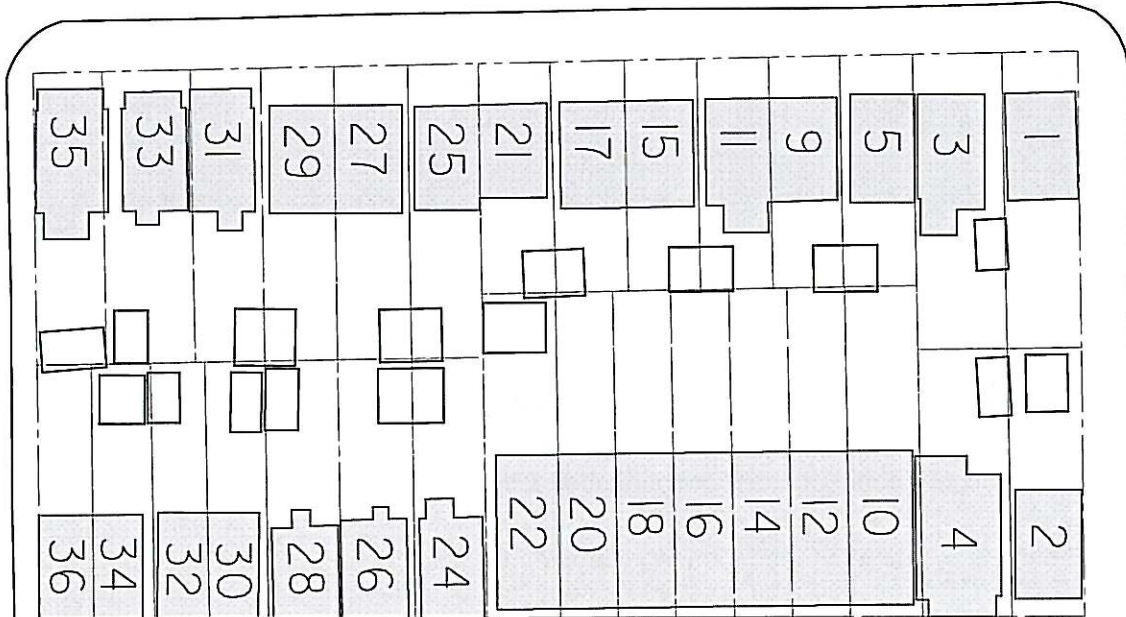

10 NELLES AVENUE  
FRONT YARD PARKING

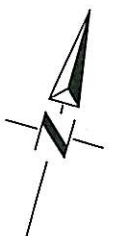

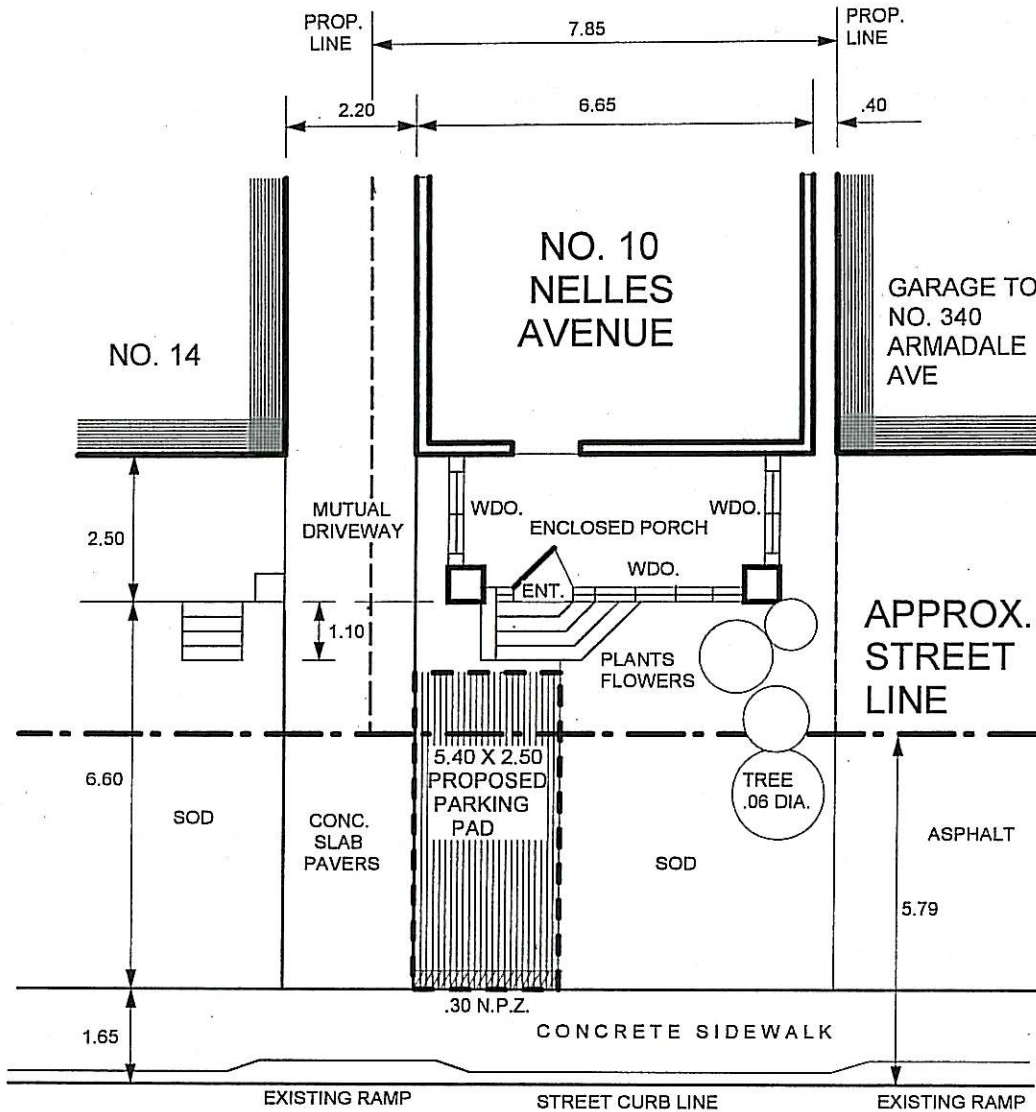

# NELLES AVENUE

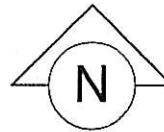

FRONT YARD PARKING					
FOR: MR. DOUGLAS ANDREW MORROW					
LOCATION: NO. 10 NELLES AVE., TORONTO					
ABOVE STREET LINE			BELOW STREET LINE		
TOT. AREA	18.67 SM	100%	100%	TOT. AREA	32.49 SM
PAVED AREA	9.05 SM	48.5%	41.4%	PAVED AREA	13.45 SM
TOT. LOS AREA	9.62 SM	51.5%	58.6%	TOT. LOS AREA	19.03 SM
DATE DRAWN : JULY 20, 2007			NOTE:		
REVISED DATE : *****					
SCALE : 1 : 100 METERS					



