

**Fence Exemption Request
911 Islington Avenue**

Date:	September 18, 2008
To:	Etobicoke York Community Council
From:	Curtis Sealock, Manager, Municipal Licensing and Standards
Wards:	Ward 5, Etobicoke Lakeshore
Reference Number:	ML&S Folder Number 07 282514 FEN

SUMMARY

This staff report is in response to an application for a fence exemption to maintain an existing driveway gate measuring approximately 2.79 metres at the front of 911 Islington Avenue, for which the Etobicoke York Community Council has delegated authority from City Council to make a final decision.

RECOMMENDATIONS

Municipal Licensing and Standards recommend that The Etobicoke York Community Council refuse the application, as the proposed fence does not comply with the provisions of Toronto Municipal Code Chapter 447, Fences.

Financial Impact

There are no financial implications resulting from adoption of this report.

ISSUE BACKGROUND

Municipal Licensing and Standards received an application from the property owner, Mr. Jakub Wisniewski, to maintain an existing decorative 2.79 metre high wood gate that extends 3.66 metres across the width of the driveway. The rest of the fence is 1.90 metres high.

The existing decorative gate which is attached to the side wall of the dwelling is approximately 2.79 metres in height and set back approximately 5.64 metres from the rear face of the sidewalk (Attachments 1, 2 and 3).

COMMENTS

This Fence Exemption request is to maintain an existing decorative wood gate across the driveway of this property. The gate does not comply with the City of Toronto Municipal Code, Chapter 447, Fences, Subsection 2, as the height of the gate is 0.79 of a metre higher than the permitted height of 2.00 metres, and is considered as part of the fence when determining the height of a fence.

CONTACT

John Romano, Supervisor
Etobicoke York District
Municipal Licensing and Standards
Tel: 416-394-2536 Fax: 416-394-2904
E-mail: jromano@toronto.ca

SIGNATURE

Curtis Sealock, District Manager
Etobicoke York District

ATTACHMENTS

Attachment 1: Site Plan
Attachment 2: Aerial map of the property and plans of the gate
Attachment 3: Photograph of the front of the property and the gate

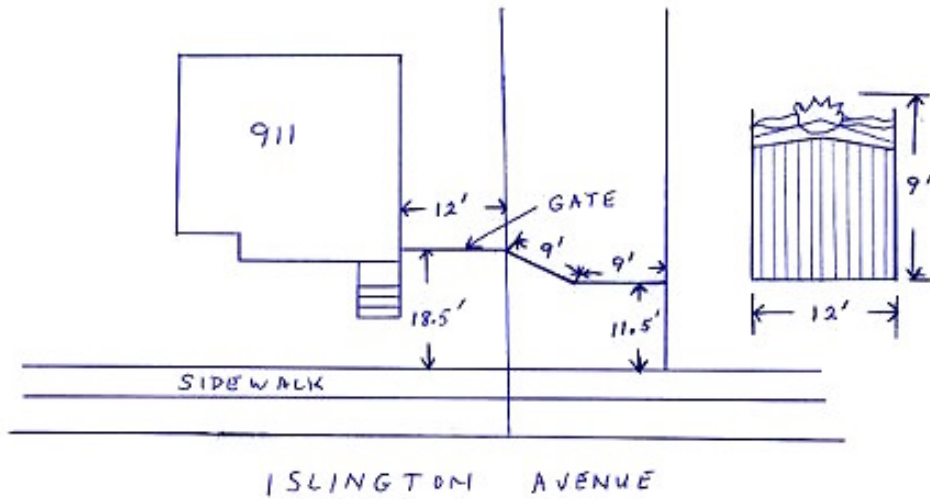

(For Illustration Only – Not to Scale)

Attachment 2: Aerial map of the property and plans of the gate



Attachment 3: Photograph of the front of the property and the gate