

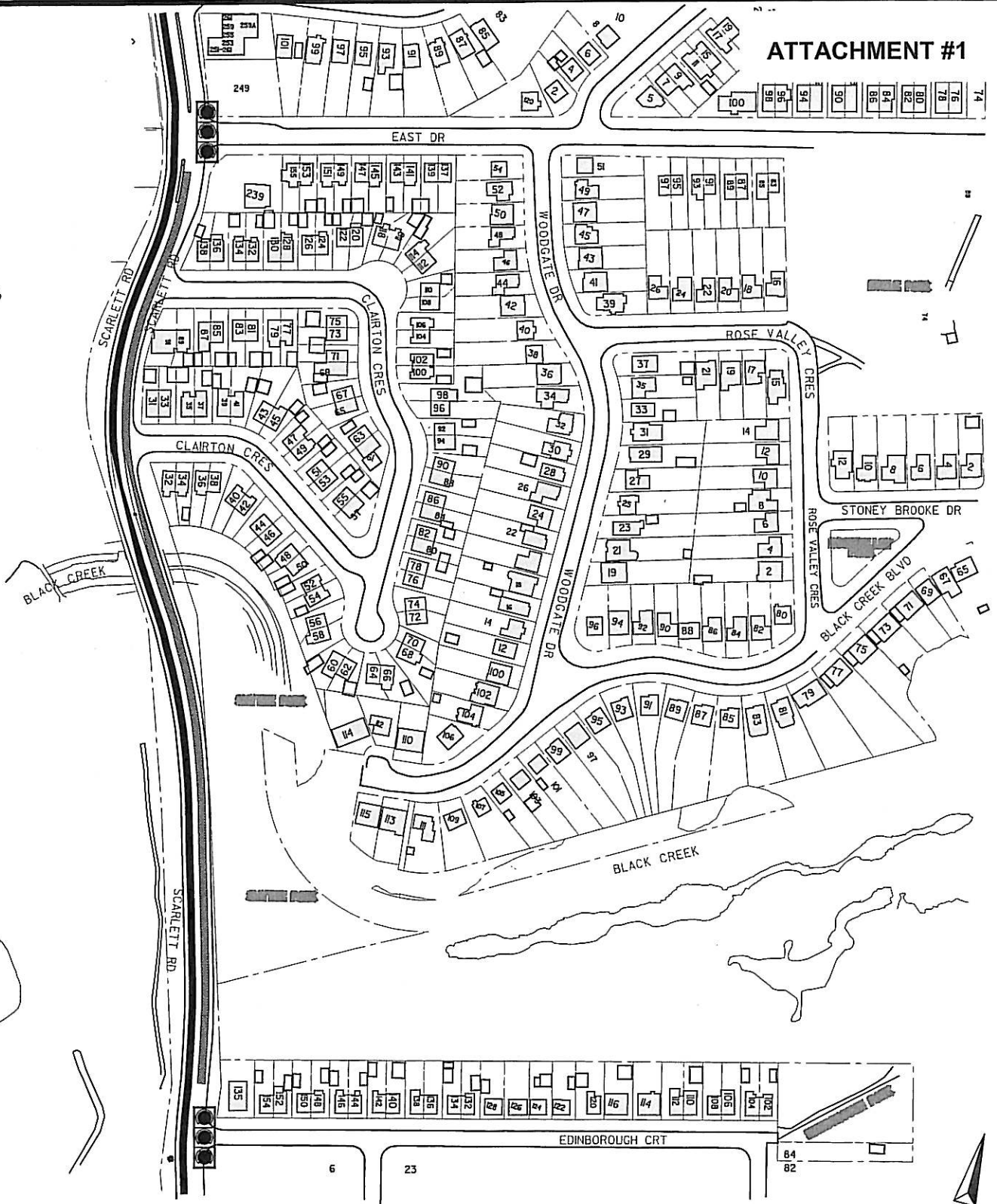



ATTACHMENT #1



-  EXISTING 50 km SPEED
-  PROPOSED 40 km SPEED
-  EXISTING TRAFFIC CONTROL SIGNALS

**SCARLETT RD BETWEEN EAST DR AND EDINBOROUGH CRT
SPEED LIMIT AMENDMENT FROM 50 km TO 40 km**

