

ny08076_map1

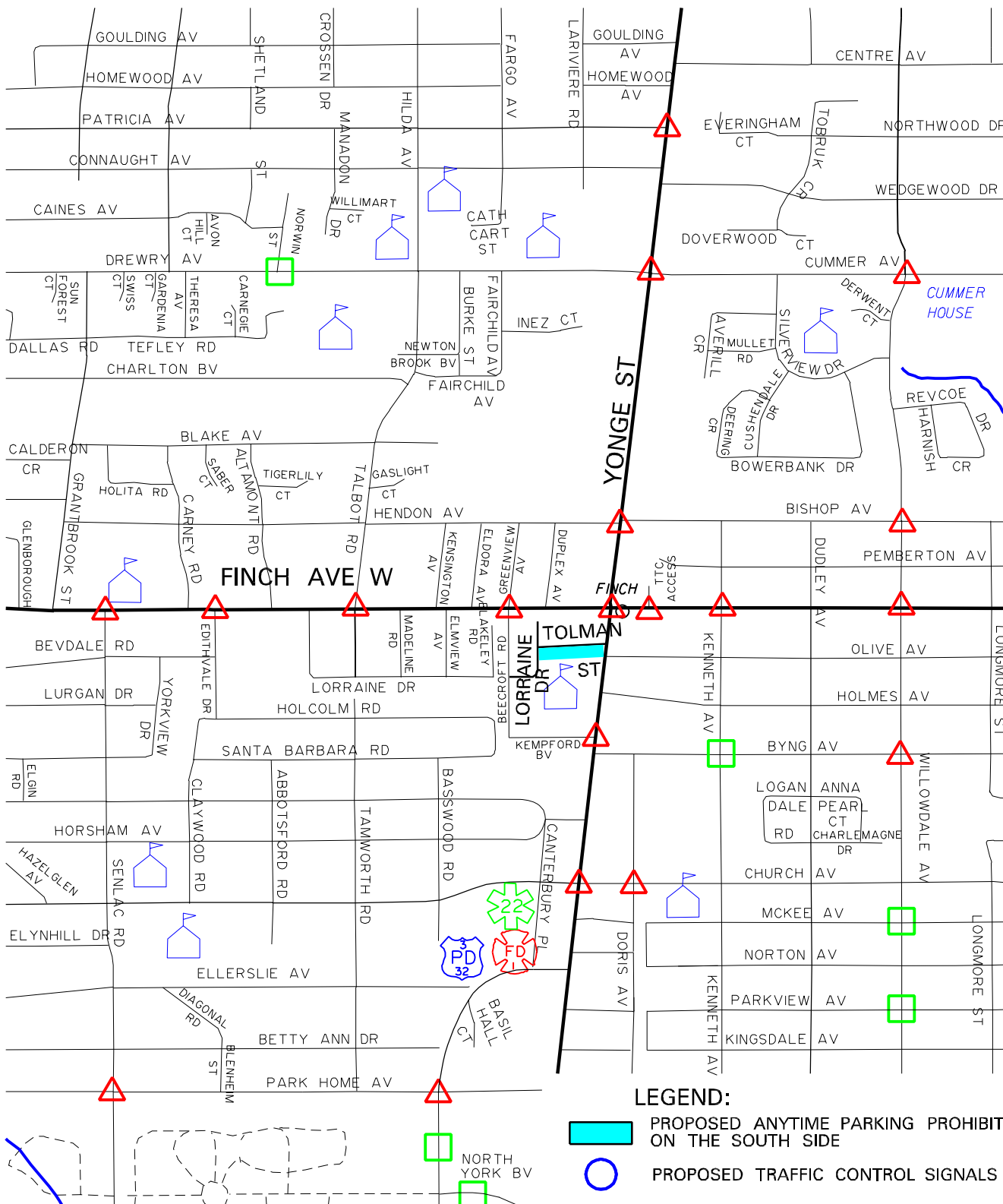

LEGEND:

- PROPOSED ANYTIME PARKING PROHIBITION ON THE SOUTH SIDE
- PROPOSED TRAFFIC CONTROL SIGNALS
- TRAFFIC CONTROL SIGNALS
- PEDESTRIAN CROSSOVER



LOCATION
TOLMAN STREET FROM
YONGE STREET TO LORRAINE AVENUE
PARKING PROHIBITION