

FRONT YARD PARKING APPEAL

126 BALSAM AVE

APPENDIX 'D'

LANDSCAPE PROPOSAL: 126 BALSAM AVENUE

STONEHENGE • DESIGN • BUILD

1/0" = 1/4" ± 09/08

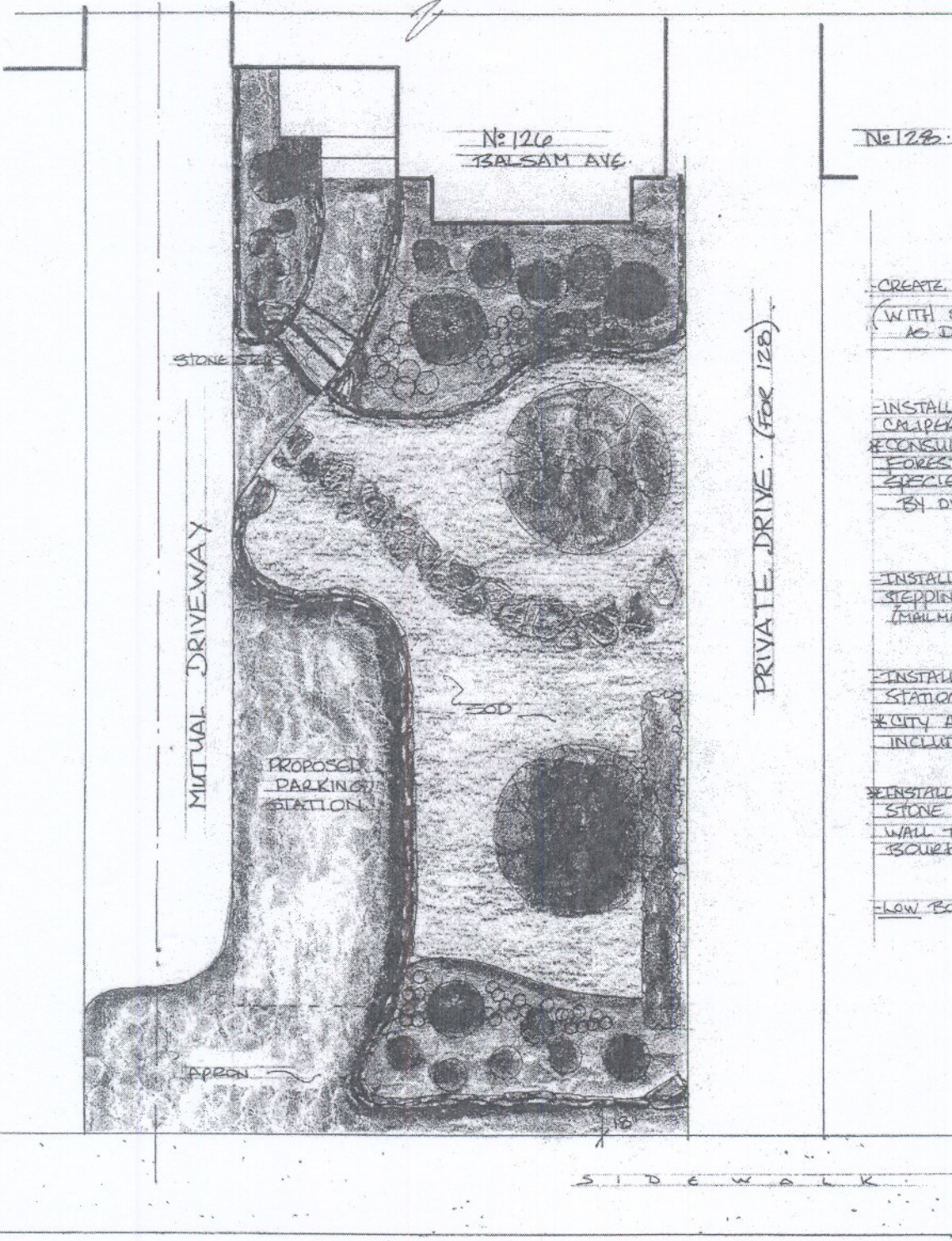

No 126

CREATE PLANTING BEDS  
(WITH STONE EDGING)  
AS DESIRED.

INSTALL TWO LARGE  
CAMPER TREES  
CONSULT WITH URBAN  
FOREST FOR DESIRED  
SPECIES.  
BY OWNER.

INSTALL RANDOM FLAG  
STEPPING STONES  
(MAILMAN ROUTE).

INSTALL PARKING  
STATION AS REQUIRED  
CITY APPROVED PAVERS  
INCLUDING 'APRON'

INSTALL LOW NATURAL  
STONE RETAINING  
WALL TO SUIT NEIGH.  
BOURHOOD.

LOW BOXWOOD HEDGE