

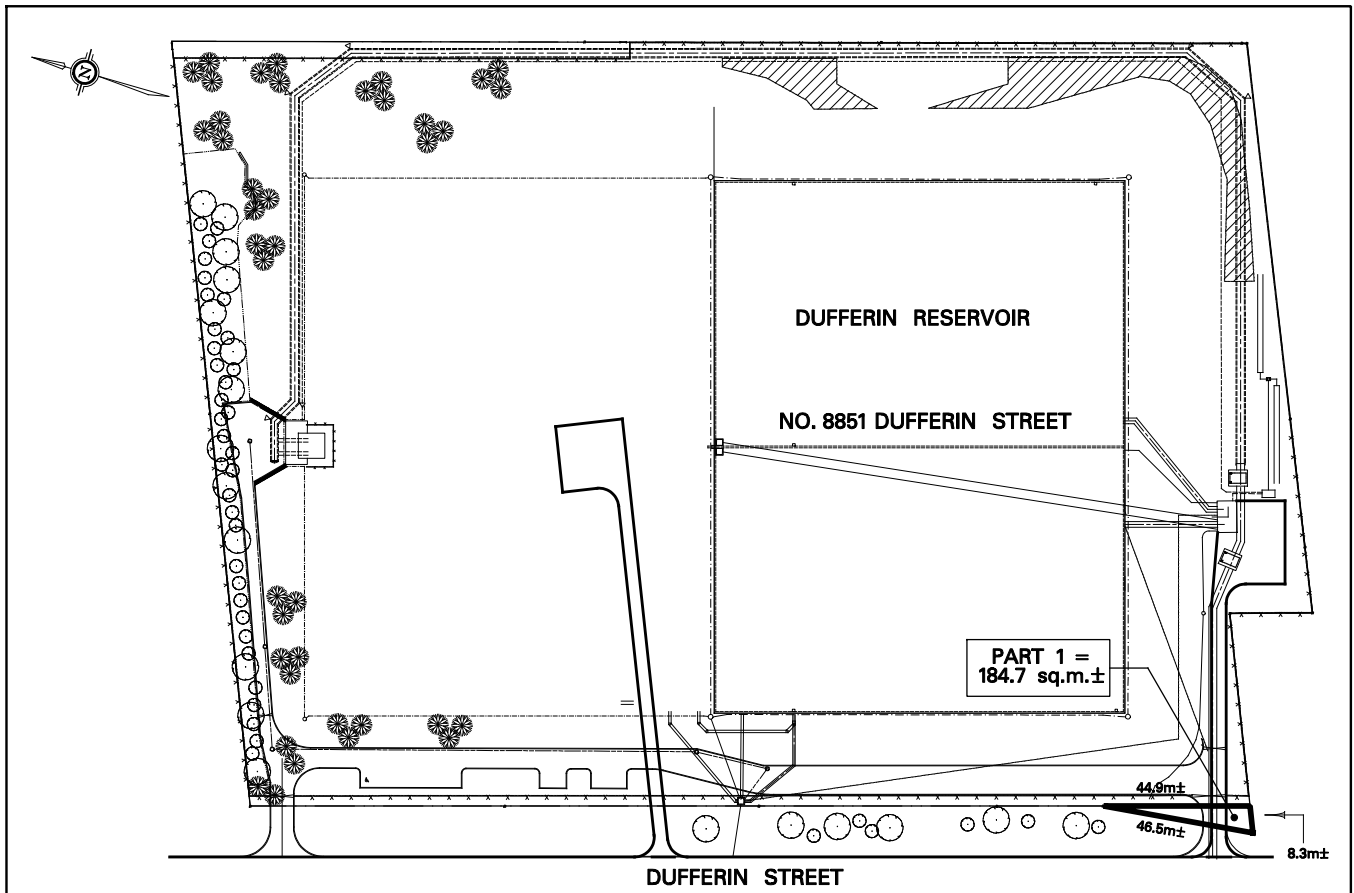

Appendix "A"

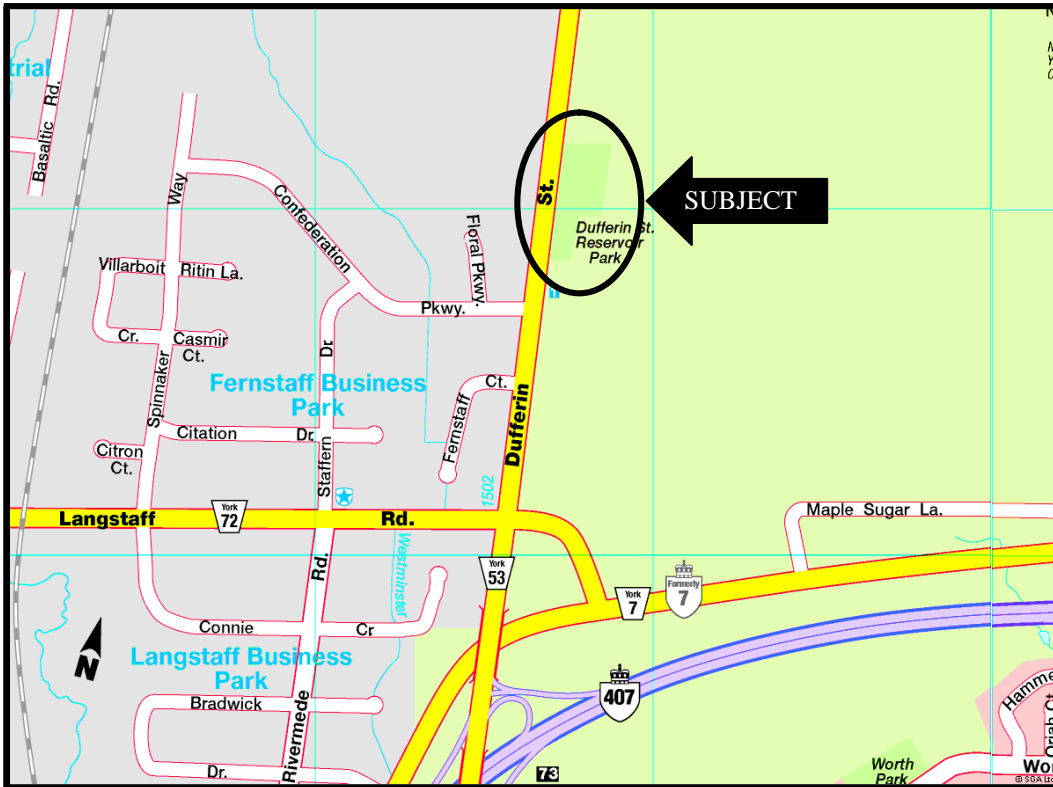

 <p>TECHNICAL SERVICES DIVISION SURVEY & MAPPING SERVICES</p>	<p>NOTE: THIS SKETCH HAS BEEN COMPILED FROM OFFICE RECORDS</p>	<p>PROPERTY INFORMATION SHEET</p> <p>CITY OWNED LAND</p> <p>SKETCH SHOWING A PORTION OF DUFFERIN RESERVOIR (NO. 8851 DUFFERIN STREET) REQUIRED BY THE REGION OF YORK FOR ROAD WIDENING PURPOSES</p>	
	<p>NOT TO SCALE</p>	<p>WARD N/A</p> <p>DATE: JANUARY 30, 2009</p>	<p>SKETCH No. PS-2009-019</p>
<p>PREPARED BY: DWAYNE PITT</p>	<p>CHECKED BY: JOHN HOUSE</p>		