

ITEM NY 25.10 - ATTACHMENT TO MOTION SUBMITTED BY COUNCILOR PERRUZZA

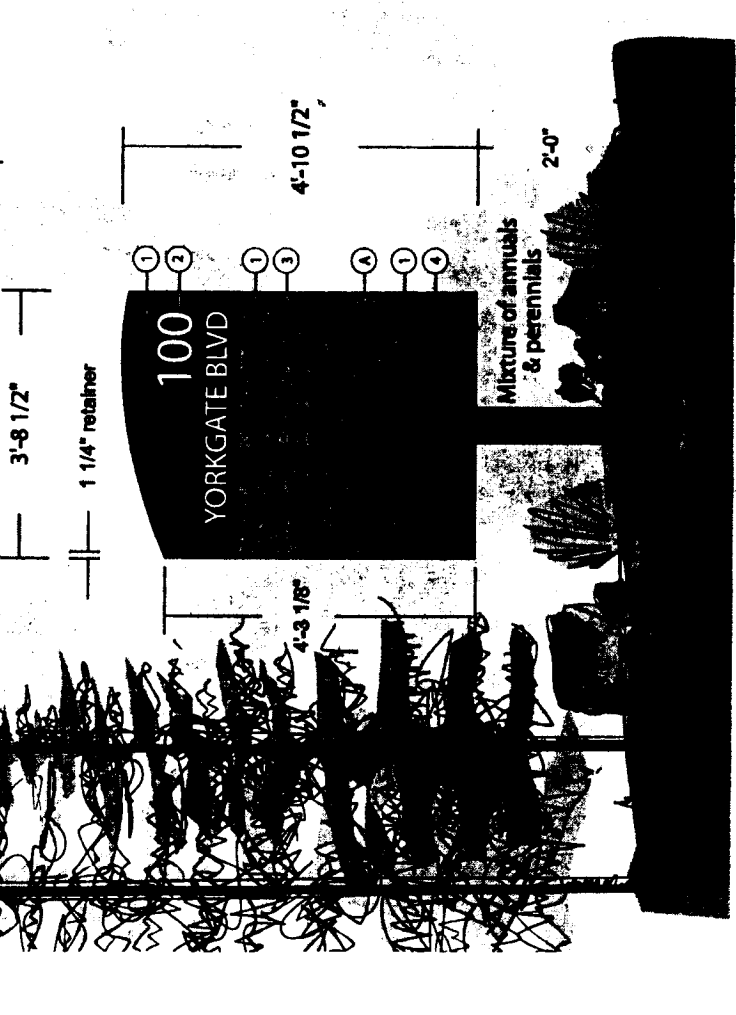

16± sq.ft.
Supply & install (1) one double face illuminated pylon sign
 Installed at 100 Yorkgate Blvd.
 Aluminum fabricated custom cabinet painted satin black
 Clear lexan faces with 3M vinyl applied graphics second surface
 Graphics backed up with white diffuser vinyl
 H.O. Daylight fluorescent illumination
 Single pole support. Visible pole to be painted satin black
 New concrete base required
 Installation location to be determined

- ① 3M 3630-22 Black (Opaque background & all graphics on green field)
- ② 3M 3630-20 white vinyl
- ③ 3M 3630-106 Brilliant Green (Translucent field)
- ④ 3M 3630-51 Silver Grey (Translucent)
- 3M 3630-106 Brilliant Green (Translucent)
- 3M 3630-33 Red (Translucent)
- 3M 3630-25 Sunflower (Translucent)

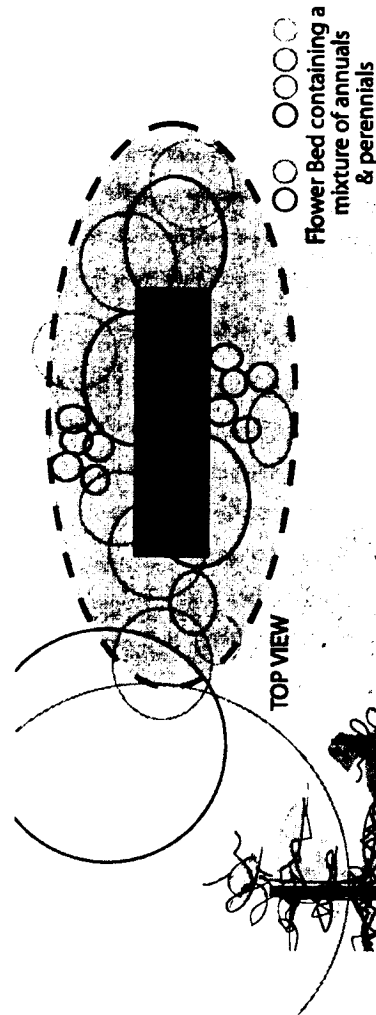
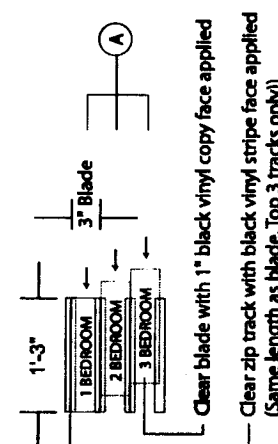

Opposite Side
 Clear blade with 1" black vinyl copy face applied
 Clear zip track with black vinyl stripe face applied
 (Same length as blade. Top 3 tracks only)
 * Note: Clear tracks glued to face of clear acrylic. Install stoppers on ends of tracks to prevent faces from being vandalized or blown out by strong winds.

Job No. _____

Version #: MCAIR0001
 Date: 14-APR-08
 Design #: 08-0478
 Scale: 1/2"=1'-0"
 Sales: P. Brown
 Designer: R. Ferraro/CM

Rev. #: _____
 Date: _____

Vector Artwork Required
 High Resolution Image Required
 Final Colours Required

Conceptual artwork only

Electrical Requirements
 120V 240V
 Other _____

Customer Approval
 Date: _____

mcarthur properties
 100 Yorkgate Blvd
 Toronto, ON.
MASTER

333 Sheppard Ave. East
 Toronto, Ontario, Canada M1E 4B3
 www.patison.com

Tel: (416) 759-1111
 Fax: (416) 759-9955
 Toll Free: 1-800-388-8236

The artistic works depicted herein are copyrighted and are the exclusive property of Pattison Sign Group and all such content is reproduced in whole or in part without prior written consent.



Patison Sign Group signs illuminated by fluorescent tubes under LED lenses contain mercury and phosphor. Dispose of these lamps according to local, state, and federal laws.