

# 544 KING STREET WEST OCTOBER 31, 2008 COMMITTEE OF ADJUSTMENT RESUBMISSION

## LIST OF DRAWINGS:

- A 0.1 STATISTICS & CONTEXT PLAN
- A 1.0 GROUND FLOOR PLAN
- A 1.1 MEZZANINE FLOOR PLAN
- A 1.2 2nd FLOOR PLAN
- A 1.3 3rd FLOOR PLAN
- A 1.4 4th-6th FLOOR PLAN
- A 1.5 7-8th FLOOR PLAN
- A 1.6 9th FLOOR PLAN
- A 4.1 EAST ELEVATION
- A 4.2 WEST ELEVATION
- A 4.3 SOUTH & NORTH ELEVATIONS
- A 4.4 SOUTH ELEVATION
- A 4.5 NORTH ELEVATION
- A 5.1 NORTH/SOUTH CROSS SECTION
- A 5.2 EAST/WEST CROSS SECTION



The 544 King St. W. proposal in context with Zoe's at 548 King, the proposed Fashion House at 570 King, and an anticipated redevelopment as per zoning bylaw at 540 King.

### DRAWING NOT TO BE SCALED

Contractor must check and verify all dimensions on the job and report any discrepancies to the architect before proceeding with the work.

This drawing shall not be used for construction purposes until signed by the consultant responsible. This drawing, as an instrument of service, is provided by and is the property of Sweeney Sterling Finlayson & Co. Architects.

### ISSUED

08/07/10 Preliminary Project Review  
08/09/10 Committee of Adjustment  
08/10/31 Committee of Adjustment Resubmission

XXXXXXX Revised

### REVISED



468 Wellington St. W. P +1 416 971 6252  
Suite 200 F +1 416 971 5420  
Toronto, ON info@andco.com  
Canada M5V 1E3 www.andco.com  
Sweeney Sterling Finlayson & Co Architects Inc.

544 King St. W.  
1-9 Morrison St.  
Toronto, Ont.

Allied Properties REIT  
Toronto, Ont.

Dwg. Title :

### TITLE SHEET

DATE : 08-08-15  
SCALE : NTS  
DRAWN : AJ  
CHECKED : MV  
PROJECT NO. : 0817

Dwg. No. :

A0.0

**SITE STATISTICS:**

**ZONING CATEGORY:** RA H23.0

**LOT AREA:** 1,793 SM. (19,300 sqft.)

**GROSS NON-RESIDENTIAL FLOOR AREA:**

**GROUND FLOOR** 587 SM ( 6,319 sqft.)  
**MEZZ. FLOOR** 722 SM ( 7,772 sqft.)  
**2nd FLOOR** 1,651 SM ( 17,764 sqft.)  
**3rd FLOOR** 1,550 SM ( 16,677 sqft.)  
**4th FLOOR** 1,550 SM ( 16,677 sqft.)  
**5th FLOOR** 1,550 SM ( 16,677 sqft.)  
**6th FLOOR** 1,550 SM ( 16,677 sqft.)  
**7th FLOOR** 1,496 SM ( 16,096 sqft.)  
**8th FLOOR** 1,496 SM ( 16,096 sqft.)  
**9th FLOOR** 792 SM ( 8,522 sqft.)

**TOTAL**  
**NON-RESIDENTIAL GFA:** 12,944 SM (139,276 sqft)

**DENSITY:** NO DENSITY RESTRICTIONS

**PARKING REQUIREMENTS:**

Office - Downtown 1 @ 300SM = 44

**PARKING PROPOSED:**

16-Triple Parking Stackers (16X3) for commercial = 48  
 5-Parallel Parking Spaces = 5  
 1-Handicapped Space = 1  
**TOTAL PARKING SPACES PROVIDED** 54

**BIKE PARKING REQUIRED AND PROVIDED:**

Office - Downtown 1@1,250 SM = 11

**SETBACKS REQUIREMENTS:**

**FRONT:** 0m (3m setback at 20.0m above grade)  
 Front 25M Zero Lot Line Permission  
**REAR:** 7.5m  
**EAST:** 7.5m(after 25m depth)  
**WEST:** 7.5m(after 25m depth)  
 Setback from CenteLine of Public Lane = 3m in RA district

**SETBACKS PROPOSED:**

**FRONT:** 0m (3m @ 25.8m above grade)  
**REAR:** 0m  
**EAST:** 0m  
**WEST:** 0m  
 Setback from CenteLine of Public Lane = 3m

**HEIGHT PERMITTED:**

23.0m + 5.0m MECH. PENTHOUSE ALLOWANCE  
 = 28.0m TOTAL BUILDING HEIGHT  
 (INCLUDING WRAPPED PENTHOUSE)

**HEIGHT PROPOSED SOUTH TOWER:**

Ground Floor @ 6.18m + 6 Storeys @ 3.8m + 1 Storey @ 3.775m +  
 Elevator Overrun @ 0.85m  
**TOTAL:** 33.605m

**HEIGHT PROPOSED NORTH TOWER:**

Ground Floor @ 5.6m + 6 Storeys @ 3.8m + 2 Storeys @ 3.775m +  
 Elevator Overrun @ 0.85m  
**TOTAL:** 36.8m

**NON-RESIDENTIAL LOADING PROPOSED AND REQUIRED:**

**REQUIRED:** Office - Downtown 1 Type "A", 3 Type "B"  
**PROPOSED:** Office - Downtown 1 Type "G", 2 Type "C"



**DRAWING NOT TO BE SCALED**

Contractor must check and verify all dimensions on the job and report any discrepancies to the architect before proceeding with the work.  
 This drawing shall not be used for construction purposes until signed by the consultant responsible. This drawing, as an instrument of service, is provided by and is the property of Sweeney Sterling Finlayson & Co. Architects.

**ISSUED**

08/07/10 Preliminary Project Review  
 08/09/10 Committee of Adjustment  
 08/10/31 Committee of Adjustment Resubmission

XXXXXXX Revised

**REVISED**



468 Wellington St. W. P +1 416 971 6252  
 Suite 200 F +1 416 971 5420  
 Toronto, ON info@andco.com  
 Canada M5V 1E3 www.andco.com  
 Sweeney Sterling Finlayson & Co Architects Inc.

544 King St. W.  
 1-9 Morrison St.  
 Toronto, Ont.

Allied Properties REIT  
 Toronto, Ont.

Dwg. Title :

**TITLE SHEET**

**DATE :** 08-08-15  
**SCALE :** 1:300  
**DRAWN :** AJ  
**CHECKED :** MV  
**PROJECT NO. :** 0817 **A0.1**

I: 2008: 0817 544 King Street West - Drawings - 0817-544 King-L1.dwg | Oct 31, 2008 | 12:08 pm | alexandra

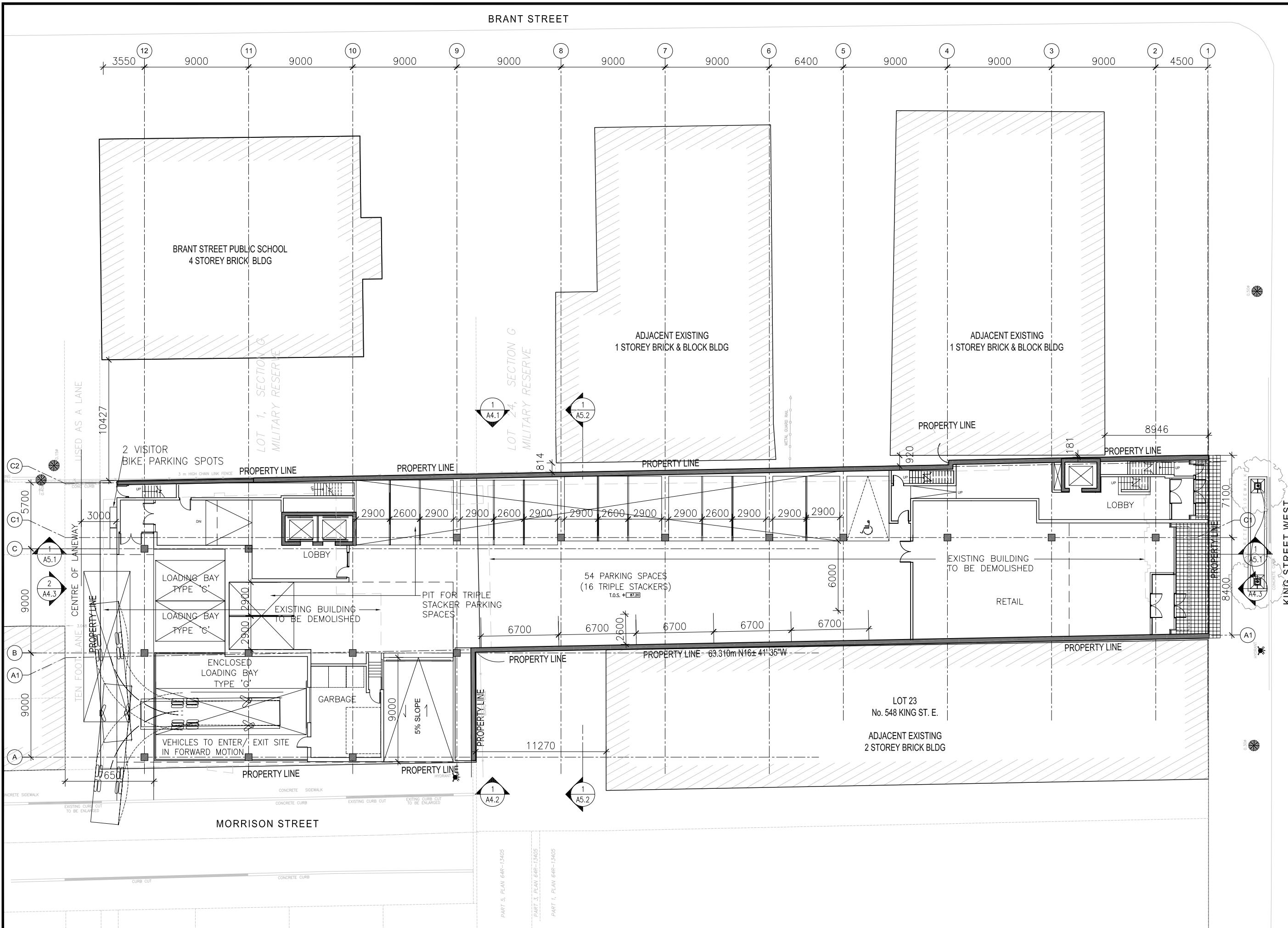

**DRAWING NOT TO BE SCALED**

Contractor must check and verify all dimensions on the job and report any discrepancies to the architect before proceeding with the work.

This drawing shall not be used for construction purposes until signed by the consultant responsible. This drawing, as an instrument of service, is provided by and is the property of Sweeney Sterling Finlayson & Co. Architects.

**ISSUED**

- 08/07/10 Preliminary Project Review
- 08/09/10 Committee of Adjustment
- 08/10/31 Committee of Adjustment Resubmission

XXXXXXXX Revised

**REVISED**

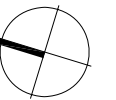

468 Wellington St. W. P +1 416 971 6252  
 Suite 200 F +1 416 971 5420  
 Toronto, ON info@andco.com  
 Canada M5V 1E3 www.andco.com  
 Sweeney Sterling Finlayson & Co Architects Inc.

544 King St. W.  
 1-9 Morrison St.  
 Toronto, Ont.

Allied Properties REIT  
 Toronto, Ont.

Dwg. Title :

**GROUND FLOOR PLAN**

DATE : 08-08-15

SCALE : 1:300

DRAWN : AJ

CHECKED : MV

PROJECT NO. : 0817

Dwg. No. :

**A1.0**

I:\2008\0817 544 King Street West\Drawings\0817-544 king-mezz floor.dwg | Oct 31, 2008 | 1:17 pm | alexandra

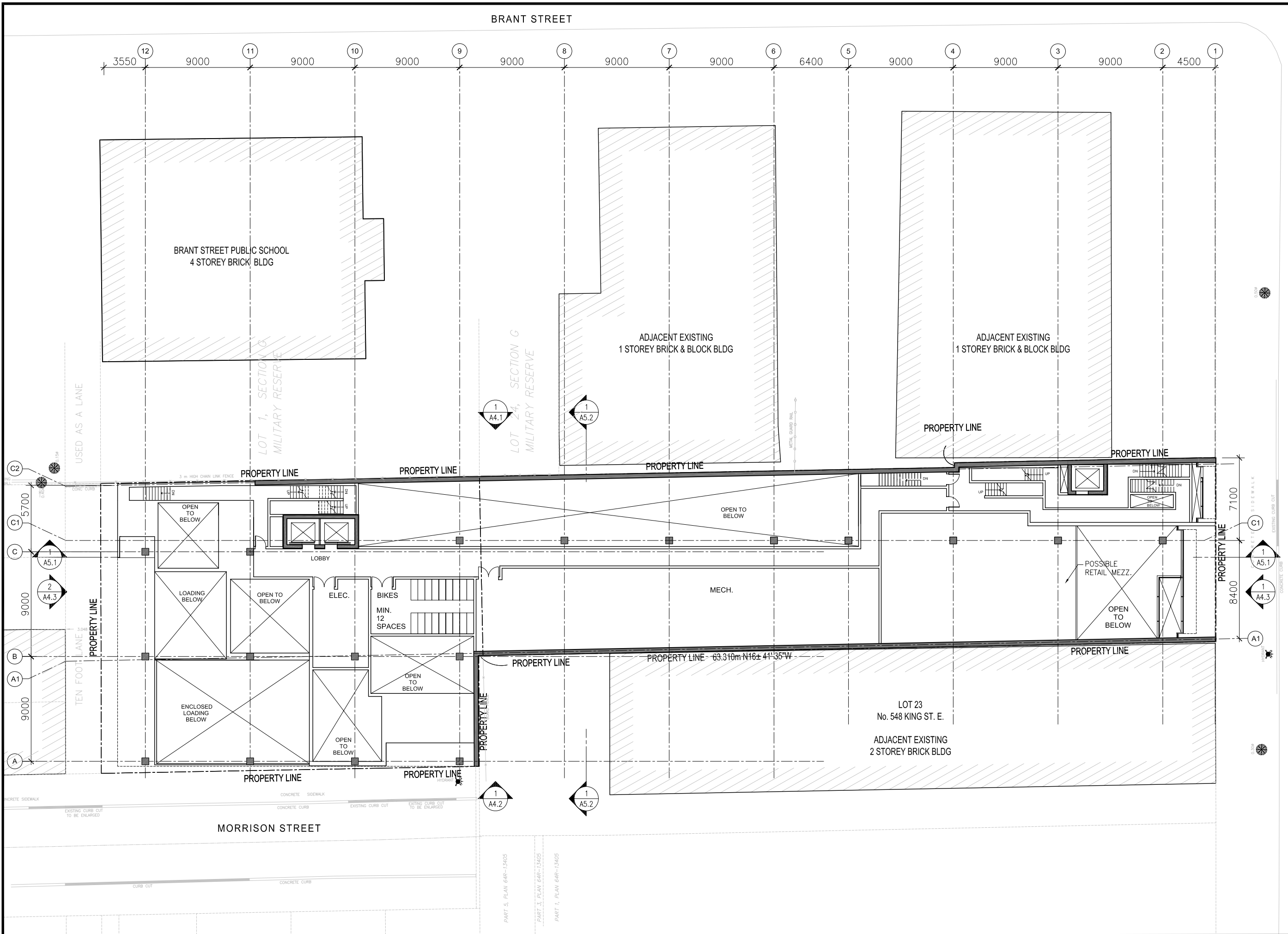

**DRAWING NOT TO BE SCALED**

Contractor must check and verify all dimensions on the job and report any discrepancies to the architect before proceeding with the work.

This drawing shall not be used for construction purposes until signed by the consultant responsible. This drawing, as an instrument of service, is provided by and is the property of Sweeny Sterling Finlayson & Co. Architects.

**ISSUED**

- 08/07/10 Preliminary Project Review
- 08/09/10 Committee of Adjustment
- 08/10/31 Committee of Adjustment Resubmission

XXXXXXXX Revised

**REVISED**

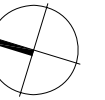

KING STREET WEST



468 Wellington St. W. P +1 416 971 6252  
 Suite 200 Toronto, ON info@andco.com  
 Canada M5V 1E3 www.andco.com  
 Sweeny Sterling Finlayson & Co Architects Inc.

544 King St. W.  
 1-9 Morrison St.  
 Toronto, Ont.

Allied Properties REIT  
 Toronto, Ont.

Dwg. Title :

**MEZZ. FLOOR PLAN**

DATE : 08-08-15  
 SCALE : 1:300  
 DRAWN : AJ  
 CHECKED : MV  
 PROJECT NO. : 0817

Dwg. No. : **A1.1**

I: 2008: 0817 544 King Street West: Drawings: 0817-544 King-L2.dwg | Oct 30, 2008 | 5:25 pm | alexandra

3550 9000 9000 9000 9000 9000 9000 9000 6400 9000 9000 9000 9000 4500

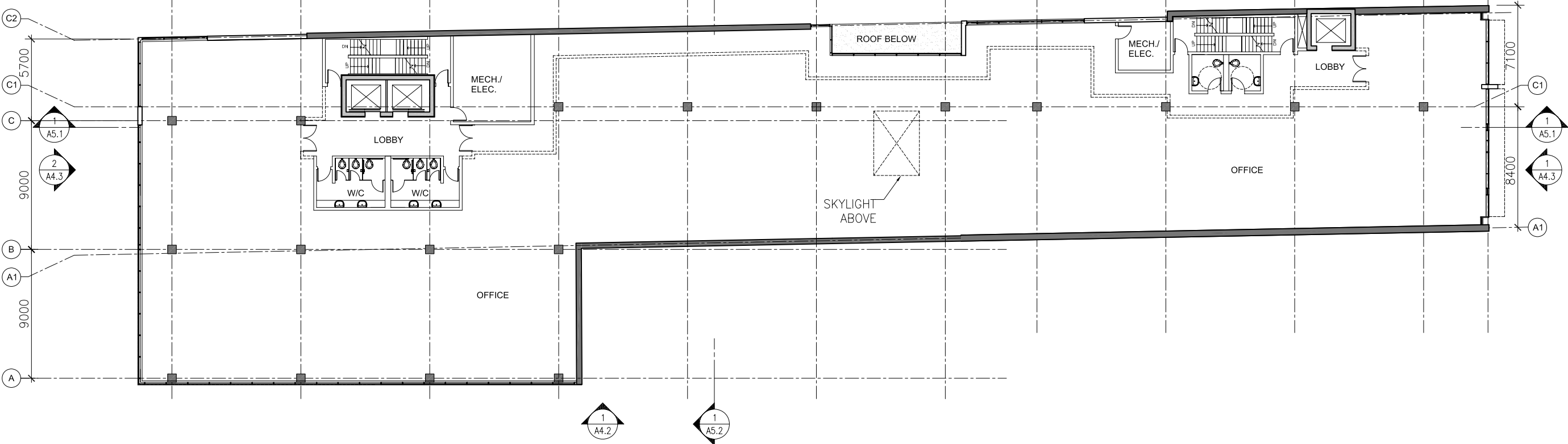

**DRAWING NOT TO BE SCALED**  
Contractor must check and verify all dimensions on the job and report any discrepancies to the architect before proceeding with the work.  
This drawing shall not be used for construction purposes until signed by the consultant responsible. This drawing, as an instrument of service, is provided by and is the property of Sweeney Sterling Finlayson & Co. Architects.

**ISSUED**

08/07/10	Preliminary Project Review
08/09/10	Committee of Adjustment
08/10/31	Committee of Adjustment Resubmission

XXXXXXXX Revised

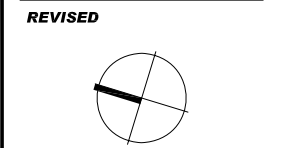

**&Co**

468 Wellington St. W. P +1 416 971 6252  
Suite 200 F +1 416 971 5420  
Toronto, ON info@andco.com  
Canada M5V 1E3 www.andco.com

Sweeney Sterling Finlayson & Co Architects Inc.

544 King St. W.  
1-9 Morrison St.  
Toronto, Ont.

Allied Properties REIT  
Toronto, Ont.

Dwg. Title :  
**2ND FLOOR PLAN**

DATE : 08-08-15  
SCALE : 1:300  
DRAWN : AJ  
CHECKED : MV  
PROJECT NO. : 0817

Dwg. No. :  
**A1.2**

I:\2008\0817 544 King Street West\Drawings\0817-544 king-L3.dwg | Oct 30, 2008 | 5:45 pm | alexandra

**DRAWING NOT TO BE SCALED**

Contractor must check and verify all dimensions on the job and report any discrepancies to the architect before proceeding with the work.  
This drawing shall not be used for construction purposes until signed by the consultant responsible. This drawing, as an instrument of service, is provided by and is the property of Sweeny Sterling Finlayson & Co. Architects.

**ISSUED**

08/07/10 Preliminary Project Review  
08/09/10 Committee of Adjustment  
08/10/31 Committee of Adjustment Resubmission

XXXXXXXX Revised

**REVISED**

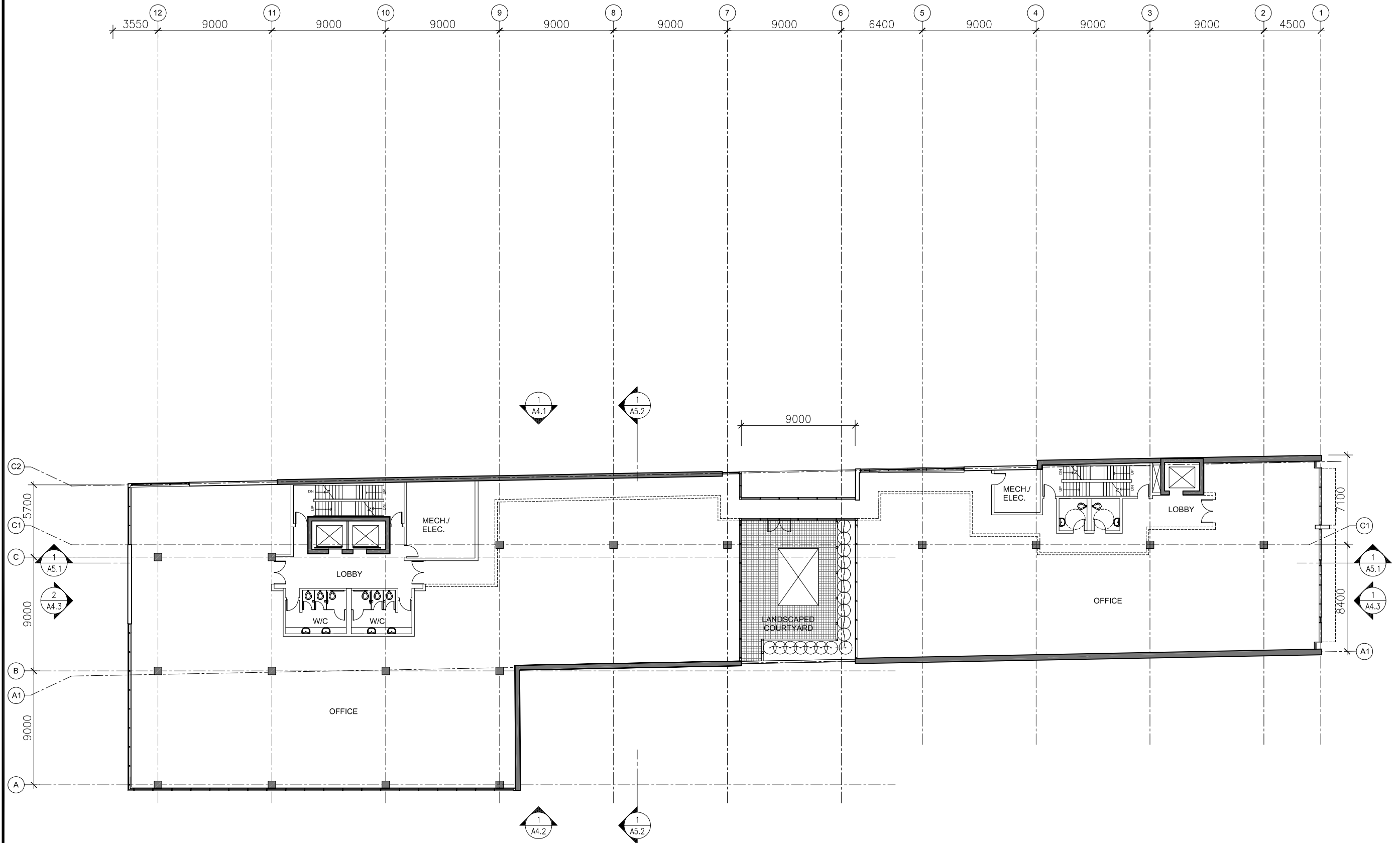
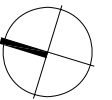

468 Wellington St. W. P +1 416 971 6252  
Suite 200 F +1 416 971 5420  
Toronto, ON info@andco.com  
Canada M5V 1E3 www.andco.com

Sweeny Sterling Finlayson & Co Architects Inc.

544 King St. W.  
1-9 Morrison St.  
Toronto, Ont.

Allied Properties REIT  
Toronto, Ont.

Dwg. Title :

**3RD FLOOR PLAN**

DATE : 08-08-15

SCALE : 1:300

DRAWN : AJ

CHECKED : MV

PROJECT NO. : 0817

Dwg. No. :

A1.3

I: 2008: 0817 544 King Street West: Drawings: 0817-544 King-L3-6.dwg | Oct 30, 2008 | 5:43 pm | alexandra

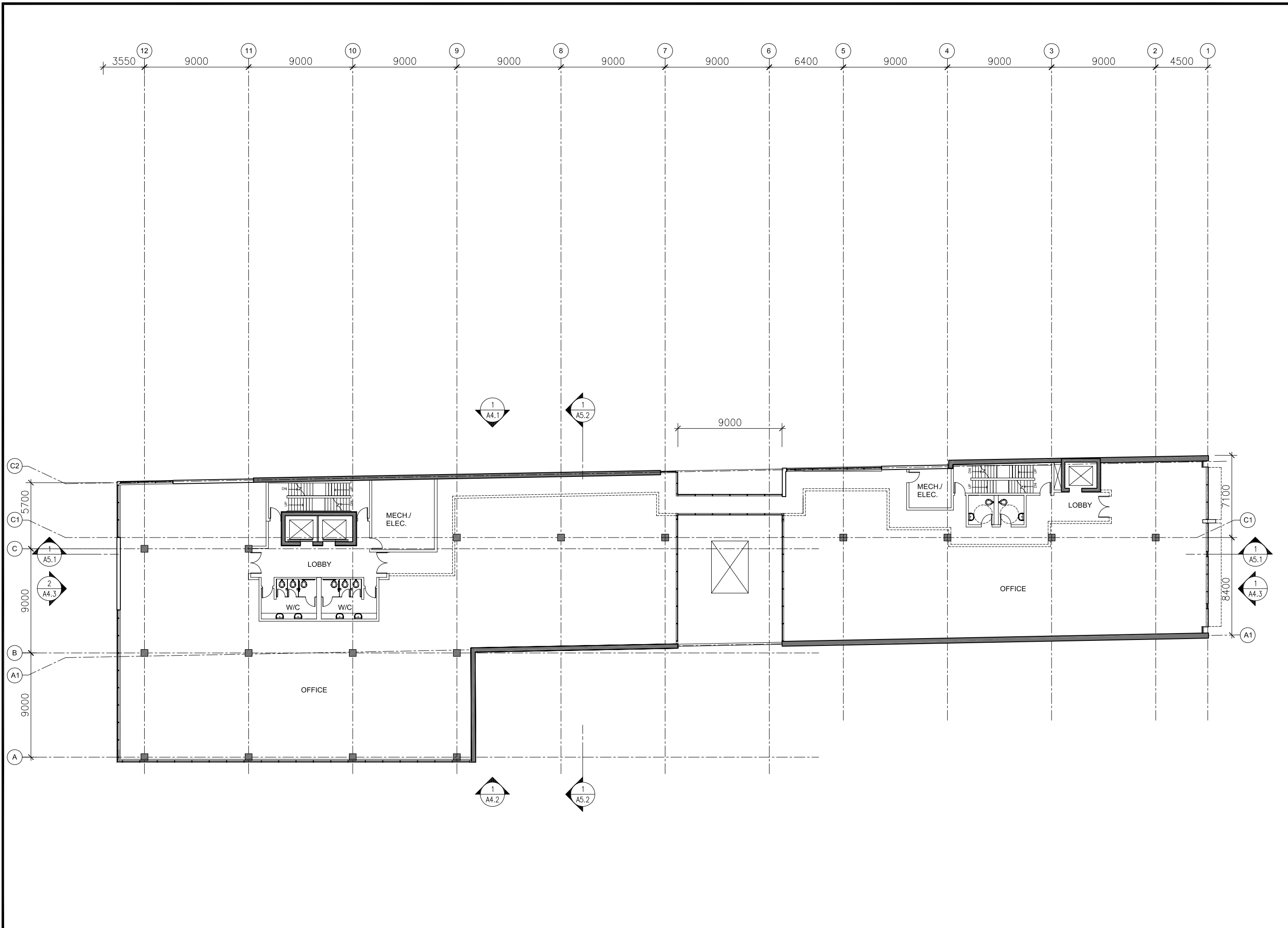

**DRAWING NOT TO BE SCALED**

Contractor must check and verify all dimensions on the job and report any discrepancies to the architect before proceeding with the work.  
This drawing shall not be used for construction purposes until signed by the consultant responsible. This drawing, as an instrument of service, is provided by and is the property of Sweeney Sterling Finlayson & Co. Architects.

**ISSUED**

08/07/10 Preliminary Project Review  
08/09/10 Committee of Adjustment  
08/10/31 Committee of Adjustment Resubmission

XXXXXXXX Revised

**REVISED**

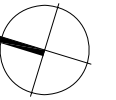

468 Wellington St. W. P +1 416 971 6252  
Suite 200 F +1 416 971 5420  
Toronto, ON info@andco.com  
Canada M5V 1E3 www.andco.com  
Sweeney Sterling Finlayson & Co Architects Inc.

544 King St. W.  
1-9 Morrison St.  
Toronto, Ont.

Allied Properties REIT  
Toronto, Ont.

Dwg. Title :

**4TH - 6TH  
FLOOR PLAN**

DATE : 08-08-15

SCALE : 1:300

DRAWN : AJ

CHECKED : MV

PROJECT NO. : 0817

Dwg. No. :

**A1.4**

I: 2008: 0817 544 King Street West: Drawings: 0817-544 King-L7-8.dwg | Oct 30, 2008 | 5:54 pm | alexandra

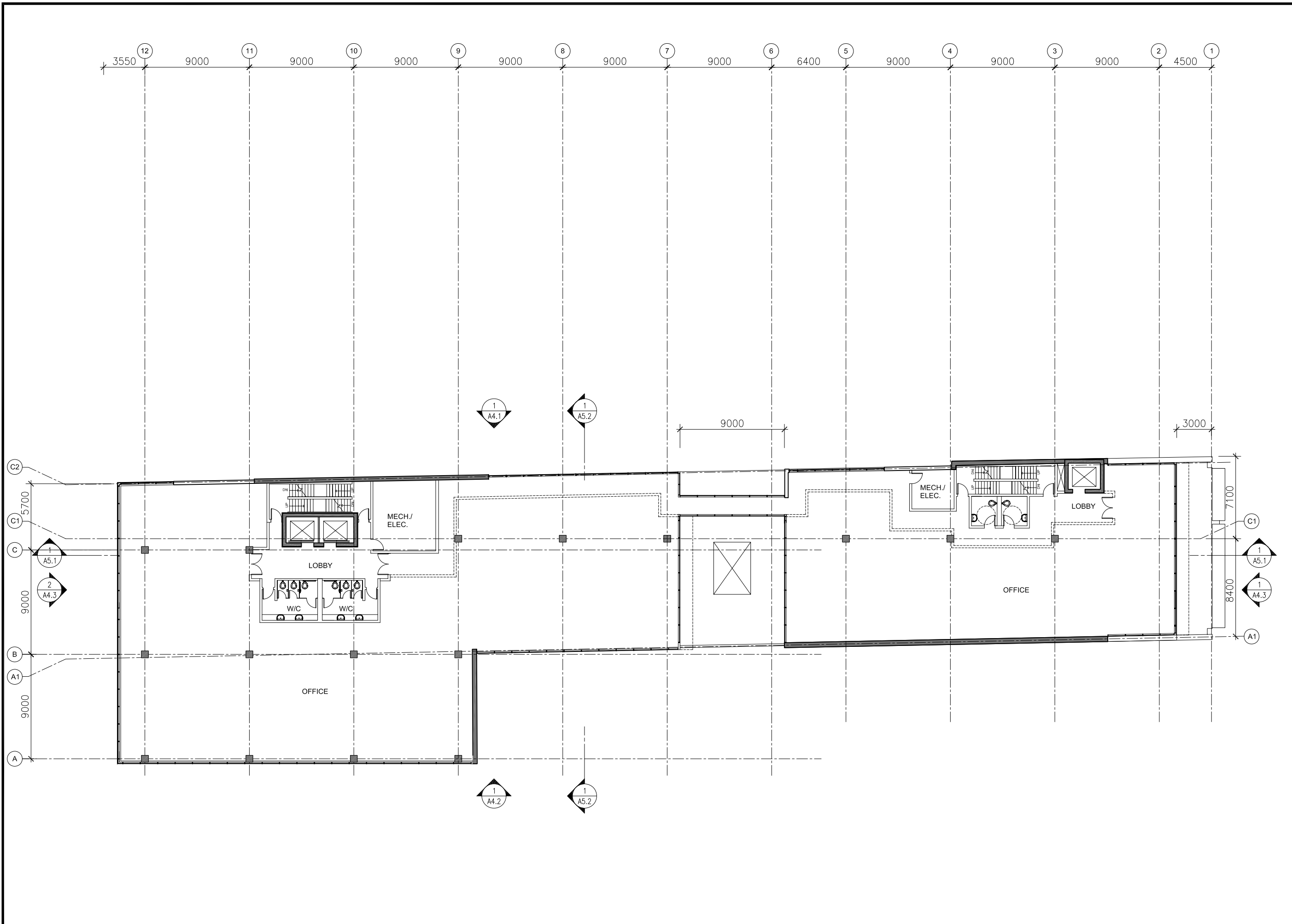

**DRAWING NOT TO BE SCALED**

Contractor must check and verify all dimensions on the job and report any discrepancies to the architect before proceeding with the work.  
This drawing shall not be used for construction purposes until signed by the consultant responsible. This drawing, as an instrument of service, is provided by and is the property of Sweeney Sterling Finlayson & Co. Architects.

**ISSUED**

08/07/10	Preliminary Project Review
08/09/10	Committee of Adjustment
08/10/31	Committee of Adjustment Resubmission

XXXXXXXX Revised

**REVISED**

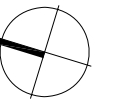

468 Wellington St. W. P +1 416 971 6252  
 Suite 200 F +1 416 971 5420  
 Toronto, ON info@andco.com  
 Canada M5V 1E3 www.andco.com

Sweeney Sterling Finlayson & Co Architects Inc.

544 King St. W.  
 1-9 Morrison St.  
 Toronto, Ont.

Allied Properties REIT  
 Toronto, Ont.

Dwg. Title :

**7TH & 8TH FLOOR PLAN**

DATE : 08-08-15

SCALE : 1:300

DRAWN : AJ

CHECKED : MV

PROJECT NO. : 0817

Dwg. No. :

**A1.5**



I:\2008\0817 544 King Street West\Drawings\0817-544 king-L9.dwg | Oct 31, 2008 | 1:04 pm | alexandra

**DRAWING NOT TO BE SCALED**

Contractor must check and verify all dimensions on the job and report any discrepancies to the architect before proceeding with the work.  
This drawing shall not be used for construction purposes until signed by the consultant responsible. This drawing, as an instrument of service, is provided by and is the property of Sweeny Sterling Finlayson & Co. Architects.

**ISSUED**

08/07/10 Preliminary Project Review  
08/09/10 Committee of Adjustment  
08/10/31 Committee of Adjustment Resubmission

XXXXXXXX Revised

**REVISED**

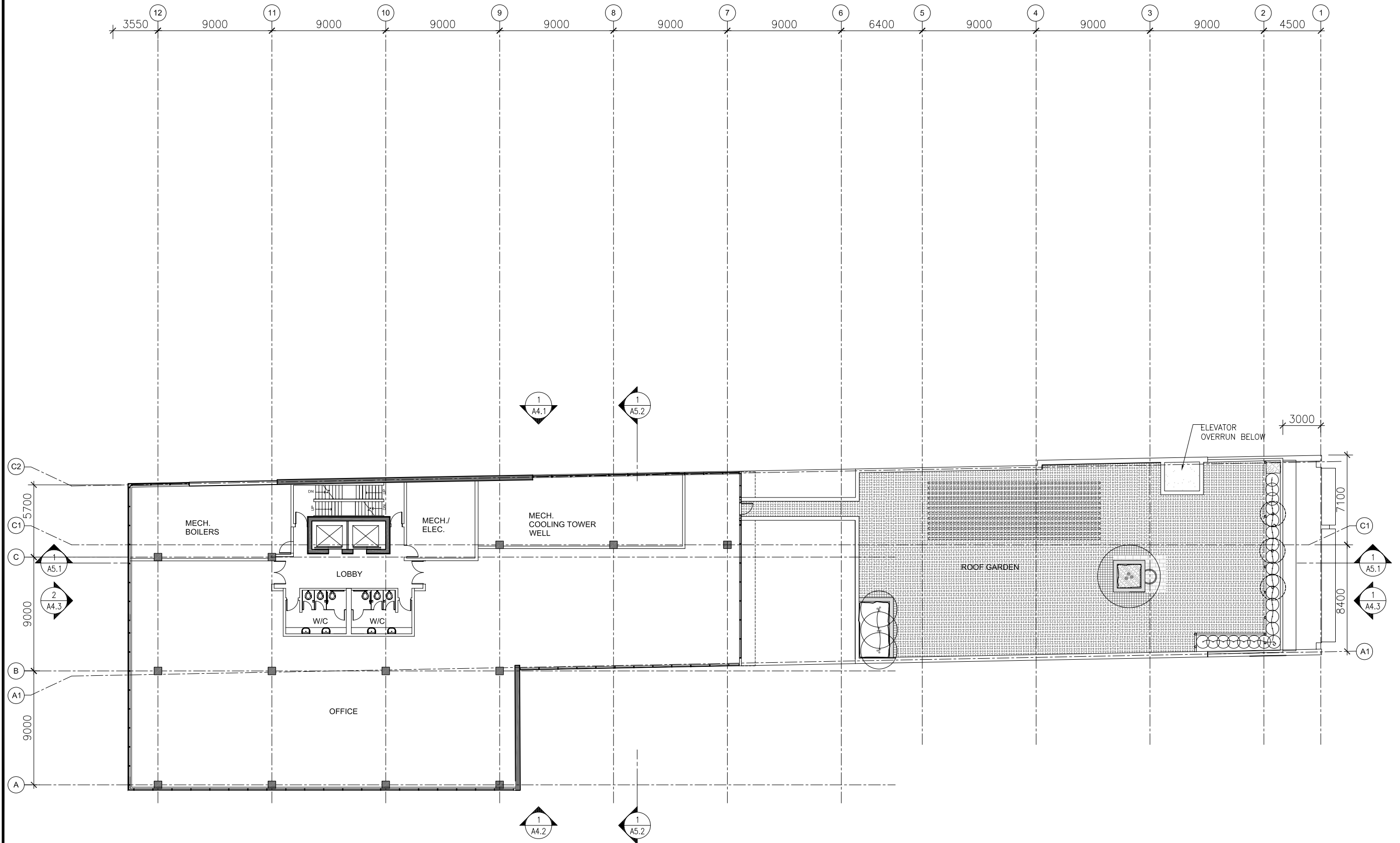
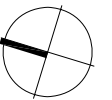

468 Wellington St. W. P +1 416 971 6252  
Suite 200 F +1 416 971 5420  
Toronto, ON info@andco.com  
Canada M5V 1E3 www.andco.com  
Sweeny Sterling Finlayson & Co Architects Inc.

544 King St. W.  
1-9 Morrison St.  
Toronto, Ont.

Allied Properties REIT  
Toronto, Ont.

Dwg. Title :

**9TH FLOOR PLAN**

DATE : 08-08-15  
SCALE : 1:300  
DRAWN : AJ  
CHECKED : MV  
PROJECT NO. : 0817

Dwg. No. :

**A1.6**

MATERIAL LEGEND

- ① ALUMINUM LOUVRES
- ② GLAZED CURTAINWALL WITH OPERABLE WINDOWS COMPLETE WITH VERTICAL SUNSHADES
- ③ CURTAIN WALL COMPLETE WITH SPANDREL PANELS
- ④ GLAZED WINDOW SYSTEM
- ⑤ REINFORCED GLASS FIBRE CONCRETE PANELS
- ⑥ LOADING COMPLETE ITH ENCLOSURE
- ⑦ CURTAIN WALL SYSTEM
- ⑧ HORIZONTAL SUNSHADES
- ⑨ PREFINISHED METAL CLADDING
- ⑩ WOOD SLAT TRELLIS
- ⑪ BRICK

**DRAWING NOT TO BE SCALED**

Contractor must check and verify all dimensions on the job and report any discrepancies to the architect before proceeding with the work.

This drawing shall not be used for construction purposes until signed by the consultant responsible. This drawing, as an instrument of service, is provided by and is the property of Sweeny Sterling Finlayson & Co. Architects.

**ISSUED**

- 08/07/10 Preliminary Project Review
- 08/09/10 Committee of Adjustment
- 08/10/31 Committee of Adjustment Resubmission

XXXXXXXX Revised

**REVISED**

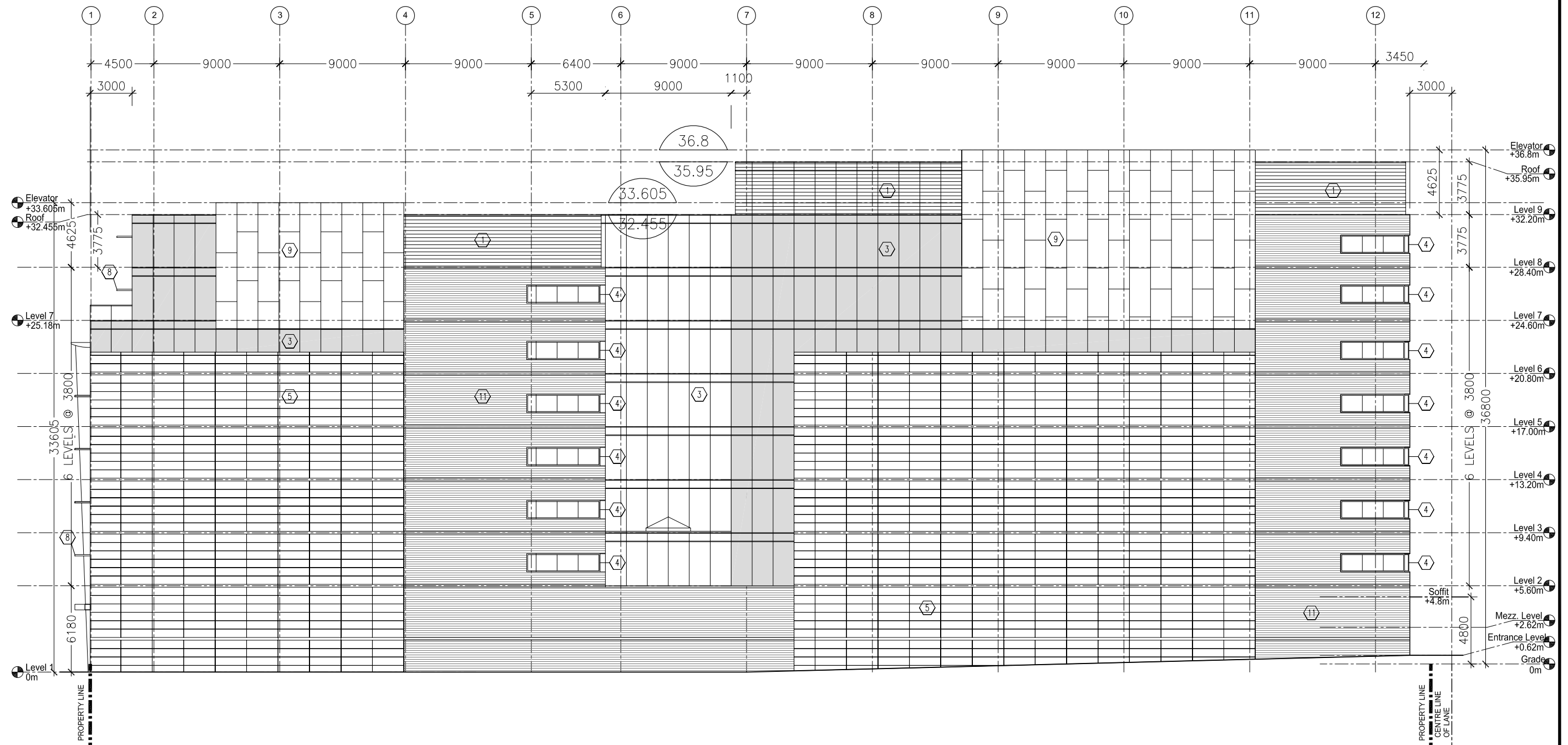

544 King St. W.  
1-9 Morrison St.  
Toronto, Ont.

Allied Properties REIT  
Toronto, Ont.

Dwg. Title :  
**EAST ELEVATION**

DATE : 08-08-15  
SCALE : 1:300  
DRAWN : AJ  
CHECKED : MV  
PROJECT NO. : 0817

Dwg. No. :  
**A4.1**

I: 2008: 0817 544 King Street West: Drawings: 0817-544-Elevations-TD.dwg | Oct 31, 2008 | 11:13 am | alexandra

MATERIAL LEGEND

- ① ALUMINUM LOUVRES
- ② GLAZED CURTAINWALL WITH OPERABLE WINDOWS COMPLETE WITH VERTICAL SUNSHADES
- ③ CURTAIN WALL COMPLETE WITH SPANDREL PANELS
- ④ GLAZED WINDOW SYSTEM
- ⑤ REINFORCED GLASS FIBRE CONCRETE PANELS
- ⑥ LOADING COMPLETE ITH ENCLOSURE
- ⑦ CURTAIN WALL SYSTEM
- ⑧ HORIZONTAL SUNSHADES
- ⑨ PREFINISHED METAL CLADDING
- ⑩ WOOD SLAT TRELLIS
- ⑪ BRICK

DRAWING NOT TO BE SCALED

Contractor must check and verify all dimensions on the job and report any discrepancies to the architect before proceeding with the work.

This drawing shall not be used for construction purposes until signed by the consultant responsible. This drawing, as an instrument of service, is provided by and is the property of Sweeny Sterling Finlayson & Co. Architects.

ISSUED

- 08/07/10 Preliminary Project Review
- 08/09/10 Committee of Adjustment
- 08/10/31 Committee of Adjustment Resubmission

XXXXXXXX Revised

REVISED

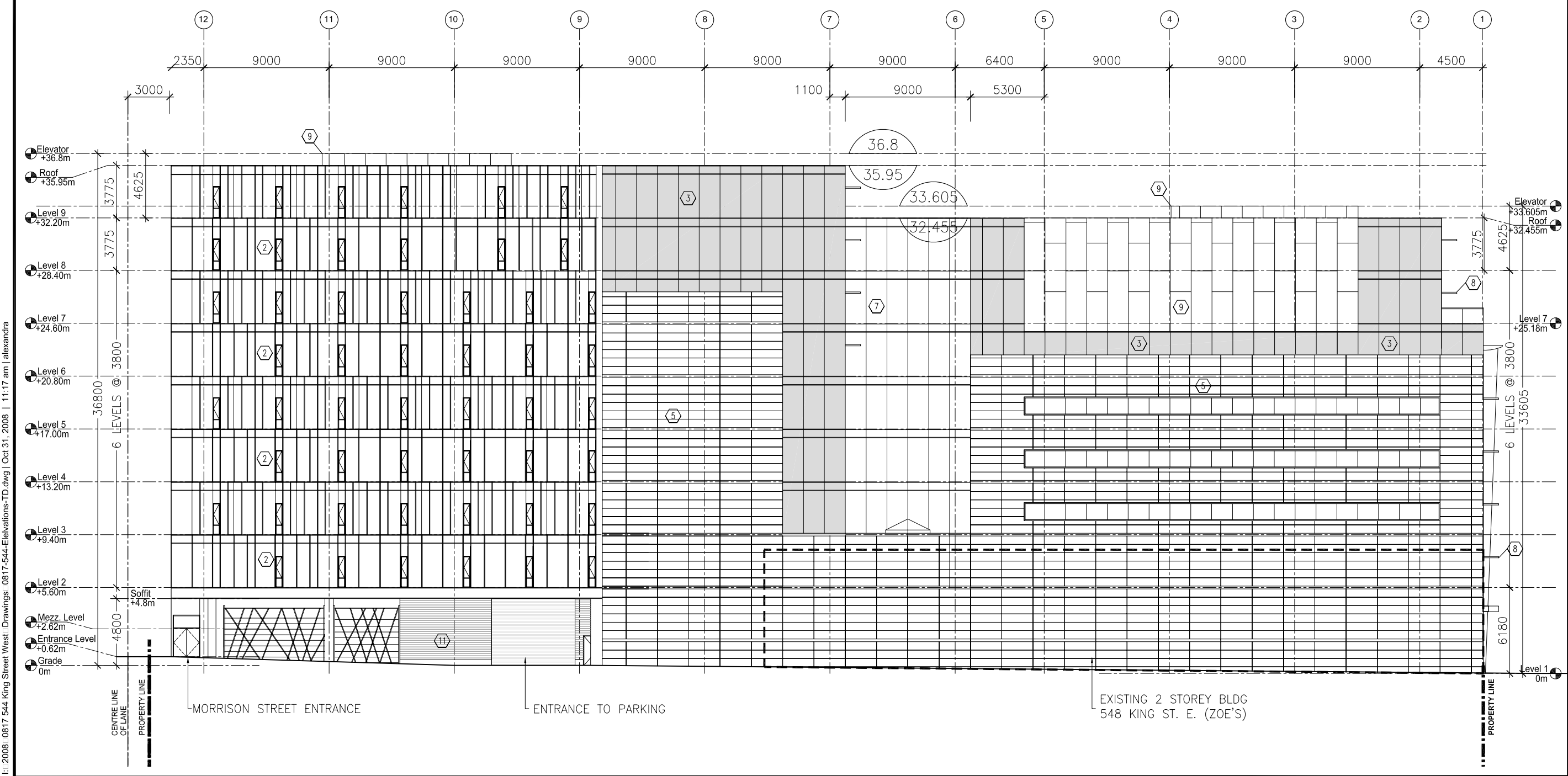

**&Co**

468 Wellington St. W. P +1 416 971 6252  
 Suite 200 F +1 416 971 5420  
 Toronto, ON info@andco.com  
 Canada M5V 1E3 www.andco.com  
 Sweeny Sterling Finlayson & Co Architects Inc.

544 King St. W.  
 1-9 Morrison St.  
 Toronto, Ont.

Allied Properties REIT  
 Toronto, Ont.

Dwg. Title :  
**WEST ELEVATION**

DATE : 08-08-15  
 SCALE : 1:300  
 DRAWN : AJ  
 CHECKED : MV  
 PROJECT NO. : 0817

Dwg. No. :  
**A4.2**

MATERIAL LEGEND

- |   |                                   |
|---|-----------------------------------|
| ① ALUMINUM LOUVRES  | ⑥ LOADING COMPLETE WITH ENCLOSURE |
| ② GLAZED CURTAINWALL WITH OPERABLE WINDOWS COMPLETE WITH VERTICAL SUNSHADES | ⑦ CURTAIN WALL SYSTEM             |
| ③ CURTAIN WALL COMPLETE WITH SPANDREL PANELS                                | ⑧ HORIZONTAL SUNSHADES            |
| ④ GLAZED WINDOW SYSTEM  | ⑨ PREFINISHED METAL CLADDING      |
| ⑤ REINFORCED GLASS FIBRE CONCRETE PANELS                                    | ⑩ WOOD SLAT TRELLIS               |
|   | ⑪ BRICK                           |

**DRAWING NOT TO BE SCALED**

Contractor must check and verify all dimensions on the job and report any discrepancies to the architect before proceeding with the work.

This drawing shall not be used for construction purposes until signed by the consultant responsible. This drawing, as an instrument of service, is provided by and is the property of Sweeney Sterling Finlayson & Co. Architects.

**ISSUED**

08/07/10 Preliminary Project Review  
 08/09/10 Committee of Adjustment  
 08/10/31 Committee of Adjustment Resubmission

XXXXXXXX Revised

**REVISED**

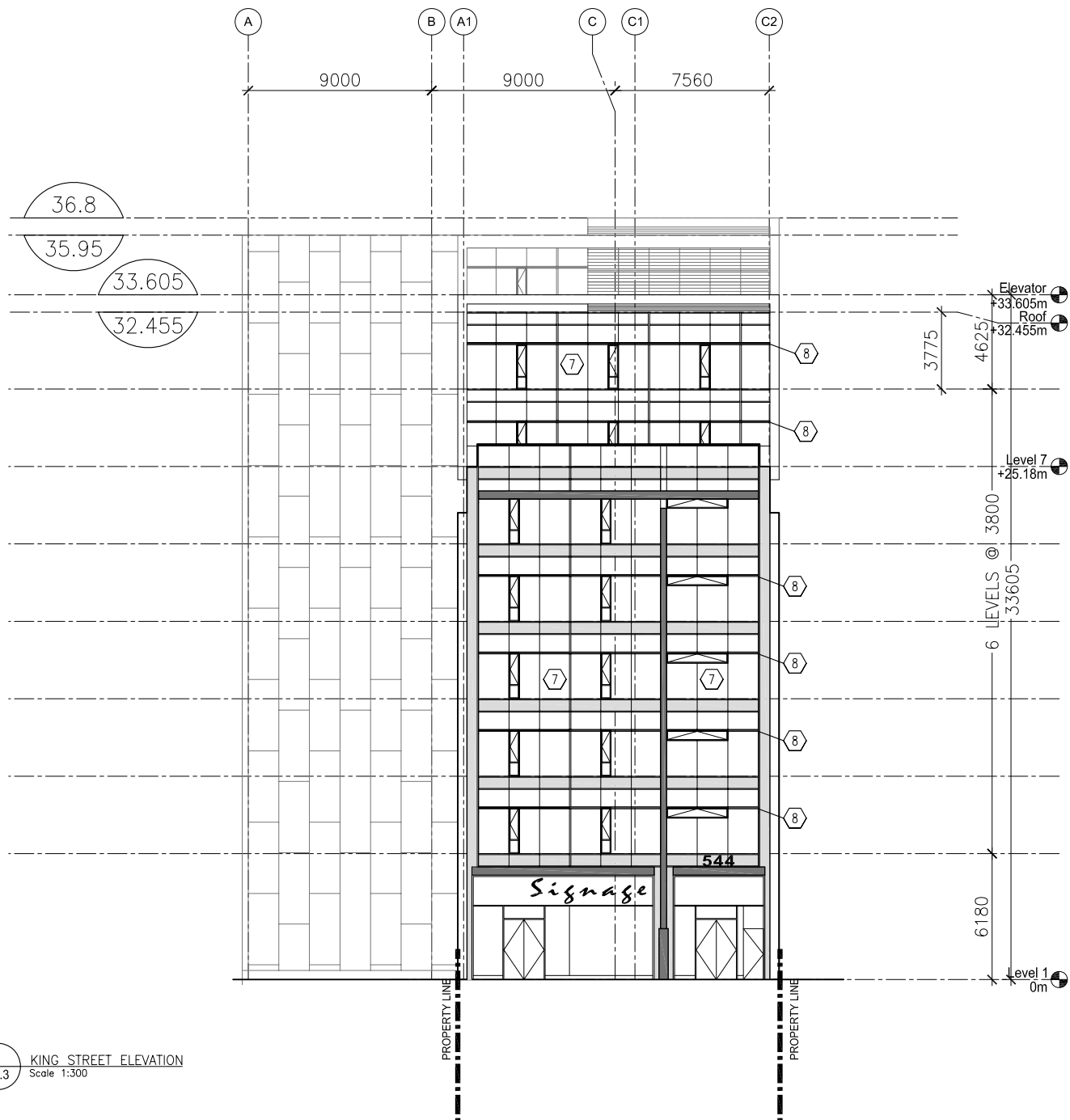

1 KING STREET ELEVATION  
 A4.3 Scale 1:300

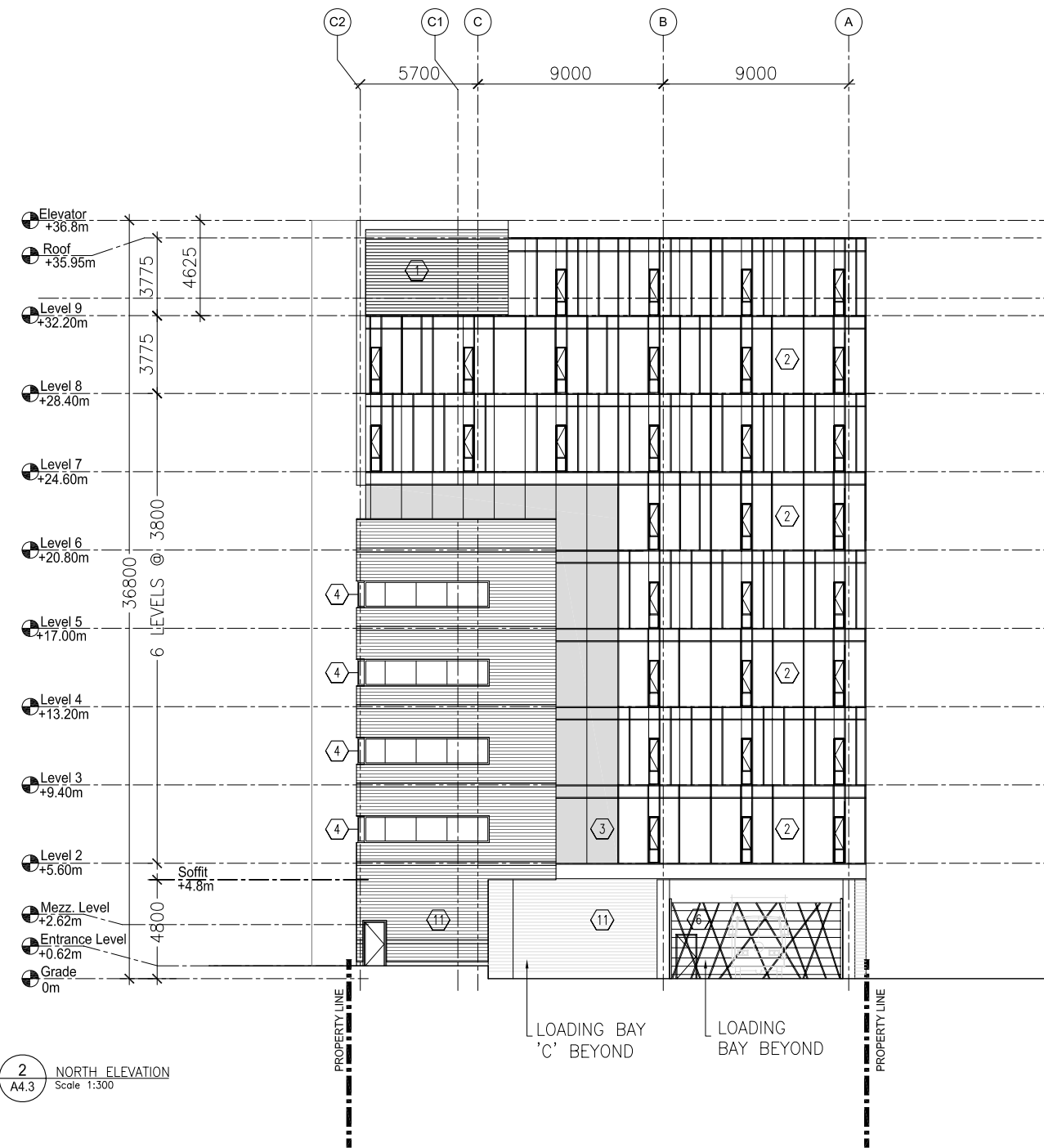

2 NORTH ELEVATION  
 A4.3 Scale 1:300



468 Wellington St. W. P +1 416 971 6252  
 Suite 200 F +1 416 971 5420  
 Toronto, ON info@andco.com  
 Canada M5V 1E3 www.andco.com  
 Sweeney Sterling Finlayson & Co Architects Inc.

544 King St. W.  
 1-9 Morrison St.  
 Toronto, Ont.

Allied Properties REIT  
 Toronto, Ont.

Dwg. Title :

**SOUTH & NORTH ELEVATIONS**

DATE : 08-08-15

SCALE : 1:300

DRAWN : AJ

CHECKED : MV

PROJECT NO. : 0817

Dwg. No. :

A4.3

MATERIAL LEGEND

- |   |                                   |
|---|-----------------------------------|
| ① ALUMINUM LOUVRES  | ⑥ LOADING COMPLETE WITH ENCLOSURE |
| ② GLAZED CURTAINWALL WITH OPERABLE WINDOWS COMPLETE WITH VERTICAL SUNSHADES | ⑦ CURTAIN WALL SYSTEM             |
| ③ CURTAIN WALL COMPLETE WITH SPANDREL PANELS                                | ⑧ HORIZONTAL SUNSHADES            |
| ④ GLAZED WINDOW SYSTEM  | ⑨ PREFINISHED METAL CLADDING      |
| ⑤ REINFORCED GLASS FIBRE CONCRETE PANELS                                    | ⑩ WOOD SLAT TRELLIS               |
|   | ⑪ BRICK                           |

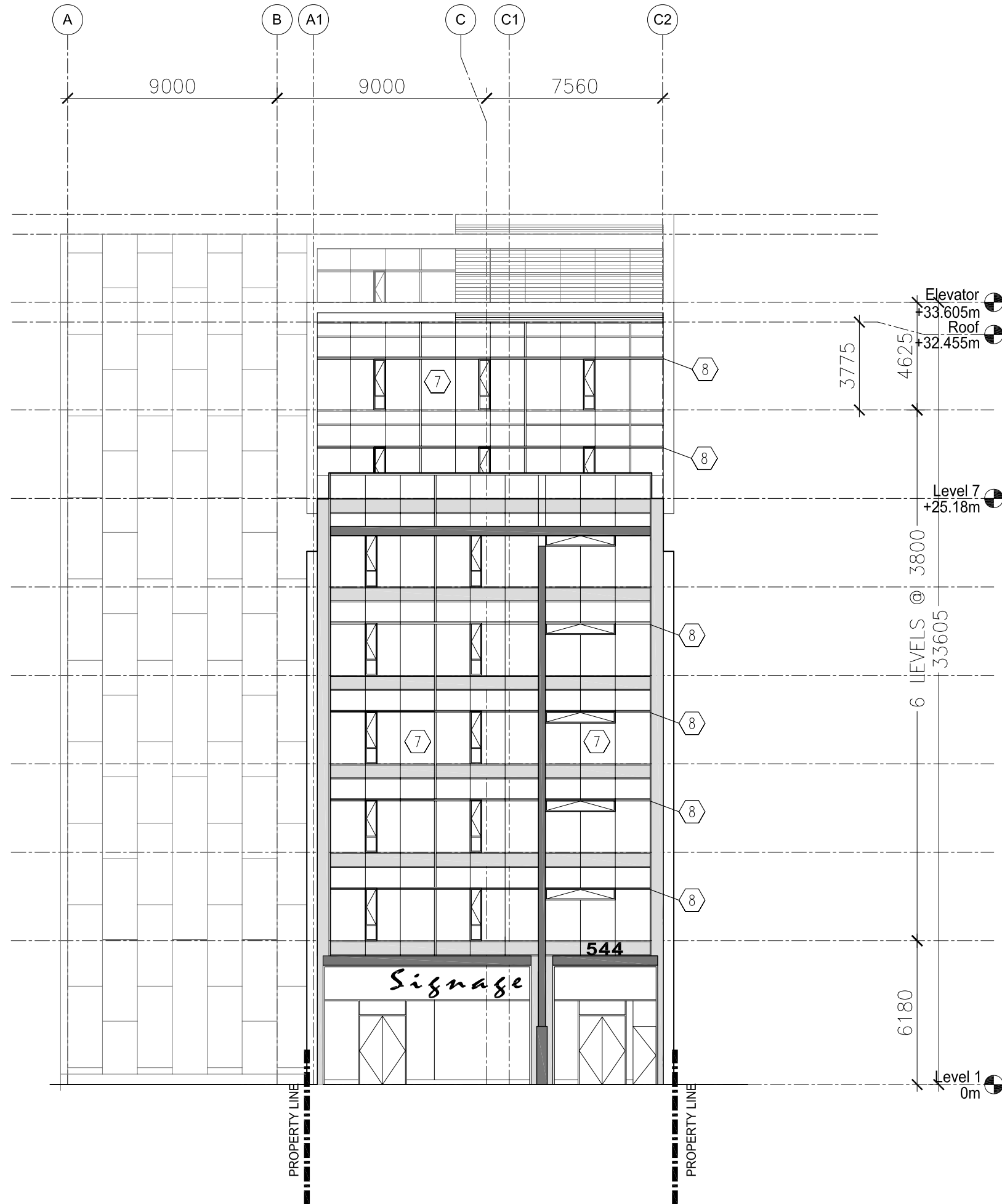

**DRAWING NOT TO BE SCALED**

Contractor must check and verify all dimensions on the job and report any discrepancies to the architect before proceeding with the work.

This drawing shall not be used for construction purposes until signed by the consultant responsible. This drawing, as an instrument of service, is provided by and is the property of Sweeney Sterling Finlayson & Co. Architects.

**ISSUED**

- 08/07/10 Preliminary Project Review
- 08/09/10 Committee of Adjustment
- 08/10/31 Committee of Adjustment Resubmission

XXXXXXXX Revised

**REVISED**



468 Wellington St. W. P +1 416 971 6252  
 Suite 200 F +1 416 971 5420  
 Toronto, ON info@andco.com  
 Canada M5V 1E3 www.andco.com  
 Sweeney Sterling Finlayson & Co Architects Inc.

544 King St. W.  
 1-9 Morrison St.  
 Toronto, Ont.

Allied Properties REIT  
 Toronto, Ont.

Dwg. Title :

**SOUTH ELEVATION**

DATE : 08-10-28  
 SCALE : 1:200  
 DRAWN : AJ  
 CHECKED : MV  
 PROJECT NO. : 0817

Dwg. No. :  
**A4.4**

MATERIAL LEGEND

- ① ALUMINUM LOUVRES
- ② GLAZED CURTAINWALL WITH OPERABLE WINDOWS COMPLETE WITH VERTICAL SUNSHADES
- ③ CURTAIN WALL COMPLETE WITH SPANDREL PANELS
- ④ GLAZED WINDOW SYSTEM
- ⑤ REINFORCED GLASS FIBRE CONCRETE PANELS
- ⑥ LOADING COMPLETE WITH ENCLOSURE
- ⑦ CURTAIN WALL SYSTEM
- ⑧ HORIZONTAL SUNSHADES
- ⑨ PREFINISHED METAL CLADDING
- ⑩ WOOD SLAT TRELLIS
- ⑪ BRICK



**DRAWING NOT TO BE SCALED**

Contractor must check and verify all dimensions on the job and report any discrepancies to the architect before proceeding with the work.

This drawing shall not be used for construction purposes until signed by the consultant responsible. This drawing, as an instrument of service, is provided by and is the property of Sweeny Sterling Finlayson & Co. Architects.

**ISSUED**

- 08/07/10 Preliminary Project Review
- 08/09/10 Committee of Adjustment
- 08/10/31 Committee of Adjustment Resubmission

XXXXXXXX Revised

**REVISED**



468 Wellington St. W. P +1 416 971 6252  
 Suite 200 F +1 416 971 5420  
 Toronto, ON info@andco.com  
 Canada M5V 1E3 www.andco.com  
 Sweeny Sterling Finlayson & Co Architects Inc.

544 King St. W.  
 1-9 Morrison St.  
 Toronto, Ont.

Allied Properties REIT  
 Toronto, Ont.

Dwg. Title :

**NORTH ELEVATION**

DATE : 08-10-28

SCALE : 1:200

DRAWN : AJ

CHECKED : MV

PROJECT NO. : 0817

Dwg. No. :

A4.5

**DRAWING NOT TO BE SCALED**

Contractor must check and verify all dimensions on the job and report any discrepancies to the architect before proceeding with the work.

This drawing shall not be used for construction purposes until signed by the consultant responsible. This drawing, as an instrument of service, is provided by and is the property of Sweeney Sterling Finlayson & Co. Architects.

**ISSUED**

08/07/10	Preliminary Project Review
08/09/10	Committee of Adjustment
08/10/31	Committee of Adjustment Resubmission

XXXXXXXX Revised

**REVISED**

I:\2008\0817 544 King Street West\Drawings\0817-544-king-section.dwg | Oct 31, 2008 | 1:26 pm | alexandra

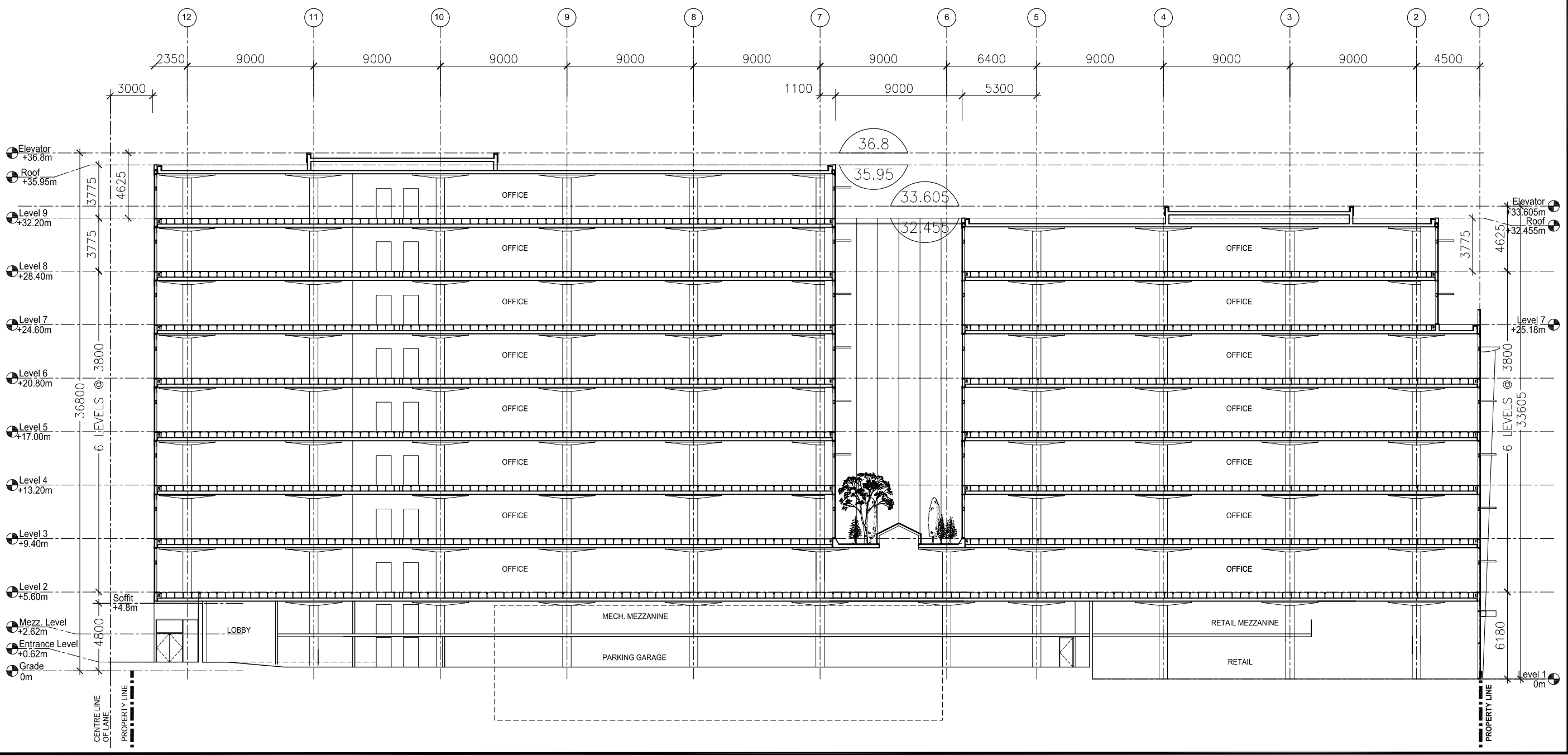

468 Wellington St. W. P +1 416 971 6252  
 Suite 200 F +1 416 971 5420  
 Toronto, ON info@andco.com  
 Canada M5V 1E3 www.andco.com

Sweeney Sterling Finlayson & Co Architects Inc.

544 King St. W.  
 1-9 Morrison St.  
 Toronto, Ont.

Allied Properties REIT  
 Toronto, Ont.

Dwg. Title :  
**NORTH/SOUTH  
 CROSS SECTION**

DATE : 08-08-15  
 SCALE : 1:300  
 DRAWN : AJ  
 CHECKED : MV  
 PROJECT NO. : 0817

Dwg. No. :  
**A5.1**

I: 2008: 0817 544 King Street West: Drawings: 0817-544-king-section.dwg | Oct 31, 2008 | 12:04 pm | alexandra

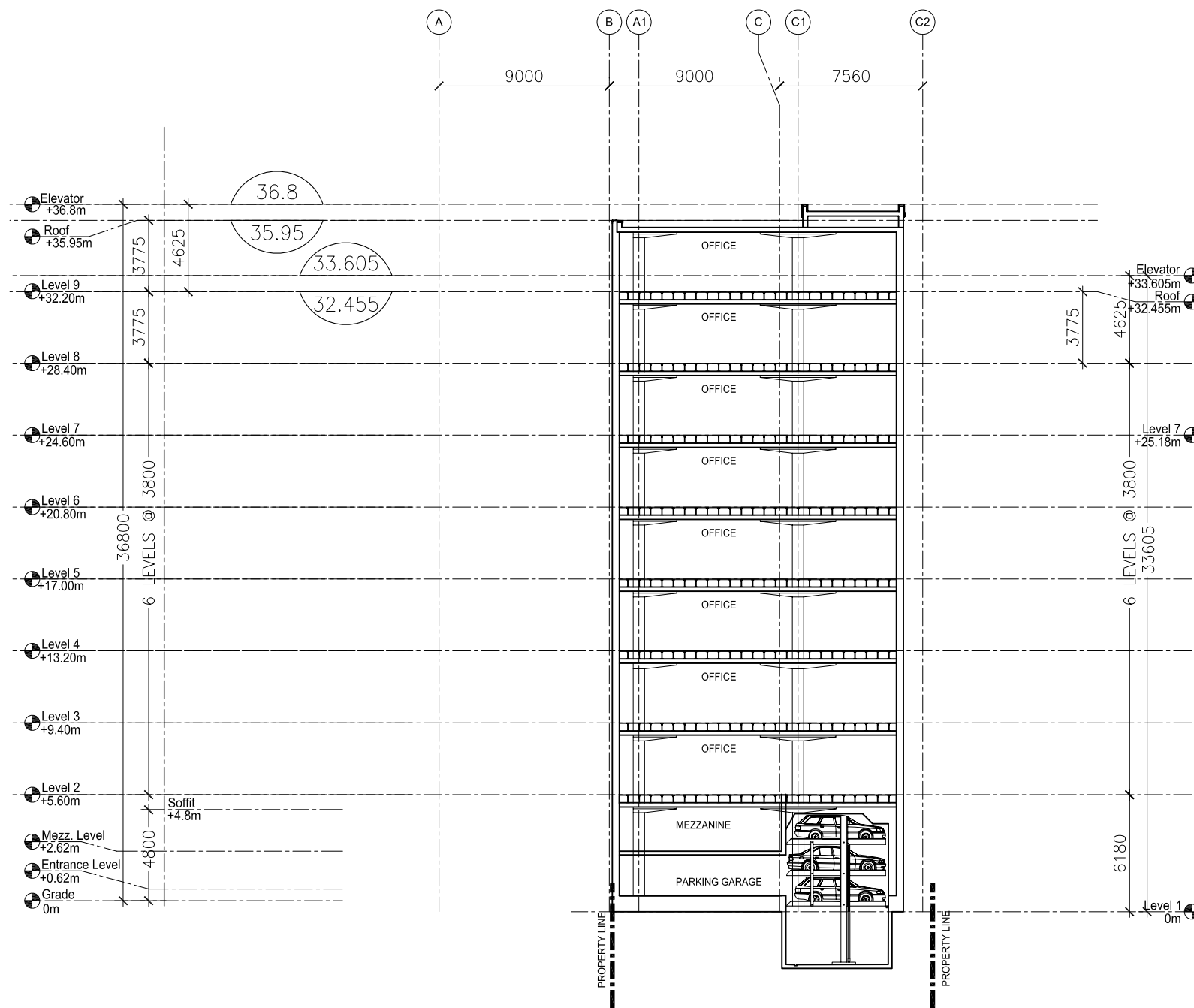

**DRAWING NOT TO BE SCALED**

Contractor must check and verify all dimensions on the job and report any discrepancies to the architect before proceeding with the work.  
This drawing shall not be used for construction purposes until signed by the consultant responsible. This drawing, as an instrument of service, is provided by and is the property of Sweeney Sterling Finlayson & Co. Architects.

**ISSUED**

08/07/10 Preliminary Project Review  
08/09/10 Committee of Adjustment  
08/10/31 Committee of Adjustment Resubmission

XXXXXXXX Revised

**REVISED**



468 Wellington St. W. P +1 416 971 6252  
Suite 200 F +1 416 971 5420  
Toronto, ON info@andco.com  
Canada M5V 1E3 www.andco.com  
Sweeney Sterling Finlayson & Co Architects Inc.

544 King St. W.  
1-9 Morrison St.  
Toronto, Ont.

Allied Properties REIT  
Toronto, Ont.

Dwg. Title:  
**EAST/WEST  
CROSS SECTION**

DATE: 08-08-15  
SCALE: 1:300  
DRAWN: AJ  
CHECKED: MV  
PROJECT NO.: 0817

Dwg. No.:

**A5.2**