

Front Yard Parking Appeal - 28 Coxwell Avenue  
APPENDIX 'D'

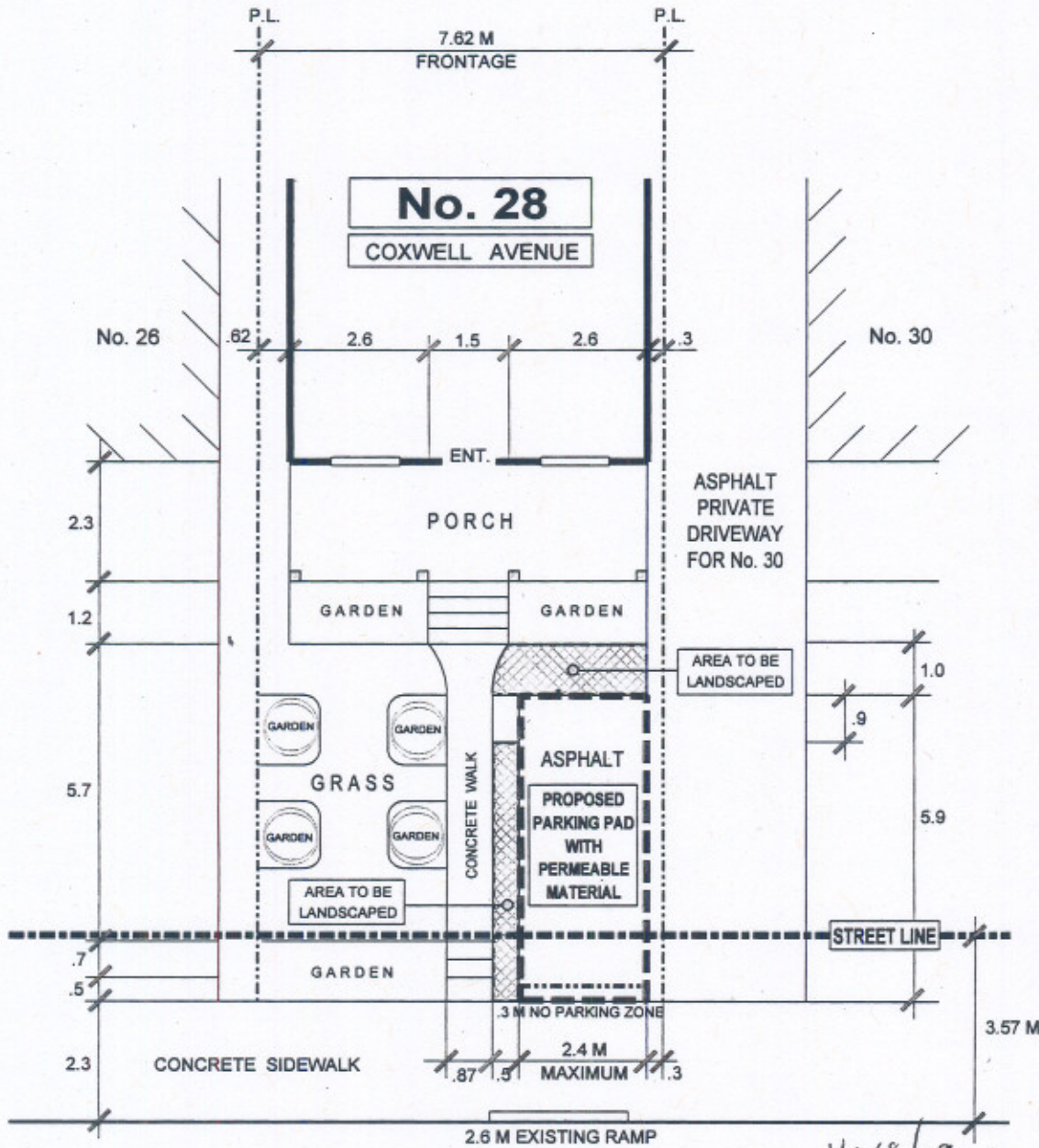

ASPHALT PRIVATE DRIVEWAY FOR No. 30

AREA TO BE LANDSCAPED

STREET LINE

2.6 M EXISTING RAMP

*H478/09*  
*Denise St. Genois*

**COXWELL AVENUE**



**TRANSPORTATION SERVICES DIVISION**  
TORONTO AND EAST YORK DISTRICT  
RIGHT OF WAY MANAGEMENT - OFF STREET PARKING



**FRONT YARD PARKING CHAPTER 918 F.Y.P. - 100041**

TOTAL PARKING AREA ON STREET ALLOWANCE	3.0 M <sup>2</sup>	PRIVATE PROPERTY			STREET ALLOWANCE		
		AREA M <sup>2</sup>	%	CODE	AREA M <sup>2</sup>	%	CODE
TOTAL AREA		53.5	100		9.2	100	
LANDSCAPED OPEN SPACE		42.3	79	50% min.	6.2	67	50% min.
PAVED AREA		11.2	21	50% max.	3.0	33	50% max.
SOFT LANDSCAPING		31.9	75	75% min.	5.1	82	75% min.

REVISIONS	
Date	By

DRAWN BY: R. MUNSON      DATE: NOV. 13' 07      SCALE: 1:100