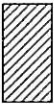

ST. CLAIR AVENUE WEST: COBALT AVENUE - CALEDONIA ROAD
EXISTING NO STOPPING REGULATIONS TO BE RESCINDED (Sheet 1 of 9)

LEGEND

-  EXISTING " NO STOPPING " FROM 4:00pm - 6:00pm, EXCEPT SATURDAYS, SUNDAYS & PUBLIC HOLIDAYS
-  EXISTING " NO STOPPING " FROM 7:00am - 9:00am, EXCEPT SATURDAY, SUNDAYS & PUBLIC HOLIDAYS

DWG. NO. 421F - 9915

A. A.

SCALE 1 : 1000

FEBRUARY, 2010

TRANSPORTATION SERVICES

TORONTO & EAST YORK DISTRICT



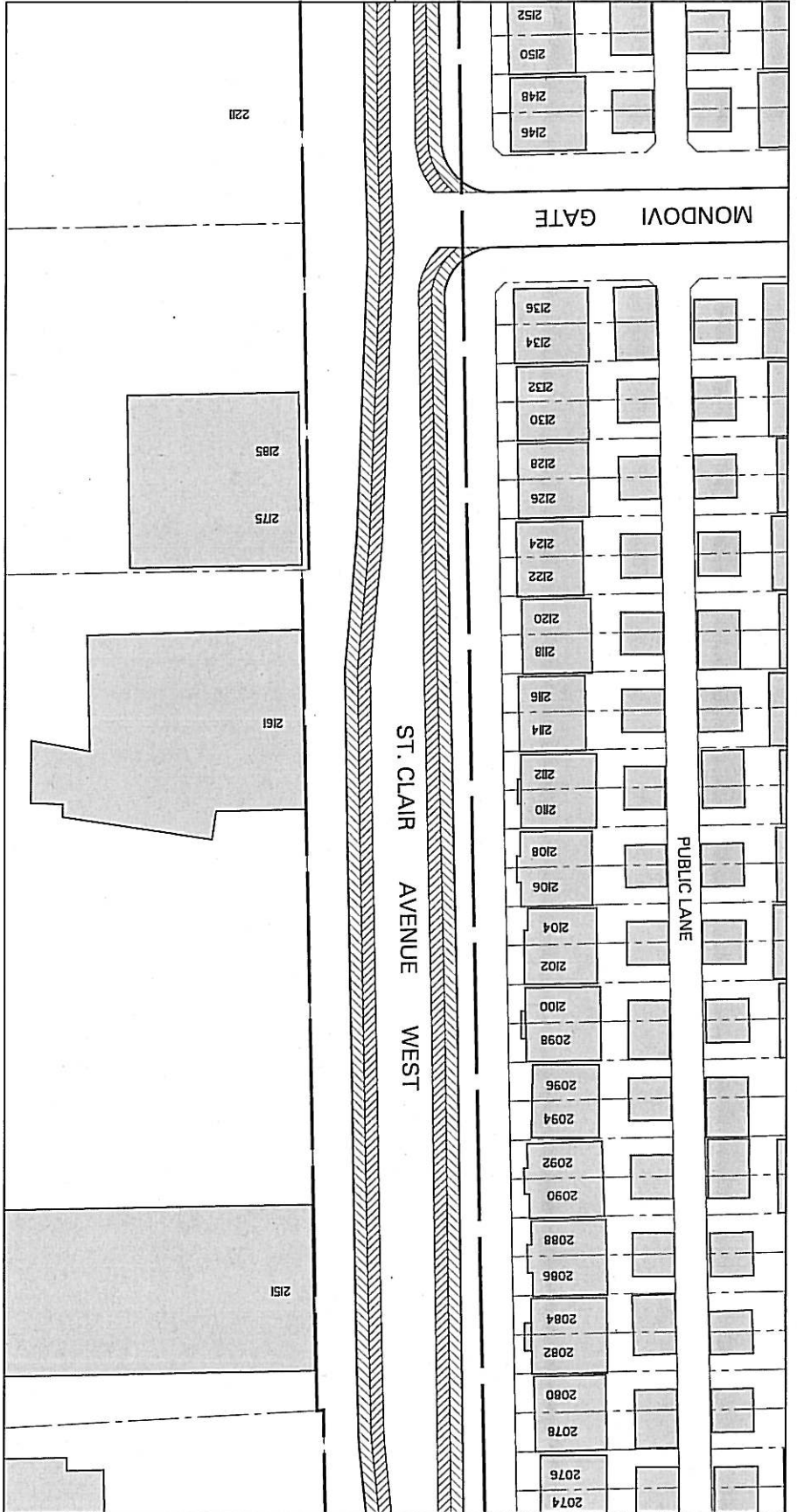

MATCH LINE DWG. NO. 421F - 9915



MATCH LINE DWG. NO. 421F - 9917

ST. CLAIR AVENUE WEST: COBALT AVENUE - CALEDONIA ROAD
EXISTING NO STOPPING REGULATIONS TO BE RESCINDED (Sheet 2 of 9)

LEGEND

-  EXISTING " NO STOPPING " FROM 4:00pm - 6:00pm, EXCEPT SATURDAYS, SUNDAYS & PUBLIC HOLIDAYS
-  EXISTING " NO STOPPING " FROM 7:00am - 9:00am, EXCEPT SATURDAY, SUNDAYS & PUBLIC HOLIDAYS



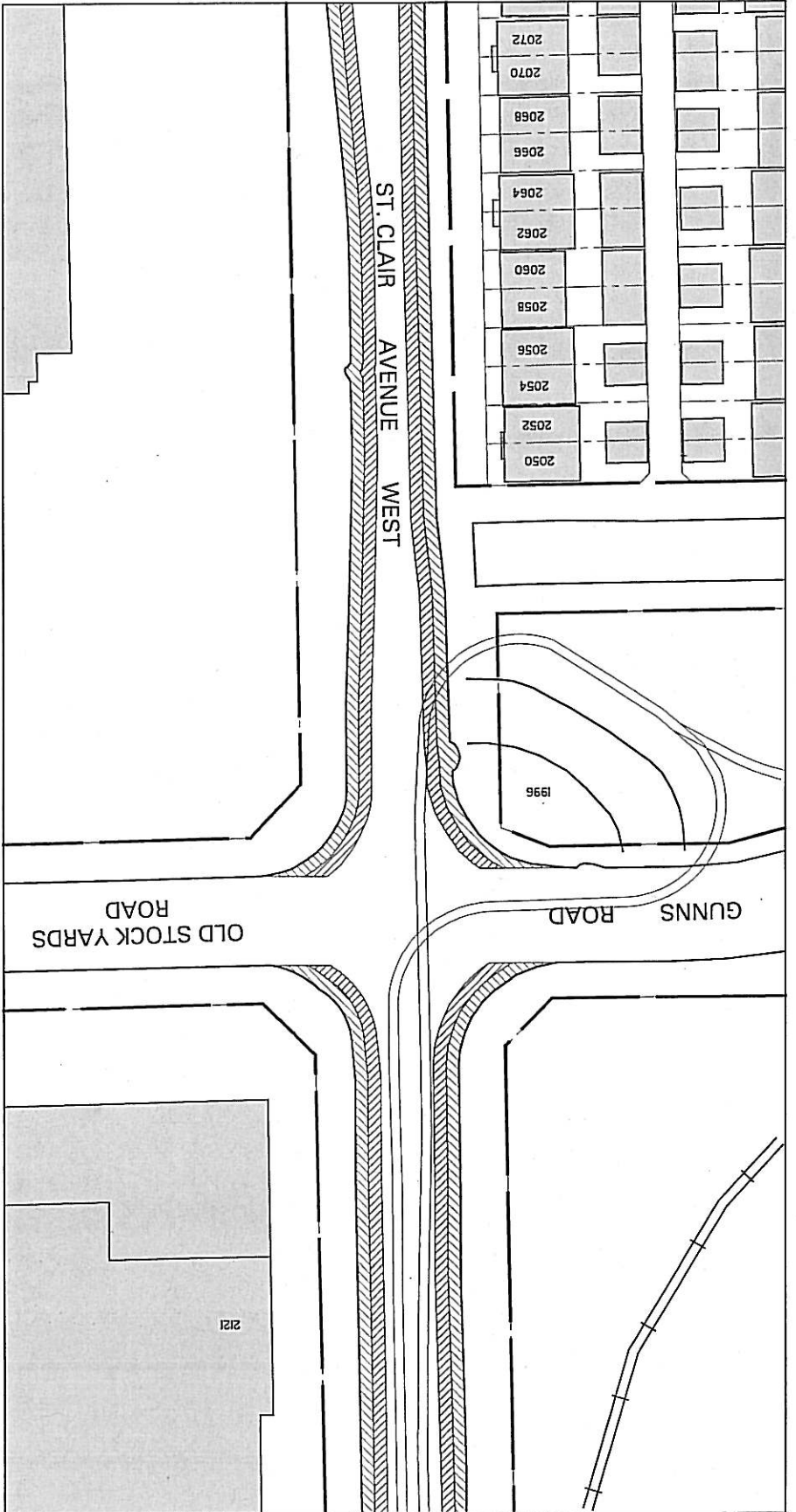

MATCH LINE DWG. NO. 421F-9916



MATCH LINE DWG. NO. 421F-9918

**ST. CLAIR AVENUE WEST: COBALT AVENUE - CALEDONIA ROAD
EXISTING NO STOPPING REGULATIONS TO BE RESCINDED (Sheet 3 of 9)**

LEGEND

-  EXISTING " NO STOPPING " FROM 4:00pm - 6:00pm, EXCEPT SATURDAYS, SUNDAYS & PUBLIC HOLIDAYS
-  EXISTING " NO STOPPING " FROM 7:00am - 9:00am, EXCEPT SATURDAY, SUNDAYS & PUBLIC HOLIDAYS



MATCH LINE DWG. NO. 421F - 9917

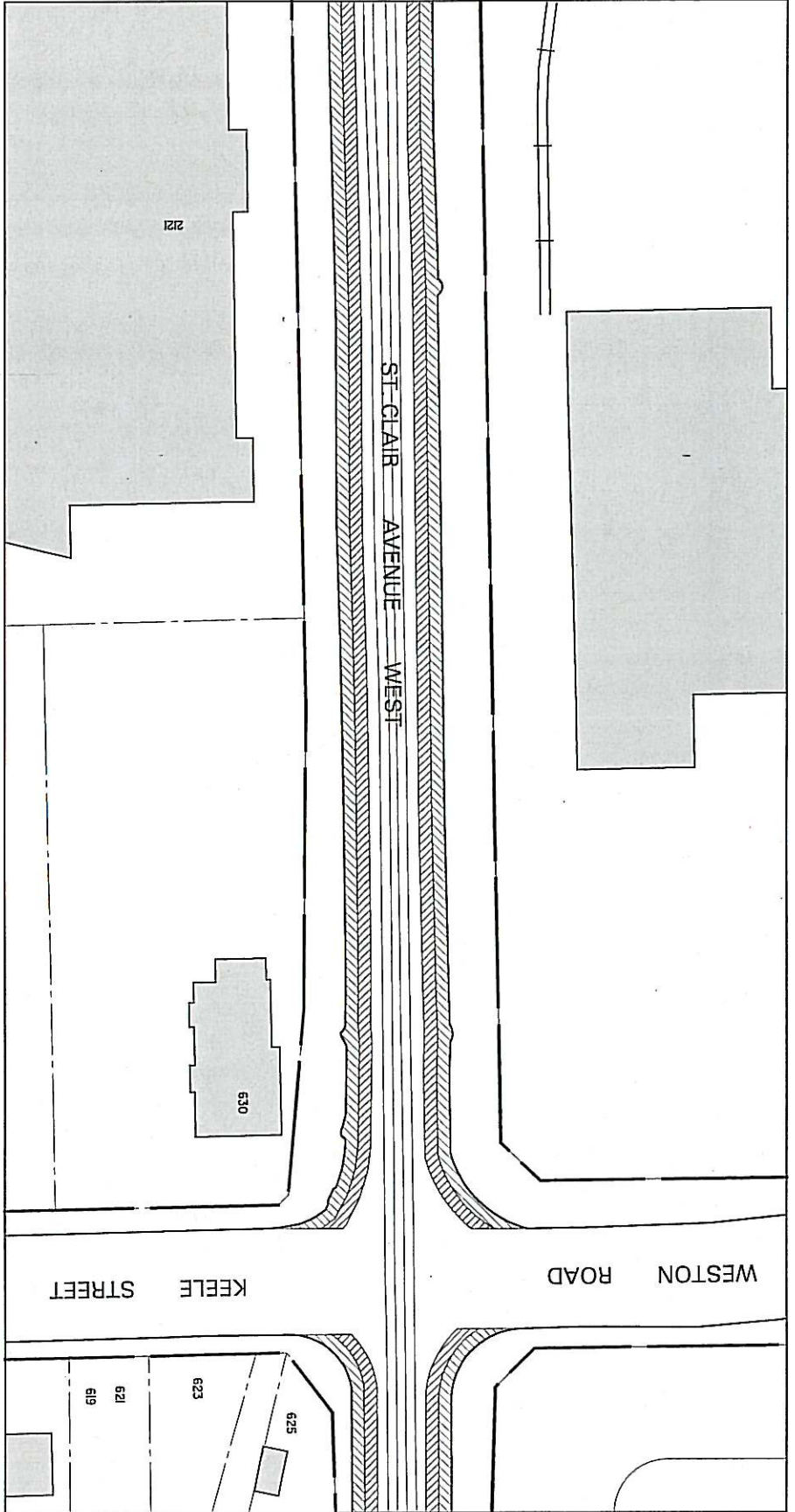

MATCH LINE DWG. NO. 421F - 9919

**ST. CLAIR AVENUE WEST: COBALT AVENUE - CALEDONIA ROAD
EXISTING NO STOPPING REGULATIONS TO BE RESCINDED (Sheet 4 of 9)**

LEGEND



-  EXISTING " NO STOPPING " FROM 4:00pm - 6:00pm, EXCEPT SATURDAYS, SUNDAYS & PUBLIC HOLIDAYS
-  EXISTING " NO STOPPING " FROM 7:00am - 9:00am, EXCEPT SATURDAY, SUNDAYS & PUBLIC HOLIDAYS

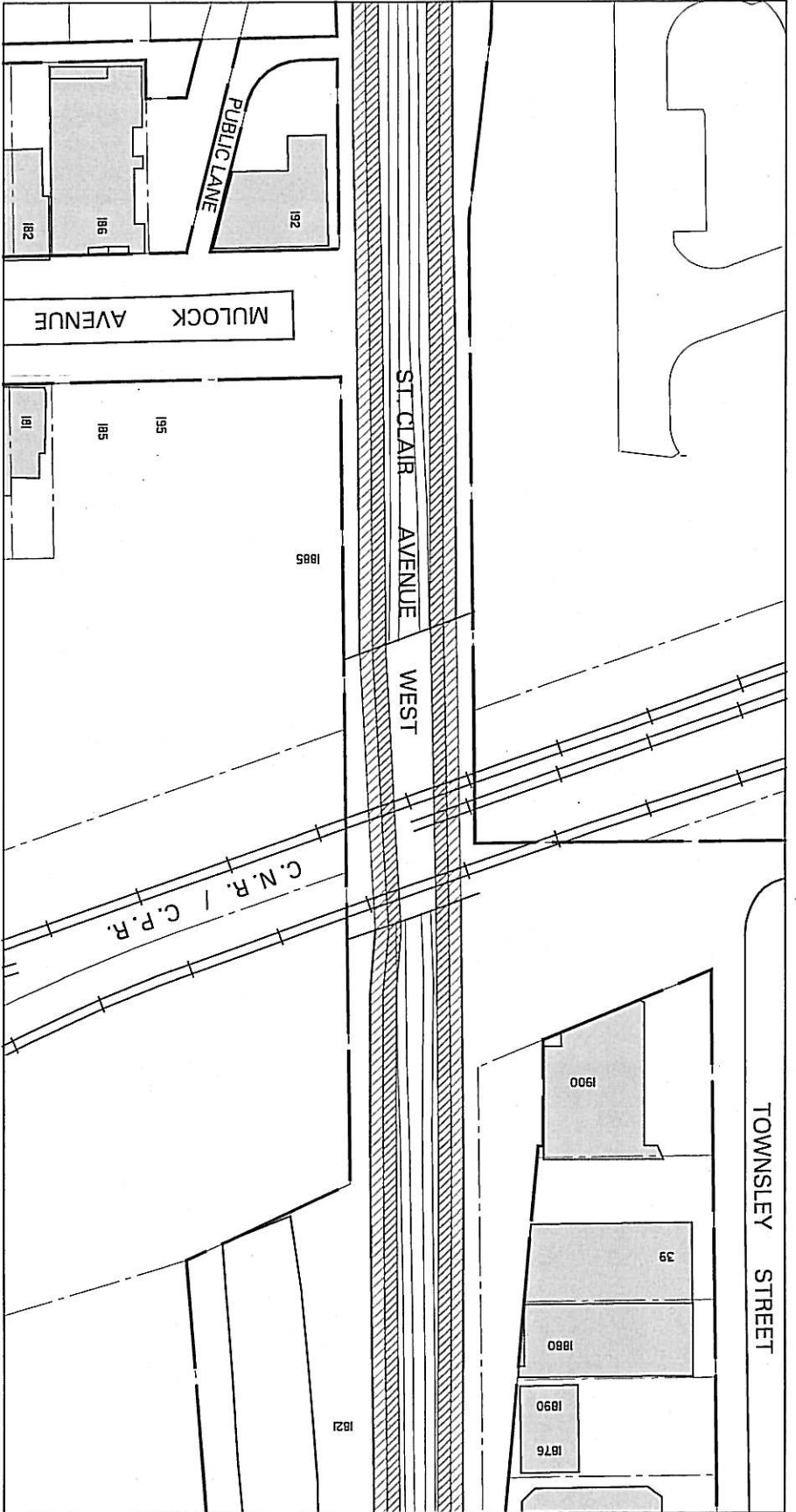



**ST. CLAIR AVENUE WEST: COBALT AVENUE - CALEDONIA ROAD
EXISTING NO STOPPING REGULATIONS TO BE RESCINDED (Sheet 5 of 9)**

LEGEND

-  EXISTING " NO STOPPING " FROM 4:00pm - 6:00pm, EXCEPT SATURDAYS, SUNDAYS & PUBLIC HOLIDAYS
-  EXISTING " NO STOPPING " FROM 7:00am - 9:00am, EXCEPT SATURDAY, SUNDAYS & PUBLIC HOLIDAYS



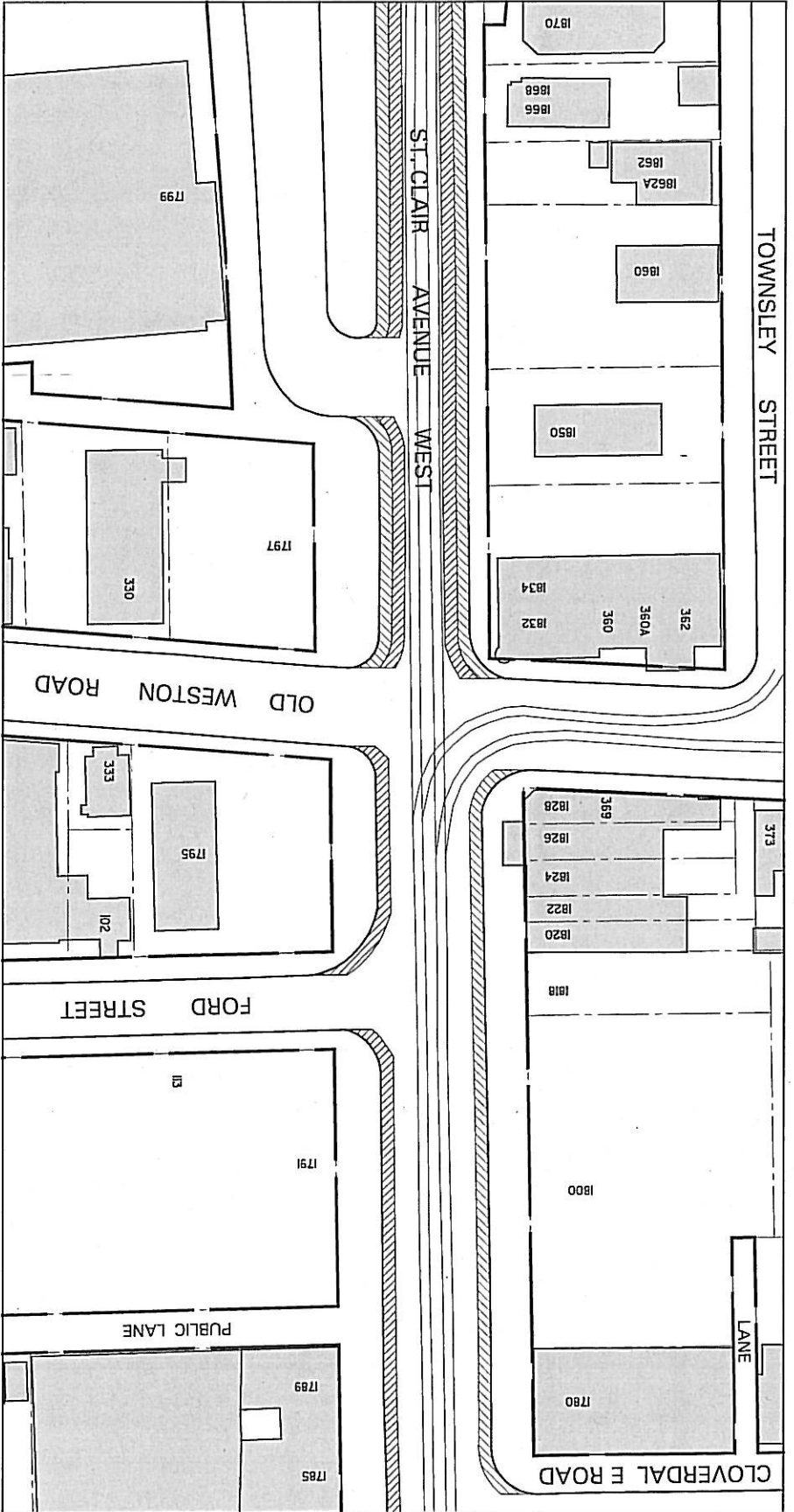

MATCH LINE DWG. NO. 421F - 9919



MATCH LINE DWG. NO. 421F - 9921

ST. CLAIR AVENUE WEST: COBALT AVENUE - CALEDONIA ROAD
EXISTING NO STOPPING REGULATIONS TO BE RESCINDED (Sheet 6 of 9)

LEGEND

-  EXISTING "NO STOPPING" FROM 4:00pm - 6:00pm, EXCEPT SATURDAYS, SUNDAYS & PUBLIC HOLIDAYS
-  EXISTING "NO STOPPING" FROM 7:00am - 9:00am, EXCEPT SATURDAY, SUNDAYS & PUBLIC HOLIDAYS



MATCH LINE DWG. NO. 421F - 9920

CLOVERDAL E ROAD

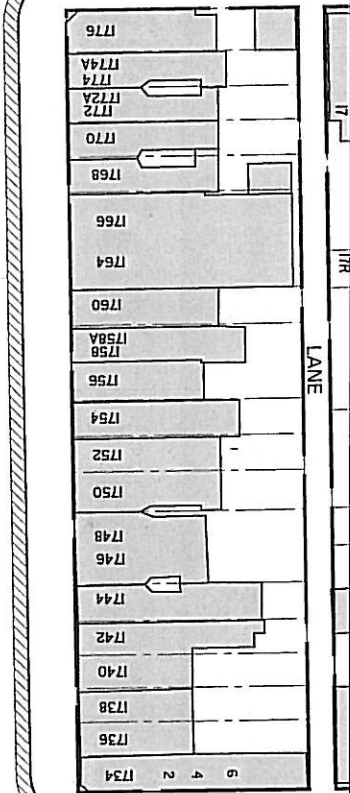

SILVERTHORN AVENUE

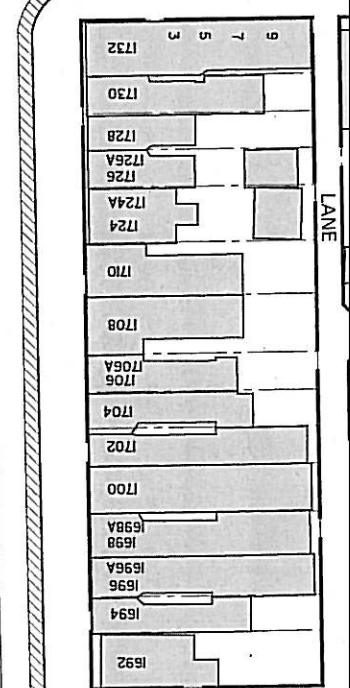

BLACKTHORN AVENUE

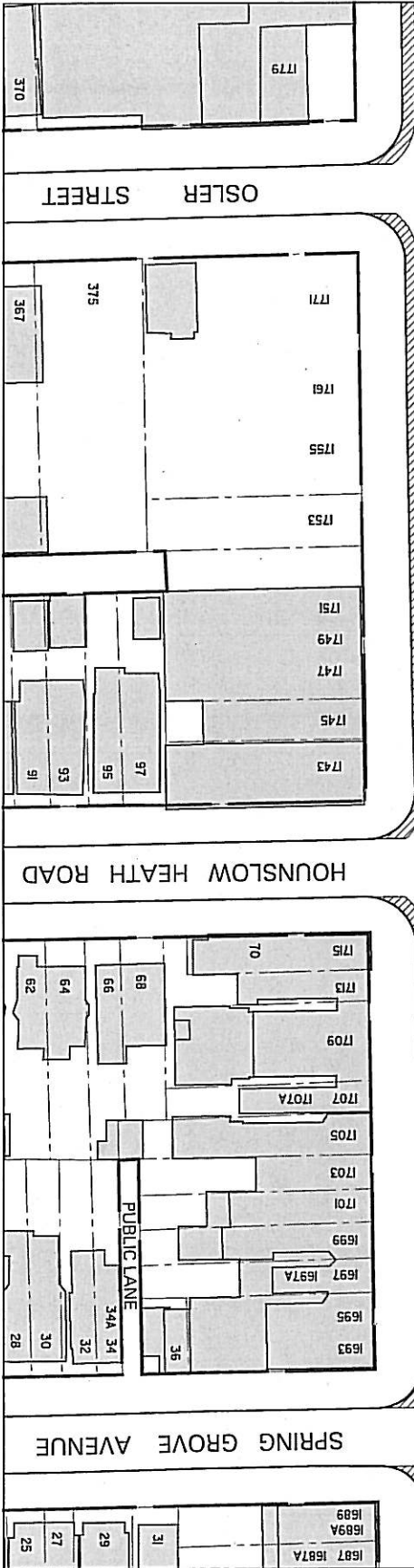

ST. CLAIR AVENUE WEST



MATCH LINE DWG. NO. 421F - 9922

**ST. CLAIR AVENUE WEST: COBALT AVENUE - CALEDONIA ROAD
EXISTING NO STOPPING REGULATIONS TO BE RESCINDED (Sheet 7 of 9)**

LEGEND

-  EXISTING " NO STOPPING " FROM 4:00pm - 6:00pm, EXCEPT SATURDAYS, SUNDAYS & PUBLIC HOLIDAYS
-  EXISTING " NO STOPPING " FROM 7:00am - 9:00am, EXCEPT SATURDAY, SUNDAYS & PUBLIC HOLIDAYS



MATCH LINE DWG. NO. 421F - 9921

BLACKTHORN AVENUE

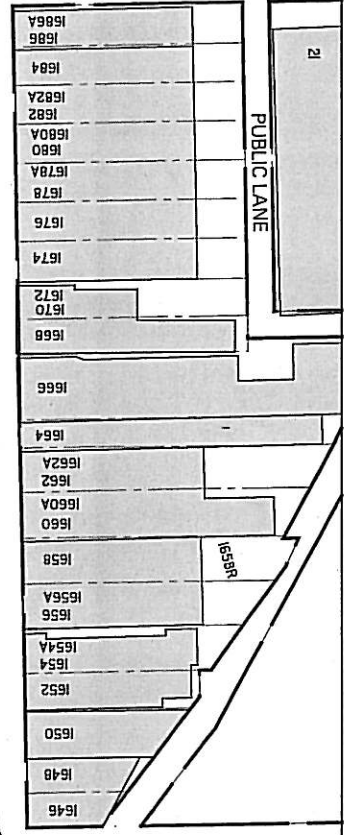

PRESCOTT AVENUE

ST. CLAIR AVENUE WEST

MATCH LINE DWG. NO. 421F - 9923

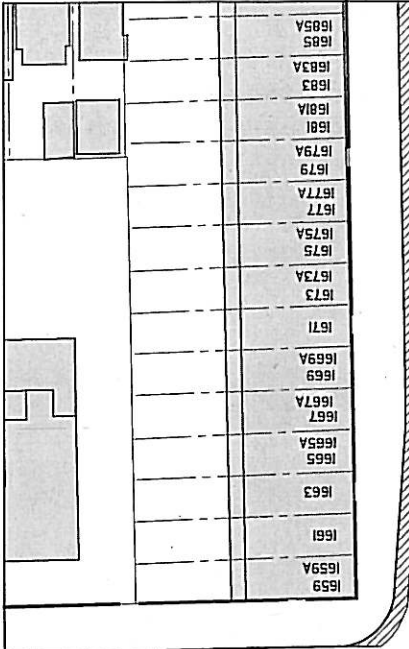

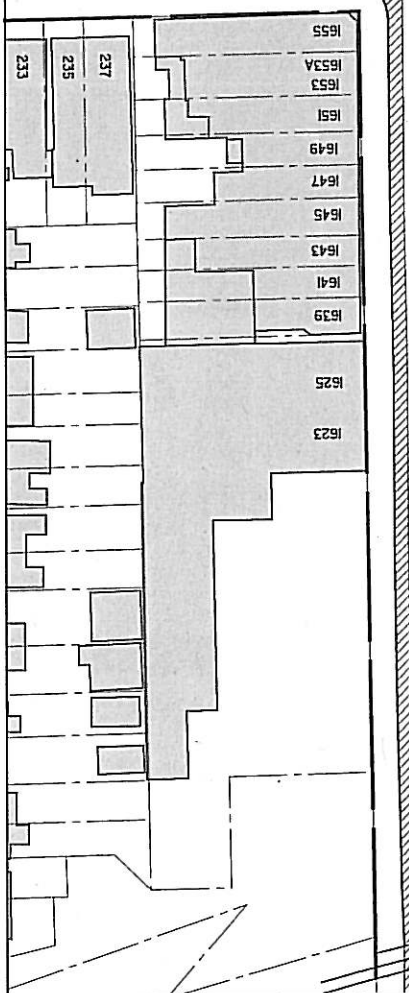

LAUGHTON AVENUE



**ST. CLAIR AVENUE WEST: COBALT AVENUE - CALEDONIA ROAD
EXISTING NO STOPPING REGULATIONS TO BE RESCINDED (Sheet 8 of 9)**

LEGEND



-  EXISTING " NO STOPPING " FROM 4:00pm - 6:00pm, EXCEPT SATURDAYS, SUNDAYS & PUBLIC HOLIDAYS
-  EXISTING " NO STOPPING " FROM 7:00am - 9:00am, EXCEPT SATURDAY, SUNDAYS & PUBLIC HOLIDAYS
-  EXISTING " NO STOPPING " FROM 7:00am - 9:00am, MONDAY TO FRIDAY, EXCEPT PUBLIC HOLIDAYS

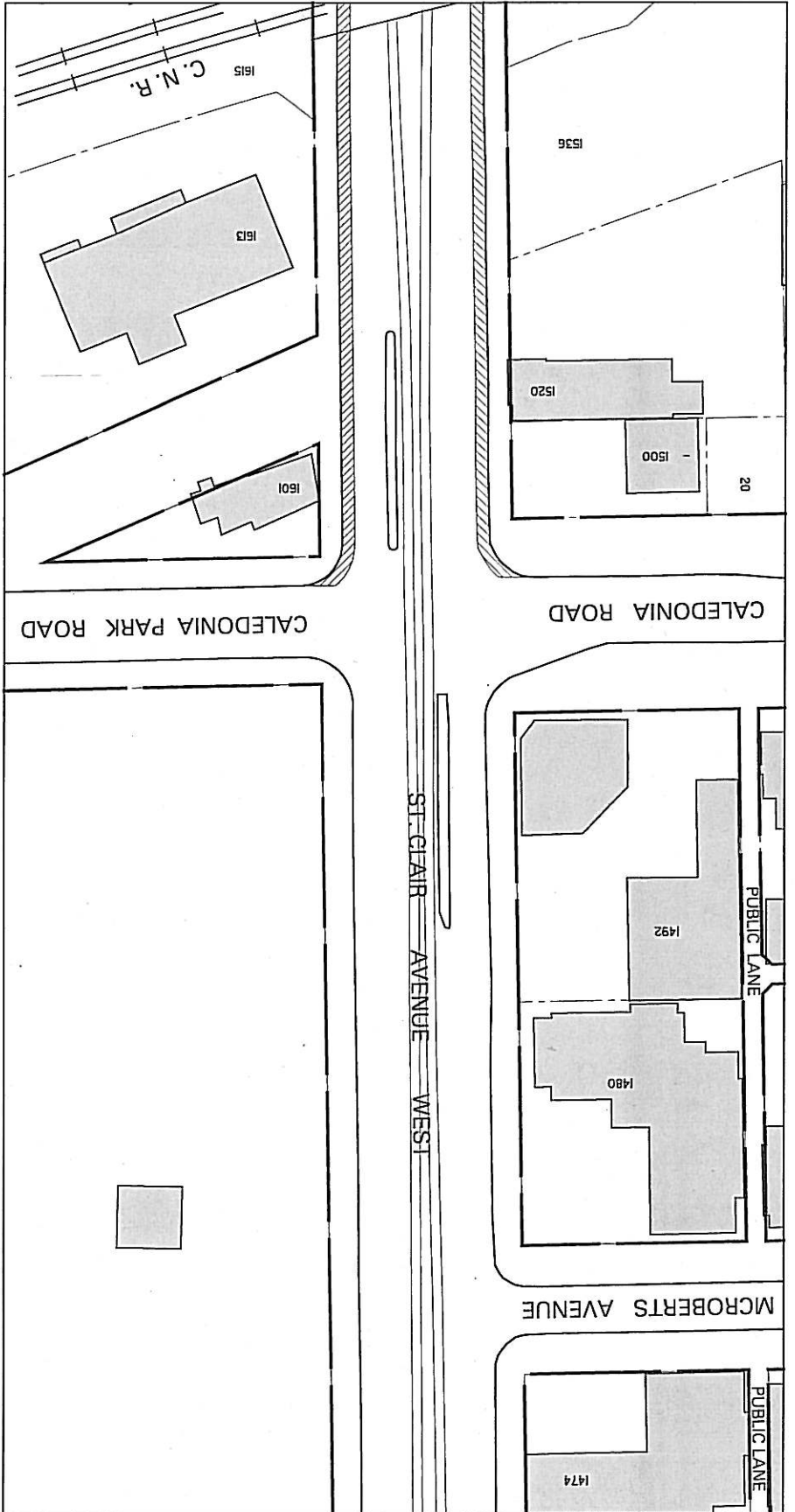



**ST. CLAIR AVENUE WEST: COBALT AVENUE - CALEDONIA ROAD
EXISTING NO STOPPING REGULATIONS TO BE RESCINDED (Sheet 9 of 9)**

LEGEND

-  EXISTING " NO STOPPING " FROM 4:00pm - 6:00pm, EXCEPT SATURDAYS, SUNDAYS & PUBLIC HOLIDAYS
-  EXISTING " NO STOPPING " FROM 7:00am - 9:00am, EXCEPT SATURDAY, SUNDAYS & PUBLIC HOLIDAYS



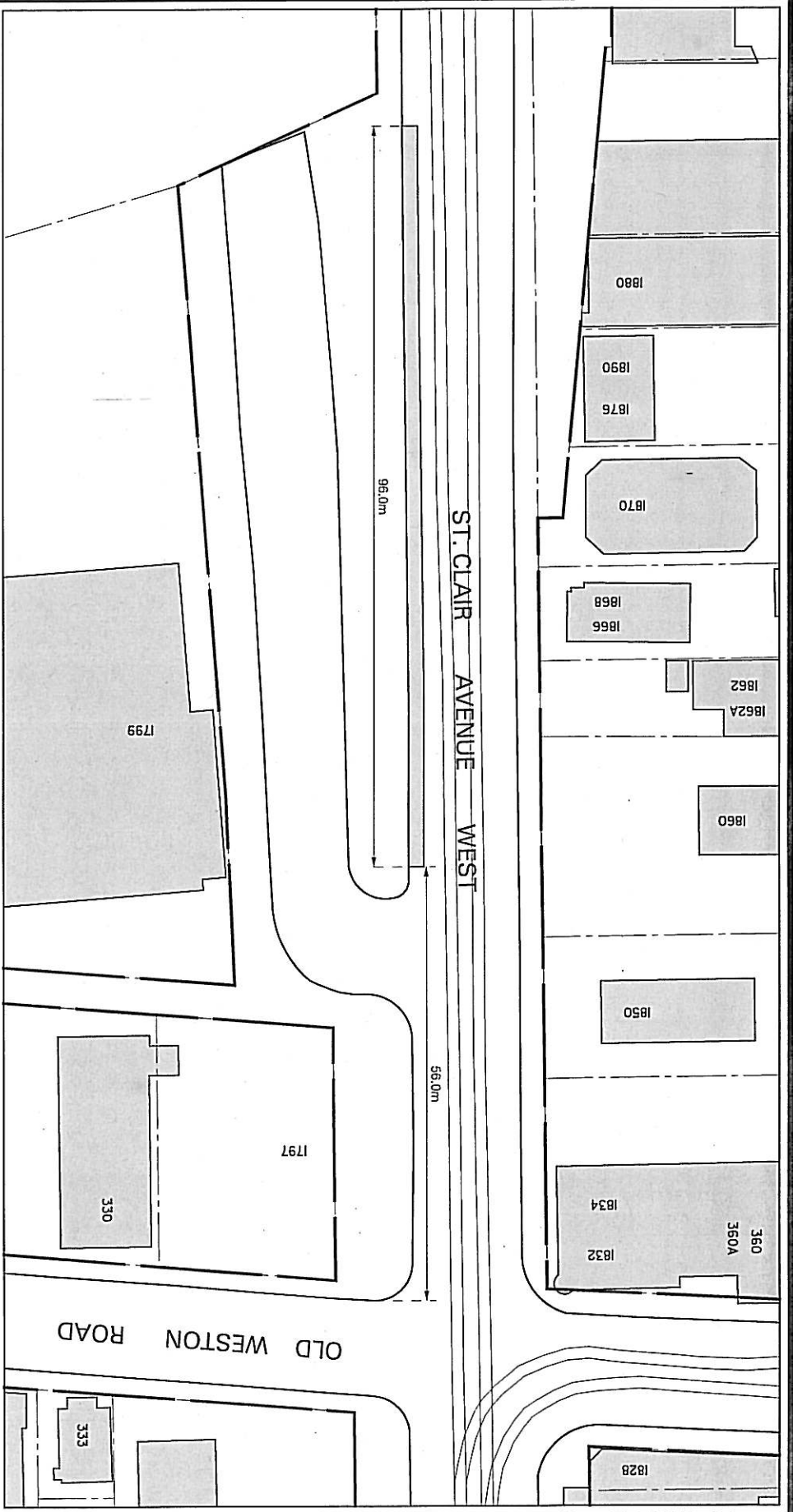

**ST. CLAIR AVENUE WEST & OLD WESTON ROAD
EXISTING NO STANDING ANYTIME REGULATION TO BE RESCINDED**

LEGEND

EXISTING " NO STANDING ANYTIME "

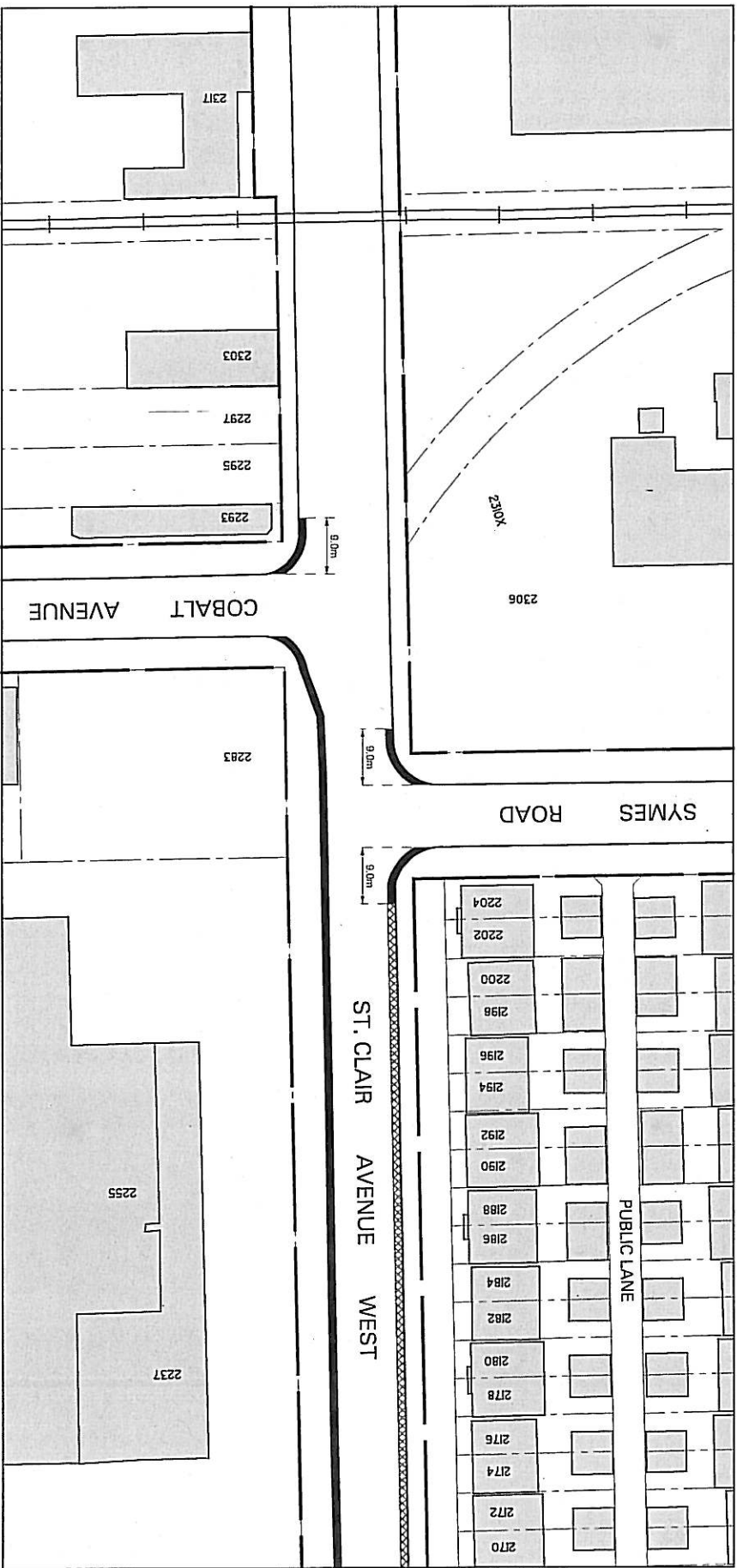

ST. CLAIR AVENUE WEST: COBALT AVENUE - C. N. R. OVERPASS (Sheet 1 of 8)
EXISTING PARKING REGULATIONS TO BE RESCINDED

LEGEND

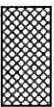
-  NO PARKING ANYTIME
-  1 HOUR PARKING LIMIT FROM 9am - 4pm,
MON. to FRI. & 8am - 6pm, SAT.



MATCH LINE DWG. NO. 421F - 9929

MATCH LINE DWG. NO. 421F - 9931

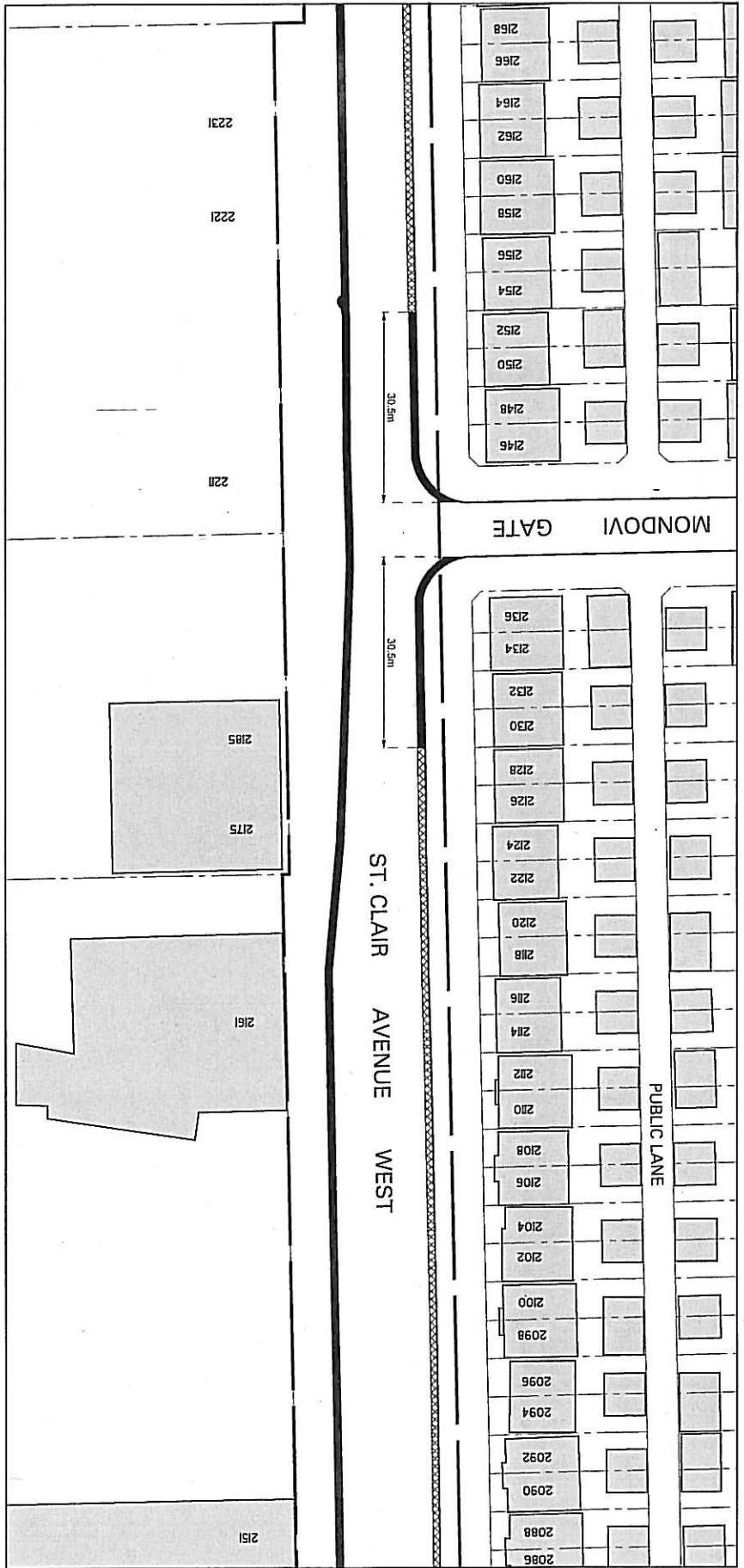

ST. CLAIR AVENUE WEST: COBALT AVENUE - C. N. R. OVERPASS (Sheet 2 of 8)
EXISTING PARKING REGULATIONS TO BE RESCINDED

LEGEND

■ NO PARKING ANYTIME

▨ 1 HOUR PARKING LIMIT FROM 9am - 4pm,
 MON. to FRI. & Sat. - 6pm, SAT.



MATCH LINE DWG. NO. 421F - 9930

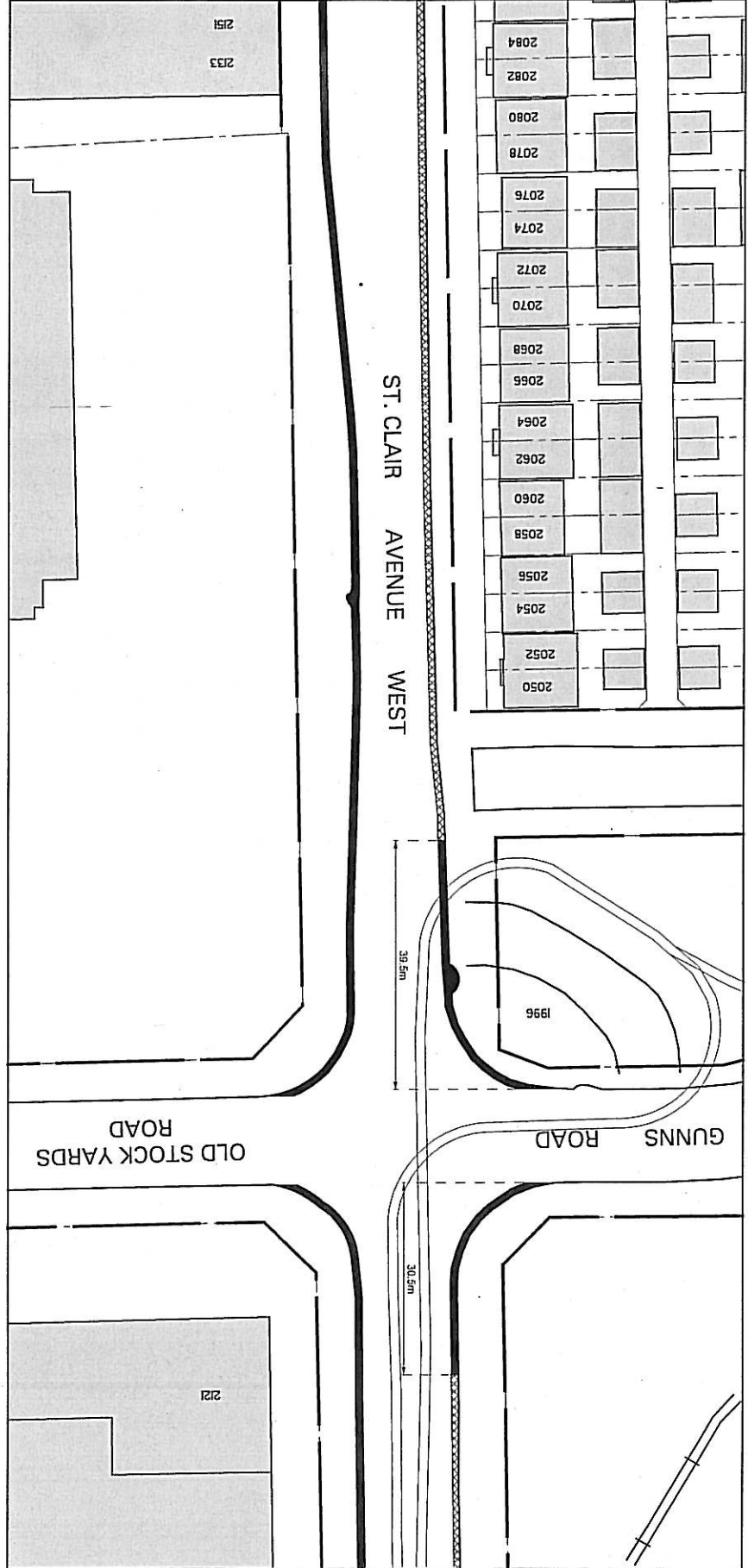

MATCH LINE DWG. NO. 421F - 9932

ST. CLAIR AVENUE WEST: COBALT AVENUE - C. N. R. OVERPASS (Sheet 3 of 8)
EXISTING PARKING REGULATIONS TO BE RESCINDED

LEGEND

-  NO PARKING ANYTIME
-  1 HOUR PARKING LIMIT FROM 9am - 4pm,
MON. to FRI. & 8am - 6pm, SAT.

DWG. NO. 421F - 9931

A. A.

SCALE 1 : 1000

FEBRUARY, 2010

TRANSPORTATION SERVICES TORONTO & EAST YORK DISTRICT



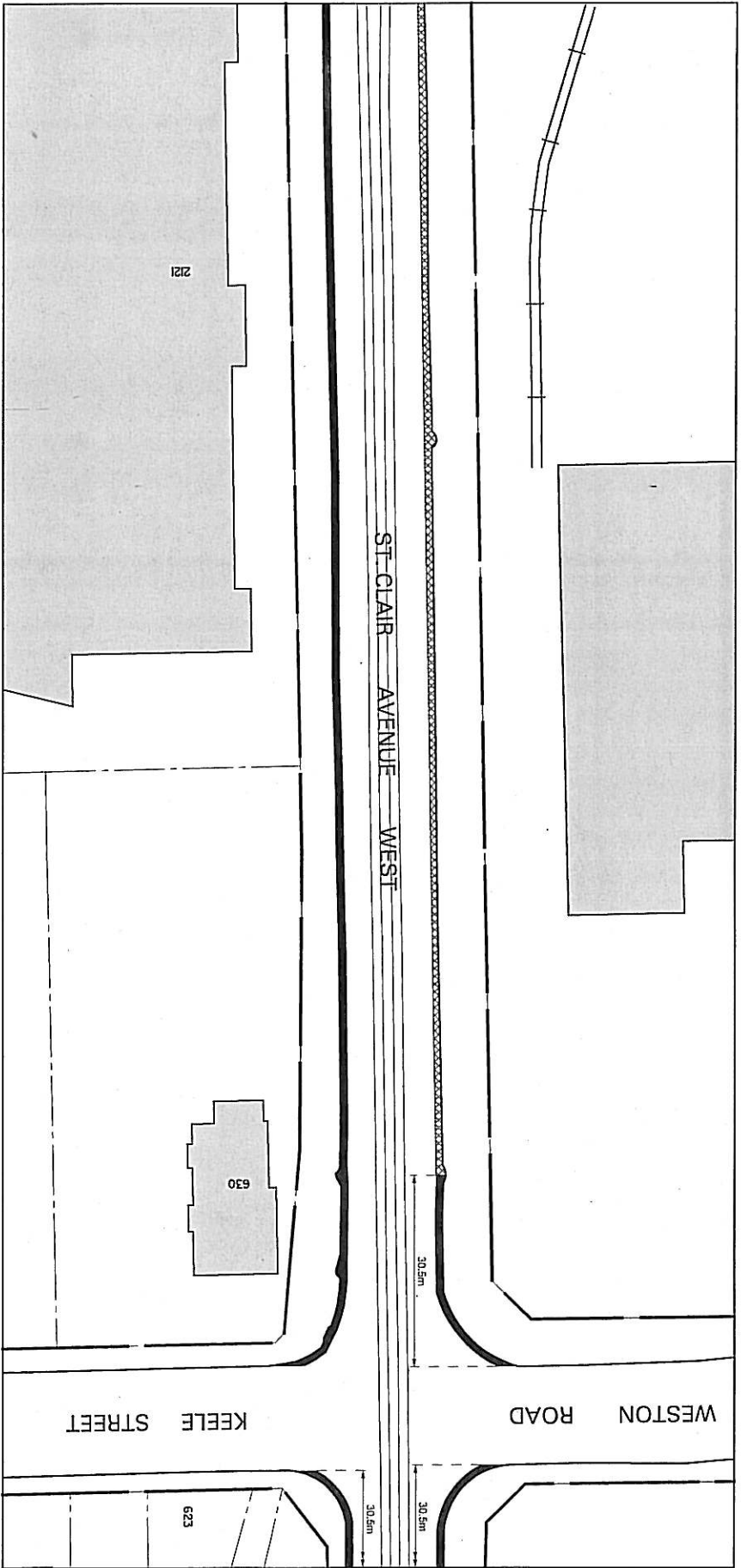

ST. CLAIR AVENUE WEST: COBALT AVENUE - C. N. R. OVERPASS (Sheet 4 of 8)
EXISTING PARKING REGULATIONS TO BE RESCINDED

LEGEND

■ NO PARKING ANYTIME

▨ 1 HOUR PARKING LIMIT FROM 9am - 4pm,
 MON. to FRI. & 8am - 6pm, SAT.



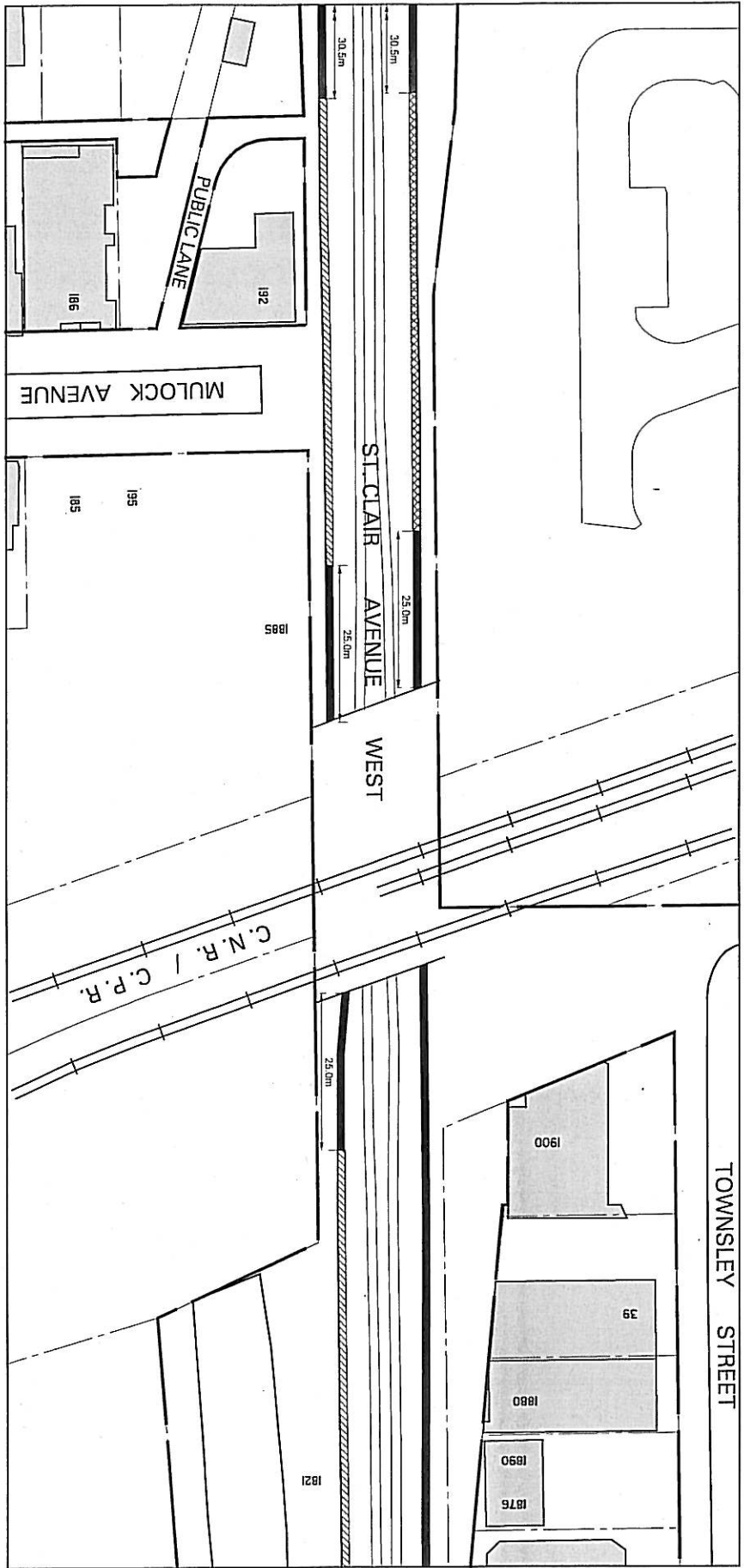

ST. CLAIR AVENUE WEST: COBALT AVENUE - C. N. R. OVERPASS (Sheet 5 of 8)
EXISTING PARKING REGULATIONS TO BE RESCINDED

LEGEND

-  NO PARKING ANYTIME
-  1 HOUR PARKING LIMIT FROM 8am - 4pm
-  1 HOUR PARKING LIMIT FROM 9am - 4pm,
MON. to FRI. & 8am - 6pm, SAT.





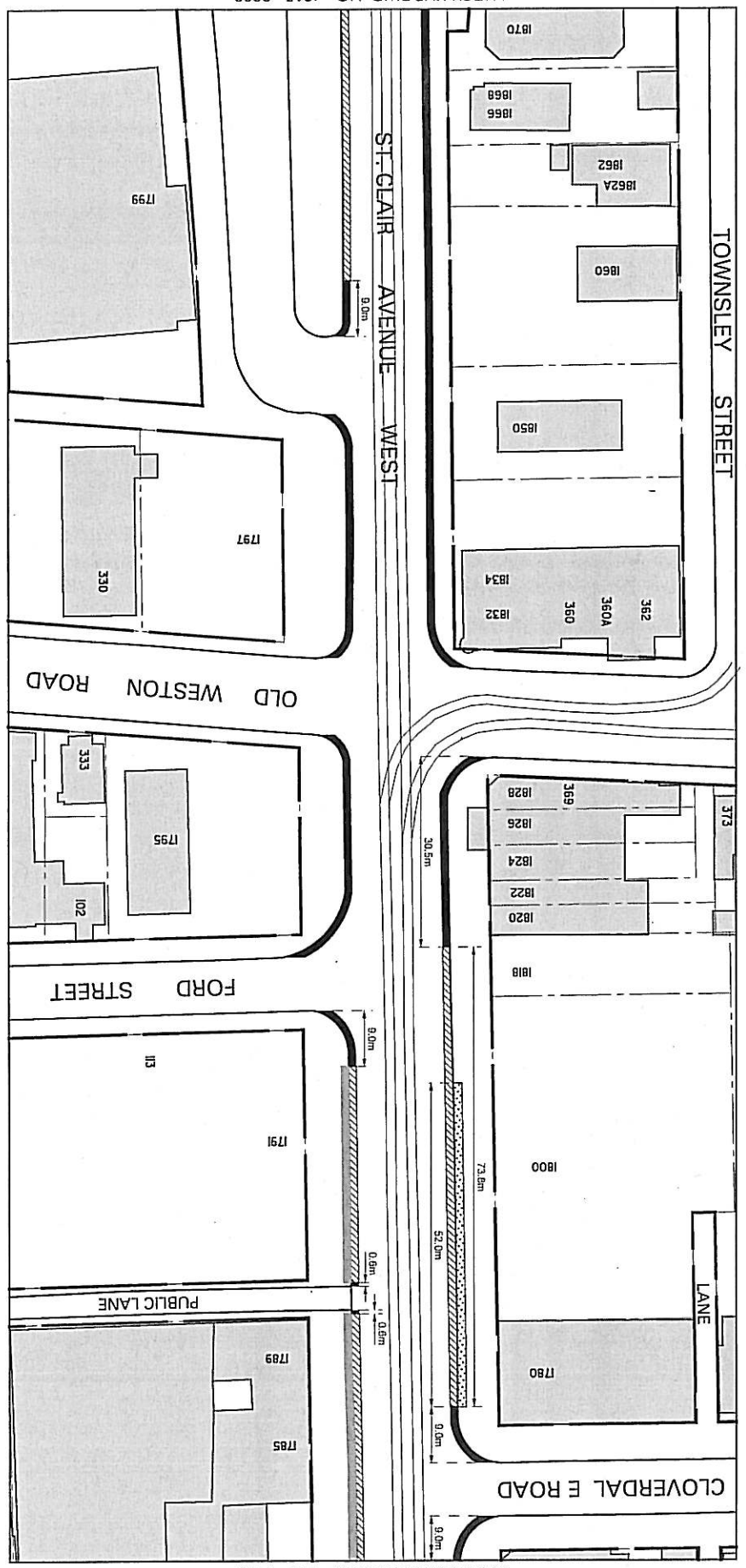

MATCH LINE DWG. NO. 421F - 9933

MATCH LINE DWG. NO. 421F - 9935



ST. CLAIR AVENUE WEST: COBALT AVENUE - C. N. R. OVERPASS (Sheet 6 of 8)
EXISTING PARKING REGULATIONS TO BE RESCINDED



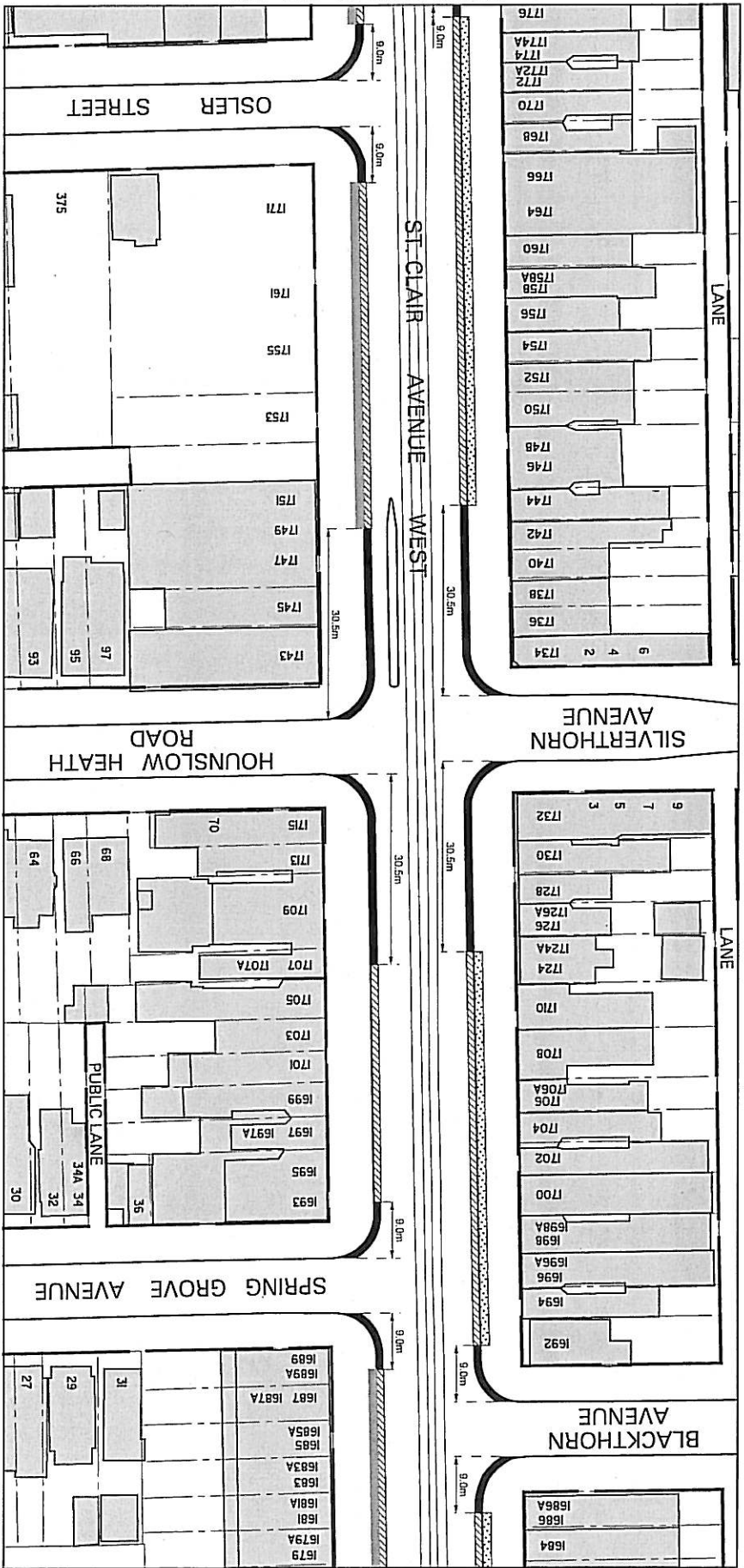

- LEGEND**
-  NO PARKING ANYTIME
 -  1 HOUR PARKING LIMIT FROM 8am - 4pm
 -  MAXIMUM 3 HR PARKING MACHINES
8am - 4pm, MON. to FRI. & 8am - 6pm SAT.
 -  MAXIMUM 3 HR PARKING MACHINES
9am - 6pm, MON. to FRI. & 8am - 6pm SAT.



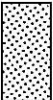

ST. CLAIR AVENUE WEST: COBALT AVENUE - C. N. R. OVERPASS (Sheet 7 of 8)
EXISTING PARKING REGULATIONS TO BE RESCINDED

LEGEND



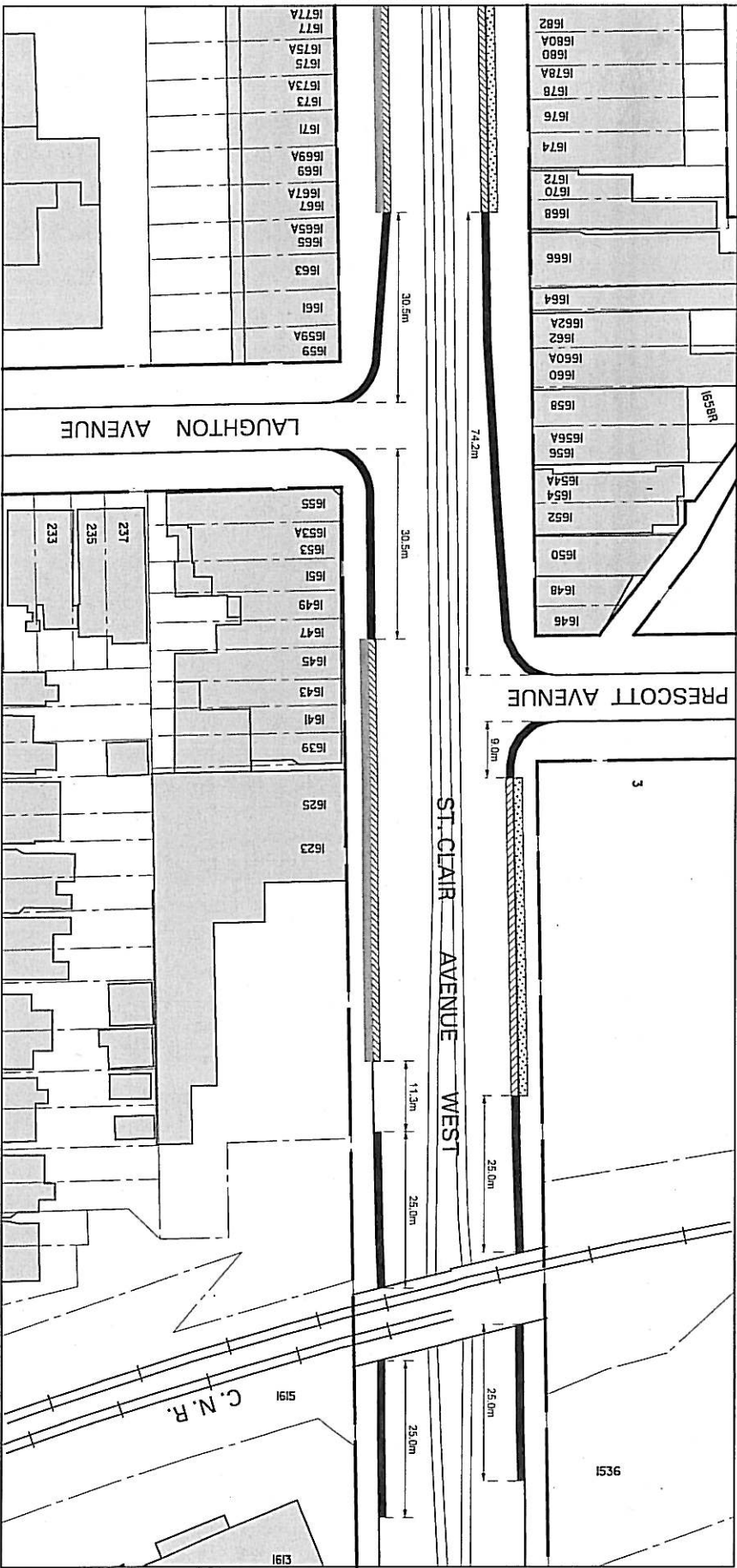

-  NO PARKING ANYTIME
-  1 HOUR PARKING LIMIT FROM 8am - 4pm
-  MAXIMUM 3 HR PARKING MACHINES
8am - 4pm, MON. to FRI. & 8am - 6pm SAT.
-  MAXIMUM 3 HR PARKING MACHINES
9am - 6pm, MON. to FRI. & 8am - 6pm SAT.





ST. CLAIR AVENUE WEST: COBALT AVENUE - C. N. R. OVERPASS (Sheet 8 of 8)
EXISTING PARKING REGULATIONS TO BE RESCINDED

LEGEND

-  NO PARKING ANYTIME
-  1 HOUR PARKING LIMIT FROM 8am - 4pm
-  1 HOUR PARKING LIMIT FROM 9am - 4pm
-  MAXIMUM 3 HR PARKING MACHINES 8am - 4pm, MON. to FRI. & 8am - 6pm SAT.
-  MAXIMUM 3 HR PARKING MACHINES 9am - 6pm, MON. to FRI. & 8am - 6pm SAT.



MATCH LINE DWG. NO. 421F - 9939

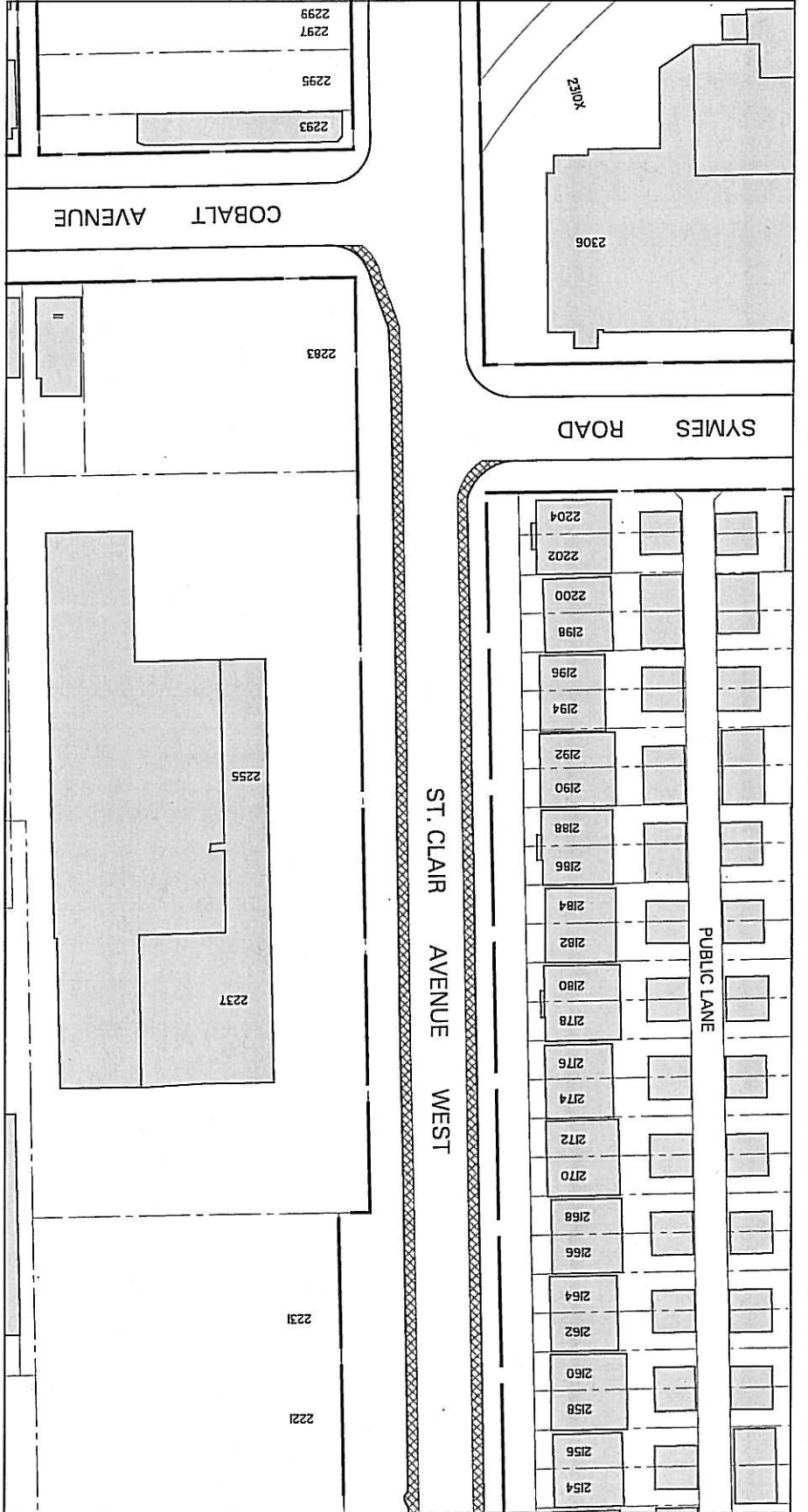

**ST. CLAIR AVENUE WEST: COBALT AVENUE - CALEDONIA ROAD
 PROPOSED NO STOPPING REGULATIONS (Sheet 1 of 9)**

LEGEND

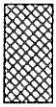

PROPOSED " NO STOPPING " FROM 7:00am - 9:00am &
 4:00pm - 6:00pm, MONDAY to FRIDAY, EXCEPT PUBLIC HOLIDAYS



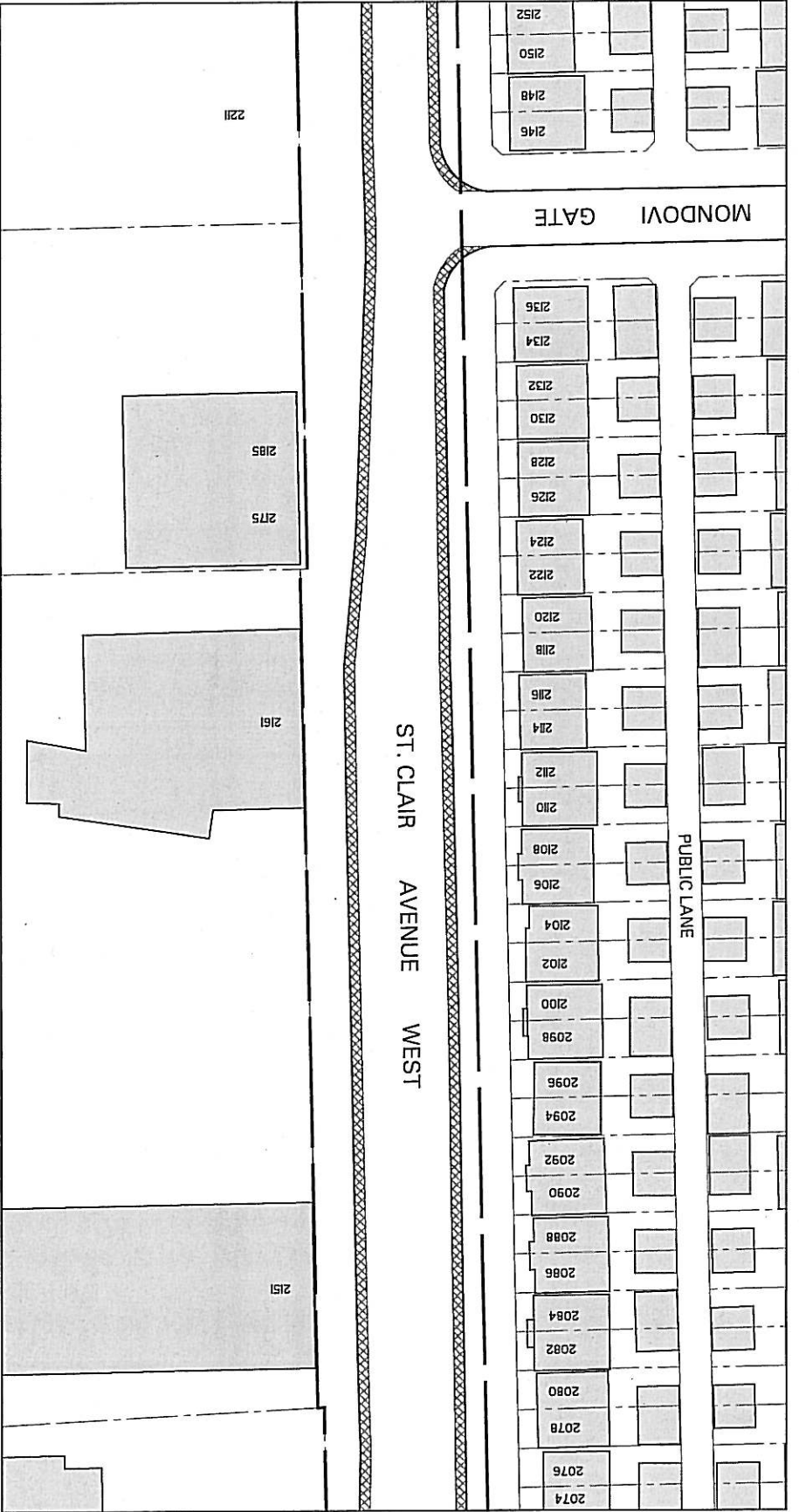

MATCH LINE DWG. NO. 421F - 9938

MATCH LINE DWG. NO. 421F - 9940

**ST. CLAIR AVENUE WEST: COBALT AVENUE - CALEDONIA ROAD
 PROPOSED NO STOPPING REGULATIONS (Sheet 2 of 9)**

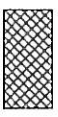

PROPOSED " NO STOPPING " FROM 7:00am - 9:00am &
 4:00pm - 6:00pm, MONDAY to FRIDAY, EXCEPT PUBLIC HOLIDAYS

LEGEND



MATCH LINE DWG. NO. 421F - 9939

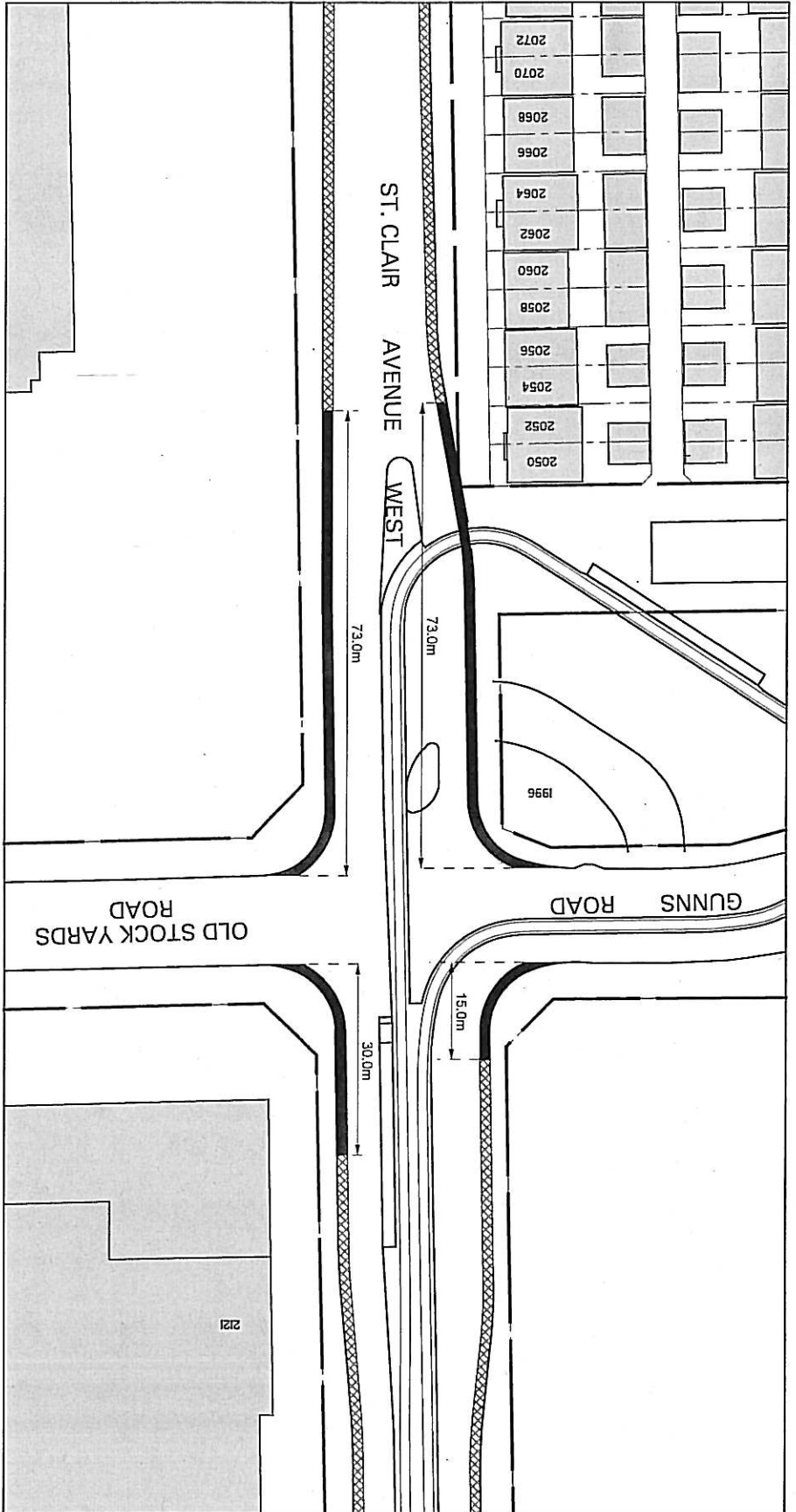

MATCH LINE DWG. NO. 421F - 9941

**ST. CLAIR AVENUE WEST: COBALT AVENUE - CALEDONIA ROAD
 PROPOSED NO STOPPING REGULATIONS (Sheet 3 of 9)**

LEGEND

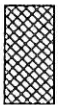
-  PROPOSED " NO STOPPING ANYTIME "
-  PROPOSED " NO STOPPING " FROM 7:00am - 9:00am & 4:00pm - 6:00pm, MONDAY to FRIDAY, EXCEPT PUBLIC HOLIDAYS



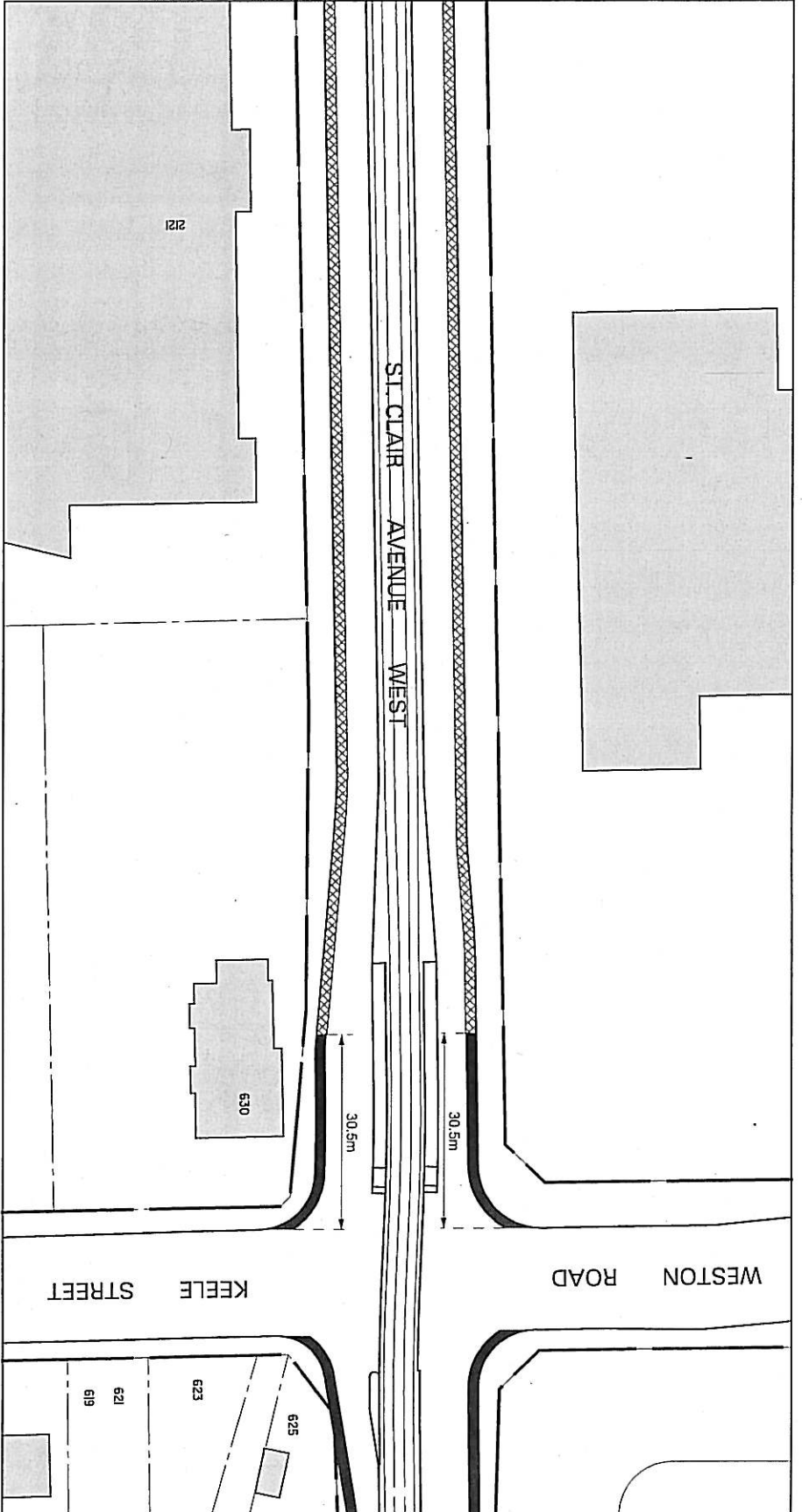

MATCH LINE DWG. NO. 421F - 9940



MATCH LINE DWG. NO. 421F - 9942

**ST. CLAIR AVENUE WEST: COBALT AVENUE - CALEDONIA ROAD
 PROPOSED NO STOPPING REGULATIONS (Sheet 4 of 9)**

LEGEND

-  PROPOSED " NO STOPPING ANYTIME "
-  PROPOSED " NO STOPPING " FROM 7:00am - 9:00am & 4:00pm - 6:00pm, MONDAY TO FRIDAY, EXCEPT PUBLIC HOLIDAYS



MATCH LINE DWG. NO. 421F - 9941

MATCH LINE DWG. NO. 421F - 9943

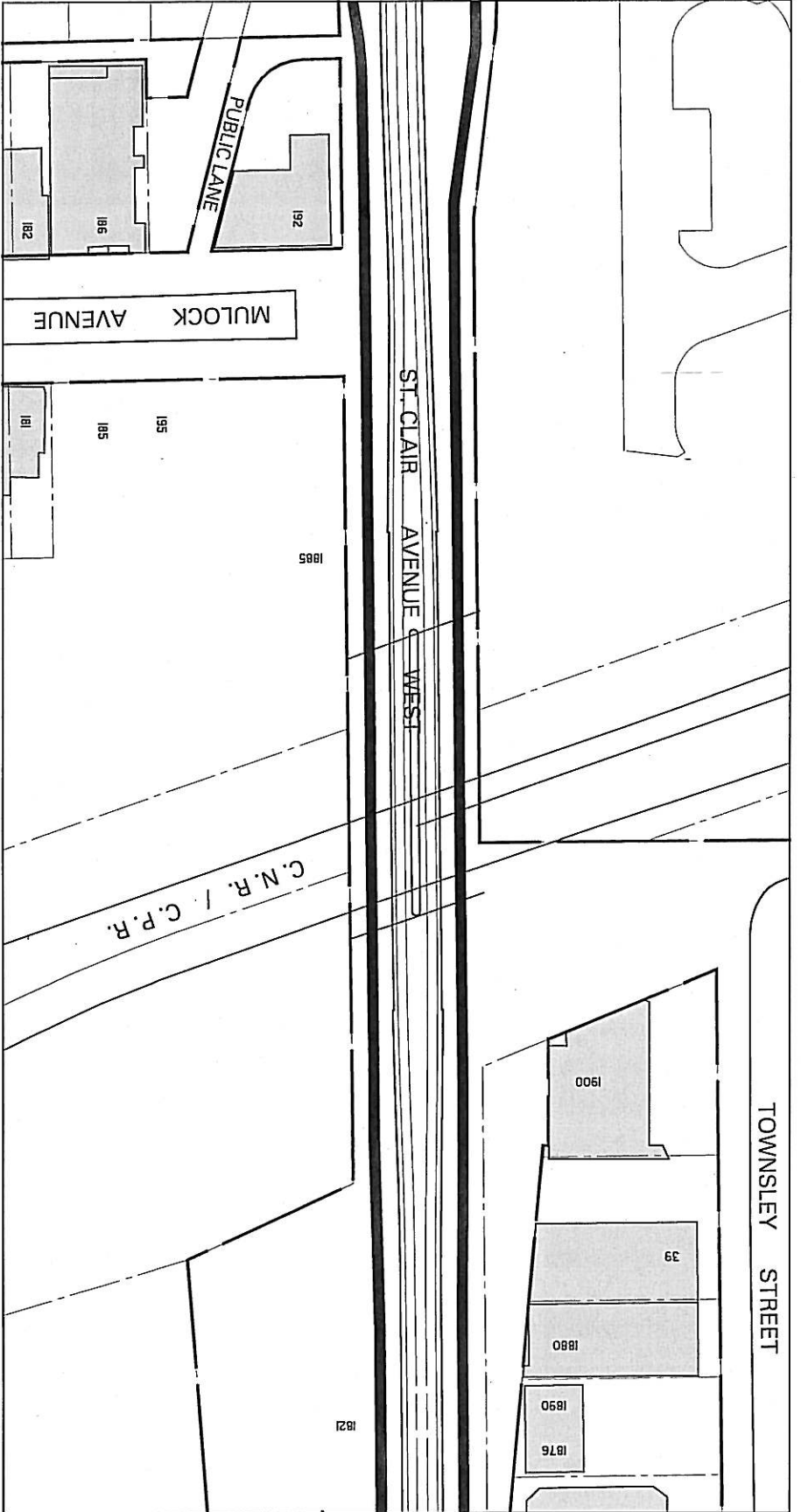

**ST. CLAIR AVENUE WEST: COBALT AVENUE - CALEDONIA ROAD
 PROPOSED NO STOPPING REGULATIONS (Sheet 5 of 9)**

LEGEND



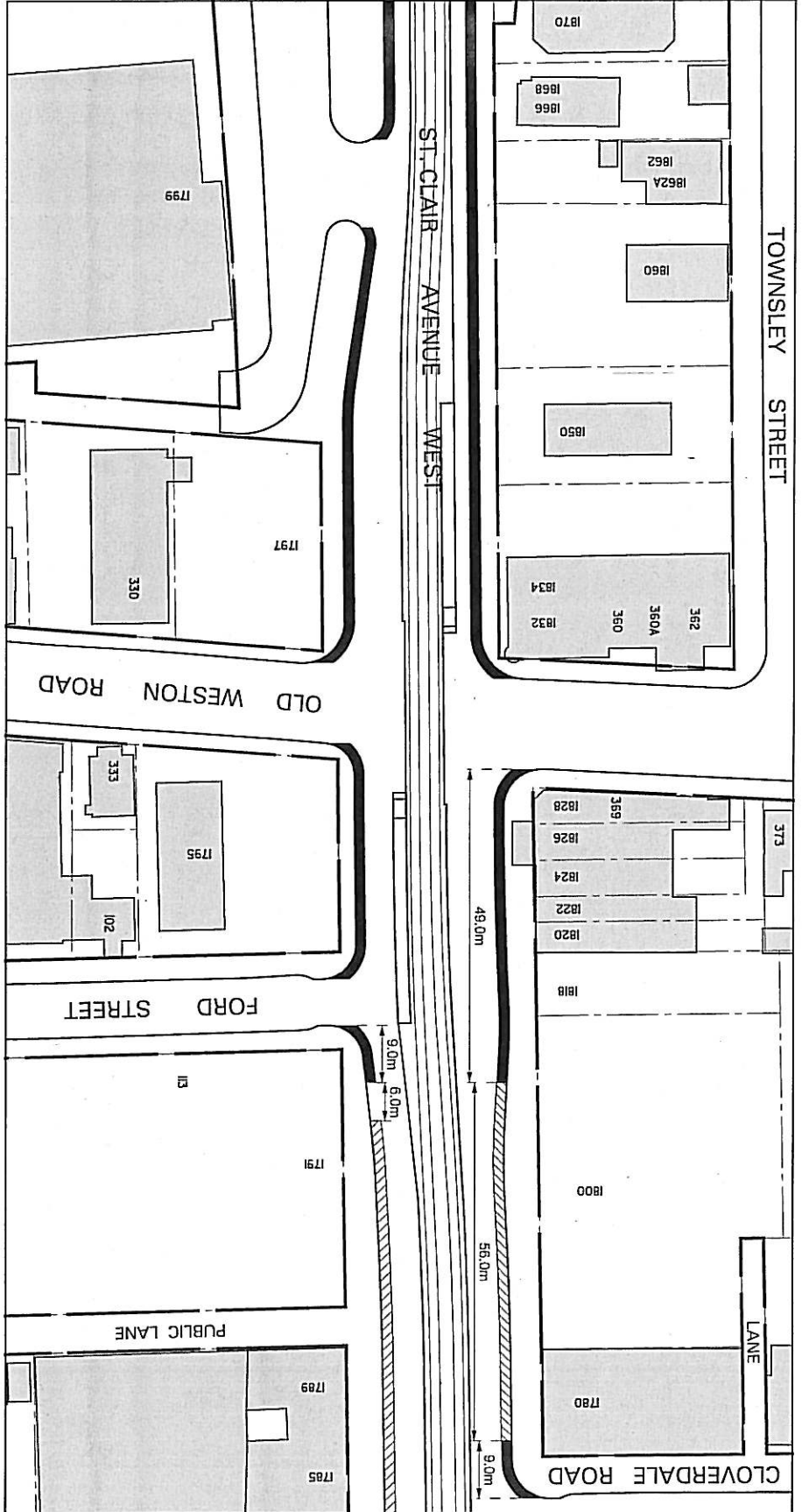

 PROPOSED "NO STOPPING ANYTIME"





**ST. CLAIR AVENUE WEST: COBALT AVENUE - CALEDONIA ROAD
 PROPOSED NO STOPPING REGULATIONS (Sheet 6 of 9)**

LEGEND



-  PROPOSED " NO STOPPING ANYTIME "
-  PROPOSED " NO STOPPING " FROM 4:00pm - 6:00pm, MONDAY to FRIDAY, EXCEPT PUBLIC HOLIDAYS
-  PROPOSED " NO STOPPING " FROM 7:00am - 9:00am, MONDAY to FRIDAY, EXCEPT PUBLIC HOLIDAYS

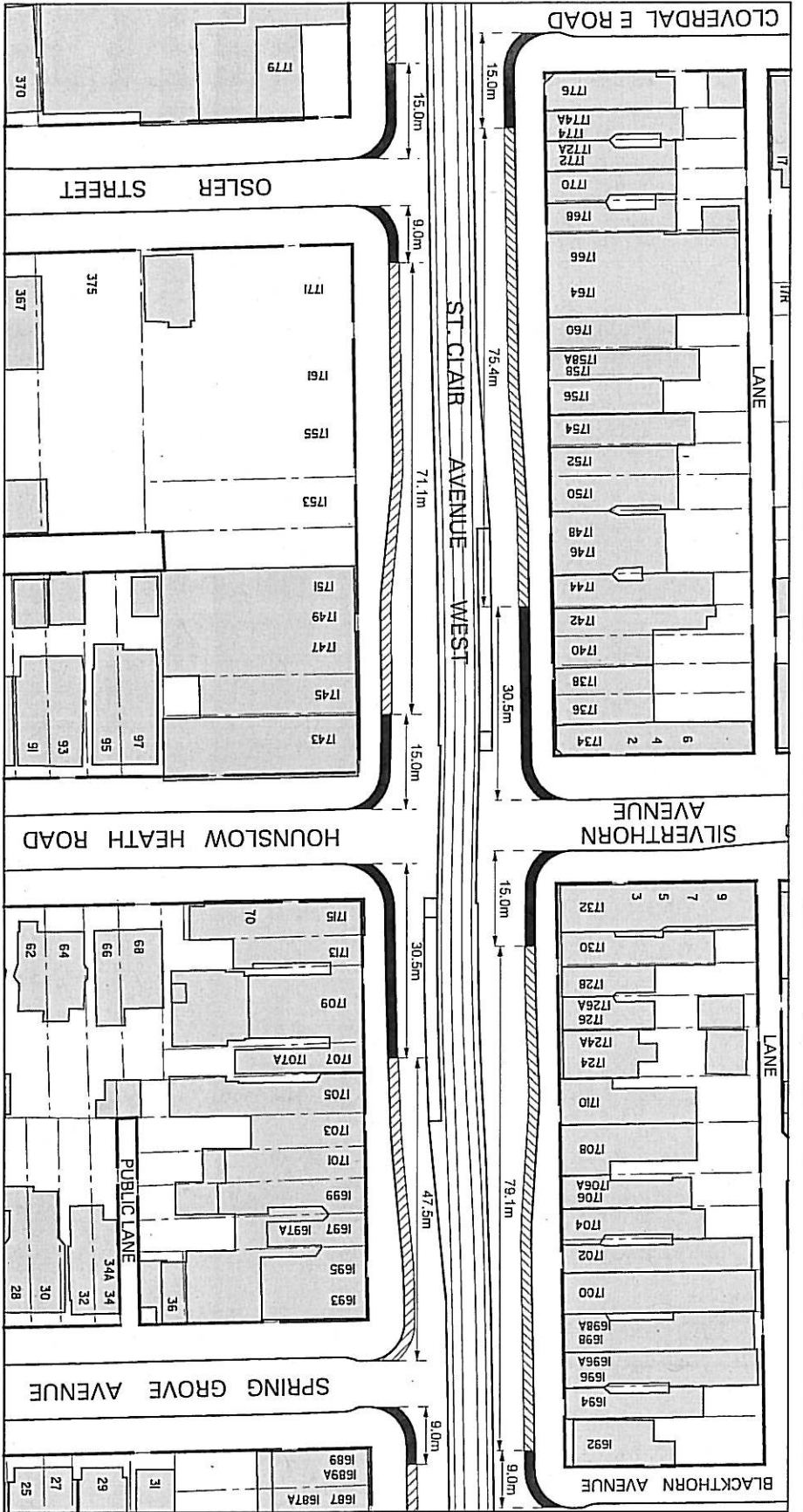



**ST. CLAIR AVENUE WEST: COBALT AVENUE - CALEDONIA ROAD
 PROPOSED NO STOPPING REGULATIONS (Sheet 7 of 9)**

LEGEND

-  PROPOSED " NO STOPPING ANYTIME "
-  PROPOSED " NO STOPPING " FROM 4:00pm - 6:00pm, MONDAY to FRIDAY, EXCEPT PUBLIC HOLIDAYS
-  PROPOSED " NO STOPPING " FROM 7:00am - 9:00am, MONDAY to FRIDAY, EXCEPT PUBLIC HOLIDAYS



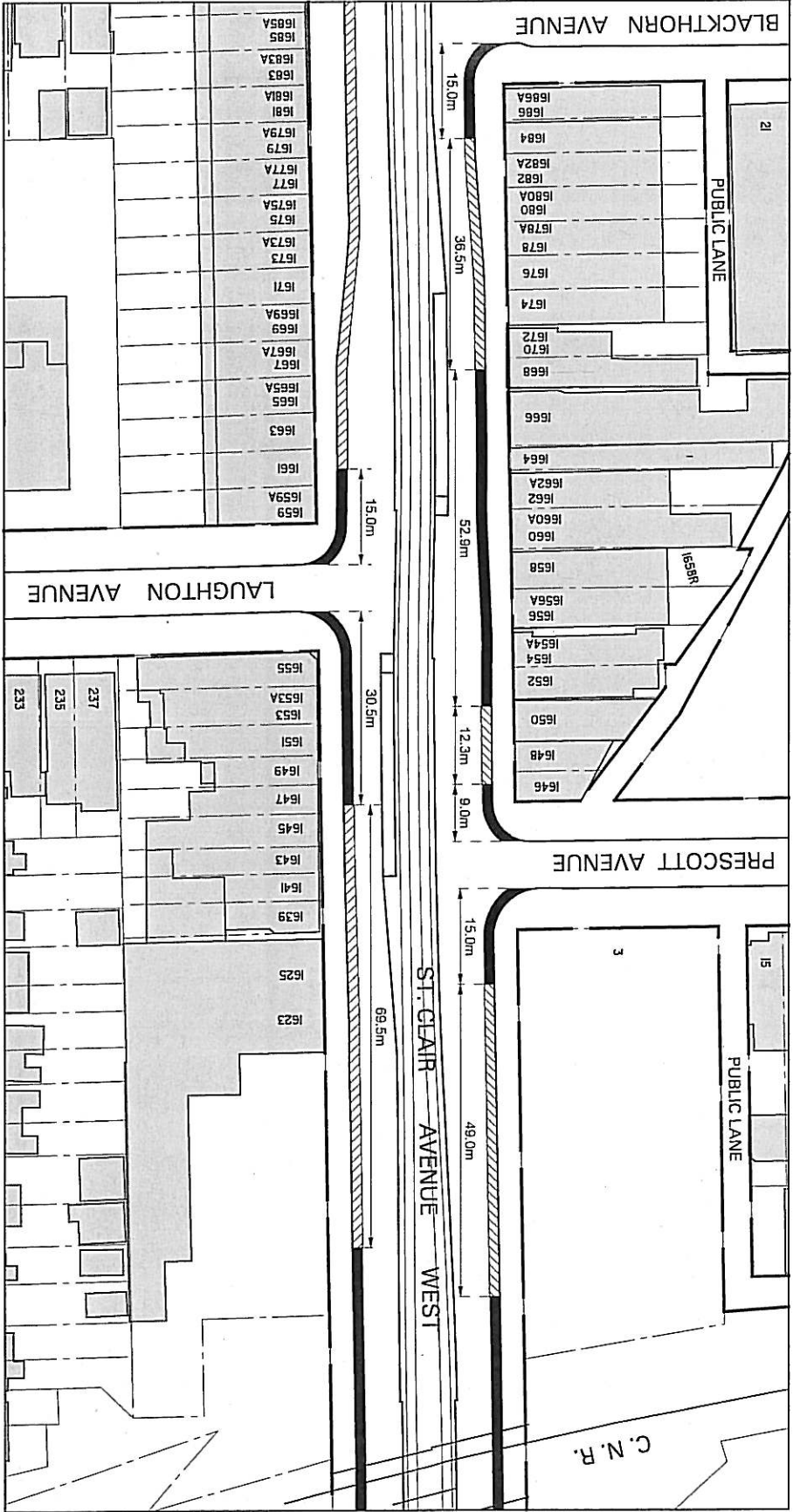

**ST. CLAIR AVENUE WEST: COBALT AVENUE - CALEDONIA ROAD
 PROPOSED NO STOPPING REGULATIONS (Sheet 8 of 9)**

LEGEND

■ PROPOSED " NO STOPPING ANYTIME "

▨ PROPOSED " NO STOPPING " FROM 4:00pm - 6:00pm,
 MONDAY TO FRIDAY, EXCEPT PUBLIC HOLIDAYS

▧ PROPOSED " NO STOPPING " FROM 7:00am - 9:00am,
 MONDAY TO FRIDAY, EXCEPT PUBLIC HOLIDAYS



MATCH LINE DWG. NO. 421F - 9945

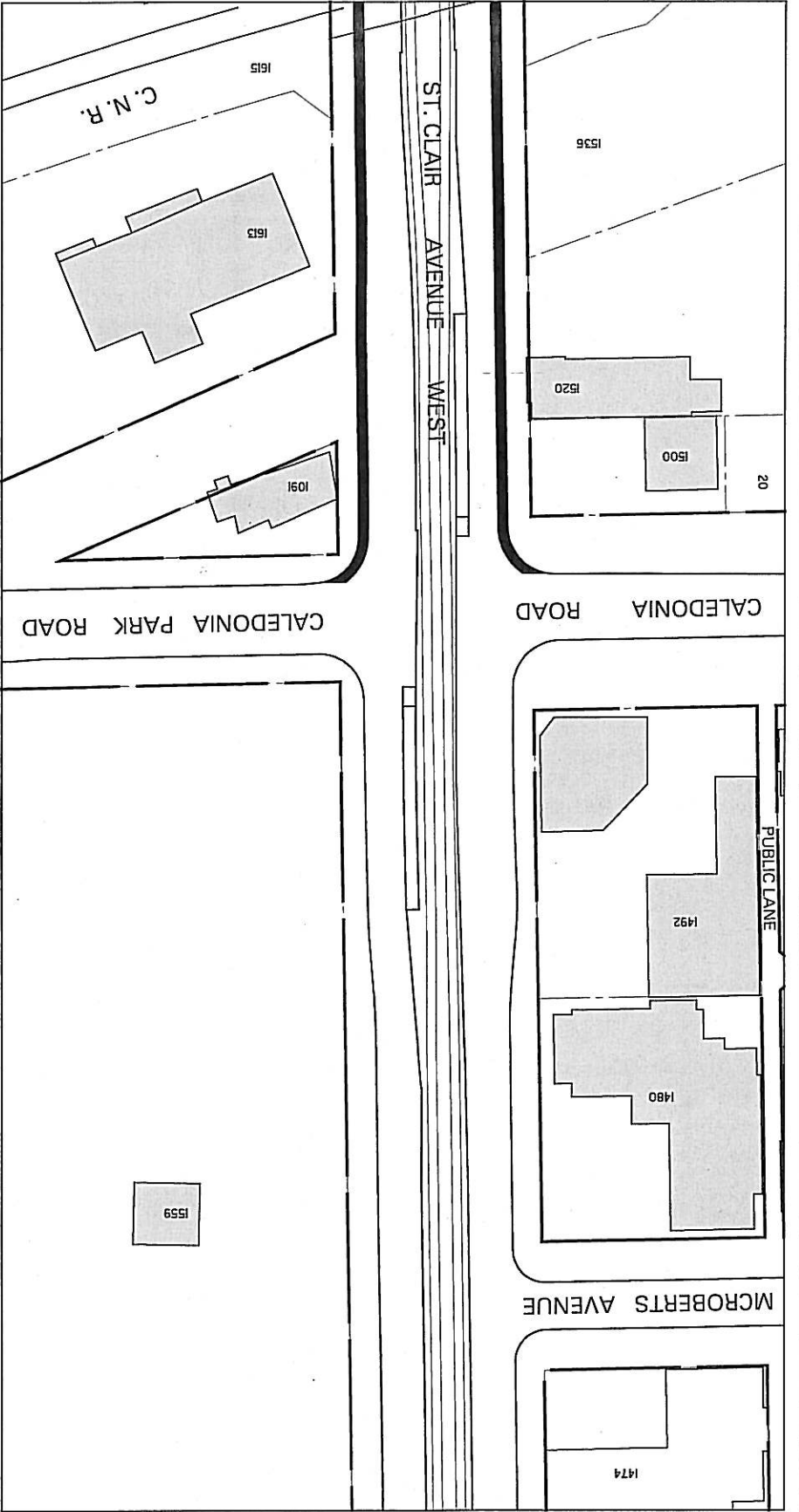

**ST. CLAIR AVENUE WEST: COBALT AVENUE - CALEDONIA ROAD
 PROPOSED NO STOPPING REGULATIONS (Sheet 9 of 9)**

LEGEND

■ PROPOSED " NO STOPPING ANYTIME "



MATCH LINE DWG. NO. 421F - 9951

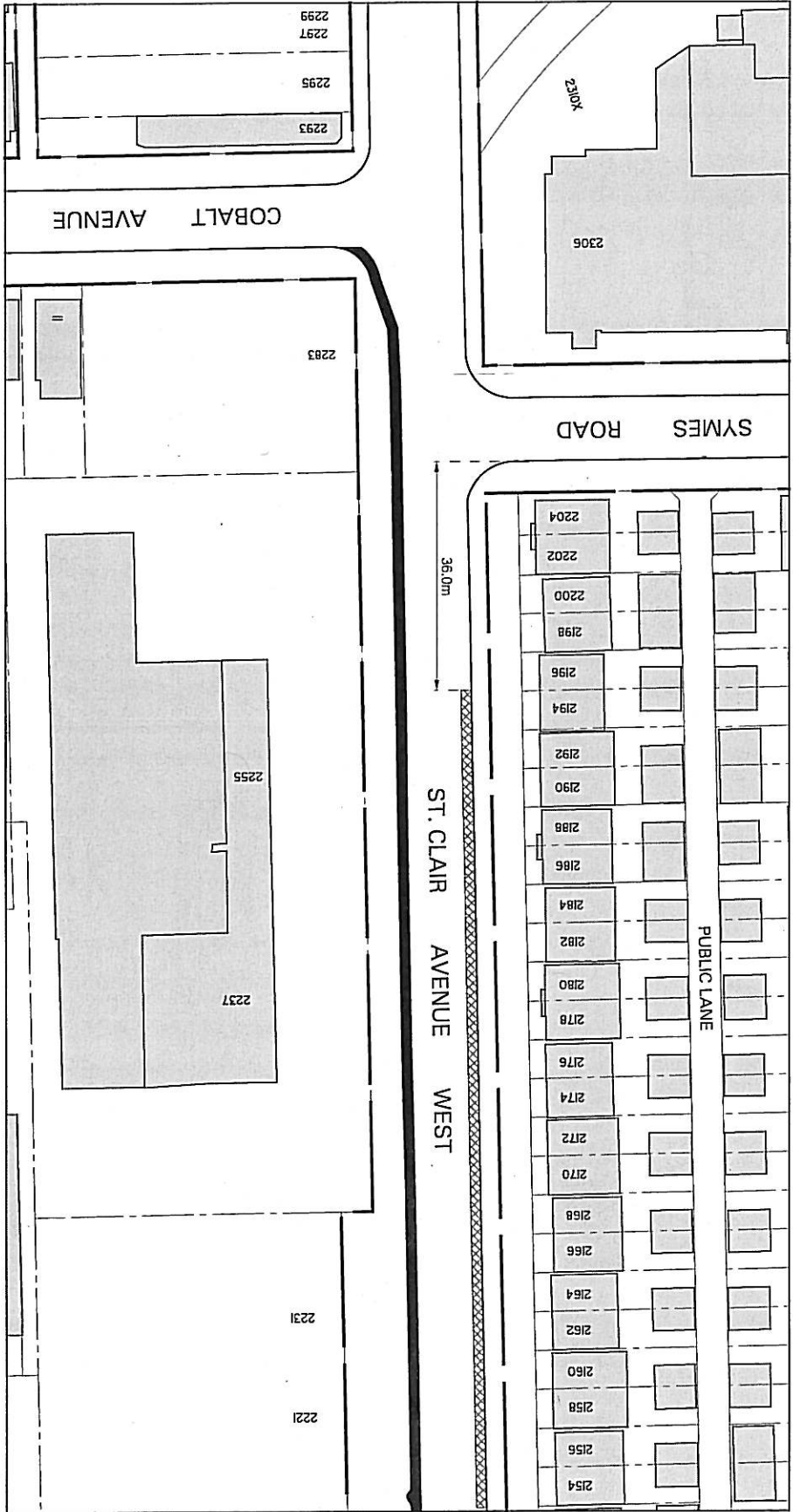

ST. CLAIR AVENUE WEST: COBALT AVENUE - C. N. R. OVERPASS (Sheet 1 of 7)
PROPOSED PARKING REGULATIONS

LEGEND

-  PROPOSED NO PARKING ANYTIME
-  PROPOSED 3 HOUR PARKING, FROM 9am - 4pm, MON. to FRI. & Sat. - 6pm, SAT.

MATCH LINE DWG. NO. 421F - 9950

MATCH LINE DWG. NO. 421F - 9952

ST. CLAIR AVENUE WEST: COBALT AVENUE - C. N. R. OVERPASS (Sheet 2 of 7) PROPOSED PARKING REGULATIONS

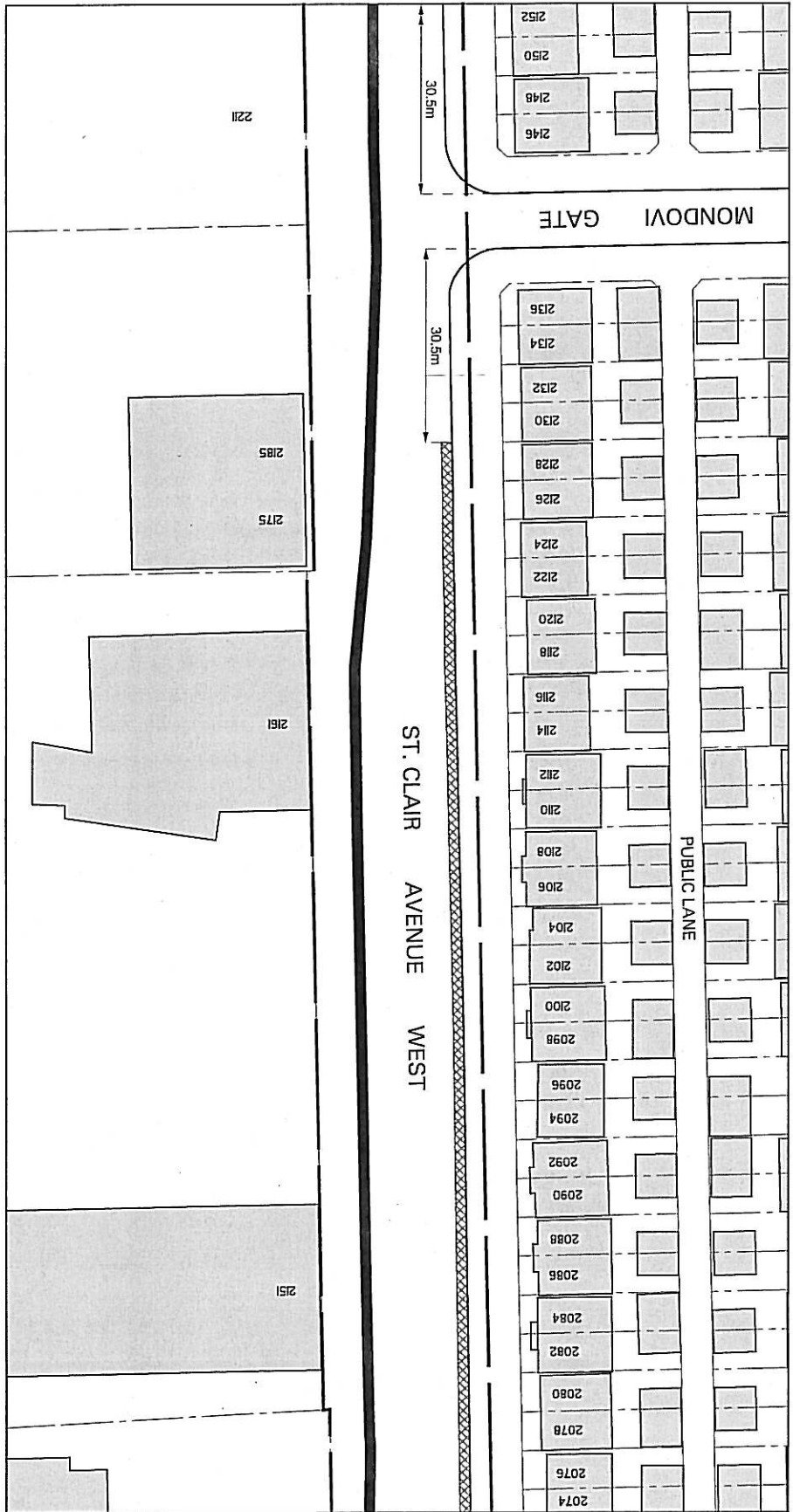

- LEGEND**
-  PROPOSED NO PARKING ANYTIME
 -  PROPOSED 3 HOUR PARKING, FROM 9am - 4pm, MON. to FRI. & Satn - 6pm, SAT.

DWG. NO. 421F - 9951

A. A.

SCALE 1 : 1000

FEBRUARY, 2010

TRANSPORTATION SERVICES TORONTO & EAST YORK DISTRICT

MATCH LINE DWG. NO. 421F - 9951

MATCH LINE DWG. NO. 421F - 9953

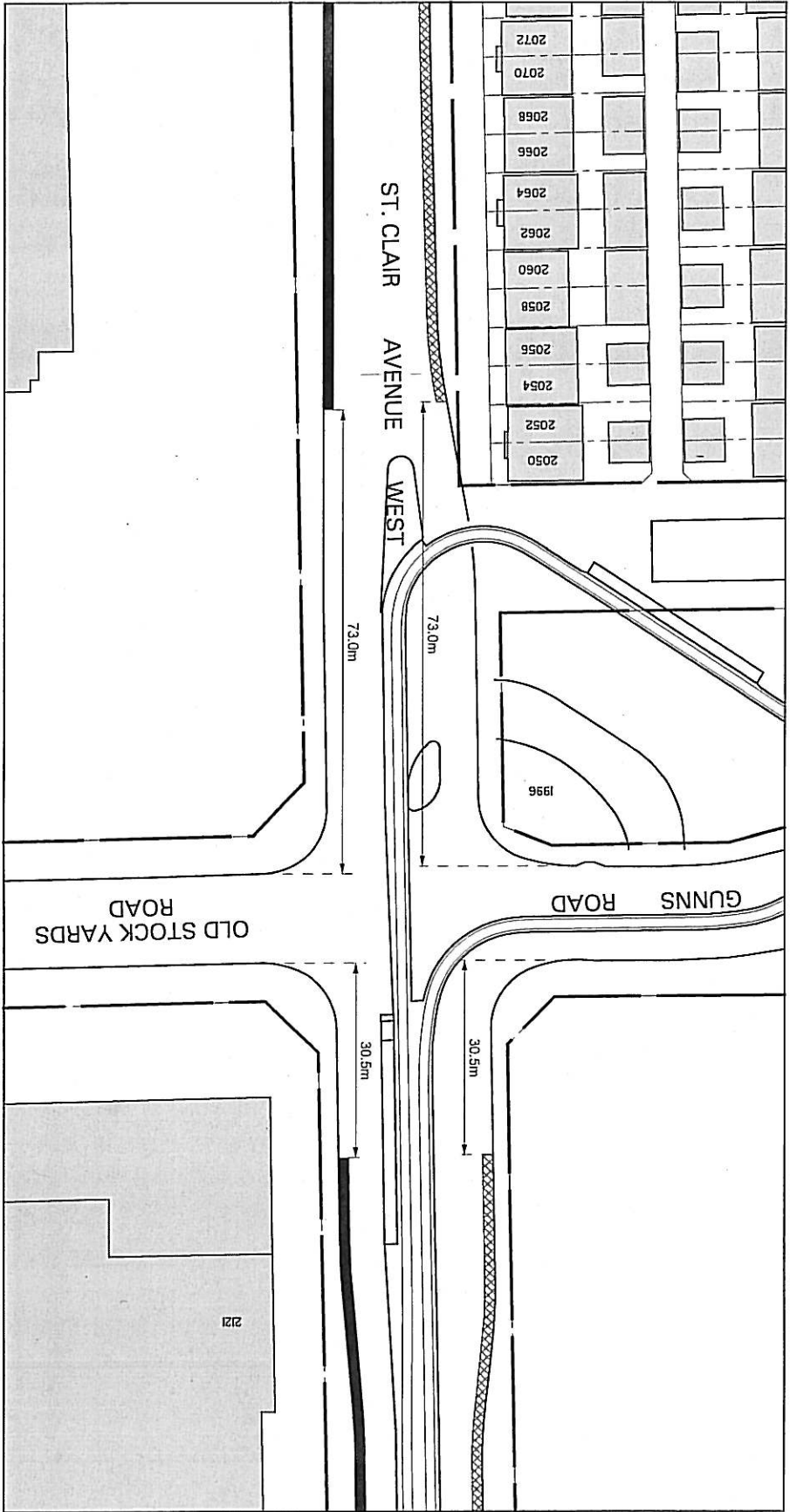



ST. CLAIR AVENUE WEST: COBALT AVENUE - C. N. R. OVERPASS (Sheet 3 of 7)
PROPOSED PARKING REGULATIONS

LEGEND

-  PROPOSED NO PARKING ANYTIME
-  PROPOSED 3 HOUR PARKING FROM 9am - 4pm, MON. to FRI. & 8am - 6pm, SAT.

ST. CLAIR AVENUE WEST: COBALT AVENUE - C. N. R. OVERPASS (Sheet 4 of 7)

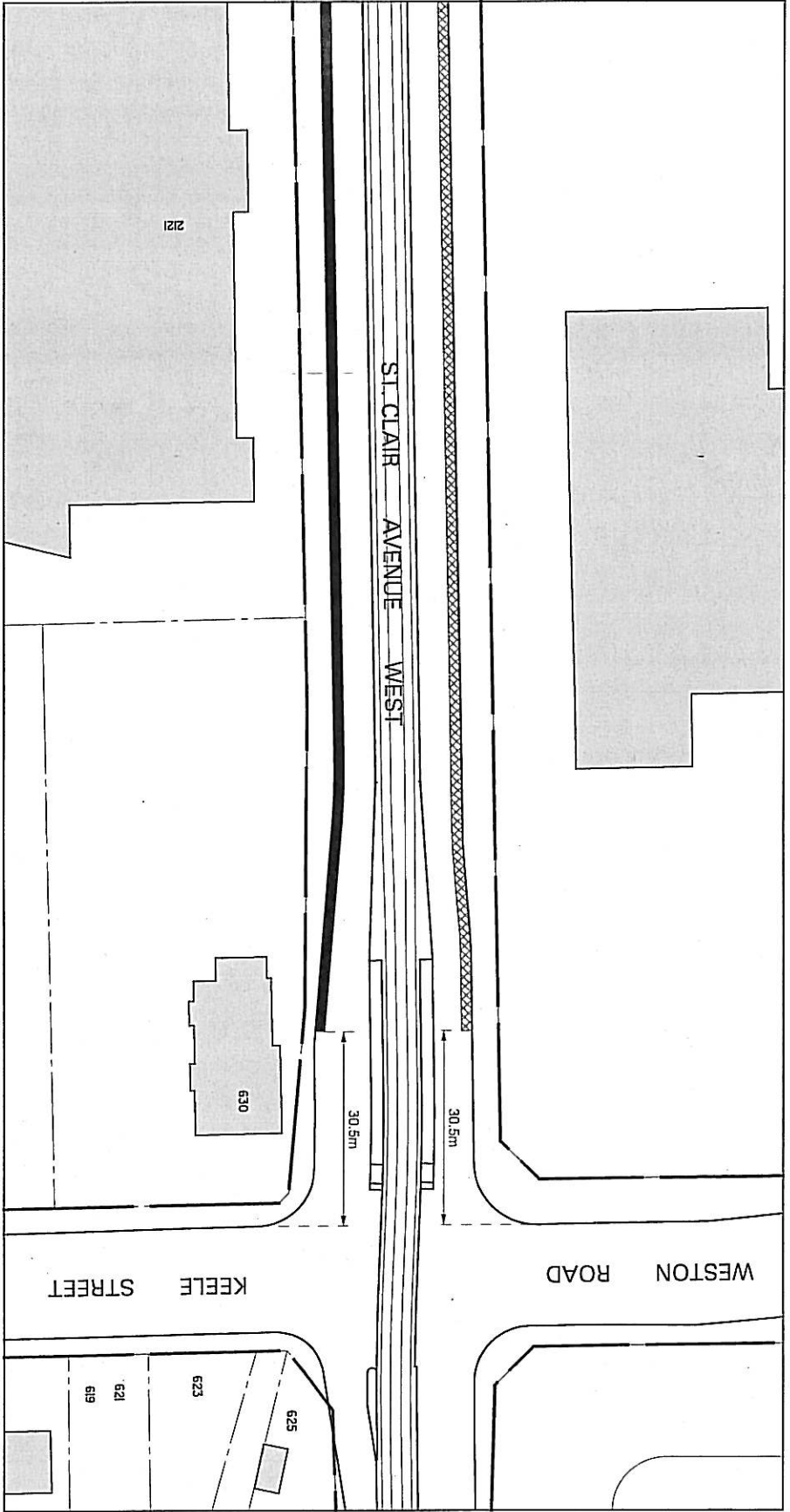

PROPOSED PARKING REGULATIONS

- LEGEND**
-  PROPOSED NO PARKING ANYTIME
 -  PROPOSED 3 HOUR PARKING FROM 9am - 4pm, MON. to FRI. & 8am - 6pm, SAT.



ST. CLAIR AVENUE WEST: COBALT AVENUE - C. N. R. OVERPASS (Sheet 5 of 7)

PROPOSED PARKING REGULATIONS

- LEGEND**
-  PROPOSED PARKING MACHINES, MAXIMUM 3 HR PARKING LIMIT 8am - 4pm, MON. to FRI. & 8am - 6pm, SAT.
 -  PROPOSED PARKING MACHINES, MAXIMUM 3 HR PARKING LIMIT 9am - 6pm, MON. to FRI. & 8am - 6pm, SAT.

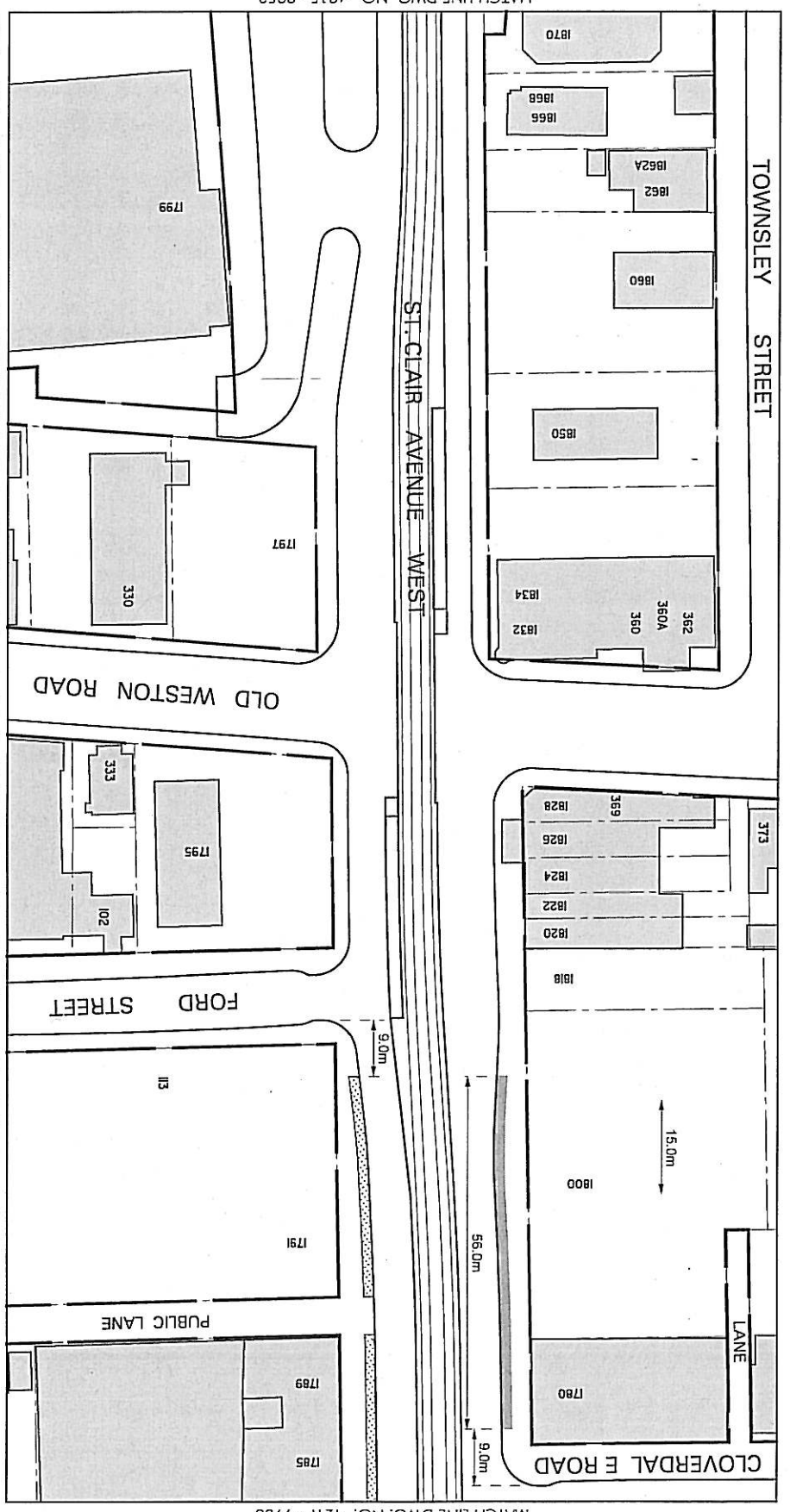

MATCH LINE DWG. NO. 421F - 9953

MATCH LINE DWG. NO. 421F - 9955

ST. CLAIR AVENUE WEST: COBALT AVENUE - C. N. R. OVERPASS (Sheet 6 of 7)

PROPOSED PARKING REGULATIONS

LEGEND

- PROPOSED NO PARKING ANYTIME
- PROPOSED PARKING MACHINES, MAXIMUM 3 HR PARKING
8am - 4pm, MON. to FRI. & 8am - 6pm, SAT.
- PROPOSED PARKING MACHINES, MAXIMUM 3 HR PARKING
9am - 6pm, MON. to FRI. & 8am - 6pm, SAT.

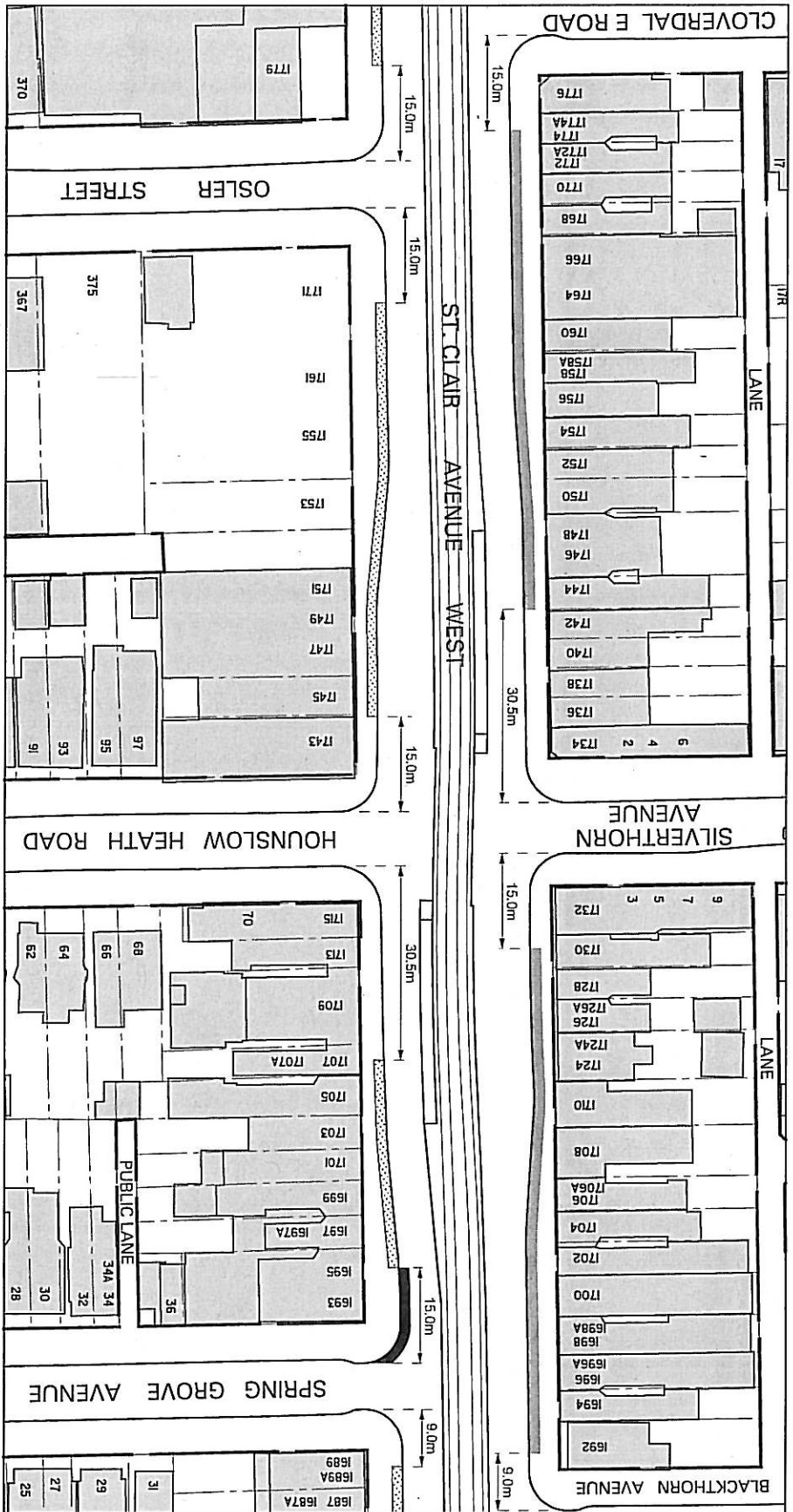

MATCH LINE DWG. NO. 421F - 9954

MATCH LINE DWG. NO. 421F - 9956

ST. CLAIR AVENUE WEST: COBALT AVENUE - C. N. R. OVERPASS (Sheet 7 of 7)

PROPOSED PARKING REGULATIONS

- LEGEND**
- PROPOSED PARKING MACHINES, MAXIMUM 3 HR PARKING
8am - 4pm, MON. to FRI. & 8am - 6pm, SAT.
 - PROPOSED PARKING MACHINES, MAXIMUM 3 HR PARKING
9am - 6pm, MON. to FRI. & 8am - 6pm, SAT.

