

## APPENDIX 'C' SKETCHES OF PRIVATE PROPERTY REQUIREMENTS

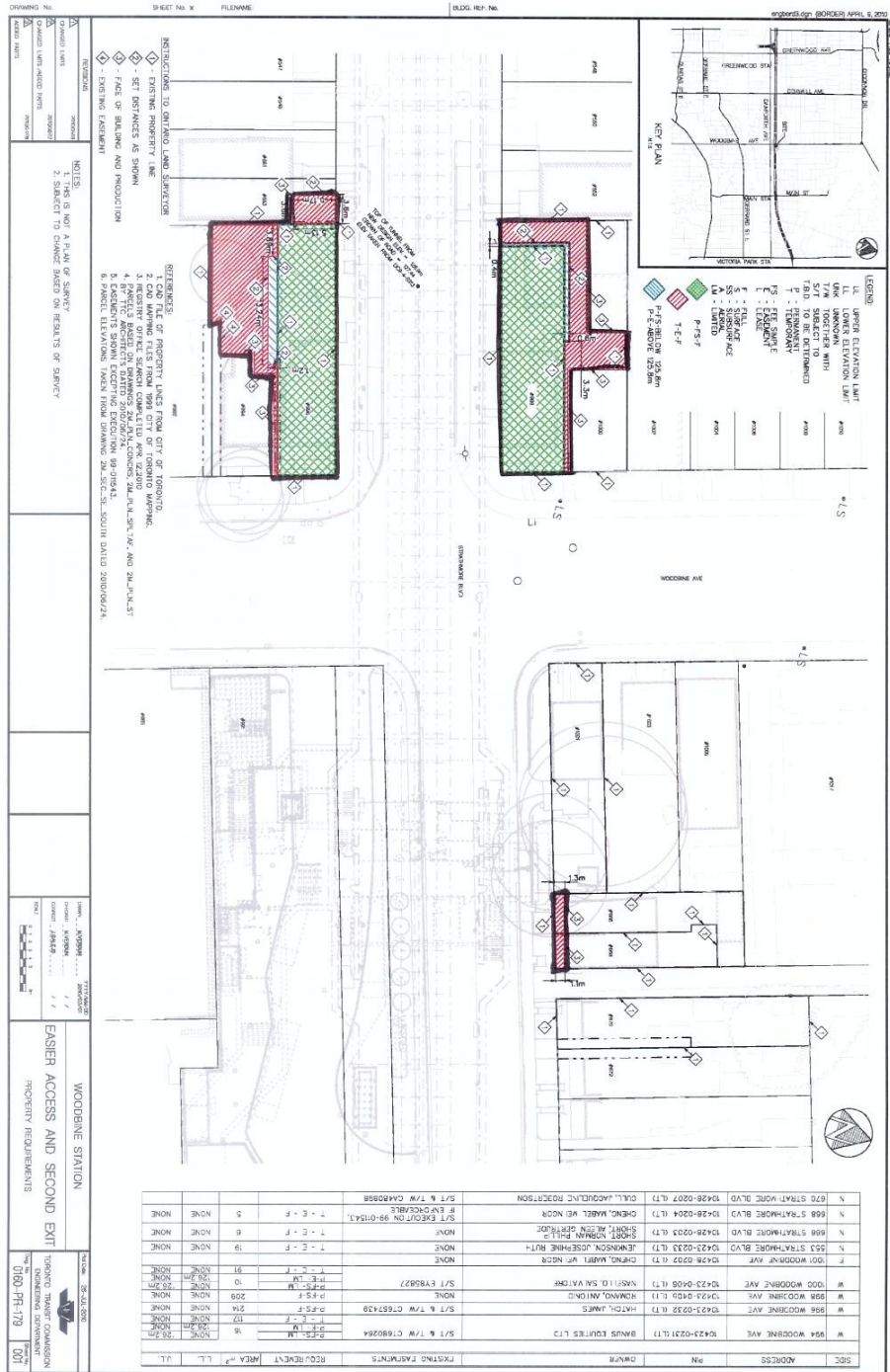

# 998 Woodbine Avenue

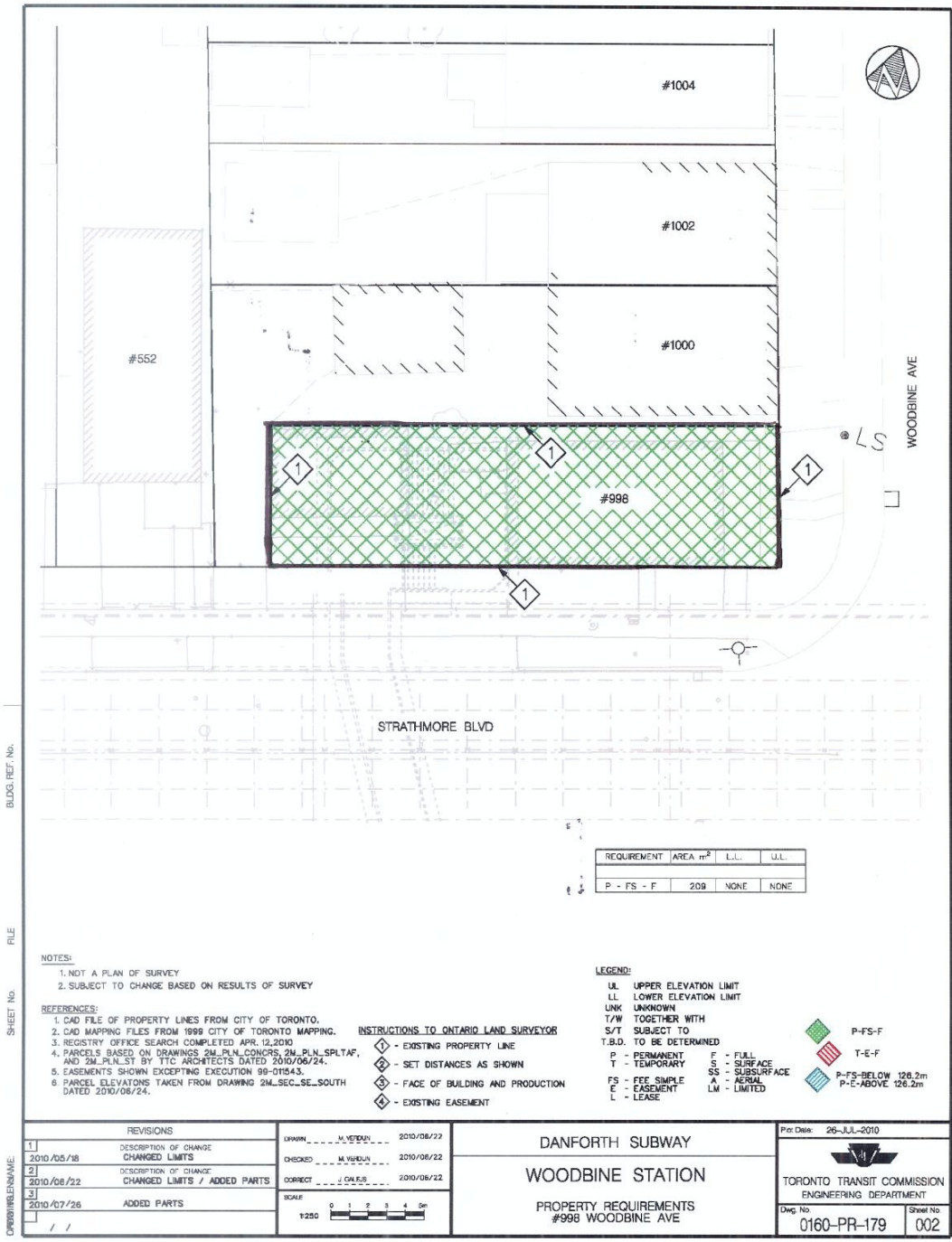

# 1000 Woodbine Avenue

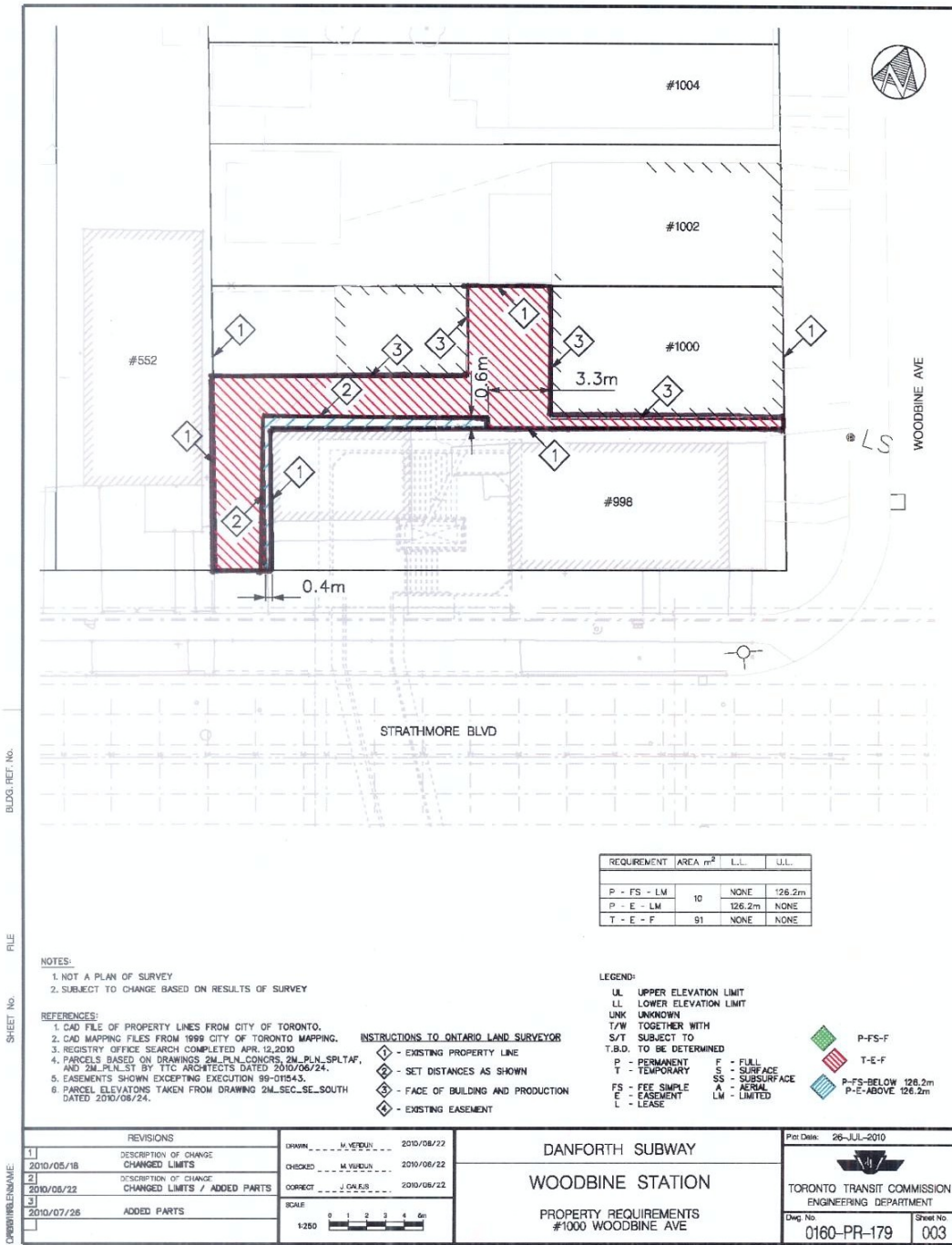

# 996 Woodbine Avenue

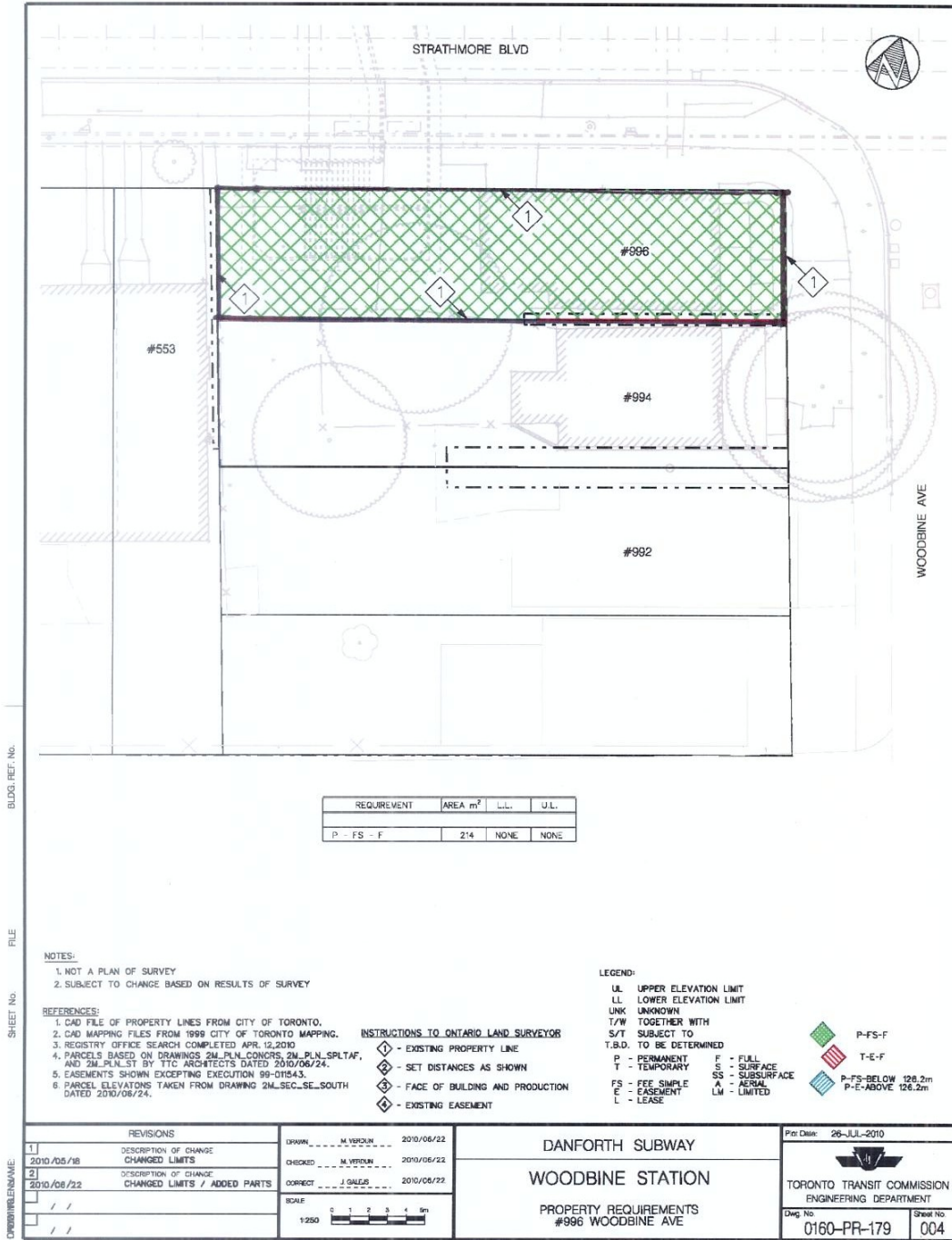

# 553 Strathmore Boulevard

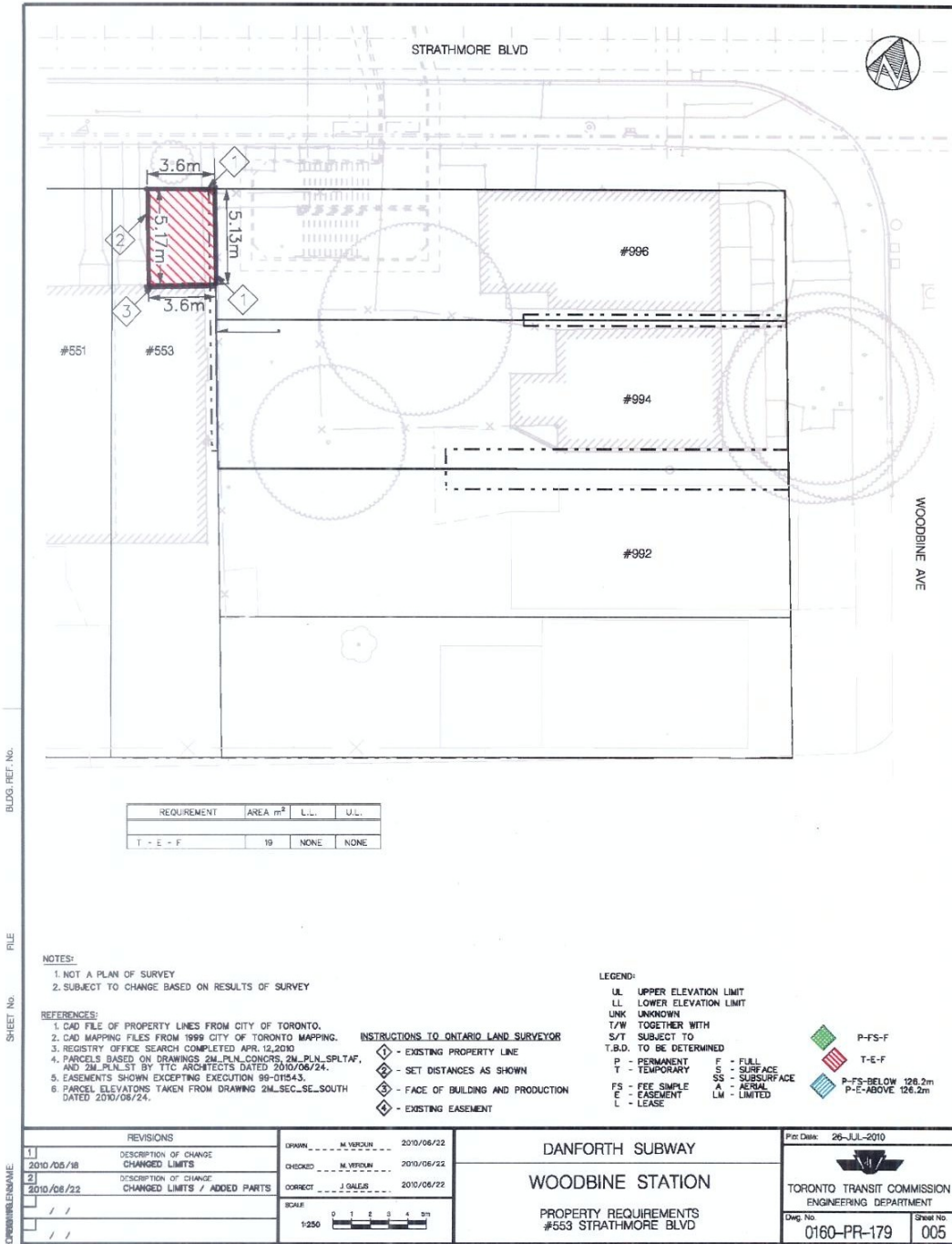

# 666 Strathmore Boulevard

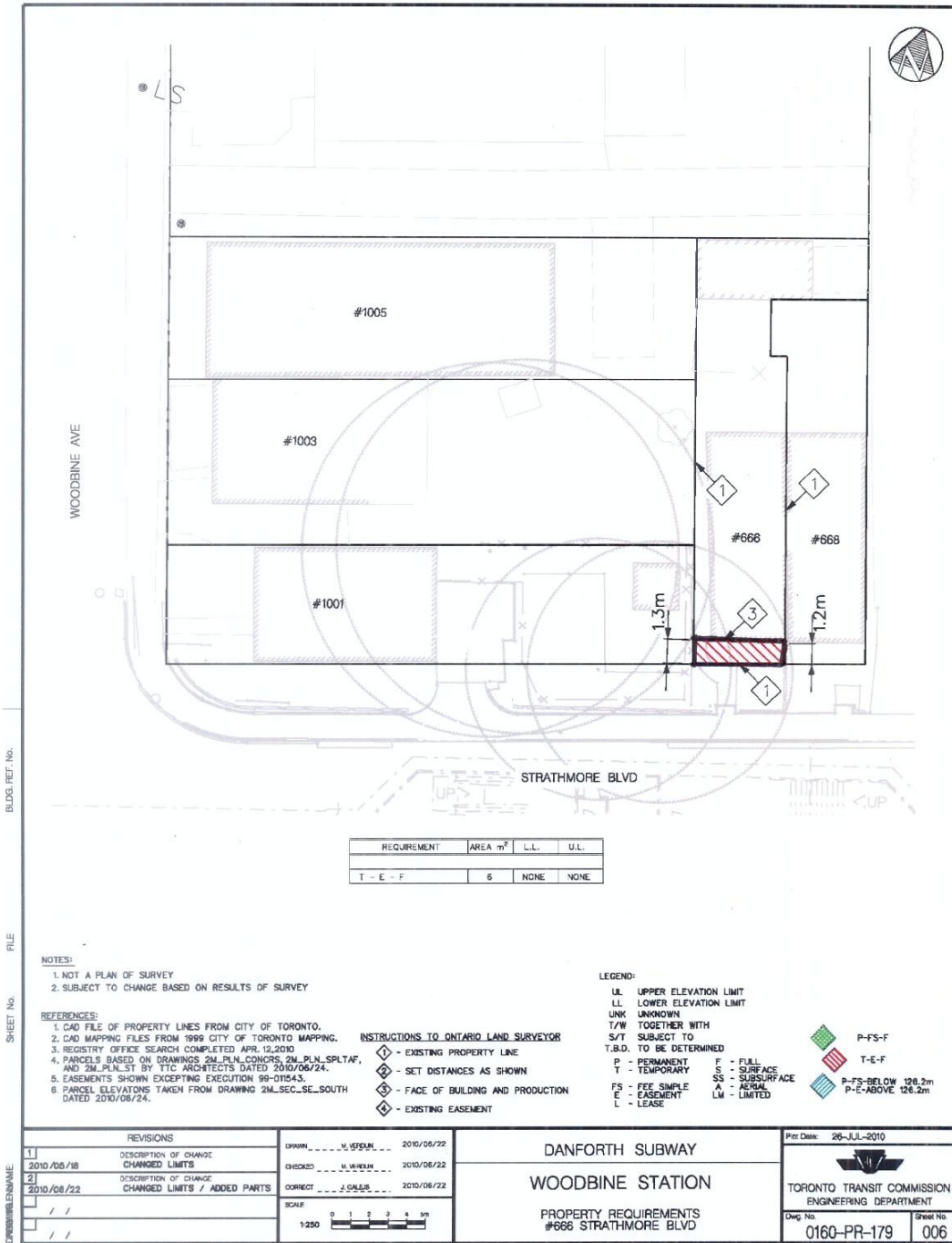

# 668 Strathmore Boulevard

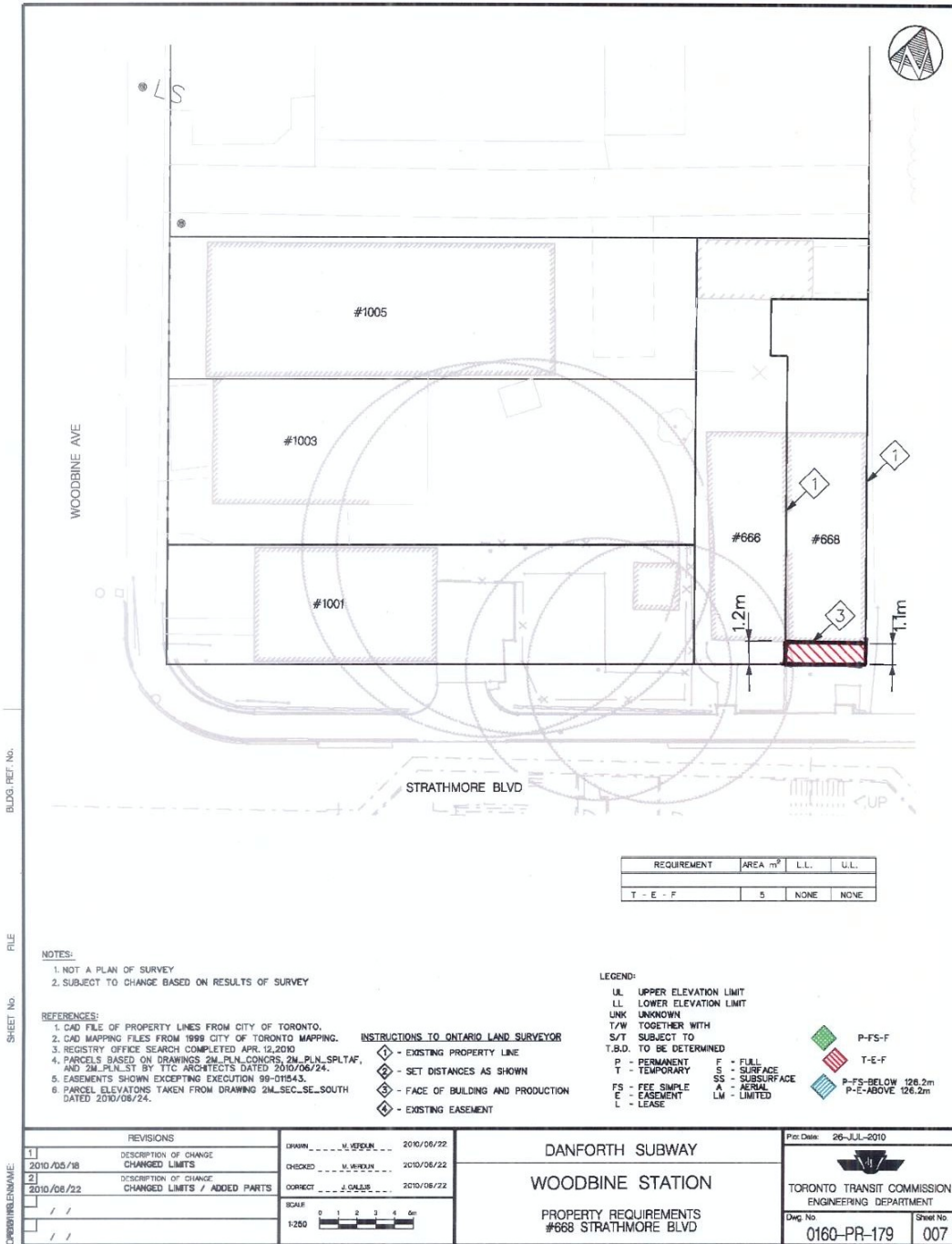

REQUIREMENT	AREA m <sup>2</sup>	L.L.	U.L.
T - E - F	5	NONE	NONE

- NOTES:**
1. NOT A PLAN OF SURVEY
  2. SUBJECT TO CHANGE BASED ON RESULTS OF SURVEY

- REFERENCES:**
1. CAD FILE OF PROPERTY LINES FROM CITY OF TORONTO.
  2. CAD MAPPING FILES FROM 1999 CITY OF TORONTO MAPPING.
  3. REGISTRY OFFICE SEARCH COMPLETED APR. 12, 2010
  4. PARCELS BASED ON DRAWINGS 2M\_PLN\_CONCRS, 2M\_PLN\_SPLTAF, AND 2M\_PLN\_ST BY TTC ARCHITECTS DATED 2010/06/24.
  5. EASEMENTS SHOWN EXCEPTING EXECUTION 99-0184.3.
  6. PARCEL ELEVATIONS TAKEN FROM DRAWING 2M\_SEC\_SE\_SOUTH DATED 2010/06/24.

- INSTRUCTIONS TO ONTARIO LAND SURVEYOR**
- ◊ - EXISTING PROPERTY LINE
  - ◊ - SET DISTANCES AS SHOWN
  - ◊ - FACE OF BUILDING AND PRODUCTION
  - ◊ - EXISTING EASEMENT

- LEGEND:**
- UL - UPPER ELEVATION LIMIT
  - LL - LOWER ELEVATION LIMIT
  - UNK - UNKNOWN
  - T/W - TOGETHER WITH
  - S/T - SUBJECT TO
  - T.S.D. - TO BE DETERMINED
  - P - PERMANENT
  - T - TEMPORARY
  - FS - FEE SIMPLE
  - E - EASEMENT
  - L - LEASE
  - F - FULL
  - S - SURFACE
  - SS - SUBSURFACE
  - A - AERIAL
  - LM - LIMITED

- P-FS-F
- T-E-F
- P-FS-BELOW 126.2m
- P-E-ABOVE 126.2m

REVISIONS		DATE
1	DESCRIPTION OF CHANGE	2010/06/22
2010/05/18	CHANGED LIMITS	2010/06/22
2	DESCRIPTION OF CHANGE	2010/06/22
2010/06/22	CHANGED LIMITS / ADDED PARTS	2010/06/22

SCALE: 1:200

**DANFORTH SUBWAY**  
**WOODBINE STATION**  
 PROPERTY REQUIREMENTS  
 #668 STRATHMORE BLVD

Proj. Date: 26-JUL-2010
<b>TORONTO TRANSIT COMMISSION</b> <b>ENGINEERING DEPARTMENT</b>
Dwg. No. <b>0160-PR-179</b>
Sheet No. <b>007</b>

# 994 Woodbine Avenue

