

Redevelopment Update

Feedback from User Groups

The architects met with a number of user groups in August to discuss design updates and to solicit more feedback about specific areas of the home and what features would be needed to ensure they functioned effectively. The list below is sample of some of the ideas:

- Confidential space for admissions and other meetings
- Dining room spaces that facilitate ease of wheelchair movement
- Environmental cues to re-direct residents at the end of corridors
- Divider system for auditorium
- Common access to inter-generational courtyard
- Vehicle access from main entrance to parking lot
- ADL kitchens to facilitate OT and other resident programming
- Quiet areas for residents

Thanks to all who took part. Stay tuned for more focus groups in the future to provide more input.

For any inquiries, please contact

Anne Marie Mohler,
Administrator at:
416.392.2301 or
amohler@toronto.ca

Architect's Update

- After meeting with West Acres Seniors' Centre, the City asked the architects to revise the design in order to retain the seniors' Centre, integrating it into the design and the "campus of care" vision.
- The *community hub* was re-designed to extend towards the seniors' centre. The new design brings the child care centre, adult day program, seniors' centre and a resident home area to create an inter-generational, age-friendly courtyard. This new extension also accommodates a redesigned loading dock and ramp.
- The lounges at the end-of-corridors in resident home areas were re-designed to achieve improved visibility to the outdoors and improved cueing.
- The parking area was re-designed, with improved access.
- The architects have completed a more detailed layout of the new long-term care home and are refining it based on the feedback received from all stakeholders.

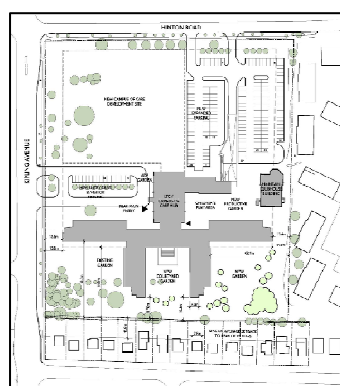

Updated building footprint and site plan

Close-up of the 'Inter-generational' Courtyard

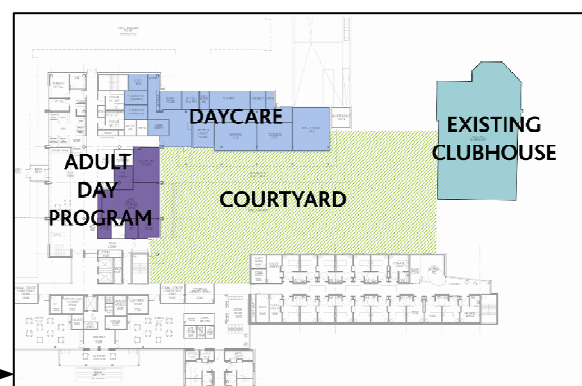

Long-Term Care Home Design Standards – Dining Areas

All resident dining areas must include design features that promote a "home-like" feel and that reinforce "familiar" eating patterns associated with smaller social gatherings. Efforts must be made to keep noise to a minimum in dining area(s) by providing finishes that reduce reflected noise and increase sound absorption.

Key Features:

- RHAs must have dedicated space for dining that is separate from any other type of space.
- The minimum, total required space for dining area(s) is 2.8 square m (30 square ft) of floor area per resident.
- Dining areas must have convenient access to a washroom that is separate from and not located in resident bedrooms and tub and shower rooms and does not open directly into food preparation or dining areas.
- Dining areas must have a hand washing sink either in the dining area or immediately next to the dining area for staff to use in preparing, delivering and serving food to the residents.
- Dining areas must provide a direct view to the outdoors or other naturally-lit space.



Important Actions: User groups, Neighbour Meetings, LEED Considerations

2010 Design

2011 Construction

2012 Occupancy

Building a new home together