

# TORONTO TRANSIT COMMISSION



ADAM GIAMBRONE  
CHAIR  
JOE MIHEVC  
VICE-CHAIR  
GARY WEBSTER  
CHIEF GENERAL MANAGER  
VINCENT RODO  
GENERAL SECRETARY



MARIA AUGIMERI  
SANDRA BUSSIN  
SUZAN HALL  
PETER MILCZYN  
RON MOESER  
ANTHONY PERRUZZA  
BILL SAUNDERCOOK



January 19, 2010

Merle MacDonald  
Planning and Growth Management Committee  
Toronto City Hall  
100 Queen Street West  
10th floor, West Tower  
Toronto, ON M5H 2N2

Dear Ms. MacDonald:

**Re: NOTICE OF PREPARATION of an Addendum Report to the Spadina Subway Extension – *Downsview to Steeles Avenue Environmental Assessment (EA)* Change in Station Construction Method at the Sheppard West Station from that Identified in the Individual EA  
Toronto-York Spadina Subway Extension (TYSSE)**

The Toronto Transit Commission (TTC) and the City of Toronto are undertaking a study to amend portions of the alignment and construction methods of the approved Environmental Assessment (EA) for the "Spadina Subway Extension – *Downsview Station to Steeles Avenue*", approved by the Ministry of the Environment in October 2006. The Amendment process is being completed in accordance with the requirements of the Ontario *Environmental Assessment Act*. The Addendum Report will examine the effects on the environment of:

- A change to the construction method from cut and cover construction to tunneling for a distance of 425  $\pm$  metres between Sheppard Avenue West and the Canadian National (CN) Rail right-of-way,
- Changes in the effects resulting from modifications to the vertical and horizontal alignment between Downsview Station and Keele Street.
- Changes in effects resulting from the lowering of the Sheppard West Station box by 8  $\pm$  metres and the relocation of the station box 120  $\pm$  metres east, directly below the CN Rail right-of-way, and
- The integration of the design and construction of a GO Transit Rail station within the CN Rail right-of-way directly above and integrated with the relocated Sheppard West Station.

The Addendum Report will describe any additional mitigation to effects resulting from the proposed changes. By way of this letter and the attached Notice, we are providing notification that an addendum report is being prepared. Another notification will be circulated once the Addendum Report is complete and available for review.



RECYCLED PAPER

You have received this notice either because you own property within the study area noted on the attached public notice; you are an interested agency or stakeholder to this undertaking. If you are a property owner with tenants in this area, please forward a copy of this notification to your tenants.

For further information regarding the project or the addendum process, please contact the Toronto-York Spadina Subway Extension (TYSSE) at (416) 393-4001, via e-mail at [TYSSE@ttc.ca](mailto:TYSSE@ttc.ca) (Use Sheppard West EA in the subject line), visit the website at: [www.spadina.ttc.ca](http://www.spadina.ttc.ca), or contact TYSSE at the address below.

Sincerely,

ORIGINAL SIGNED BY  
**JOANNA KERVIN**

Joanna Kervin, P. Eng.  
Deputy Chief Project Manager  
Third Party, Planning & Property  
Toronto-York Spadina Subway Extension  
5160 Yonge Street, Suite 1100  
Toronto, Ontario M2N 6L9

70-55-58  
GW#: 2506734

Attachment: Notice of Preparation of an Addendum Report to the Toronto-York Spadina Subway Extension Environmental Assessment (EA)

CC: Ms. Sarah O'Keefe, Transport Canada  
Ms. Solange Desautels, Ministry of the Environment  
Ms. Penelope Palmer, City of Toronto  
Mr. Joel Dempster and Mr. Greg Ashbee, Metrolinx/GO Transit

**TORONTO TRANSIT COMMISSION AND THE CITY OF TORONTO**  
**NOTICE OF PREPARATION OF AN ADDENDUM REPORT**  
**TO THE TORONTO-YORK SPADINA SUBWAY EXTENSION**  
**Downsview Station to Steeles Avenue Individual Environmental Assessment (EA)**

**Change in Station Construction Methods and in the Horizontal and Vertical Alignment**

The Toronto Transit Commission (TTC) and the City of Toronto are undertaking a study to amend the approved Environmental Assessment (EA) for the “Spadina Subway Extension – Downsview Station to Steeles Avenue” which was approved by the Minister of the Environment in October 2006. The amendment will study the environmental effects resulting from the:

- Change to the construction method from cut and cover construction to tunnelling for a distance of 425  $\pm$  metres between Sheppard Avenue West and the Canadian National (CN) Rail right-of-way;
- Modifications to the vertical and horizontal alignment between Downsview Station and Keele Street;
- Lowering of the Sheppard West Station box by 8  $\pm$  metres and relocating the station box 120  $\pm$  metres east directly below the CN Rail right-of-way; and
- Integration of the design and construction of a GO Transit Rail station within the CN Rail right-of-way directly above and integrated with the relocated Sheppard West subway station.

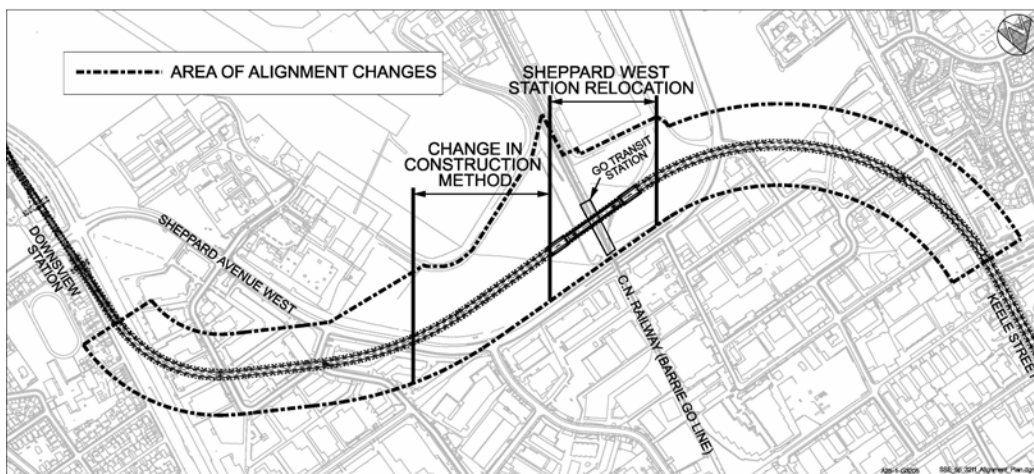

A change in construction method triggers the requirement to prepare an EA Addendum Report. The revised construction method will have scheduling and budgetary benefits and it is anticipated to result in reduced construction effects. All other changes, while within the amending boundaries of the approved EA, will result in changes to the environmental effects of the project.

The project is being assessed as an amendment to an Individual EA in accordance with the requirements in the Ontario *Environmental Assessment Act*. Input from members of the public is important. Upon completion of the Addendum Report, the document will be available to the public for comment. A notice will be published when the report is available for review.

For further information regarding the project or the addendum process, please contact the Toronto-York Spadina Subway Extension (TYSSE) at (416) 393-4001, via e-mail at [TYSSE@ttc.ca](mailto:TYSSE@ttc.ca) (put

"Sheppard West EA" in the subject line), visit the website at: [www.spadina.ttc.ca](http://www.spadina.ttc.ca), or contact us at the address below.

Joanna Kervin, P. Eng.  
Deputy Chief Project Manager  
Third Party, Planning & Property  
Toronto-York Spadina Subway Extension  
5160 Yonge Street, Suite 1100  
Toronto, Ontario, M2N 6L9

*This notice was first issued on January 20, 2010.*