

Attachment 1 - SITE PLAN

VICTORIA PARK AVENUE



PROPOSED FACIAL WALL/SIGN

**DL DUNN & ASSOCIATES** ARCHITECTS  
 PERMIT REQUIRED FOR COMPLIANCE WITH  
 THE SPLIT LOTS DEVELOPING CODE  
 09 11 08 20

ONTARIO  
 ARCHITECTS  
 REG. NO. 1153  
 11/11

Green Signal Architecture  
 229 Dundas Street  
 Toronto, ON M5G 2C8  
 Tel. 416-592-7244

PROJECT NAME  
 TORONTO CIVIC CENTRAL 2004  
 VICTORIA PARK

GENERAL SITE PLAN

PROJECT NO.: 2004-04  
 SCALE: 1/8"  
 DATE: Aug. 04, 2004  
 DRAWING NO. A01

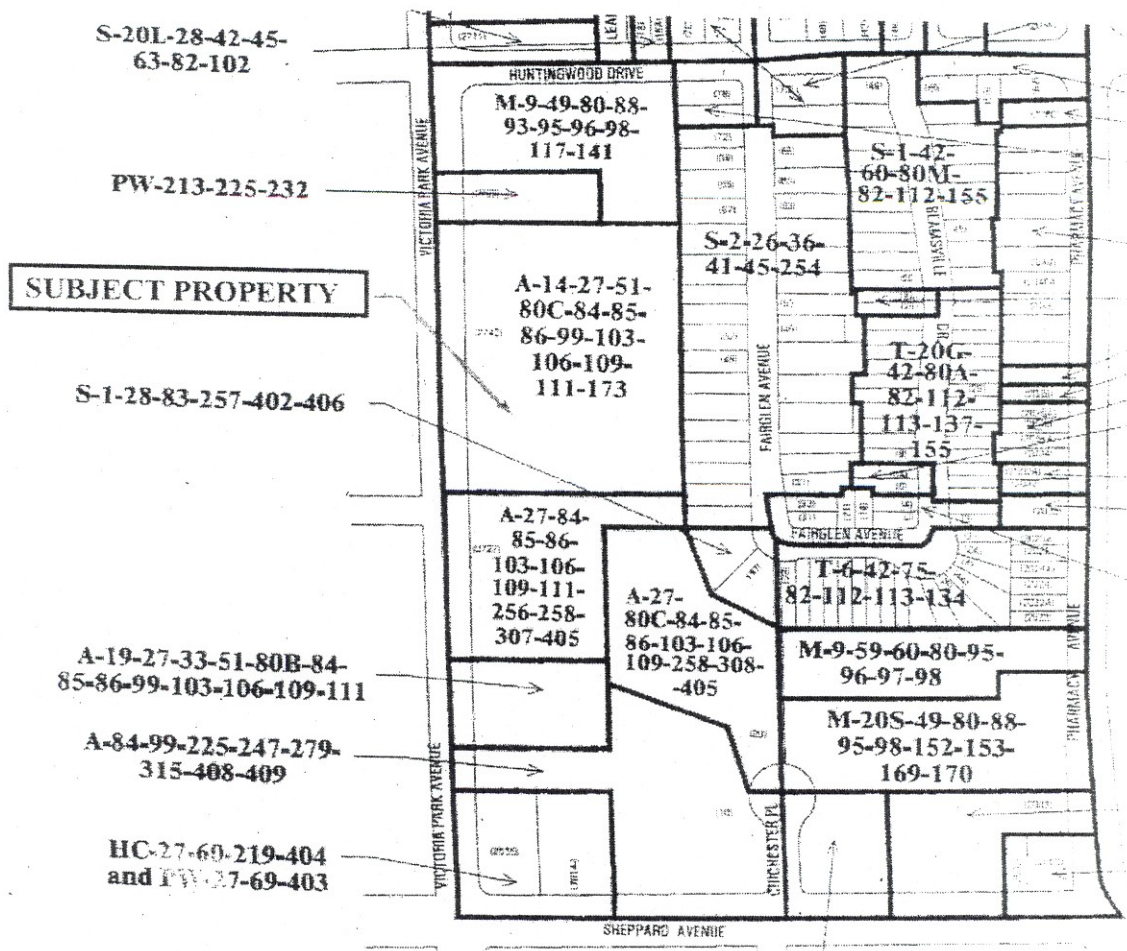

**Attachment 2 – ZONING MAP  
L'Amoreaux Community**

8'-0" HI OF PARKING ENTRY STRUCTURE  
 1'-3 1/2" HI. OF SIGN  
 + 5'-10" HI. OF SIGN  
 HI. OF SIGN FROM GRADE

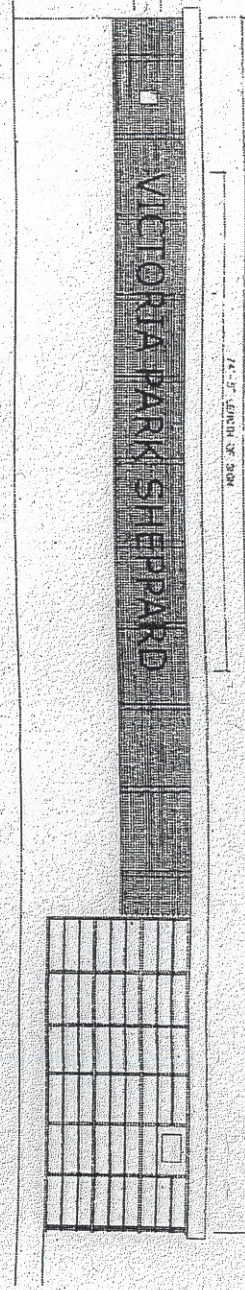

2. ELEVATION OF ADDRESS NUMBERS ON BUILDING FACADE  
 A02 3/18/11

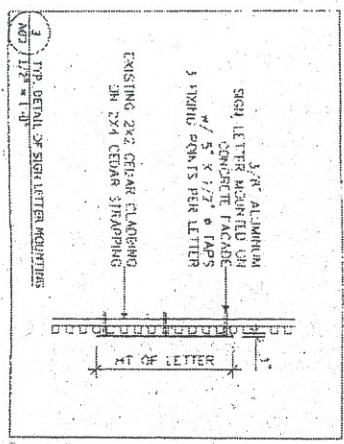

Attachment 3 - SIGN DETAILS

**TORONTO Building**  
 Permit delivered in compliance with  
 THE MARIANO BUILDING CODE  
 09-11-0820

Drawn	
C.A.C.	
REVISED	

ONTARIO ASSOCIATION  
 of ARCHITECTS  
 SIGNATURE OF  
 [Signature]

Osman Sadiqul Aziz/Architect Inc.  
 258 Dundas Street  
 Toronto, M6G 2X5  
 Tel. 416-593-0244

PROJECT NAME:  
 TORONTO CENTRAL APPEAL 2006,  
 VICTORIA PARK

SIGN DETAILS

PROJECT NO.: 200918  
 SCALE: 1/16"  
 DATE: APR. 08, 2008  
 DRAWING NO.: A02  
 REVISIONS: NONE