

BLOOR STREET WEST

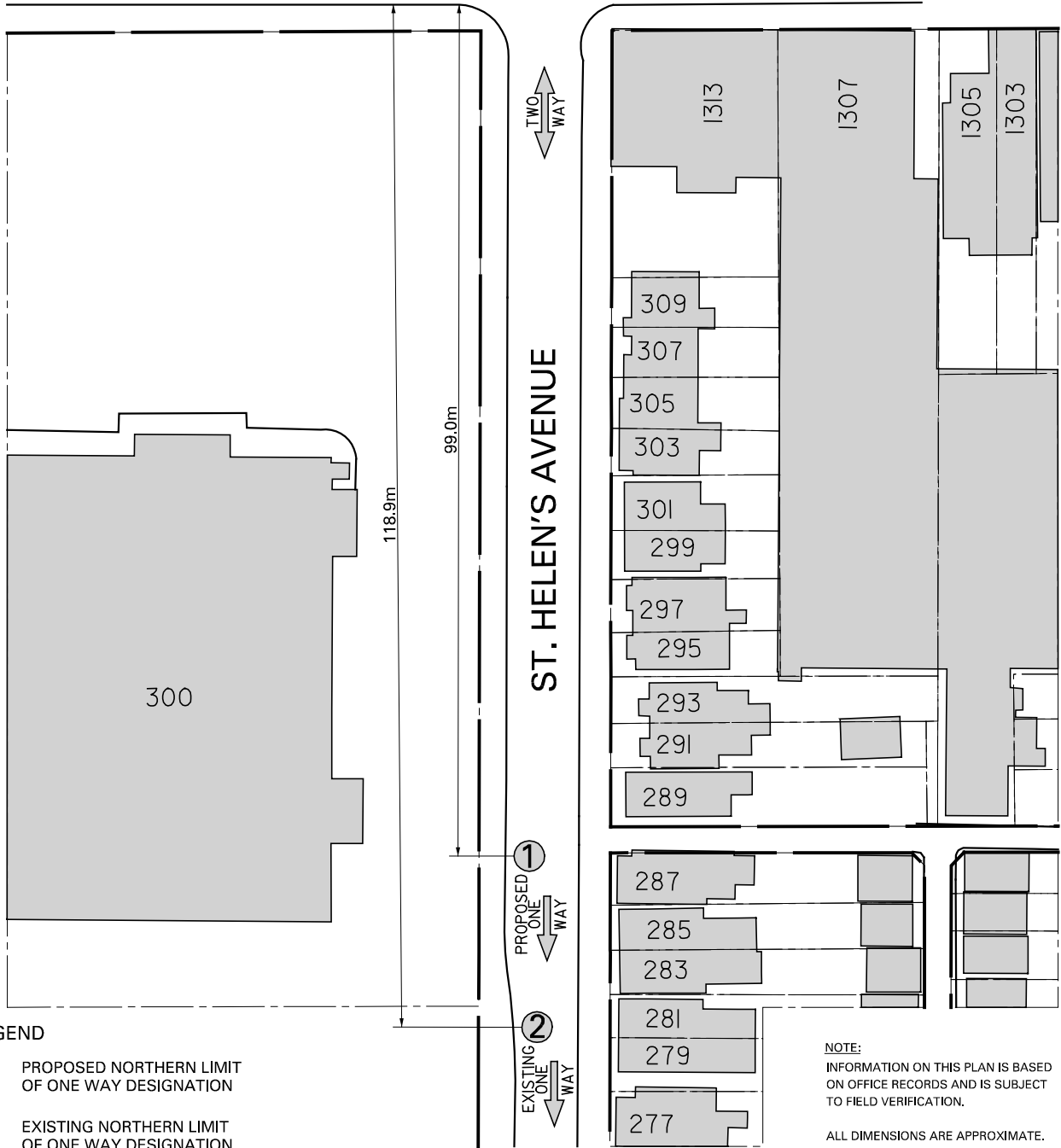
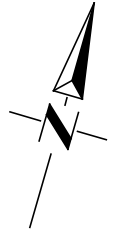

LEGEND

- ① PROPOSED NORTHERN LIMIT OF ONE WAY DESIGNATION
- ② EXISTING NORTHERN LIMIT OF ONE WAY DESIGNATION (TO BE RESCINDED)

NOTE:  
 INFORMATION ON THIS PLAN IS BASED ON OFFICE RECORDS AND IS SUBJECT TO FIELD VERIFICATION.

ALL DIMENSIONS ARE APPROXIMATE.

ST. HELEN'S AVENUE  
 BLOOR STREET WEST TO A POINT 99.0m  
 SOUTH OF BLOOR STREET WEST  
 PROPOSED NORTHERN LIMIT OF  
 ONE WAY DESIGNATION