

ADELAIDE STREET WEST

WIDMER STREET

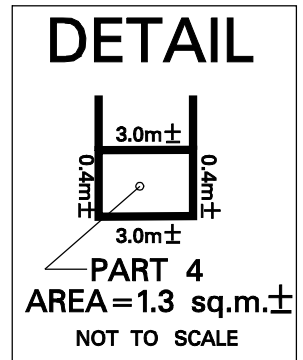
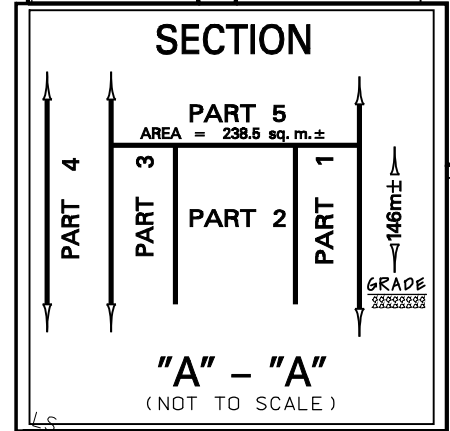
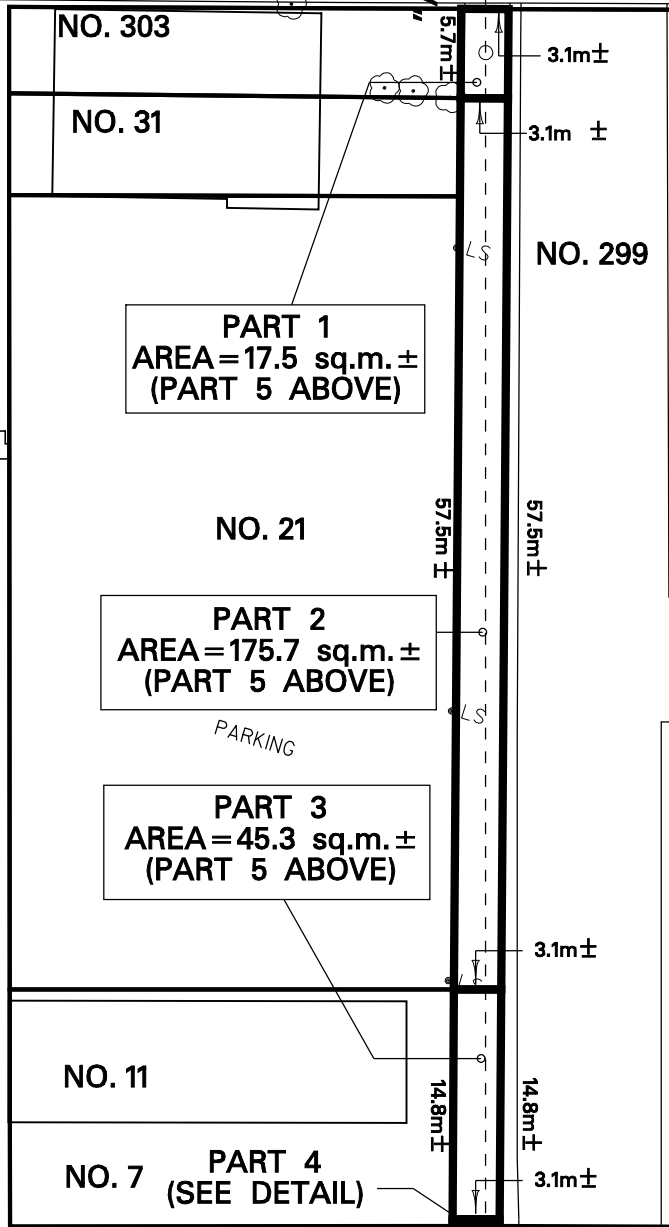

PROPERTY INFORMATION SHEET

PROPOSED CLOSURE AND SALE OF THE PUBLIC LANE
ABUTTING NOS. 11 TO 31 WIDMER STREET AND
NOS. 299 AND 303 ADELAIDE STREET WEST

Toronto

TECHNICAL SERVICES DIVISION
SURVEY & MAPPING SERVICES

NOTE:
THIS SKETCH HAS
BEEN COMPILED
FROM OFFICE RECORD.

CHECK BY JOHN HOUSE

PREPARED BY: DWAYNE PITT

WARD 20 - TRINITY-SPADINA
DATE: FEBRUARY 23, 2010

SKETCH No. PS-2010-024