

FRONT YARD PARKING APPEAL - 15 DIXON AVENUE

APPENDIX 'A'

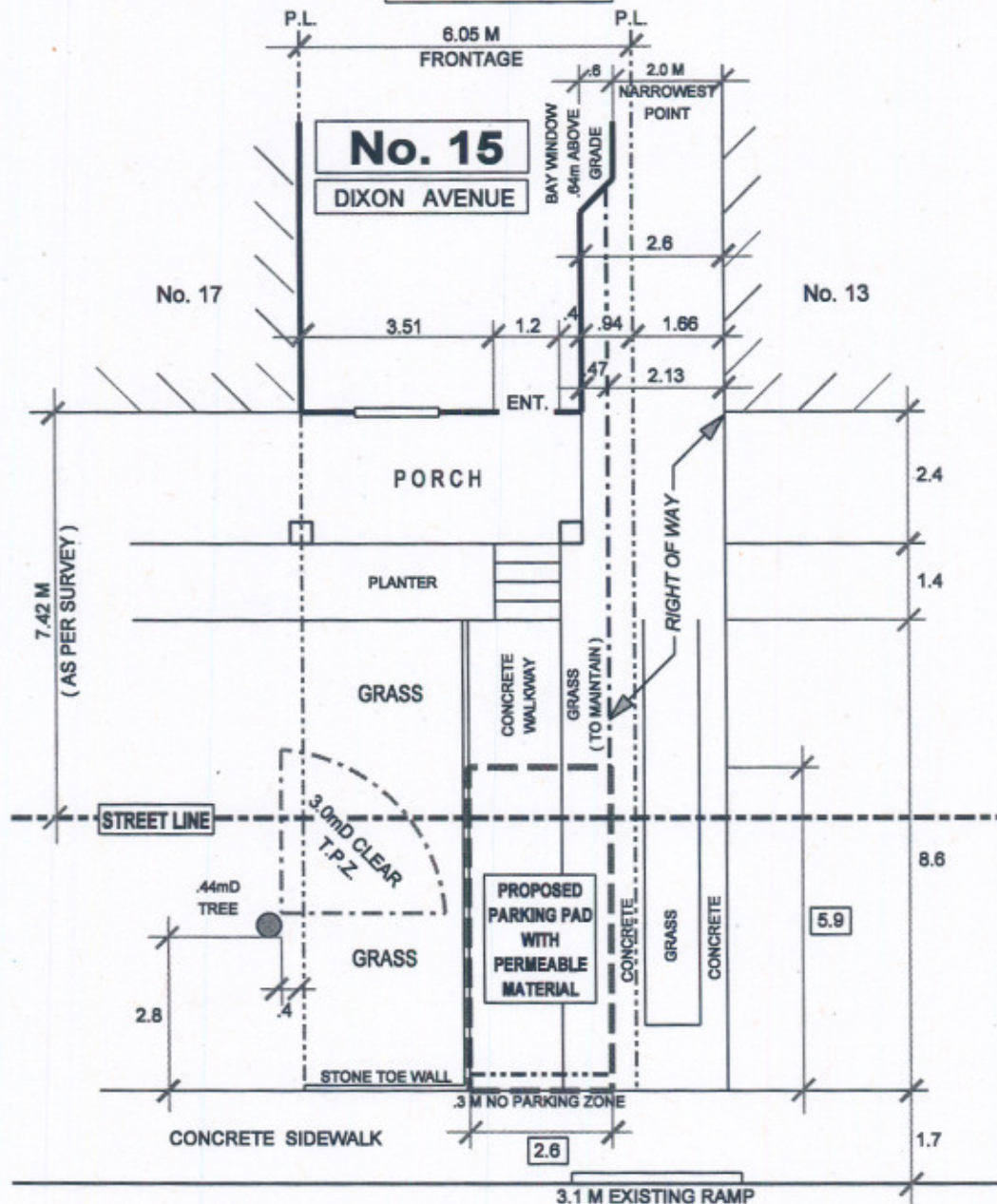

NOTE:
PERMIT PARKING ON SAME SIDE
NO LOSS OF PERMIT PARKING SPACE
DUE TO USE OF EXISTING RAMP

DIXON AVENUE



TRANSPORTATION SERVICES DIVISION
TORONTO AND EAST YORK DISTRICT
RIGHT OF WAY MANAGEMENT - OFF STREET PARKING

NORTH

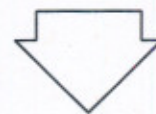

FRONT YARD PARKING CHAPTER 918 F.Y.P. - 92590

TOTAL PARKING AREA ON STREET ALLOWANCE	12.9 M ²	PRIVATE PROPERTY			STREET ALLOWANCE		
		AREA M ²	%	CODE	AREA M ²	%	CODE
TOTAL AREA		32.7	100		30.3	100	
LANDSCAPED OPEN SPACE		26.9	82	50% min.	15.2	50	50% min.
PAVED AREA		5.8	18	50% max.	15.1	50	50% max.
SOFT LANDSCAPING		20.6	76	75% min.	15.2	100	75% min.
DRAWN BY: R. MUNSON DATE: NOV. 04' 09 SCALE: 1:100							

REVISIONS

Date	By
NOV. 18' 09	R.A.M.
FEB. 06' 10	R.A.M.