

KEY MAP

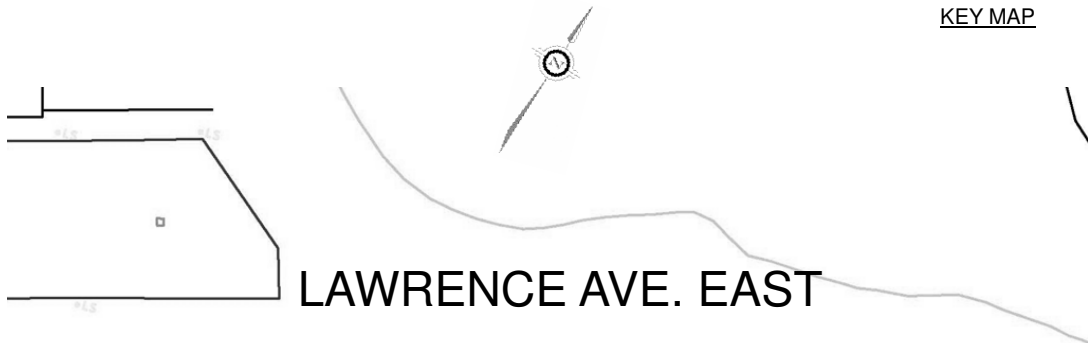

EXISTING PEDESTRIAN REFUGE ISLAND

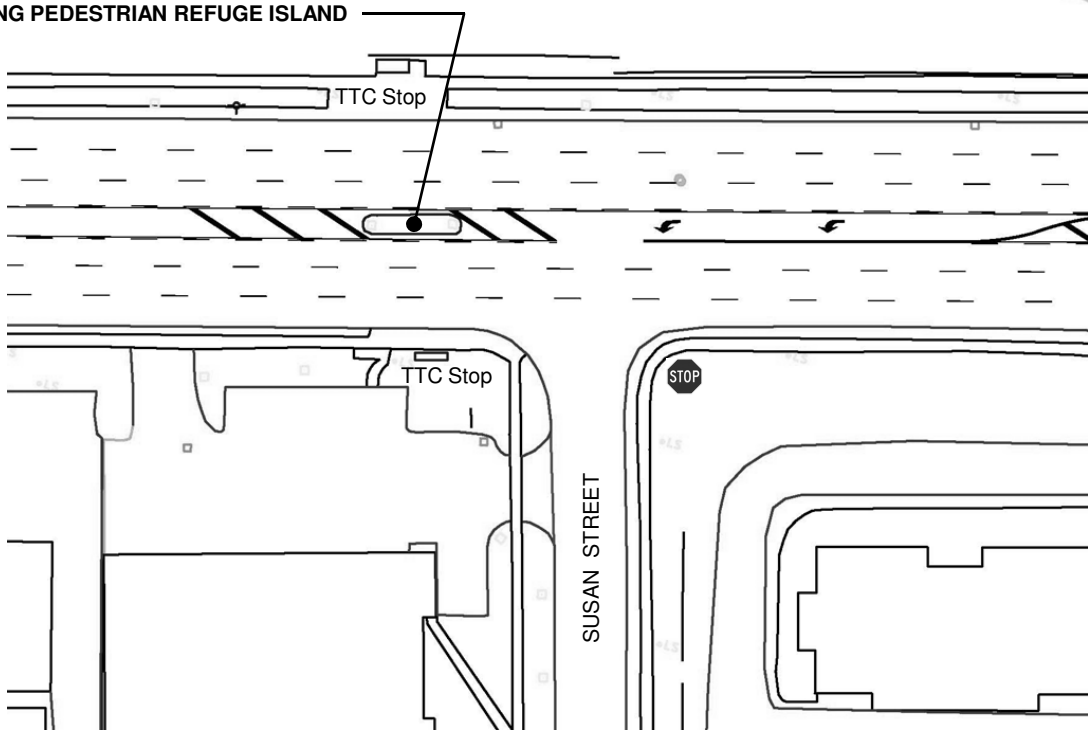

## LEGEND



EXISTING STOP SIGN



**Toronto**

TRANSPORTATION SERVICES

TRAFFIC OPERATIONS  
Scarborough District

SCALE:	NTS
DATE:	July 2011
DRAFTING:	MR/MAO

### PEDESTRIAN REFUGE ISLAND REVIEW LAWRENCE AVENUE EAST AND SUSAN STREET

FILE NUMBER: D11-4346896	
ATTACHMENT 1	WARD 43