

NATHAN PHILLIPS SQUARE REVITALIZATION PROJECT



PROJECT HISTORY

- International design competition completed March 2007
- In June 2007, City Council approved winning design and awarded contract to winning design team led by Plant Architect Inc. and Shore Tilbe Irwin & Partners in Joint Venture
- Nathan Phillips Square Revitalization Public Advisory Group formed in 2006 to advise on NPS revitalization initiative and met until end of 2010
- Led by Facilities Management, Interdivisional Senior Staff Steering Committee established to advise on project implementation. The committee includes:
 - City Planning
 - Economic Development & Culture
 - Parks, Forestry & Recreation
 - Transportation Services
 - Toronto Parking Authority

SITE PLAN

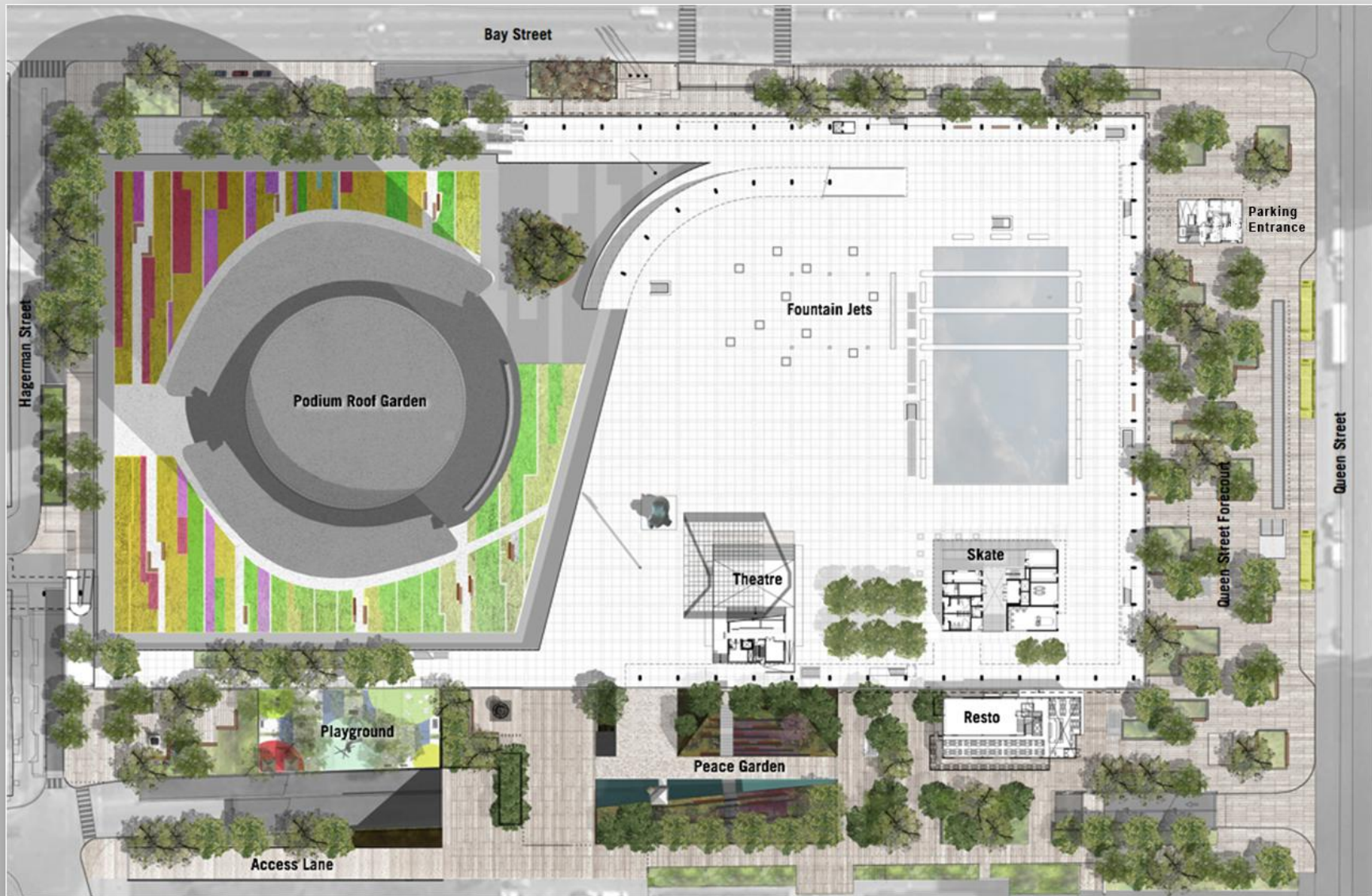

CITY HALL PODIUM GREEN ROOF



Total Area: 120,000 SQ.FT. (11,100 m²) approx.
Landscaped Area: 40,000 SQ.FT. (3,700 m²) approx.

SKATE PAVILION AND CONCESSION BUILDING



Floor Area: 3,940 SQ.FT.

THEATRE



THEATRE CONSTRUCTION

THEATRE

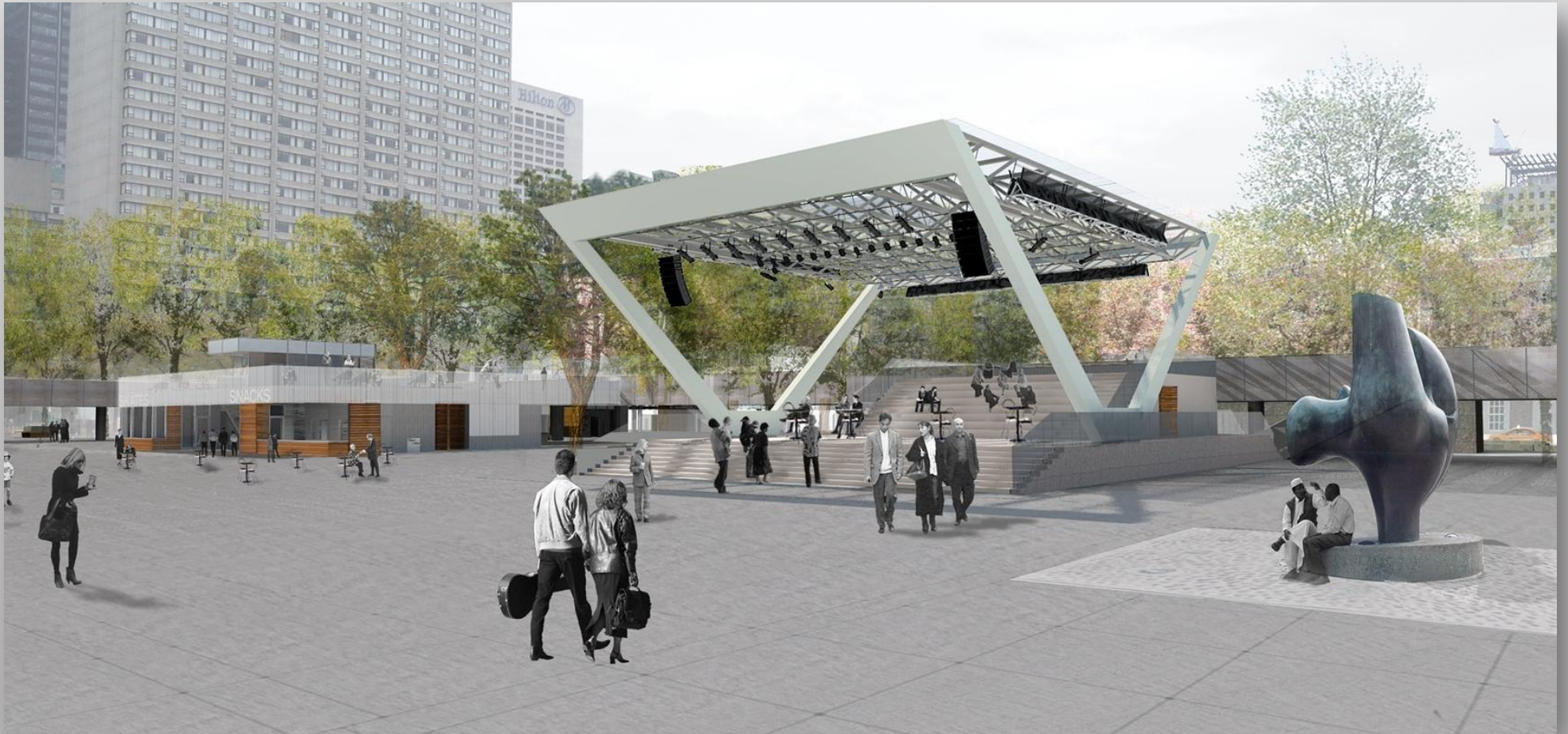

THEATRE

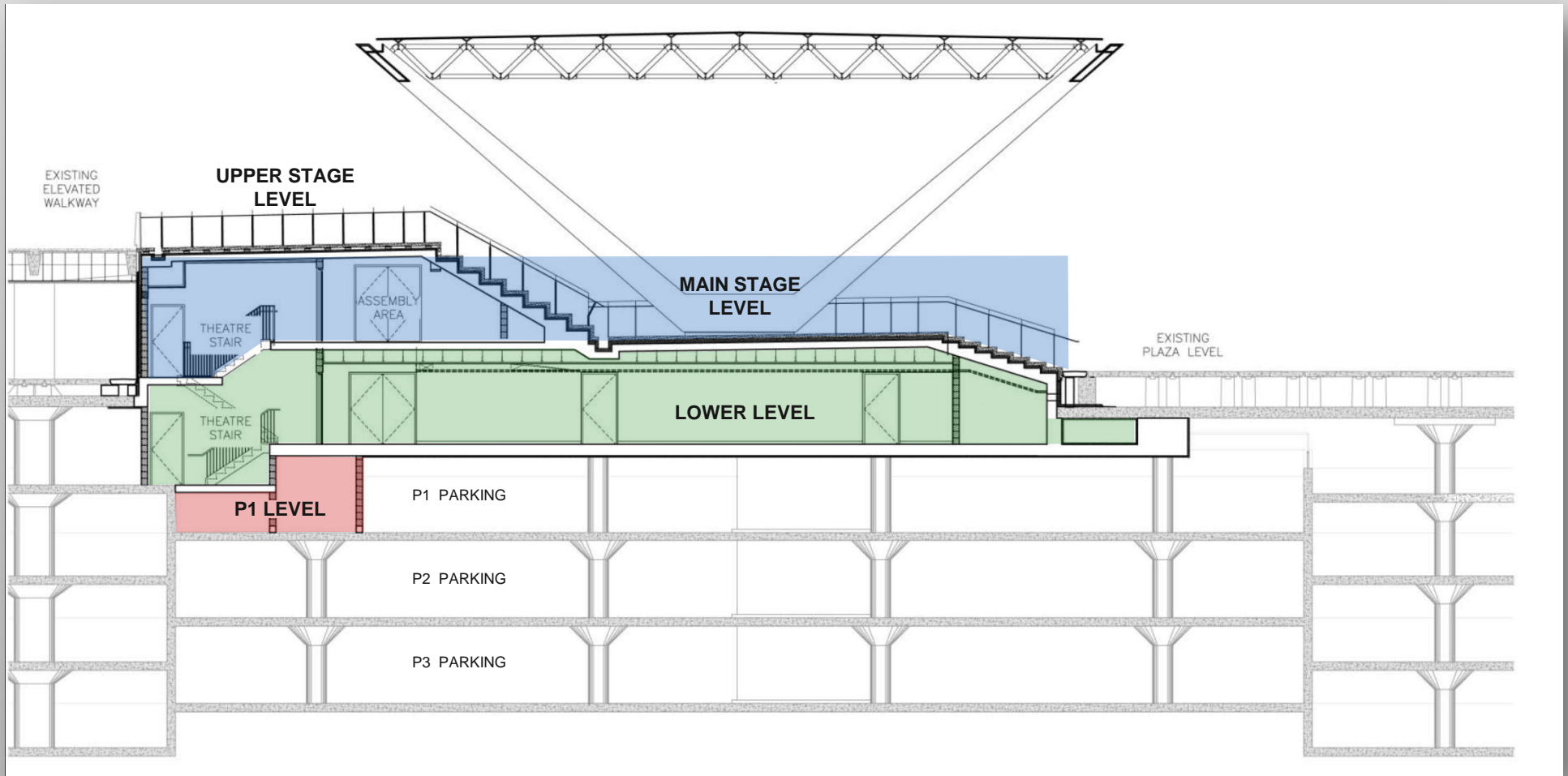

THEATRE BUILDING SECTION

| | |
|-----------------------|--------------|
| Main Stage: | 2,075 SQ.FT. |
| Assembly Area: | 730 SQ.FT. |
| Green Room | 430 SQ.FT. |
| Storage Rooms: | 1,125 SQ.FT. |
| Other Support Spaces: | 3,395 SQ.FT. |

RELOCATED PEACE GARDEN



RESTAURANT



VIEW OF RESTAURANT FORECOURT

| | |
|--------------------|---------------------|
| P1 Level: | 1,173 SQ.FT. |
| Ground Floor: | 5,188 SQ.FT. |
| Second Floor: | 2,465 SQ.FT. |
| Total Area: | 8,826 SQ.FT. |



RESTAURANT- GROUND FLOOR



RESTAURANT- SECOND FLOOR

SUSTAINABLE DESIGN FEATURES



- Installation of Podium Green Roof
- Harvest and reuse of rainwater
- Integrated storm water management
- Waste heat recovery for building heat
- Attention to on-site micro-climate
- Increased urban forest to cool the site
- Salvaged and recycled materials and sourcing locally
- Site lighting to control light pollution and preserve night sky
- Soil regeneration strategy
- Improved pedestrian environment
- LEED certification

CONSTRUCTION IMPLEMENTATION

- Construction management firm (PCL Constructors Canada Inc.) retained to facilitate phased construction of project
- Phased construction started Spring 2010 for completion by end of 2013
- Phased construction to minimize disruption for NPS users
- Meeting construction schedule recognizing ongoing public activities at NPS
- Implementation of communications plan ongoing

