

## Attachment 10: Site-specific amendment for 60 Starview Lane

Authority:

### CITY OF TORONTO

#### BY-LAW xxxx-2021

#### **To amend Zoning By-law 569-2013, as amended, with respect to the lands municipally known in the year 2020 as, 60 Starview Lane.**

Whereas Council of the City of Toronto has the authority to pursuant to Section 34 of the *Planning Act*, R.S.O. 1990, c. P. 13, as amended, to pass this By-law; and

Whereas Council of the City of Toronto has provided adequate information to the public and has held at least one public meeting in accordance with the *Planning Act*; and

The Council of the City of Toronto enacts:

Zoning By-law 569-2013, as amended, is further amended as follows:

1. The lands subject to this By-law are outlined by heavy black lines on Diagram 1 attached to this By-law.
2. The words highlighted in bold type in this By-law have the meaning provided in Zoning By-law 569-2013, Chapter 800 Definitions.
3. Zoning By-law 569-2013, as amended, is further amended by adding the lands subject to this By-law, that are not currently subject to Zoning By-law 569-2013, to the Zoning By-law Map in Section 990.10, and amending the zone label on the Zoning By-law Map in Section 990.10 respecting the lands outlined by heavy black lines to RD (f15.0; a550)(x676) as shown on Diagram 2 attached to this By-law; and
4. Zoning By-law 569-2013, as amended, is further amended by adding the lands subject to this By-law, that are not currently subject to Zoning By-law 569-2013, to the Height Overlay Map in Section 995.20.1, and applying the following height and storey label to these lands: HT 10, ST 2, as shown on Diagram 3 attached to this By-law; and
5. Zoning By-law 569-2013, as amended, is further amended by adding the lands subject to this By-law, that are not currently subject to Zoning By-law 569-2013, to the Lot Coverage Overlay Map in Section 995.30.1, and applying the following lot coverage label of 30 % to these lands, as shown on Diagram 4 attached to this By-law; and
6. Zoning By-law 569-2013, as amended, is further amended by adding the lands subject to this By-law, that are not currently subject to Zoning By-law 569-2013, to the Policy Areas Overlay Map in Section 995.10.1 and the Rooming House Overlay Map in Section 995.40.1 as shown on Diagram 5 attached to this By-law; and
7. Zoning By-law 569-2013, as amended, is further amended by adding Article 900.3.10 Exception Number 676 so that it reads:

**(676) Exception RD 676**

The lands, or a portion thereof as noted below, are subject to the following Site-specific Provisions, Prevailing By-laws and Prevailing Sections.

Site-specific Provisions:

(A) Despite Regulations 10.20.20.100(3)(B) and (C), a **community centre** is permitted.

Prevailing By-laws and Prevailing Sections:

(A) Schedule 'D' Airport Hazard Map from City of North York Zoning By-law 7625.

Enacted and passed on month ##, 20##

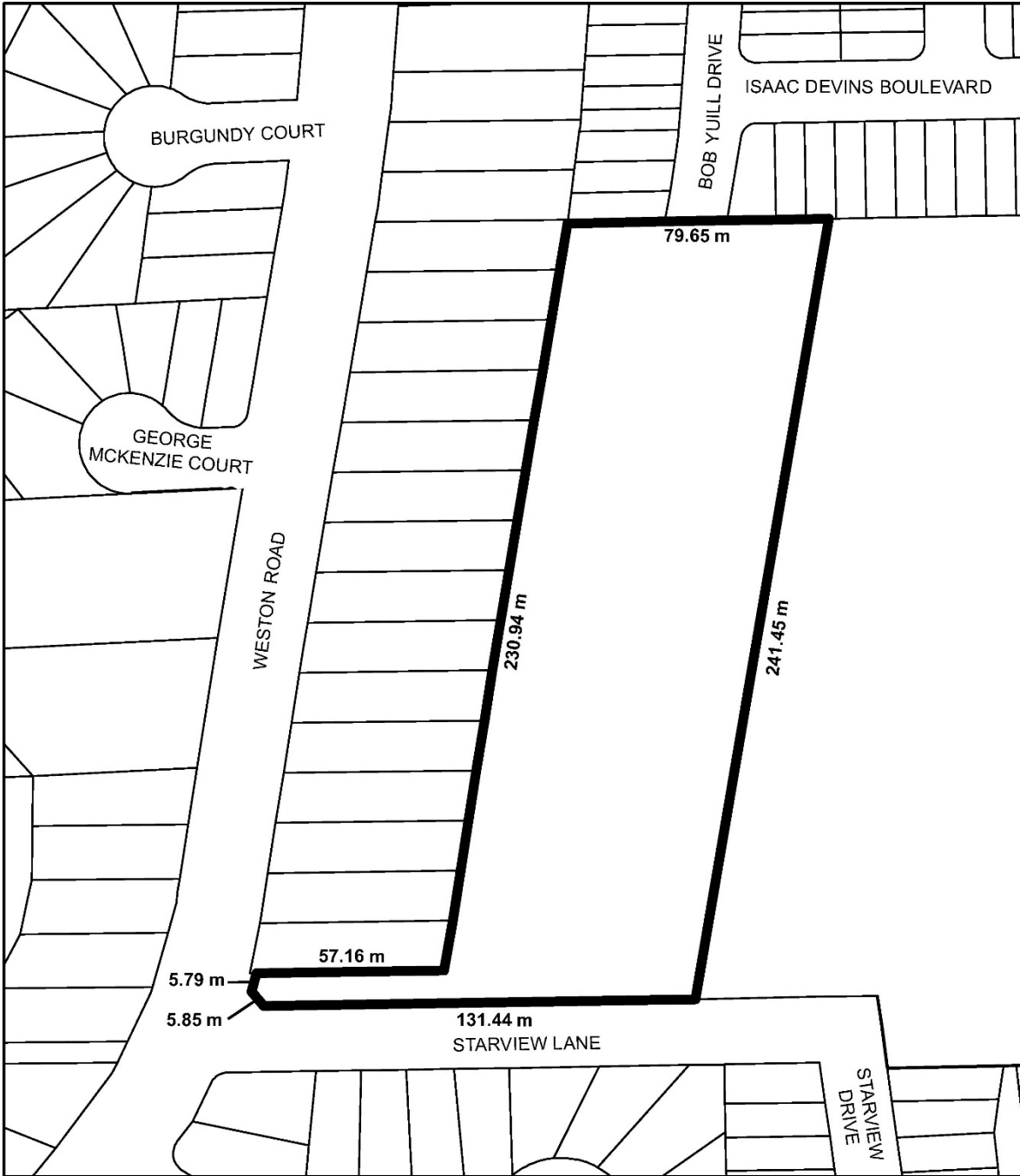

 **Toronto**  
Diagram 1

60 Starview Lane



City of Toronto By-law 569-2013  
Not to Scale  
06/03/2021

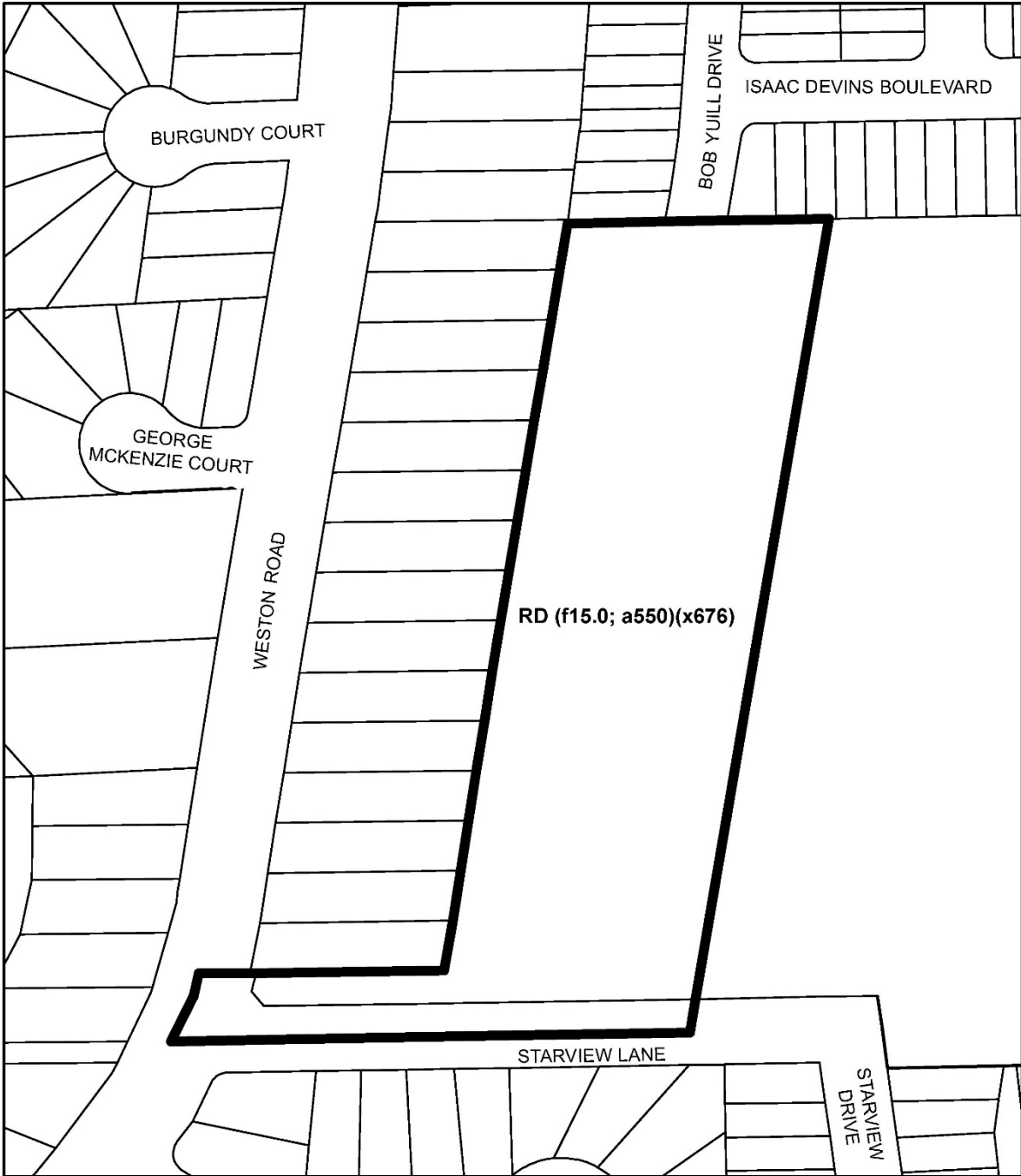

 **Toronto**  
Diagram 2

60 Starview Lane



City of Toronto By-law 569-2013  
Not to Scale  
06/03/2021

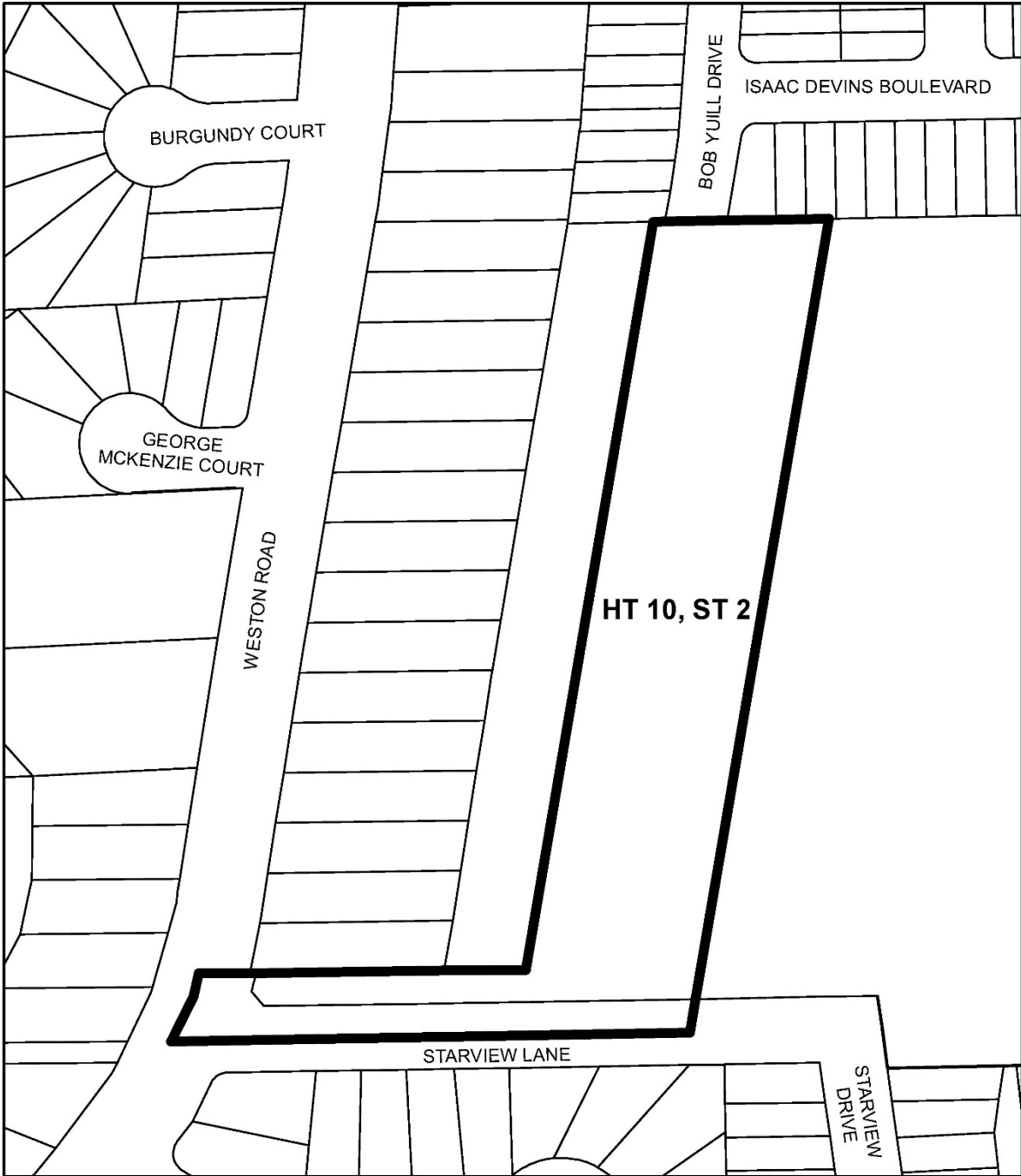

 **Toronto**  
Diagram 3

60 Starview Lane

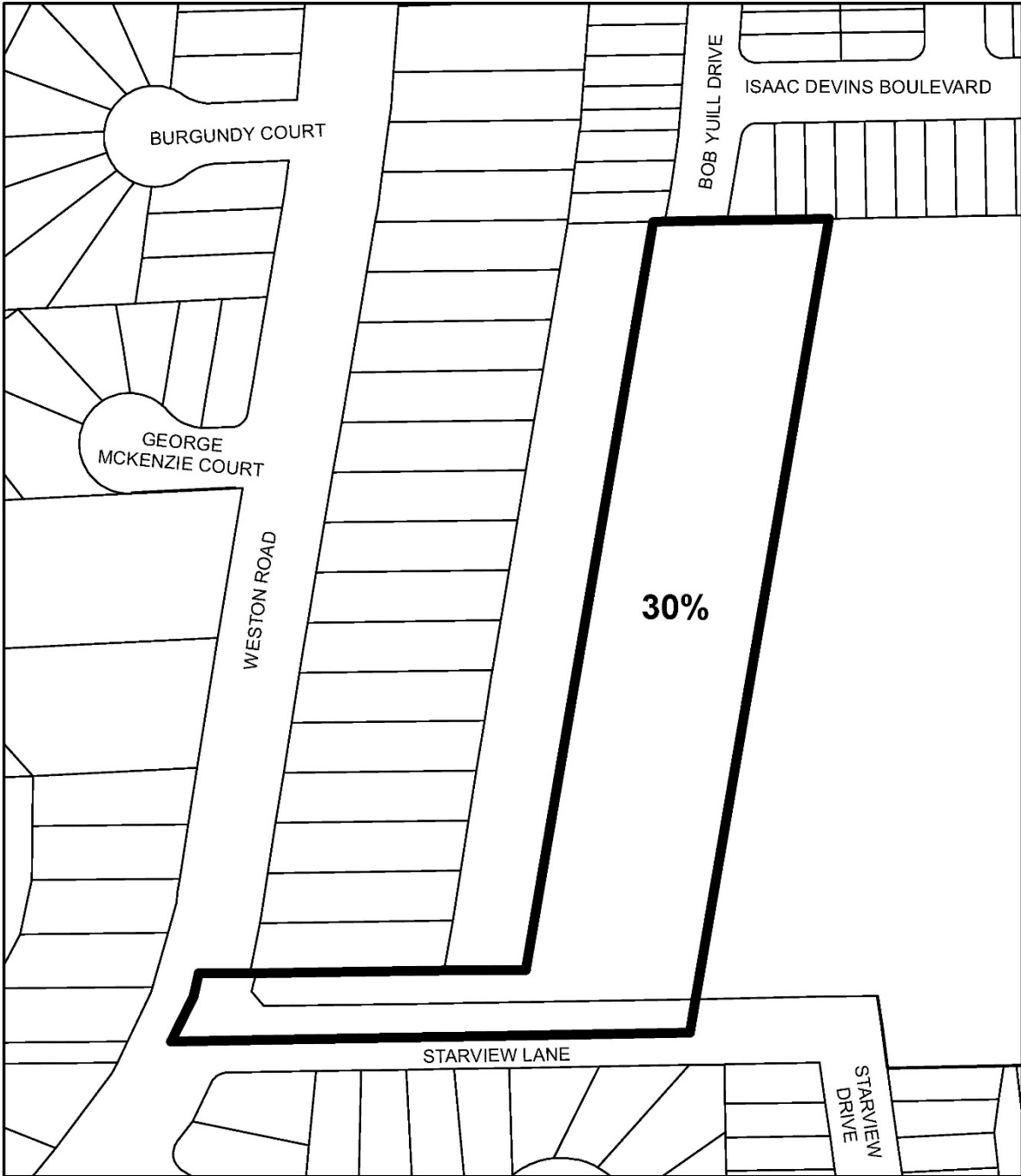

 **Toronto**  
Diagram 4

60 Starview Lane

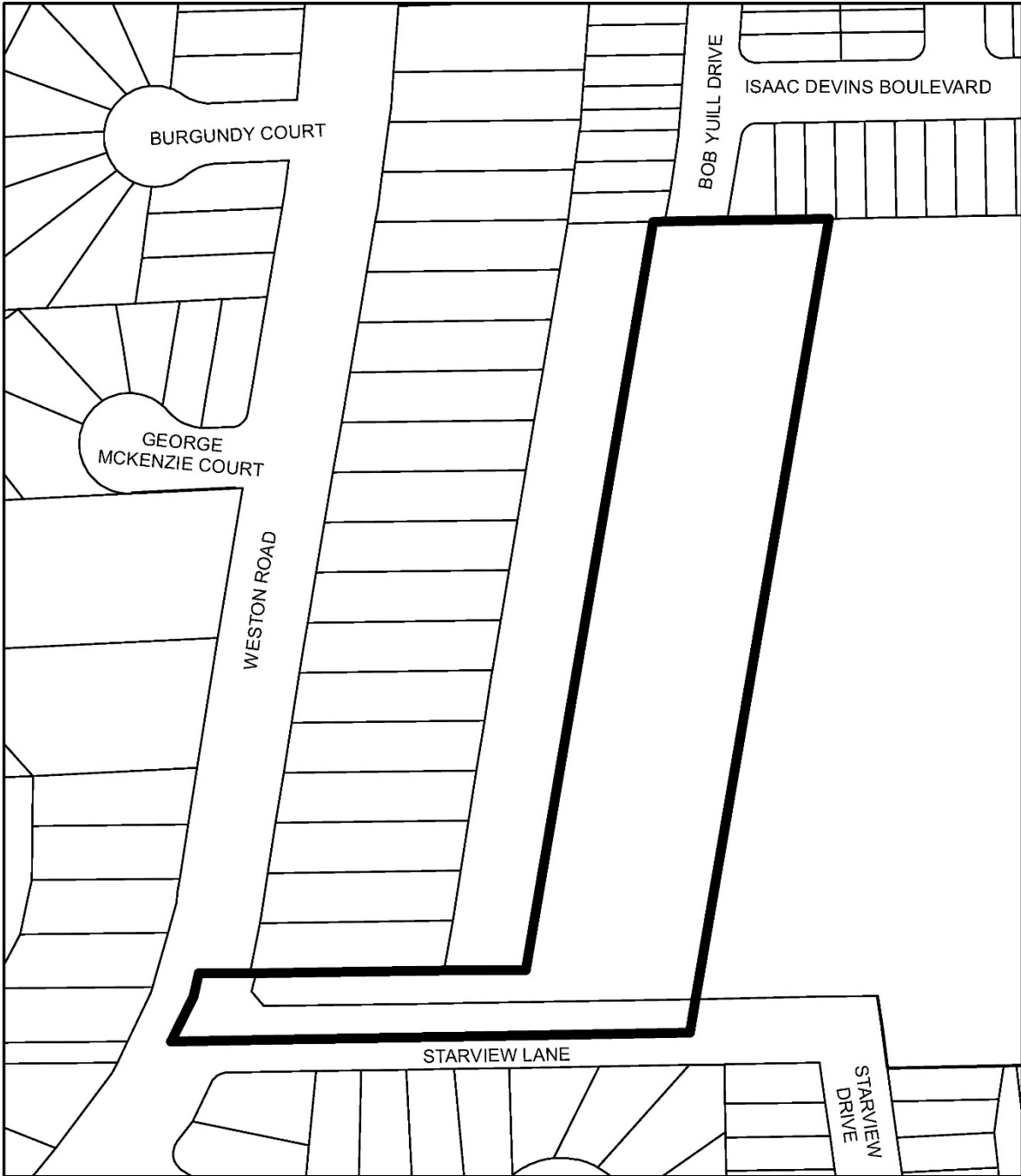

 **Toronto**  
Diagram 5

60 Starview Lane