

DUNDAS ST/ROYAL YORK RD. RAMP

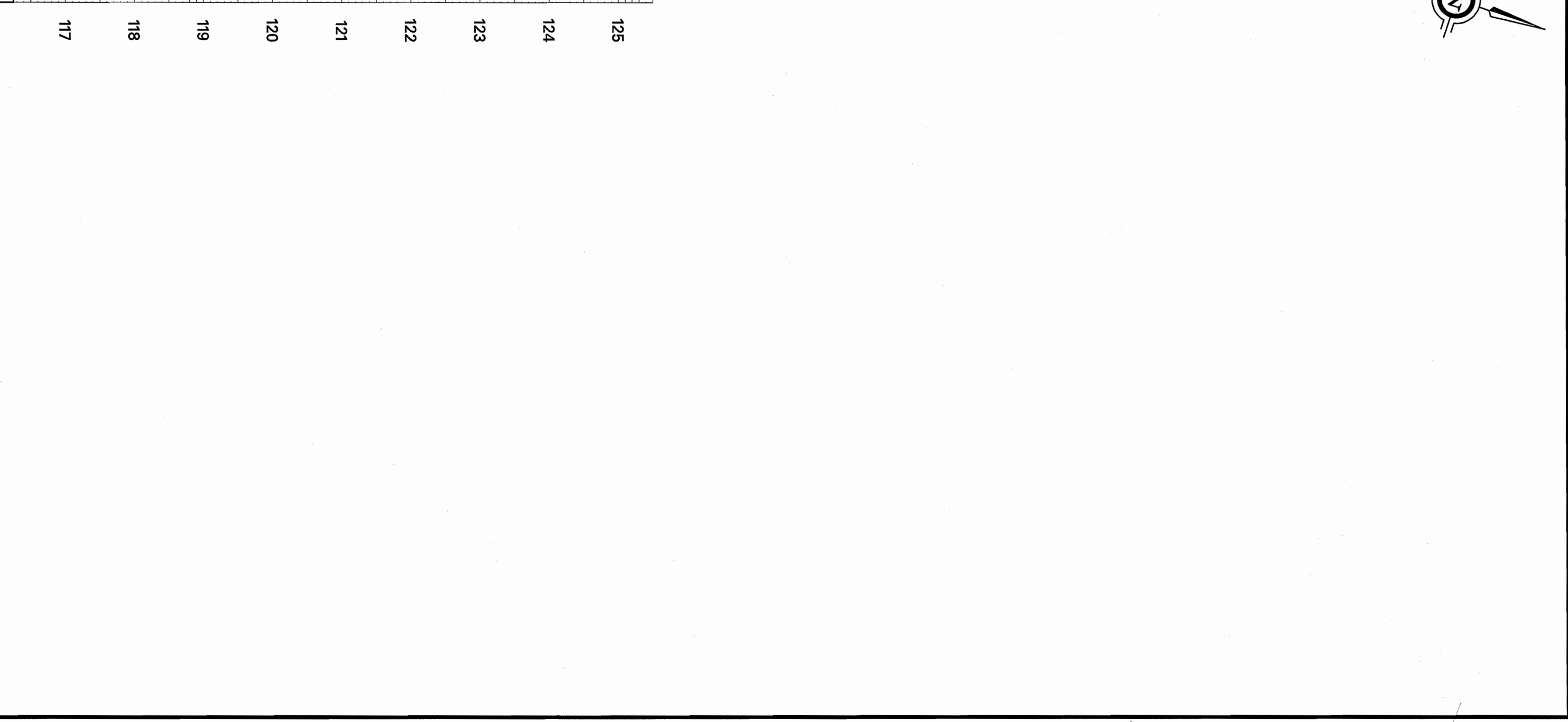
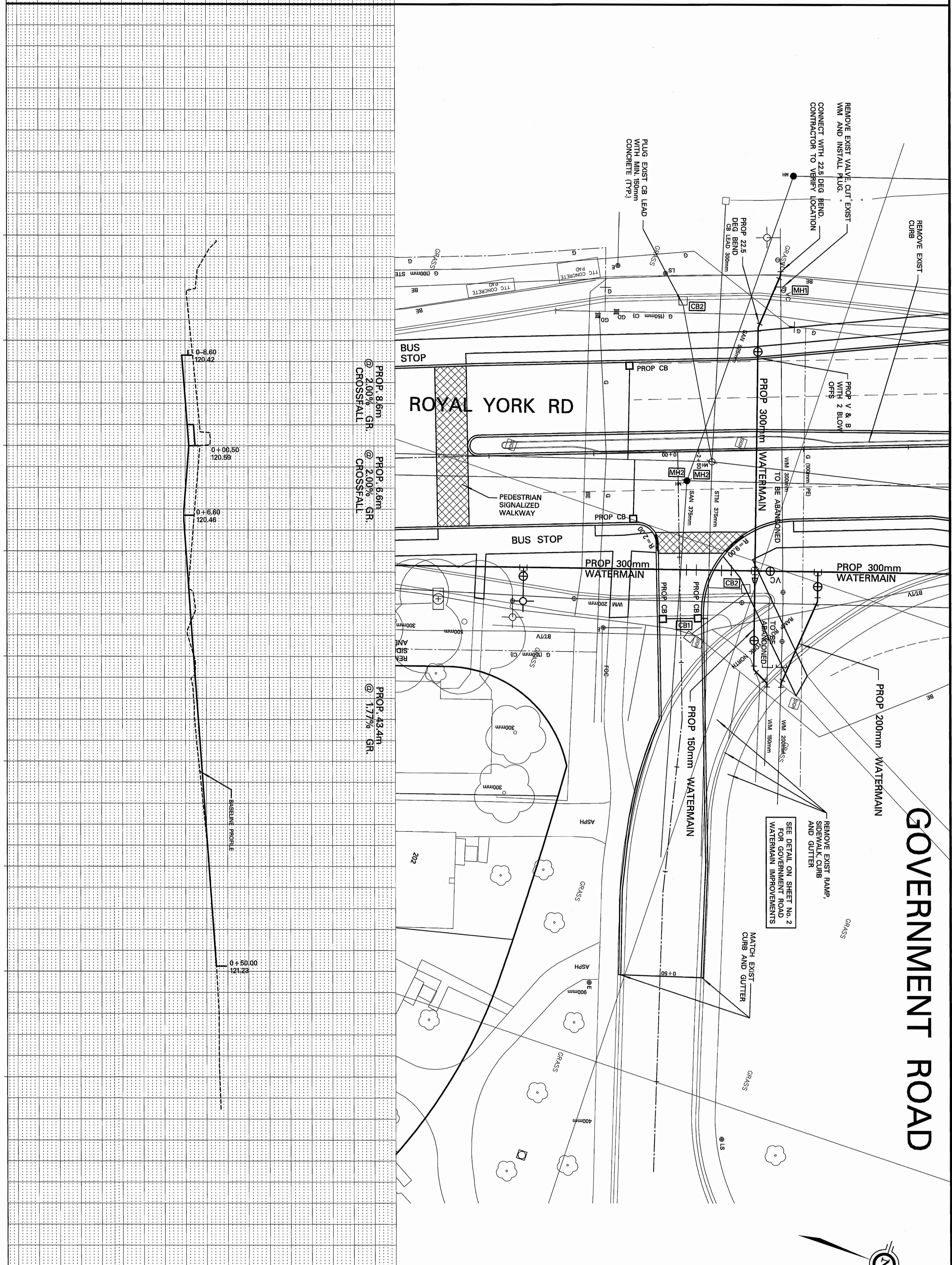
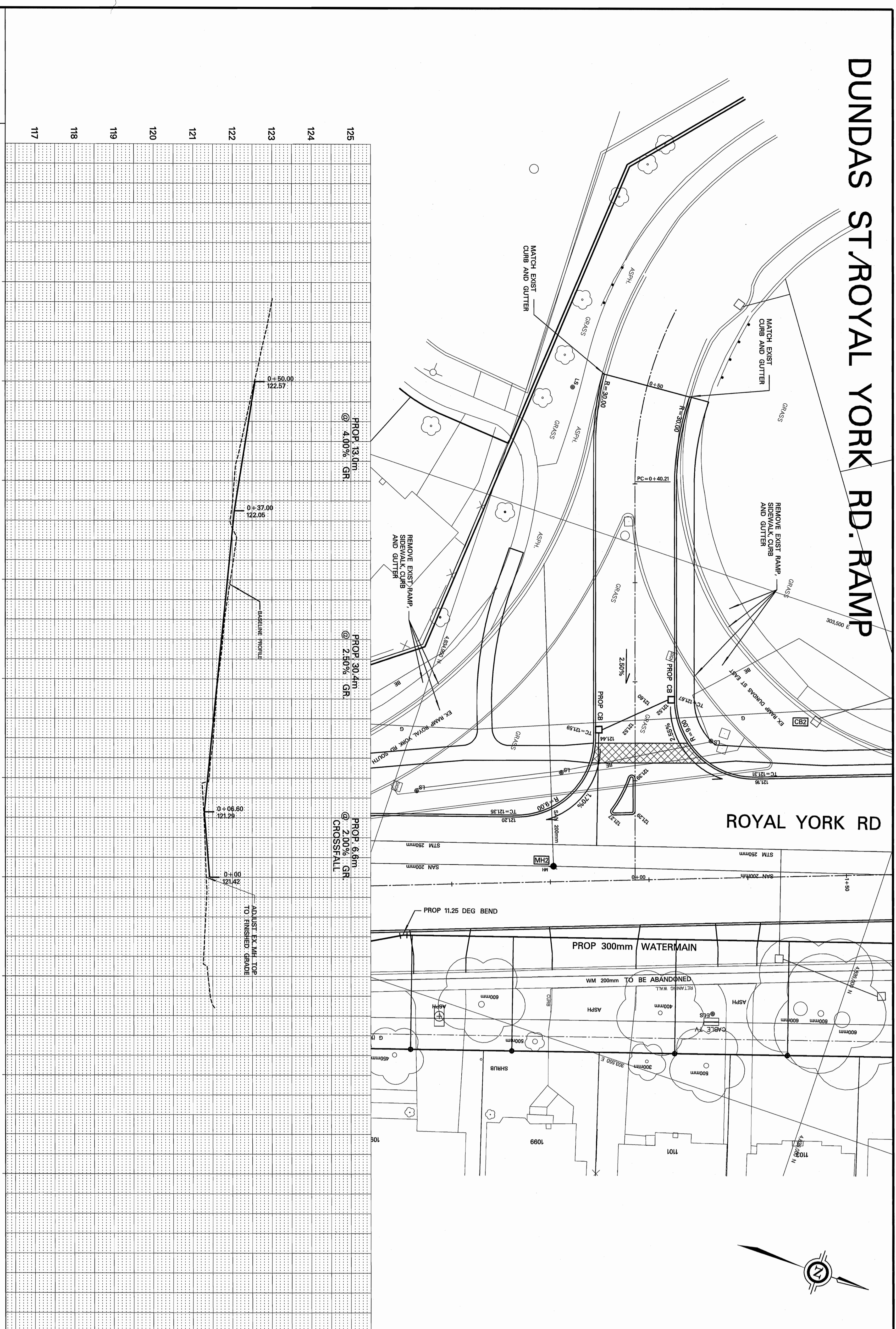

STATION	PROF. ROAD ELEVATION	BASELINE ELEVATION	STATION	PROF. ROAD ELEVATION	BASELINE ELEVATION
125			125		
124			124		
123			123		
122			122		
121			121		
120			120		
119			119		
118			118		
117			117		

STATION	PROF. ROAD ELEVATION	BASELINE ELEVATION	STATION	PROF. ROAD ELEVATION	BASELINE ELEVATION
125			125		
124			124		
123			123		
122			122		
121			121		
120			120		
119			119		
118			118		
117			117		

NO.	DATE	REVISIONS	INITIAL	SIGNED

WILLIAM A. GOSWAMI, P. ENG. EXECUTIVE DIRECTOR TECHNICAL SERVICES		TOM ELLERBROUGH, P. ENG. MANAGER, CIVIL ENGINEERING TECHNICAL SERVICES	

DESIGN: Y.R. / DRAWN: J.B. / CHECKED: Y.R. / CONTRACT NO.: U-XXXXX-03		SCALE: HORIZONTAL: 1:500 VERTICAL: 1:50 / DRAWING NUMBER: U-XXXXX-03 SHEET 3 OF 4	
---	--	---	--