

REIMAGINING THE GARDENS: Issues + Opportunities + Aspirations = Vision

Edwards Gardens and
Toronto Botanical Garden
Master Plan & Management Plan

November 2nd 2016 | Public Open House #1





AGENDA

6:10pm to 8:00pm

- | | |
|--------|--|
| 6:10pm | Welcome, agenda & introductions |
| 6:15pm | Overview of project & objectives |
| 6:20pm | Role of public parks & public gardens |
| 6:30pm | Site context overview & identified constraints |
| 6:40pm | Trends in public parks & public gardens |
| 6:50pm | Group discussion |
| 7:35pm | Questions and next steps |
| 7:45pm | Wrap up and comment forms |



PROJECT TEAM

Project Lead: Scott Torrance Landscape Architect, a division of Forrec

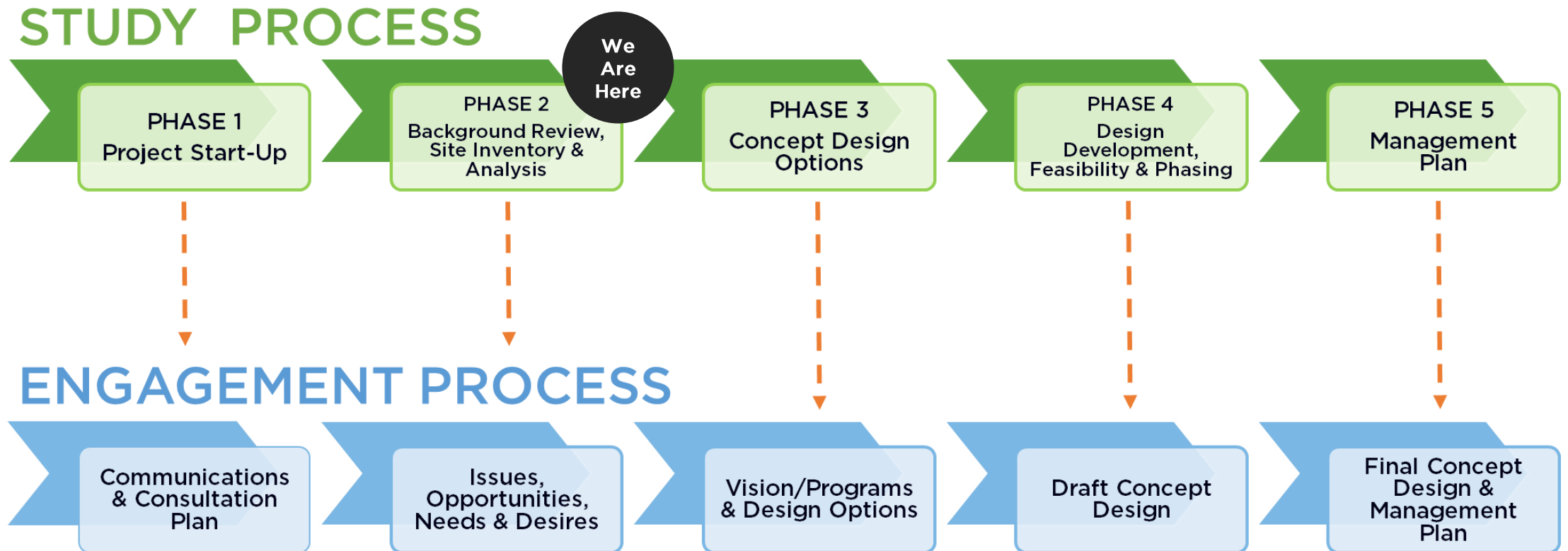
- W. Gary Smith Design
- Lord Cultural Resources
- Moriyama & Teshima Architects
- Matrix Solutions
- Urban Forest Associates Inc. (UFORA)
- Blackwell
- AW Hooker



PROJECT GOALS

- Think **holistically** about the **long-term** planning for the City parkland, the ravine system, and the Toronto Botanical Garden complex
- **Elevate the Gardens** to the level of other globally acclaimed gardens
- Promote the long-term **ecological, operational and fiscal sustainability** of Edwards Gardens and Toronto Botanical Garden

STUDY & ENGAGEMENT PROCESS





WORKSHOP OBJECTIVES

- Identify a list of:
 - Core strengths
 - Main issues
 - Areas for improvement
 - New opportunities for development
- Discuss what a unified vision for the future of the Gardens might look like

Role of Public Parks & Public Gardens



ROLE OF PUBLIC PARKS AND PUBLIC GARDENS

Public Park

- A dedicated area of publicly accessible land
- Reserved and maintained for the purposes of pleasure, exercise, amusement, ornament, and commune with nature

Public Garden

- Mission driven
- “Living” museum, with curated plant collection
- Programs in education, conservation, research and/or display
- Has a system for maintaining plant records and professional staff
- Open to the public and provides accommodation for access to all people

TYPES OF PUBLIC GARDENS



BOTANIC GARDEN

- Education and research focused: plant improvement, conservation, ecology , or basic science
- Botanically diverse, rather than simply aesthetic collections
- e.g. Brooklyn Botanic Garden

Photo: Anulla, Source: Flickr



DISPLAY GARDEN

- Focus on beauty and creating aesthetically pleasing plant exhibits
- e.g. Longwood Garden, PA

*Photo: Longwood Gardens,
Source: Wikimedia*



CONSERVATORY

- Typically a steel and glass structure for the display and study of tropical and other non-hardy plants
- e.g. Phipps Conservatory

Photo: Daderot, Wikimedia

TYPES OF PUBLIC GARDENS



ARBORETUM

- Focus on the study and display of woody plants, primarily trees and shrubs
- e.g. Arnold Arboretum of Harvard University, MA

*Photo: John Phelan,
Source: Wikipedia*



HISTORIC LANDSCAPE

- Restored or recreated landscapes of a particular period or style
- Authenticity is essential
- e.g. The Fells, NH

Photo: Wikipedia



ZOO

- Focus on creating native habitats for animal collection
- e.g. San Diego Zoo. CA

*Photo: C Burnett,
Source: Wikipedia*

Site Context & Neighbourhood



SPRINGBROOK FARM, 1955



HISTORIC OUTLINE

Wendat

Iroquois

Mississaugas of the
New Credit First Nation



Alexander Milne purchases property from Crown Lands Office (Lot 5, 3rd Concession, east of Yonge) and constructs mill on Wilket (Milne) Creek.



Rupert Edwards purchases 26-acre (10.5ha) portion of original Milne property on Wilket Creek, renaming it Springbrook Farm.



Metro Parks Department purchases property west of the Bridle Path to accommodate parking for 750 cars for Edwards Gardens. Additionally, Metro Parks purchases the property to the east of the greenhouses (part of the H.A.W. Paxton estate and lands owned by the Toronto Suburban Separate School Board).



The Civic Garden Centre is relaunched as the Toronto Botanical Garden.

1829

1832

Milne constructs new mill east on Don River, relocating wool and saw mill business from Wilket Creek site. The Wilket Creek property remained in the Milne family until 1920.

1944

1955

The Civic Garden Centre forms as an offshoot of the Toronto Garden Club

Rupert Edwards sells Springbrook Farm to the City of Toronto to be used as public park in perpetuity.

1958

1959

Metro Toronto acquires Milne Cemetery from Gordon Milne for \$1 and an agreement to maintain the site in perpetuity

1960

The Civic Garden Centre becomes a registered not-for-profit corporation.

1963

1964

The Civic Garden Centre building opens, designed by Raymond Moriyama on the former site of the Milne House, which was destroyed by fire in 1962.

1976

1977

The barns and greenhouse areas are renovated to include the outdoor cafe patio

The expansion and renovation of the Civic Garden Centre opens.

2003

2005

2006

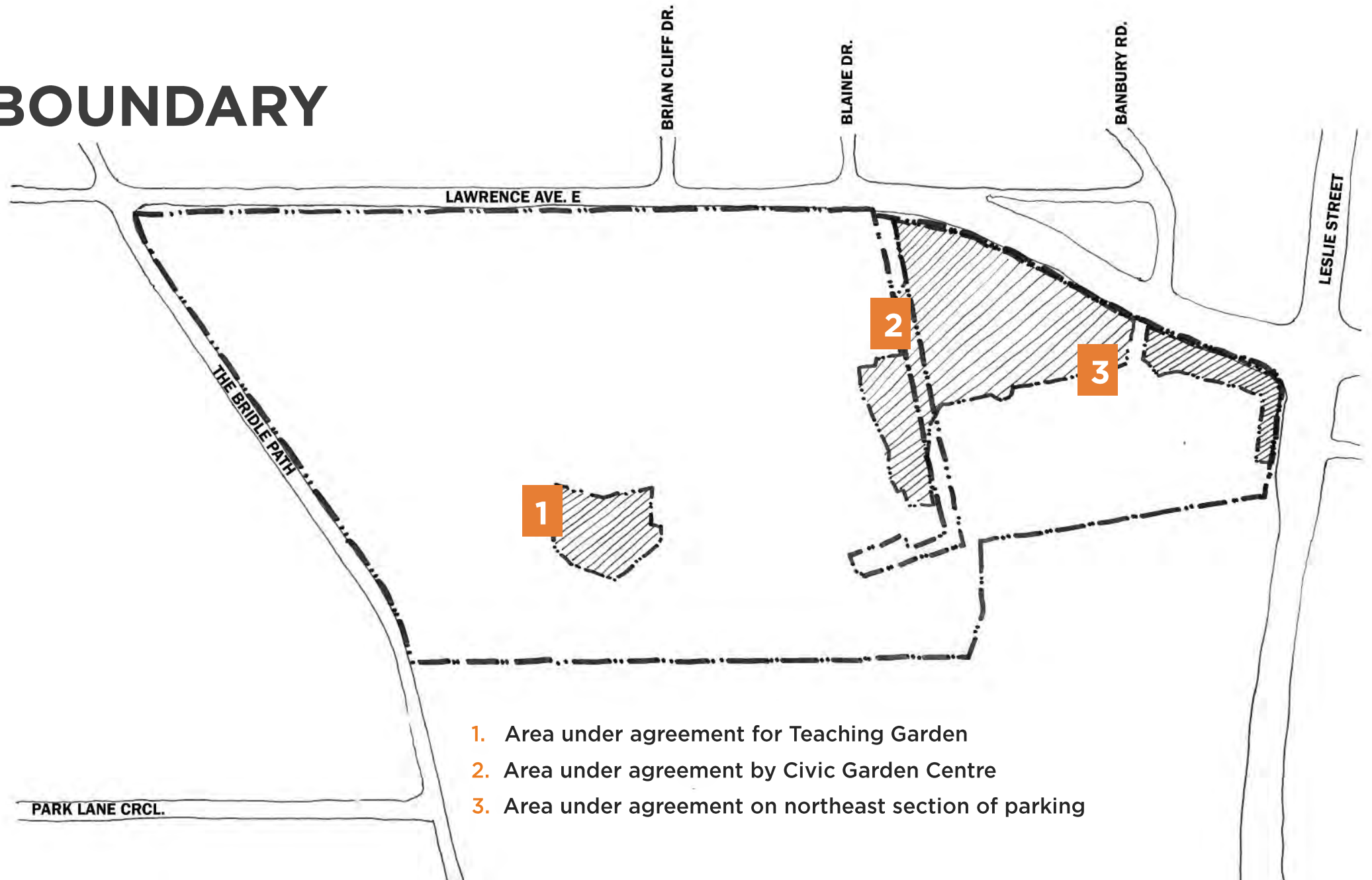
The George and Kathy Dembroski Centre for Horticulture opens at the Toronto Botanical Garden

4 acres (1.6ha) of contemporary themed gardens open at Toronto Botanical Garden.

SITE CONTEXT



SITE BOUNDARY



1. Area under agreement for Teaching Garden
2. Area under agreement by Civic Garden Centre
3. Area under agreement on northeast section of parking

CULTURAL & OPEN SPACE CORRIDOR



NEIGHBOURHOOD

Ward 25

- Older population
- Live in houses
- Family oriented
- Highly educated and affluent
- Less culturally diverse

Ward 26

- Younger population
- Live in apartments
- Very family oriented
- Highly educated
- More culturally diverse
- 55% born outside Canada

Ward 25: Population 58,315

43 Yrs Median Age	53% live in Houses	49% of families w/kids <14 yrs
74% Post Secondary	\$202k Avg Household Income	32% Visible Minority

Ward 26: Population 64,910

37 Yrs Median Age	69% live in High Rise Apts	69% of families w/kids <14 yrs
61% Post Secondary	\$88k Avg Household Income	58% Visible Minority

Toronto: Population 2,615,090

39 Yrs Median Age	41% live in High Rise Apts	50% of families w/kids <14 yrs
58% Post Secondary	\$87k Avg Household Income	49% Visible Minority

KEY FEATURES



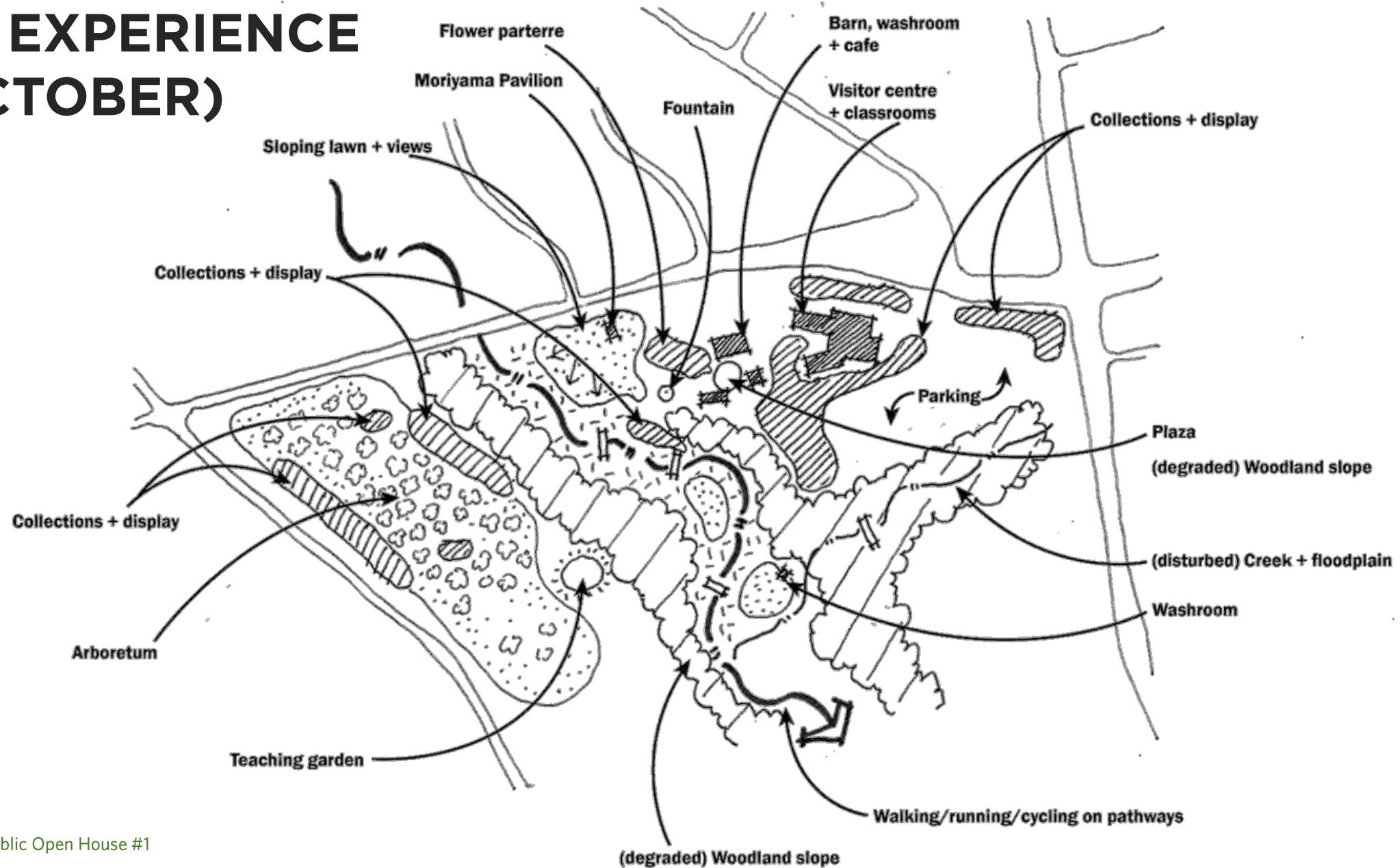
LOCAL RESIDENTS



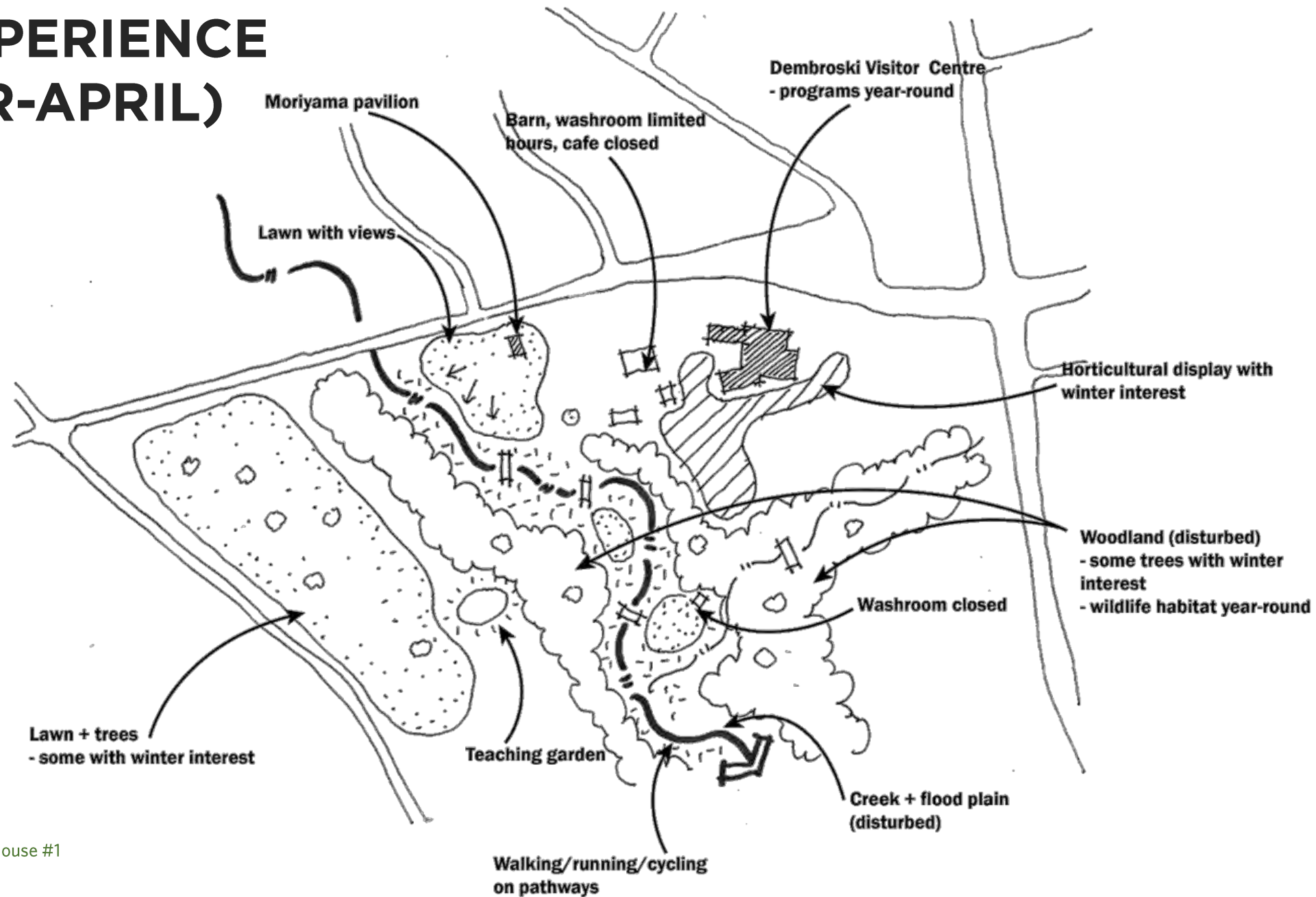
ACTIVITIES AND USES



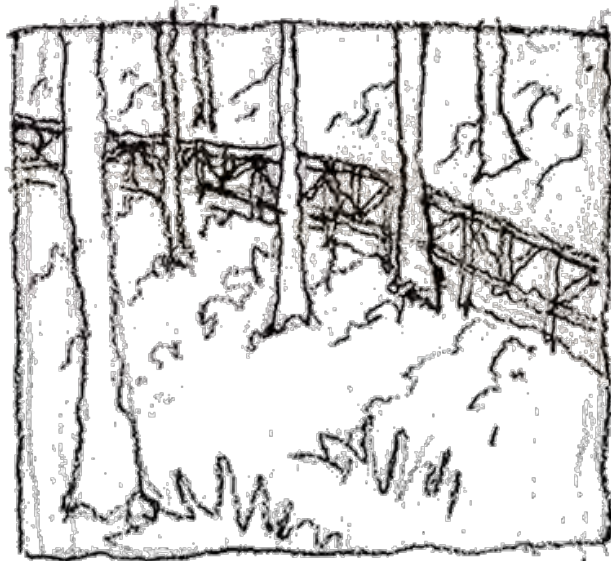
VISITOR EXPERIENCE (MAY-OCTOBER)



VISITOR EXPERIENCE (NOVEMBER-APRIL)



SENSE OF PLACE



rustic wood rail thru the woods

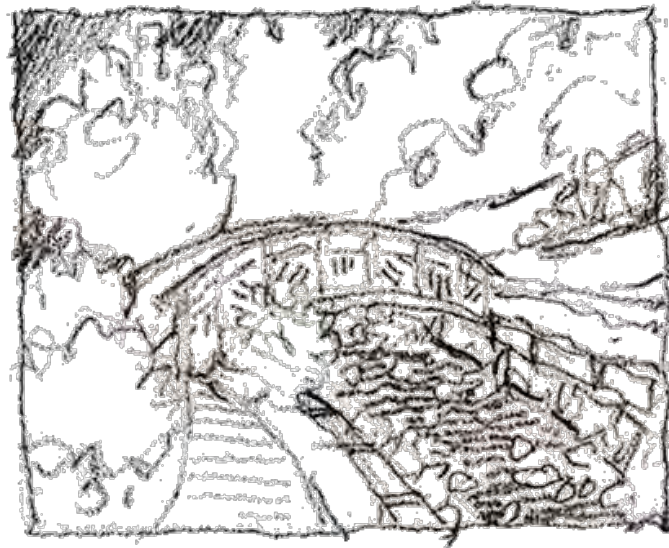


Perennial border



Beautiful pavilion, filthy skylights

POSITIVES

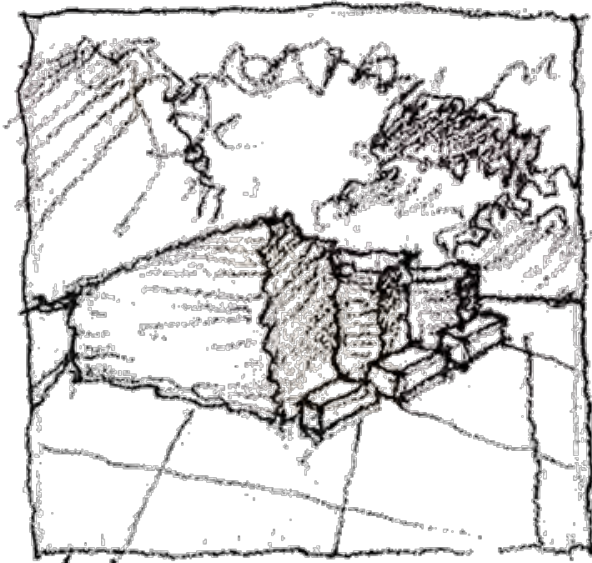


Romance



huge white oak

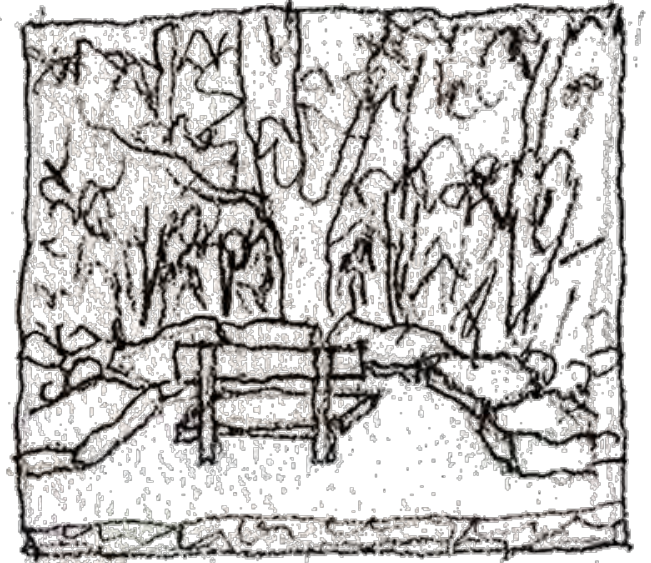
SENSE OF PLACE



Hedges at entrance to visitor center

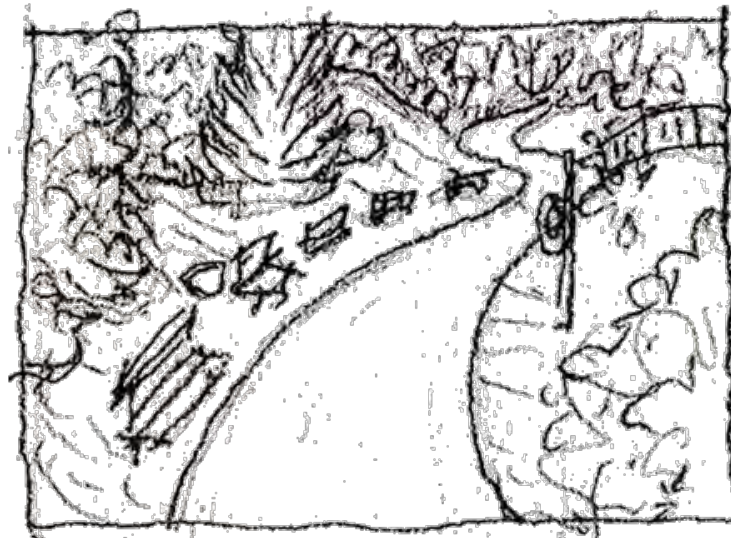


conc. ret. wall, with galv. pipe railing

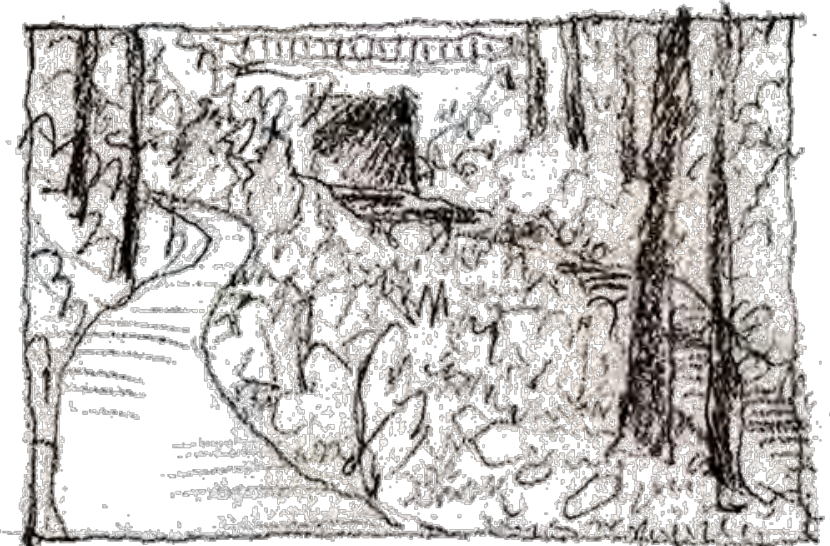


dense brush between bench & creek

NEGATIVES



benches lined up along path



Scruffy island between path & creek

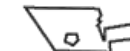
Site Opportunities & Constraints





SIZE COMPARISON



TORONTO BOTANICAL GARDEN

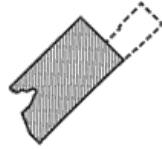


EDWARDS GARDENS

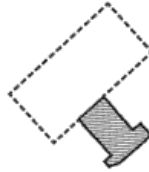
 Manicured area
 Adjacent natural area



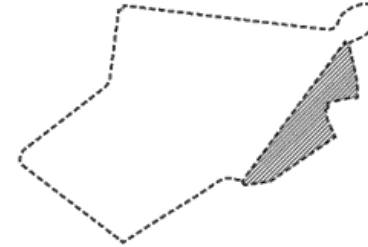
DALLAS ARBORETUM & BOTANICAL GARDEN
TEXAS, USA



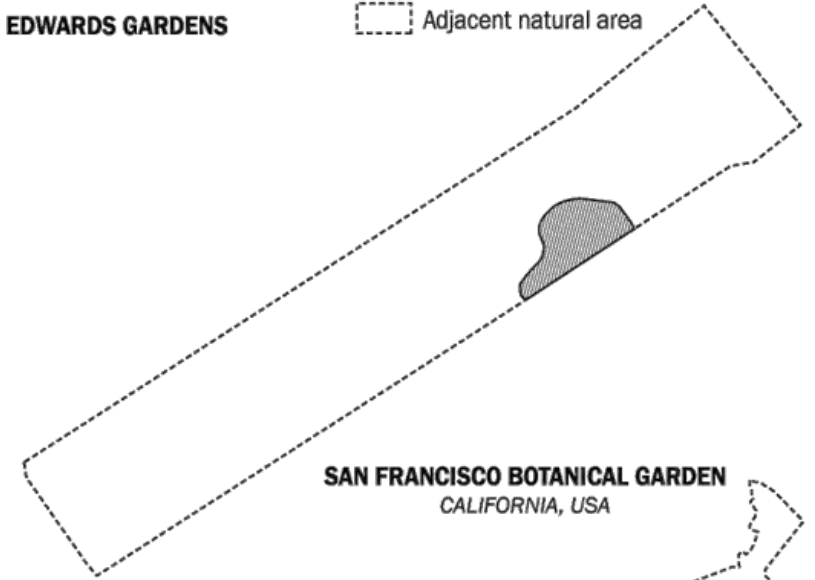
VANDUSEN BOTANICAL GARDEN
BRITISH COLUMBIA, CANADA



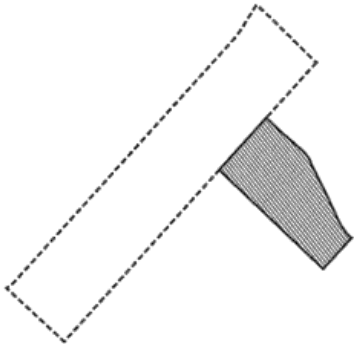
DENVER BOTANIC GARDENS
COLORADO, USA



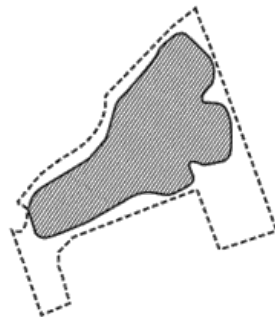
BROOKLYN BOTANIC GARDEN
NEW YORK, USA



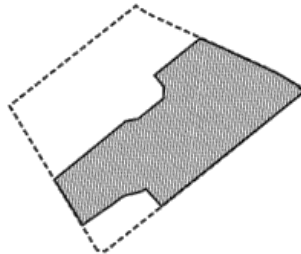
SAN FRANCISCO BOTANICAL GARDEN
CALIFORNIA, USA



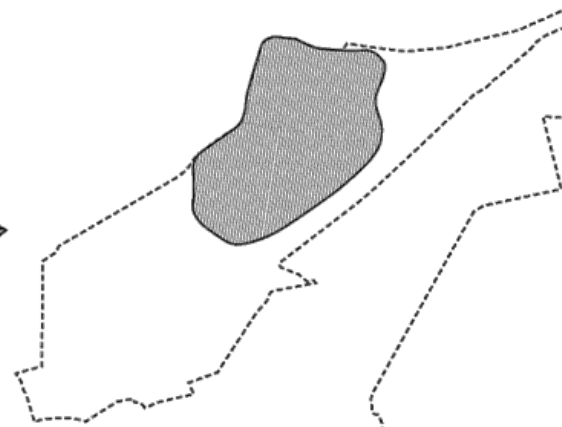
MISSOURI BOTANICAL GARDEN
MISSOURI, USA



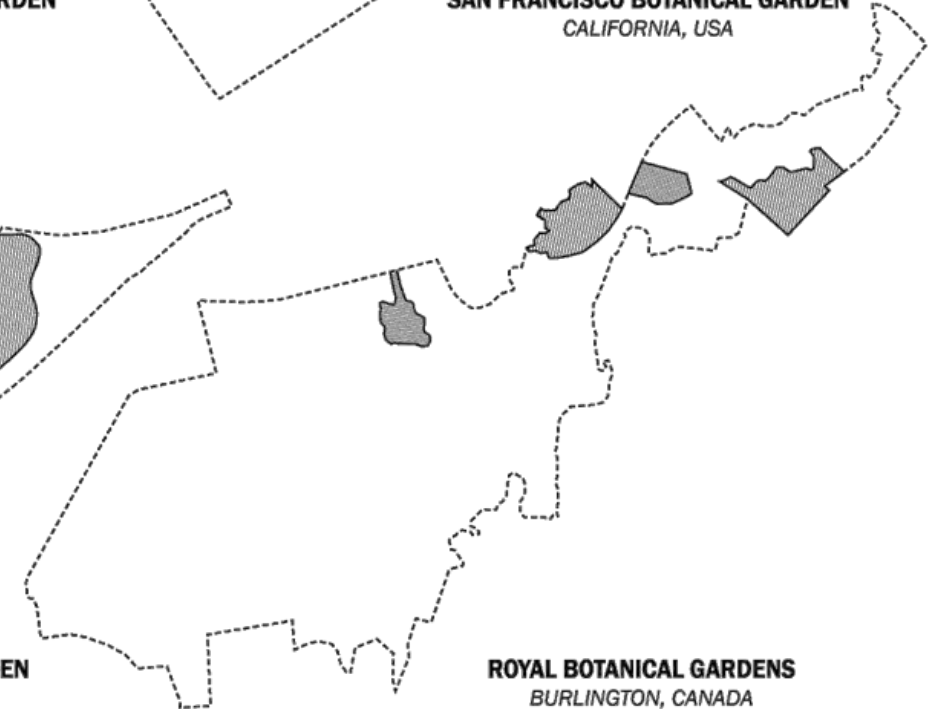
CHICAGO BOTANIC GARDEN
ILLINOIS, USA



MONTREAL BOTANIC GARDEN
QUEBEC, CANADA

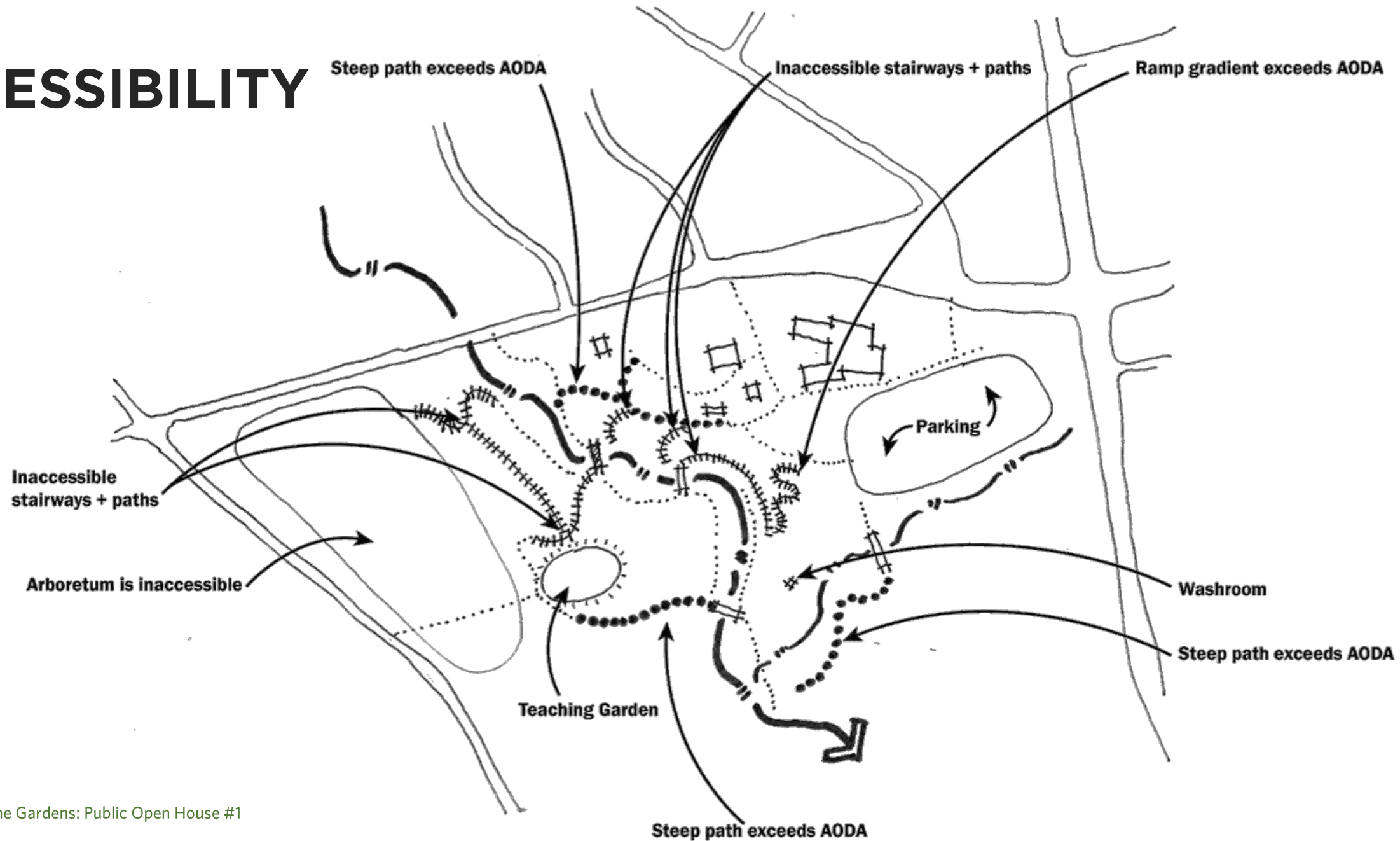


NEW YORK BOTANICAL GARDEN
NEW YORK, USA



ROYAL BOTANICAL GARDENS
BURLINGTON, CANADA

ACCESSIBILITY

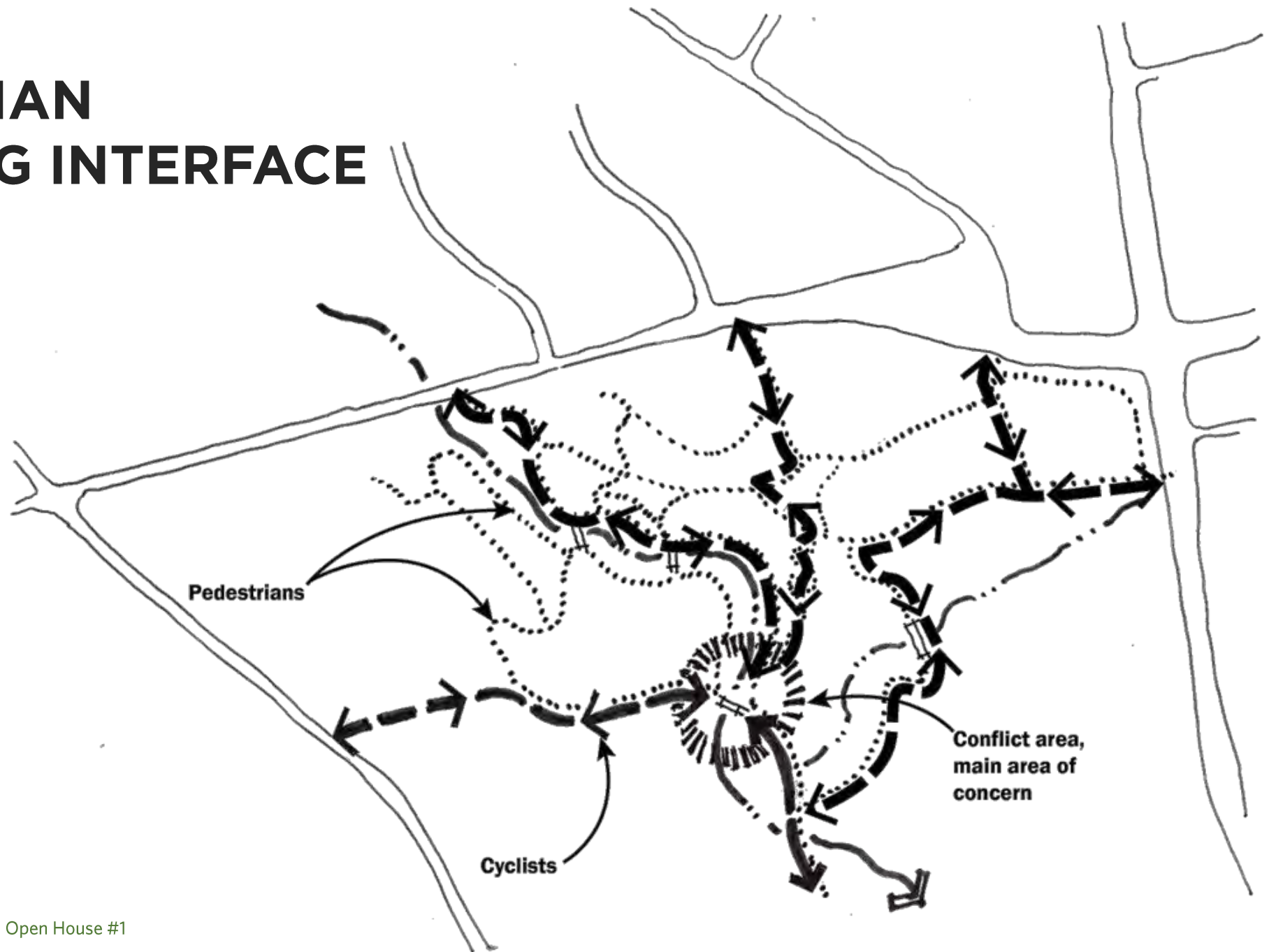


ACCESSIBILITY

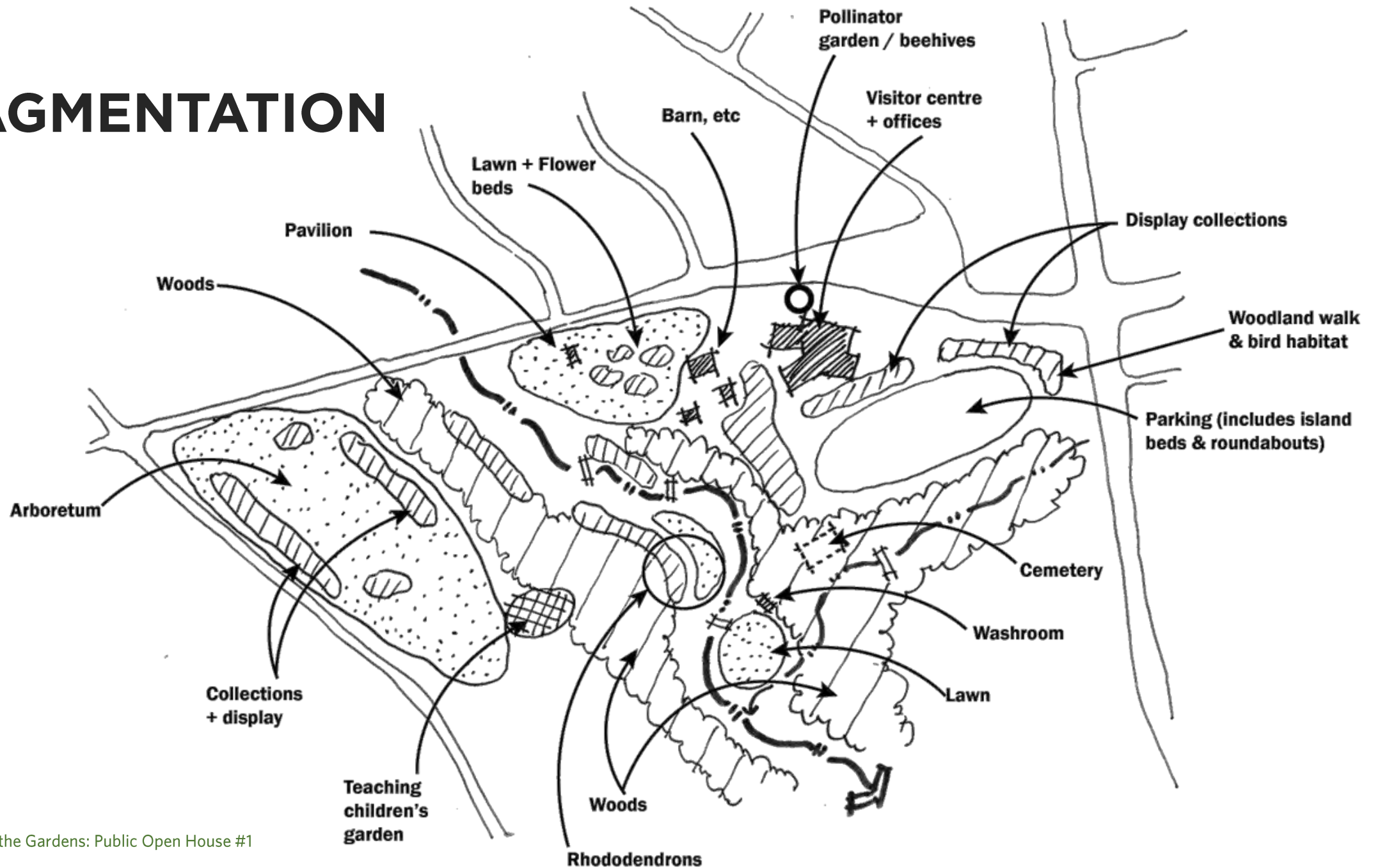


Photo: W. Gary Smith

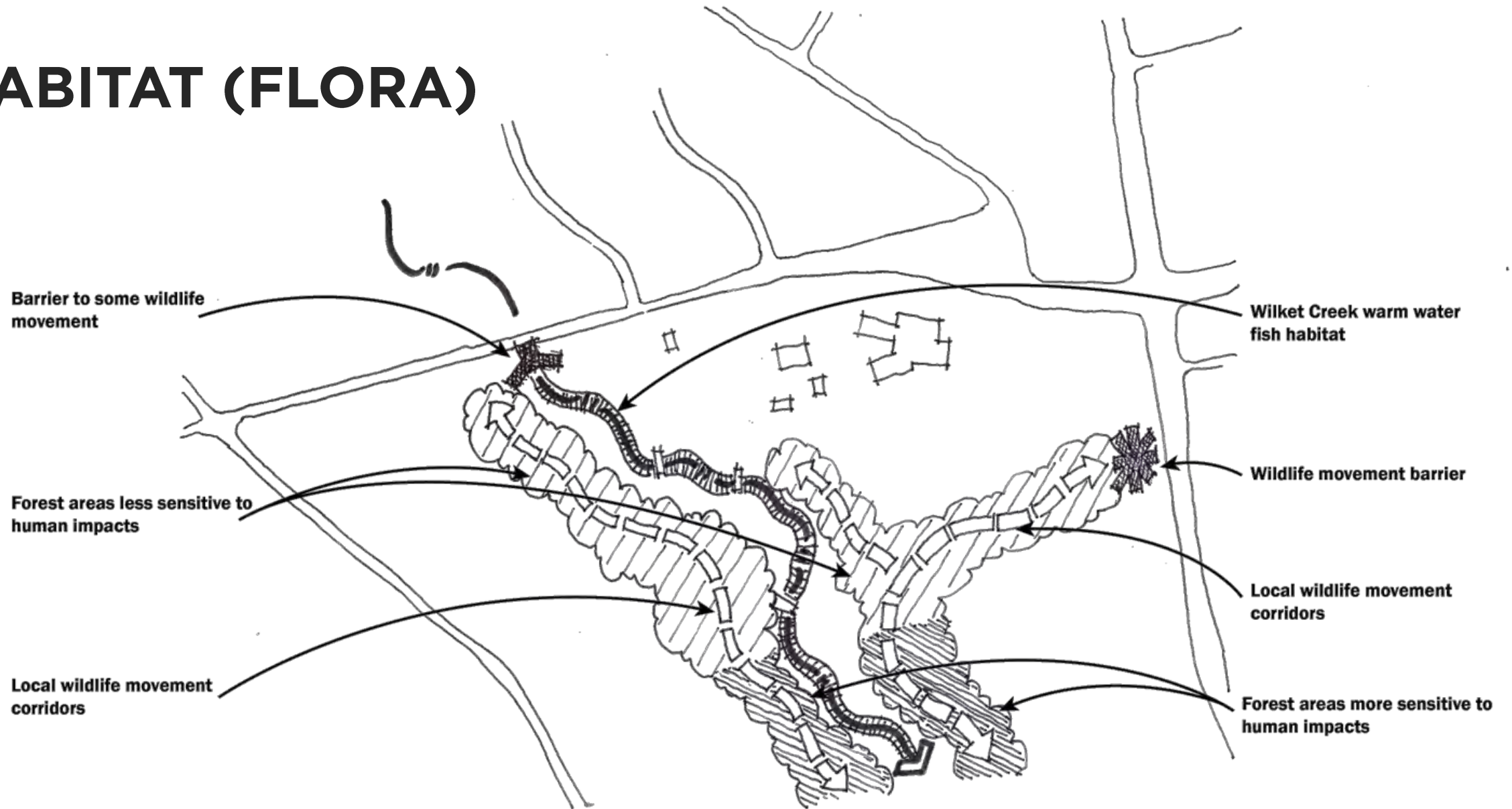
PEDESTRIAN + CYCLING INTERFACE



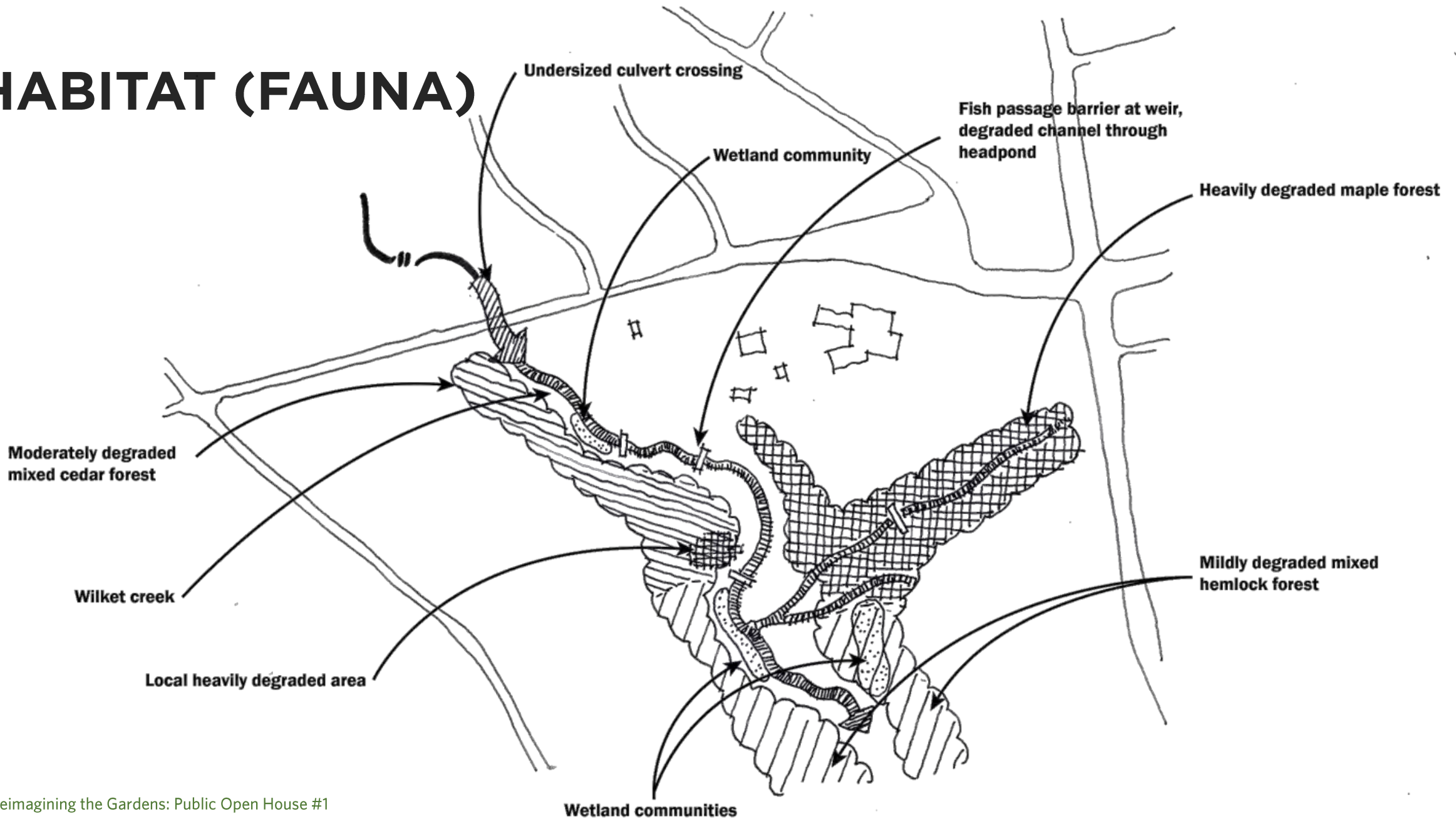
FRAGMENTATION



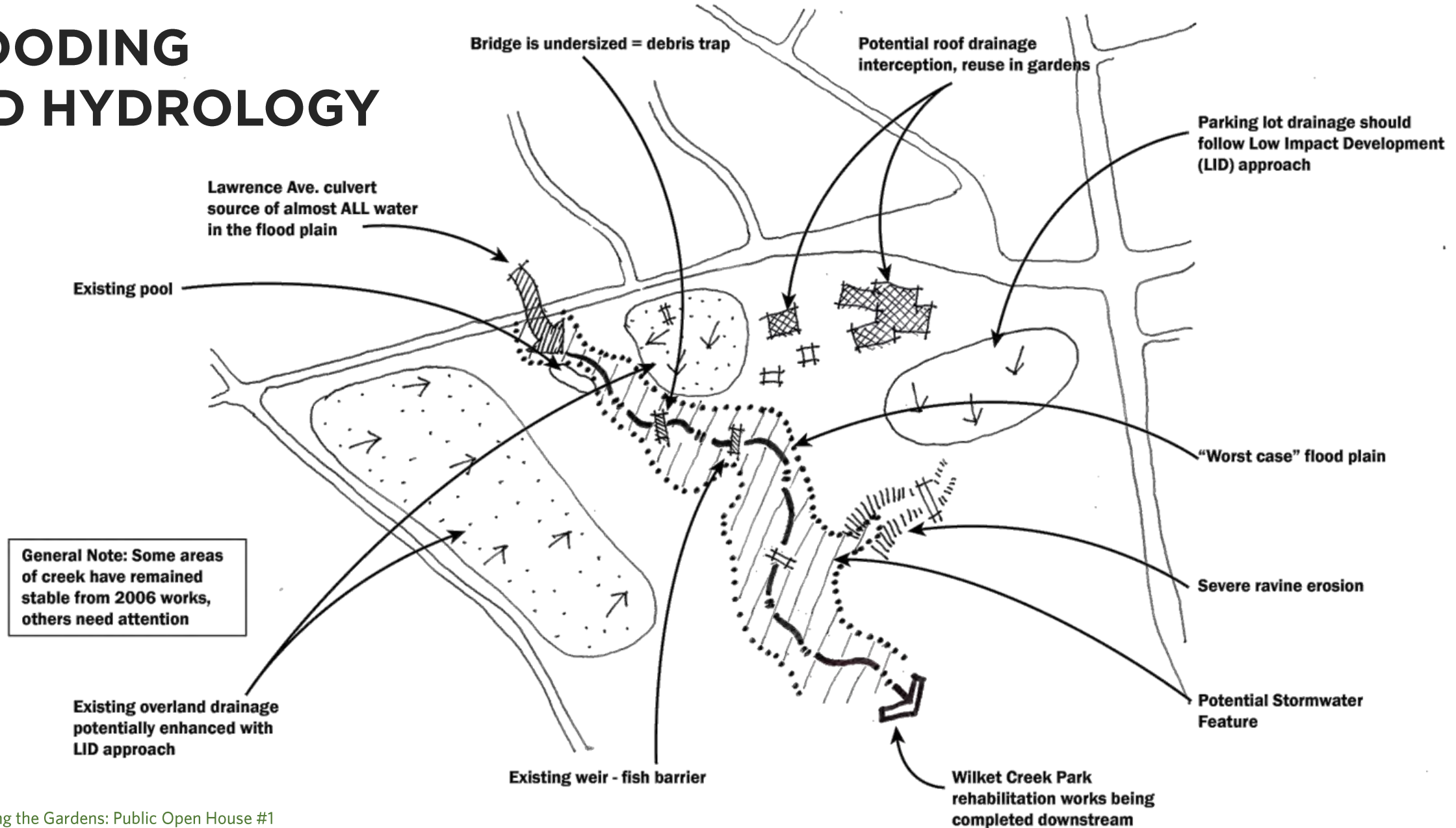
HABITAT (FLORA)



HABITAT (FAUNA)



FLOODING AND HYDROLOGY



Trends in Public Parks and in Public Gardens



Reclaimed, Linked or Satellite Gardens

Source: Wikimedia Commons



Taken by Jason Goh, Source: Pixabay



Kew Gardens @ The British Museum –
Singapore Changi Airport

Photo & Source: City of Calgary



Bend in the Bow, Calgary

Eco-Engineering & Infrastructure



Natural Landscaping
@Chicago Botanic Gardens



Stormwater Diversion
Santa Fe Botanic Garden



Bioswale Amphitheatre
@Manassas Park School

School Gardens, Citizen Science & Stewardship



School Garden Plots @Royal Botanic Gardens Edinburgh



Delaware Nature Society

Urban Agriculture & Food



Hidden Harvest, Ottawa



Edible Garden & Outdoor Kitchen @Bok Tower Gardens

Wellness & Special Occasions



Glasgow Botanic Gardens
Yoga @Central Park



Ness Botanic Gardens

Easy to Get There & Find



Long Weekend Shuttle,
Gardens by the Bay



Brooklyn Botanic Gardens

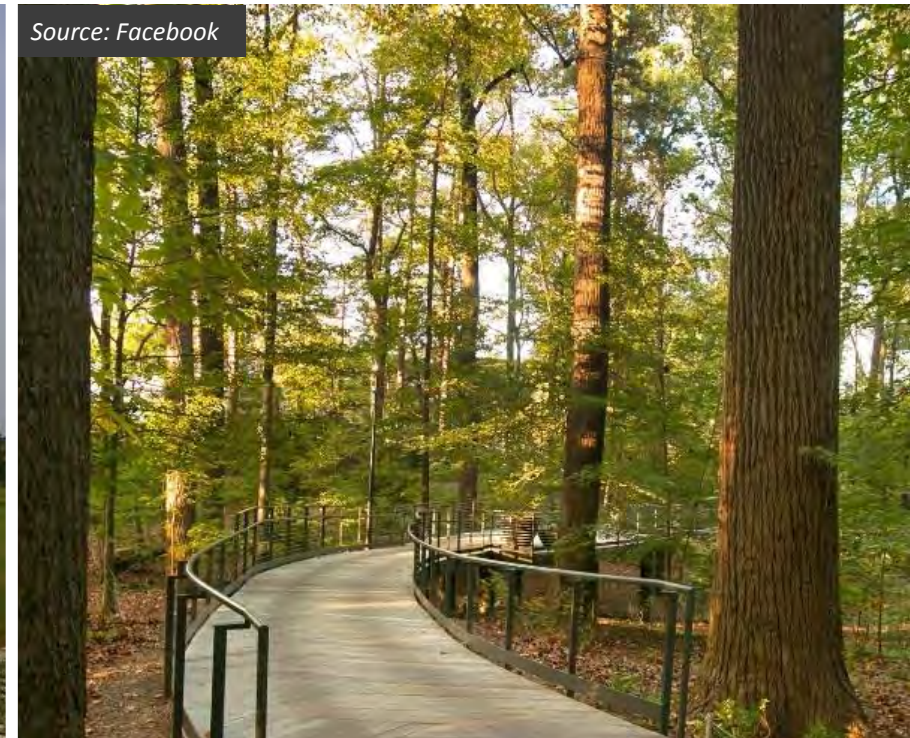
Accessible for All



Shifnall Millennium
Sensory Garden



Horticultural Therapy @
Scattering Garden
Hacquegnies, Belgium



Atlanta Botanical Gardens

Approachable Staff



Longwood Gardens, PA



Royal Botanic Gardens Edinburgh

Culturally Specific/Sensitive Programs



Canada's Diversity Gardens



Desert Botanical Gardens



Devonian Botanic Gardens

Universal Appeal



Cheekwood Botanical
Garden and Museum



VanDusen Botanical Gardens



Swarovski Kristallwelten

Night Time Access

Source: Facebook



Kew Gardens

Source: Facebook



Canyon Lights, Capilano Suspension Bridge Park, BC

Four Season Access – Winter

Source: Facebook



Luminaria, Devonian Botanic Gardens

Source: Fungus Guy, Wikimedia Commons



Algonquin Provincial Park

Outstanding Displays, Immersive Experiences & Art

Source: Facebook



Butchart Gardens

Source: Top & Bottom - Facebook



Meadow Gardens @ Longwood Gardens
Love Bomb @Jupiter Artland

Adventure & New Experiences

Source: Facebook



Skywalk, Kirstenbosch Botanic Gardens, South Africa

Source: Facebook



Zip Line, Eden Project

Live Performance & Festivals



Rose Fitzgerald Kennedy Greenway
Conservancy Food Truck Day



Outdoor Stage, Singapore
Botanic Gardens

Experimental & Test Gardens

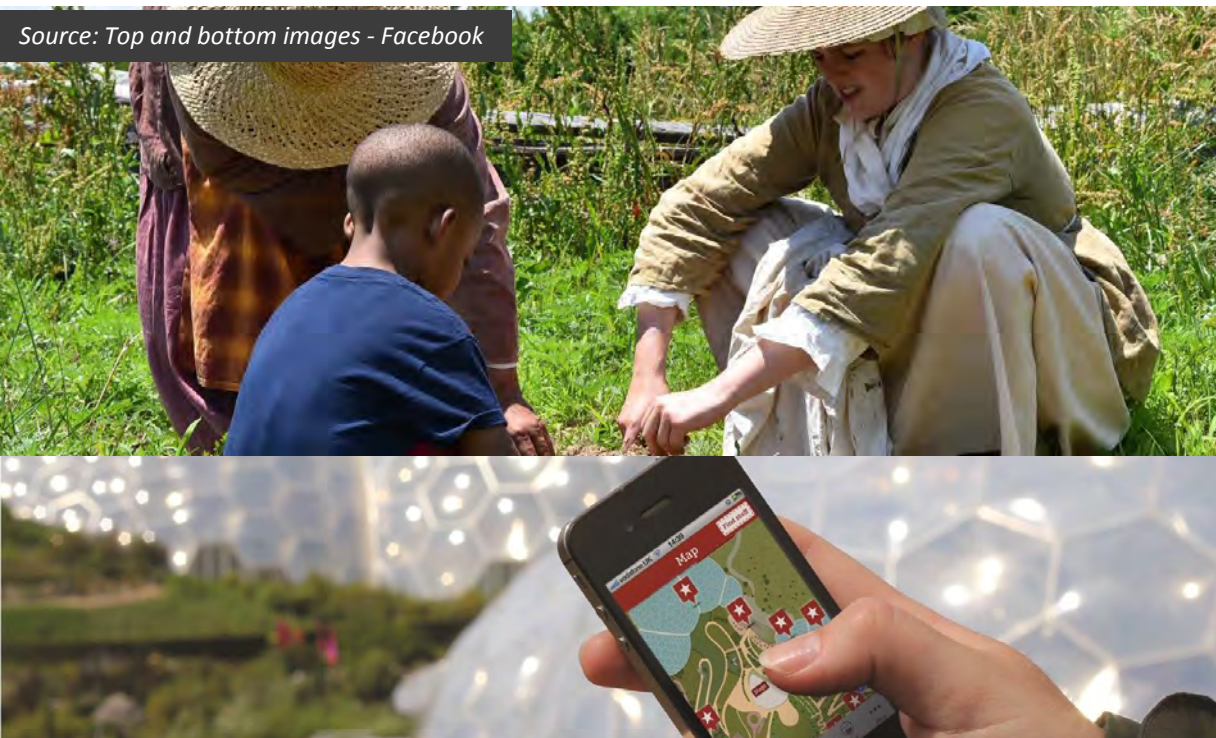


Roma Street Park, Brisbane Australia

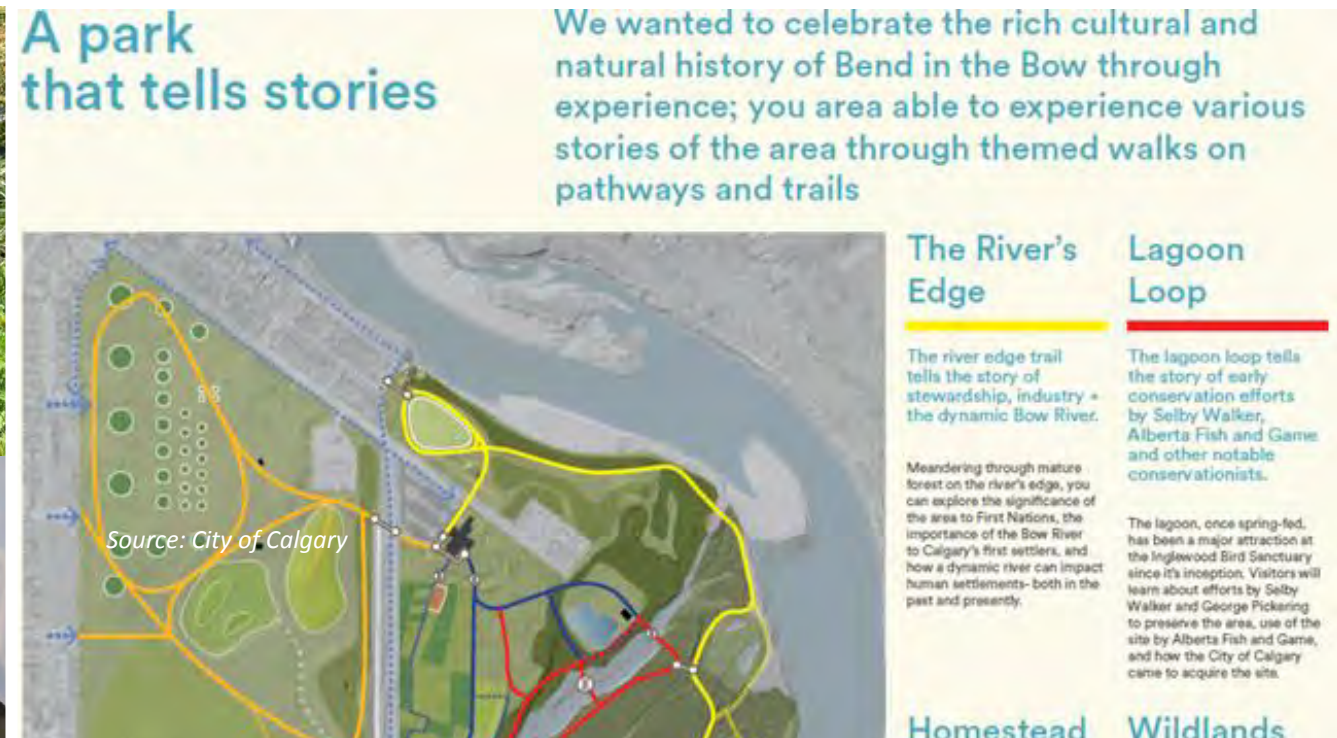


Dubuque Arboretum and Botanical Gardens

Layered Narratives



Food Traditions @National Colonial Farm & Eden Project App, UK



Bend in the Bow, Calgary

Drop-in Activity & Themed Tours

Source: Delaware Nature Society website

Programs

SATURDAYS & SUNDAYS 4/11 - 11/29
10:00 AM - 11:00 AM & 2:00 PM - 3:00 PM
Join a naturalist and become a citizen scientist. Explore the trails in search of birds, nests, eggs, butterflies, salamanders, frogs and more. Each weekend join us and explore how the natural world is changing.

Brown Bag Lecture Series
LAST FRIDAYS 4/24 - 8/28
12:00 PM - 1:00 PM
Bring your lunch and enjoy a lecture with our staff and other special guests in the Ashland Nature Center Auditorium.

Lecture topics
June 26: Top 20 Native Plants for the Backyard with Lori Athey
July 18: Birds and Wildlife of the Big Bend Region of Texas with Joe Sebastiani
August 22: Natural History Mystery with Jim White

FREE walk-in weekly programs
No pre-registration required. Just show up!

Coverdale walk-in programs are FREE for Members. See at night for Non-member pricing.

MEMBER CHILD	NON-MEMBER CHILD	MEMBER ADULT	NON-MEMBER ADULT
FREE	\$3 (AGE 2+)	FREE	\$5

Farm Fun Days
WEDNESDAYS 5/6 - 9/30
12:00 PM - 2:30 PM
Take a self-guided tour, meet our farm animals, and more. [Learn more »](#)

Farm Fun Saturdays
SATURDAYS 5/8 - 9/30
Morning animal chores, feeding, watering, self-guided tours of the farmstead (animals, garden, observation bee hive)



Delaware Nature Society

Source: Oxford University Botanic Gardens website

Tales of trees and other plants

An audio trail told by our gardeners, also featuring author Philip Pullman

Suitable for ages 10+



1
Welcome
Place the pen here to begin the trail

2
What do the labels mean?

Rosa canina

The University of Oxford Botanic Garden and Harcourt Arboretum

Director of the Botanic Garden & Harcourt Arboretum, **Timothy Walker**

Glasshouses Curator, **Kate Pritchard**

Storyteller, **Xanthe Gresham**

Primary and Families Education Officer, **Emma Williams**

Oxford University Botanic Gardens

Signature Plants & Features



Titan Arum, Eden Project



Public Toilets, Longwood Gardens

Garden Interpretation, Interactives & Activity Stations



Adelaide Botanic Gardens



Kew Gardens



Brooklyn Botanic Gardens

Permanent Galleries, Temporary Exhibitions & Visible Storage



Interdisciplinary Program Partnerships



Burden Blossom Fire Dragon
@ Desert Botanical Garden



Longwood Gardens

Research & Education Partnerships



Center for Southeastern
Conservation, Atlanta



Ph.D Plant Biology and Conservation
@Northwestern & Chicago Botanic Garden

DISCUSSION: ISSUES AND OPPORTUNITIES

DISCUSSION:

Where do we
want to be?

BOTANIC
RESEARCH
CONSERVATION

PUBLIC
PARK

DISPLAY
AESTHETICS
EXPERIENTIAL

PUBLIC
GARDEN



STRENGTHS AND WEAKNESSES

- What is currently working well in the Gardens? What features do you like?
- What do you feel are the main issues that need to be addressed in the Gardens?



KEY OPPORTUNITIES

- What do you feel are the key opportunities?



VISION FOR THE REIMAGINED GARDENS

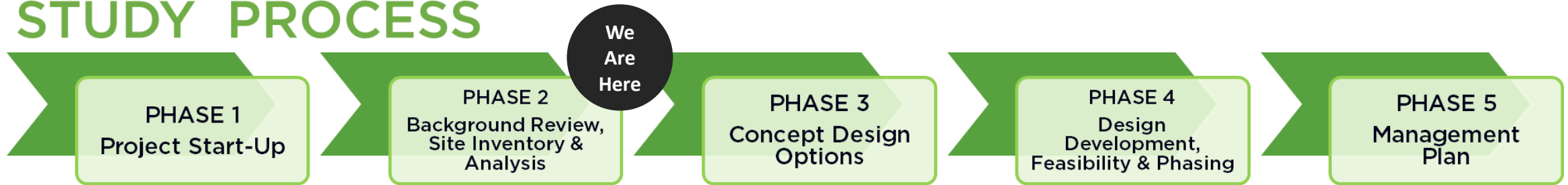
- In the future, I would like...

Questions & Next Steps



NEXT STEPS

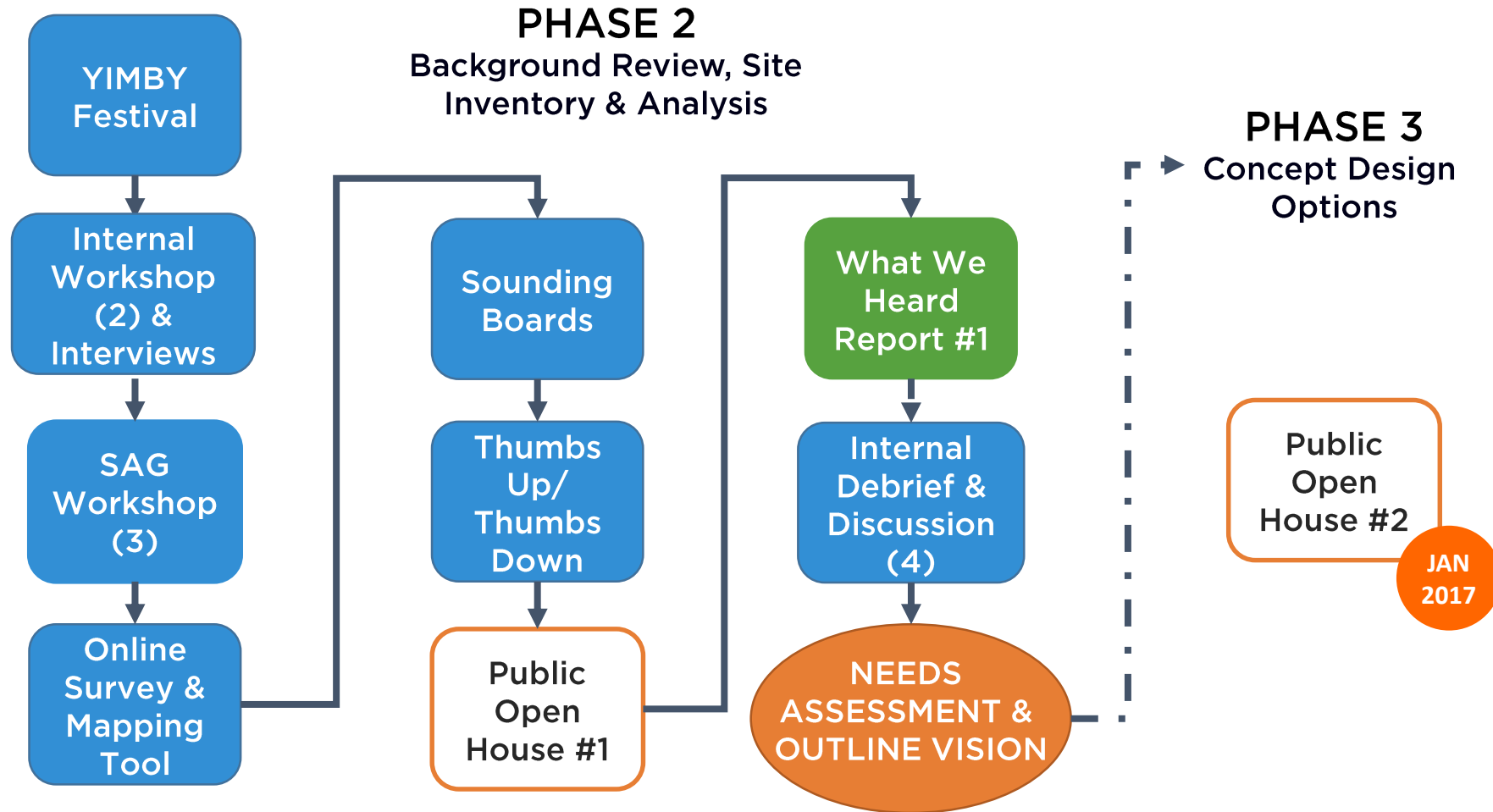
STUDY PROCESS



ENGAGEMENT PROCESS



NEXT STEPS



CONTRIBUTE & STAY INFORMED



Sign up for our
Project E-Newsletter



Complete the Online Survey

www.surveymonkey.com/r/ReimaginetheGardens



Website

toronto.ca/edwardsgardens-tbg

THANK YOU.

