

Authority: Scarborough Community Council Item SC31.3
as adopted by City of Toronto Council on May 20, 21 and
22, 2026

CITY OF TORONTO

Bill 480

BY-LAW -2026

To adopt Official Plan Amendment 901 for the City of Toronto respecting the lands known municipally in the year 2025, as 1710 and 1712 Ellesmere Road.

Whereas authority is given to Council under the Planning Act, R.S.O. 1990, c. P.13, as amended, to pass this By-law; and

Whereas Council of the City of Toronto has provided adequate information to the public and has held at least one public meeting in accordance with the Planning Act;

The Council of the City of Toronto enacts:

1. The attached Amendment 901 to the Official Plan is hereby adopted pursuant to the Planning Act, as amended.

Enacted and passed on May , 2026.

Frances Nunziata,
Speaker

John D. Elvidge,
City Clerk

(Seal of the City)

**AMENDMENT 901 TO THE OFFICIAL PLAN
LANDS MUNICIPALLY KNOWN IN THE YEAR 2025 AS 1710 and 1712 Ellesmere
Road**

The Official Plan of the City of Toronto is amended as follows:

1. Maps 19 and 20, Land Use Plan, are amended by redesignating a portion of the lands known municipally as 1710 and 1712 Ellesmere Road in the year 2025 from *Mixed Use Areas* to *Parks* as shown on the attached Appendix 1.
2. Schedule 2, The Designation of Planned but Unbuilt Roads, is amended by adding the following planned but unbuilt road:

Street Name	From	To
New east-west link	Grangeway Avenue approximately 125 metres north of Ellesmere Road	Approximately 210 metres east of Grangeway Avenue

3. Map 5-3, Scarborough Centre Secondary Plan, Street Network, is amended by deleting the existing New/Modified Street and replacing it with a new New/Modified Street as shown on the attached Appendix 2.
4. Map 5-4, Scarborough Centre Secondary Plan, Active Transportation, is amended by adding a new Active (Pedestrian/Cycling) Connection as shown on the attached Appendix 3.
5. Map 5-5, Scarborough Centre Secondary Plan, Green Linkages, is amended by adding a new Greening of Pedestrian Access to form Green Linkages as shown on the attached Appendix 4.

Appendix 1

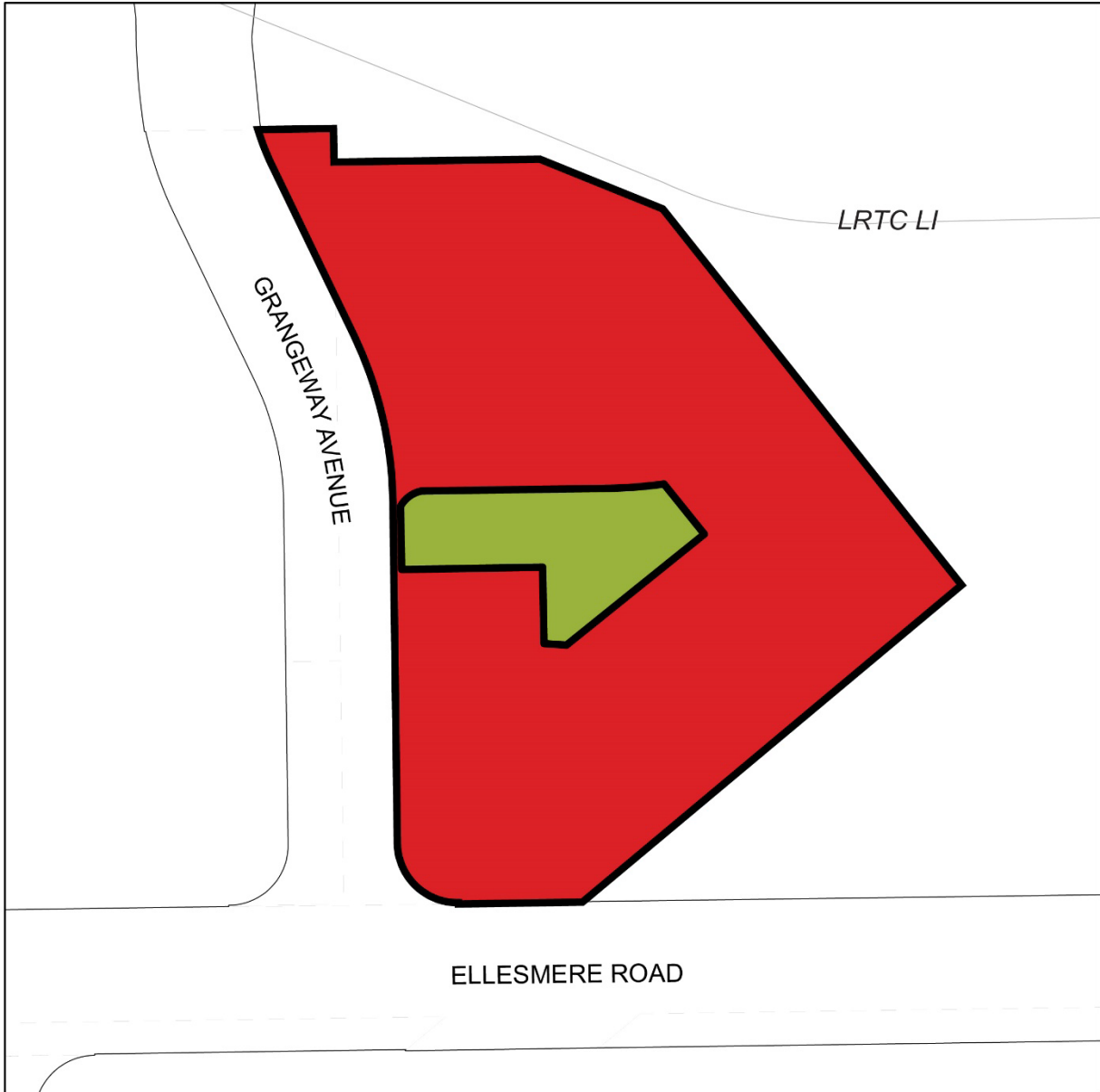



1710 & 1712 Ellesmere Road

Official Plan Amendment # 901

Proposed Revisions to Maps 19 and 20, Land Use Plan, to redesignate a portion of the lands from Mixed Use Areas to Parks

File # 23 165474 ESC 24 02

-  Subject Site
-  Mixed Use Areas
-  Parks



02/23/2026

Appendix 2

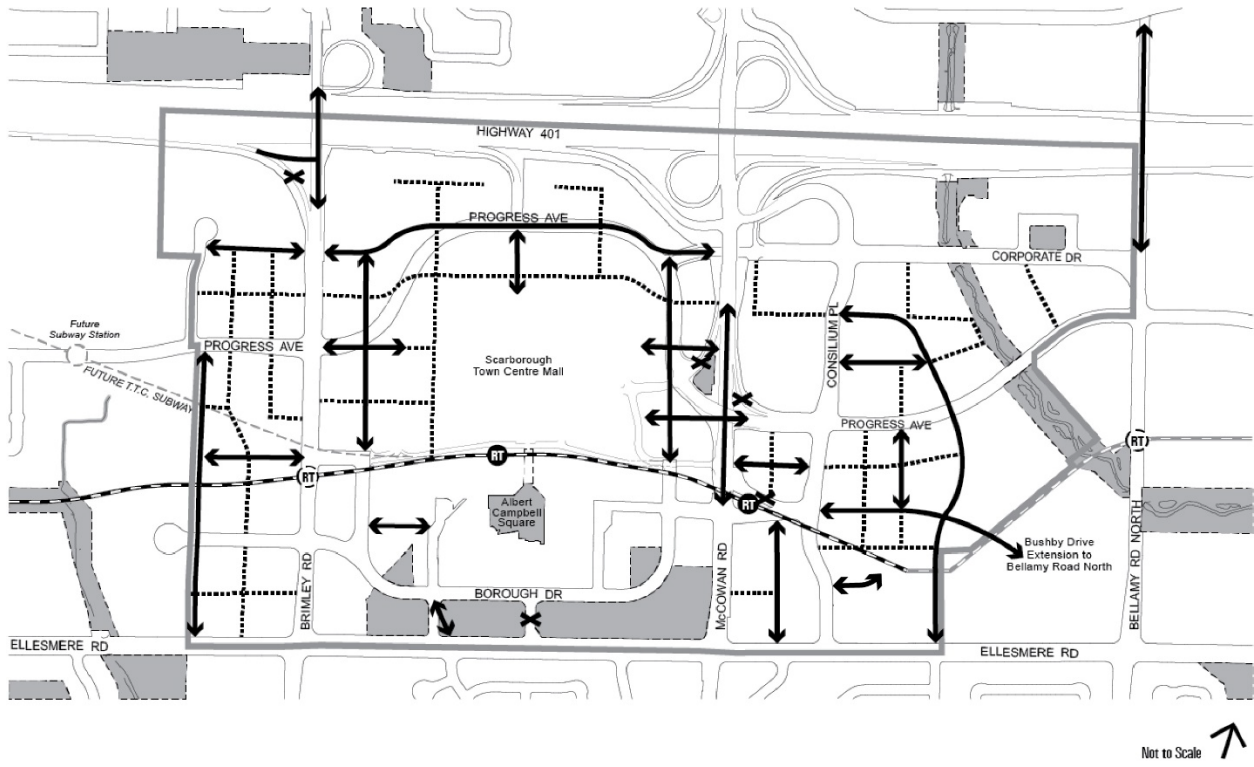

- Scarborough Centre Secondary Plan Boundary
- T.T.C. Scarborough Rapid Transit
- - - Proposed TTC Scarborough Rapid Transit Expansion
- RT Rapid Transit Station
- (RT) Potential Rapid Transit Station
- ↔ New/ Modified Street
- New Connection
- ✕ Potential Closure

Appendix 3

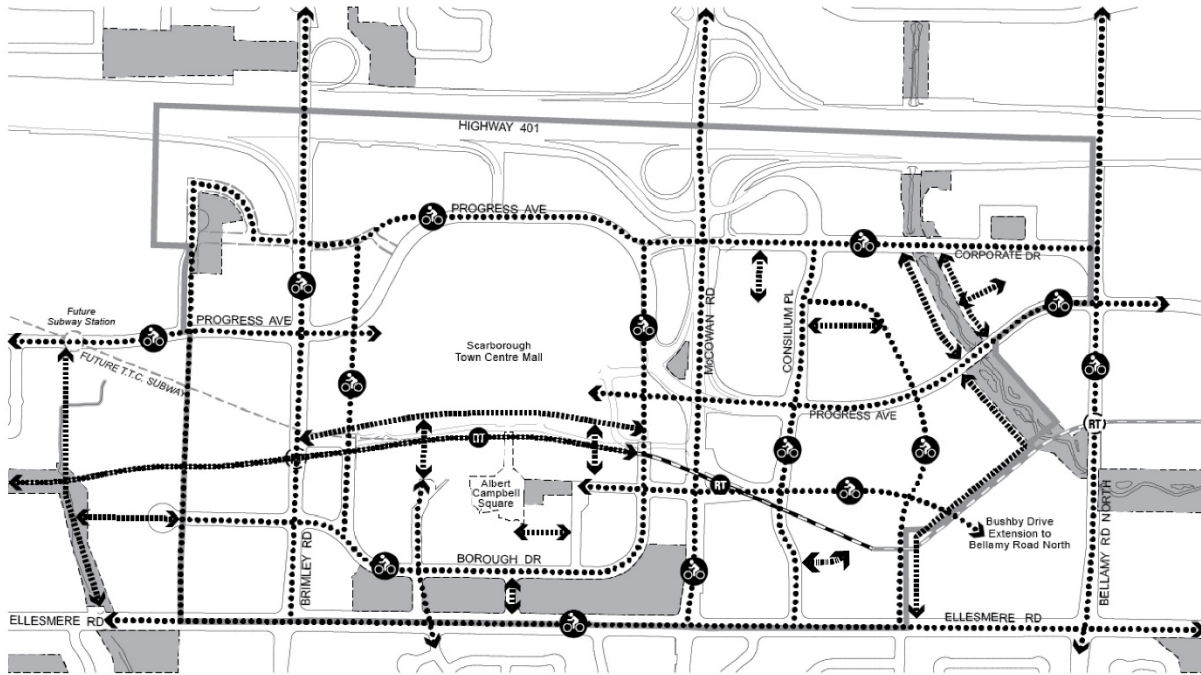

Scarborough Centre Secondary Plan

Map 5-4 Active Transportation Network

- Scarborough Centre Secondary Plan Boundary
- Parks and Open Space Areas
- T.T.C. Scarborough Rapid Transit
- Proposed TTC Scarborough Rapid Transit Expansion
- Rapid Transit Station
- Potential Rapid Transit Station
- Dedicated Cycling Connection
- Active (Pedestrian / Cycling) Connection

May 2018

Appendix 4

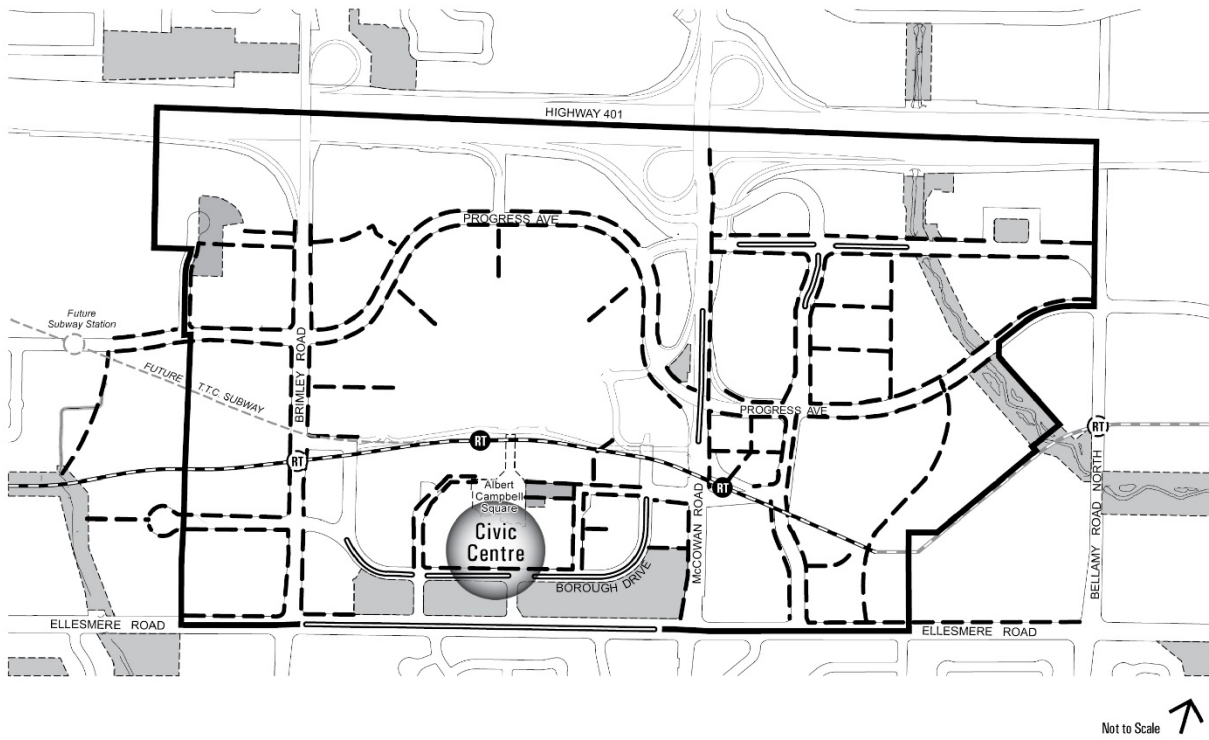

Not to Scale ↑



Scarborough Centre Secondary Plan

Map 5-5 Green Linkages

- Scarborough Centre Secondary Plan Boundary
- Parks and Open Space Areas
- T.T.C. Scarborough Rapid Transit
- Proposed T.T.C. Scarborough Rapid Transit Expansion
- Rapid Transit Station
- Potential Rapid Transit Station
- Potential & Existing Boulevard Trees / Landscaping
- Greening of Pedestrian Access to form Green Linkages

October 2013