

Authority: Humber York Community Council Report No. 9, Clause No. 5,  
as adopted by City of Toronto Council on June 18, 19 and 20, 2002  
Enacted by Council: April 16, 2003

## **CITY OF TORONTO**

### **BY-LAW No. 210-2003**

#### **To amend the General Zoning By-law No. 438-86 of the former City of Toronto in respect of the lands known as 15 Thorburn Avenue.**

WHEREAS City Council at its meeting of February 1, 2 and 3, 2000 established the Parkdale Pilot Project for the purpose, among others, of regularizing the numerous bachelorette and rooming house buildings in the Parkdale area; and

WHEREAS the owner of the lands known municipally as 15 Thorburn Avenue has applied for consideration in accordance with the Project process; and

WHEREAS the application meets the criteria and thus it is appropriate to amend the General Zoning By-law to permit the proposed use; and

WHEREAS the Council of the City of Toronto has had referred to it a proposed Zoning By-law respecting the site; and

WHEREAS the Council of the City of Toronto conducted a public meeting under Section 34 of the *Planning Act*, R.S.O. 1990, c.P. 13, as amended, regarding the proposed Zoning By-law; and

WHEREAS the Council of the City of Toronto, at its meeting held on June 18, 19 and 20, 2002, determined to amend the Zoning By-law for the former City of Toronto;

The Council of the City of Toronto HEREBY ENACTS as follows:

#### **EXEMPT PROVISIONS**

- (1) Subject to the requirements of this by-law, none of the following provisions of By-law No. 438-86 being "A by-law to regulate the use of land and the erection, use, bulk, height, spacing of and other matters relating to buildings and structures and to prohibit certain uses for lands and the erection and use of certain buildings and structures in various areas of the City of Toronto" as amended, shall apply to prevent the erection or use of a *converted house* on those lands outlined by heavy lines on Map 1:

#### **PARKING**

- (a) Section 4 (4) b

#### **DENSITY**

- (b) Section 6 (3) Part I 1

MINIMUM UNIT SIZE

- (c) Section 6 (2) 1 (iv)
- (d) Section 12 (2) 70 (ii)

DEPTH OF BUILDING

- (e) Section 6 (3) Part II 5

SIDE YARD SETBACK

- (f) Section 6 (3) Part II 3 (ii) Chart F

REAR YARD SETBACK

- (g) Section 6 (3) Part II 4

**SUBSTITUTE PROVISIONS**

- (2) No person shall erect or use a *converted house* on those lands outlined by heavy lines on Map 1 unless:

NUMBER OF UNITS

- (a) no more than thirteen *dwelling units*, all of which may be *bachelor dwelling units* are provided within the *converted house*;

MINIMUM UNIT SIZE

- (b) the average of the floor areas of the *dwelling units* is not less than 17.146m<sup>2</sup>;
- (c) the floor area of any individual *dwelling unit* is not less than 14.92m<sup>2</sup>;

DENSITY

- (d) the *residential gross floor area* of the converted house does not exceed 337.198m<sup>2</sup>; and

BUILDING ENVELOPE

- (e) no portion of the *converted house* is located otherwise than wholly within the *building envelope*, exclusive of those elements set out in Section 6(3) Part II 8 Chart provisions A, B, C, D, E, L and N, and those building elements set out in Section 6(2) 1(iii) F, of By-law No. 438-86 of the former City of Toronto, as amended.

**DEFINITIONS**

(3) For the purpose of this by-law:

(i) *building envelope* means the area shaded by diagonal lines on Map 1.

**GENERAL**

(4) With the exception of any defined terms to the extent modified by this by-law, all other provisions of By-law No. 438-86 of the former City of Toronto, as amended, continue to apply.

ENACTED AND PASSED this 16th day of April, A.D. 2003.

CASE OOTES,  
Deputy Mayor

ULLI S. WATKISS  
City Clerk

(Corporate Seal)

## MAP 1

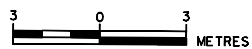
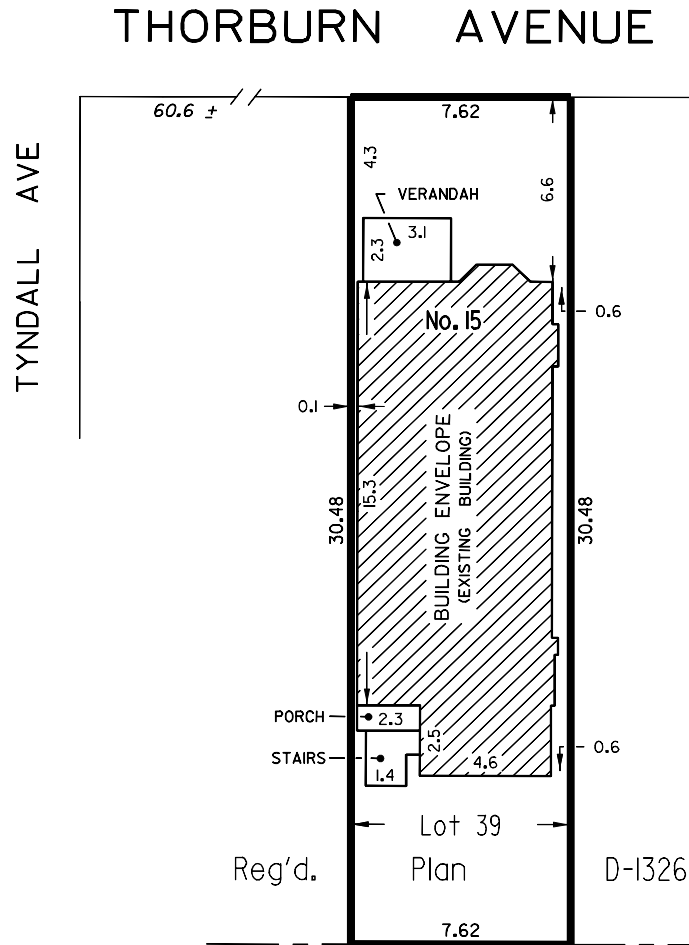

WORKS AND EMERGENCY SERVICES  
SURVEY AND MAPPING SERVICES  
TORONTO JUNE, 2002  
BLO2/ 15THOR1.DGN  
FILE: 2402.84  
MAP No. 48G-323 DRAWN: D.R.