

Authority: Notice of Motion J(3), moved by Councillor Chow, seconded by Deputy Mayor
Pantalone, as adopted by City of Toronto Council on May 4, 2005
Enacted by Council: May 4, 2005

CITY OF TORONTO

BY-LAW No. 336-2005

**To effect interim control on those lands generally bounded by Queen Street West,
Spadina Avenue, Front Street West, John Street and Simcoe Street.**

WHEREAS Council, at its meeting of May 4, 2005 adopted a report from the Chief Planner and Executive Director, City Planning, dated May 4, 2005 directing that a study be conducted by the Chief Planner and Executive Director, City Planning Division in respect of land use policies for certain lands within the King-Spadina Part II Plan area; and

WHEREAS Section 38 of the *Planning Act* permits the Council of a municipality to pass a by-law prohibiting the use of land, buildings or structures within the defined area under review for, or except for, such purposes as are set out in the by-law;

The Council of the City of Toronto HEREBY ENACTS as follows:

1. No person shall, within the lands shown within the heavy lines on the map attached to this By-law, use any land or erect or use any building or structure or any addition to any building or structure for an *entertainment facility* or a *patio* in conjunction with an *entertainment facility*.
2. For the purpose of this By-law each word or expression which is italicized shall have the same meaning as each such word or expression as defined in By-law No. 438-86 of the former City of Toronto, being "A By-law to regulate the use of land and the erection, use, bulk, height, spacing of and other matters relating to buildings and structures and to prohibit certain uses of lands and the erection and use of certain buildings and structures in various areas of the City of Toronto", as amended.
3. This By-law shall be in effect for a period of one year from the 4th day of May, 2005.

ENACTED AND PASSED this 4th day of May, A.D. 2005.

DAVID R. MILLER,
Mayor

ULLI S. WATKISS
City Clerk

(Corporate Seal)

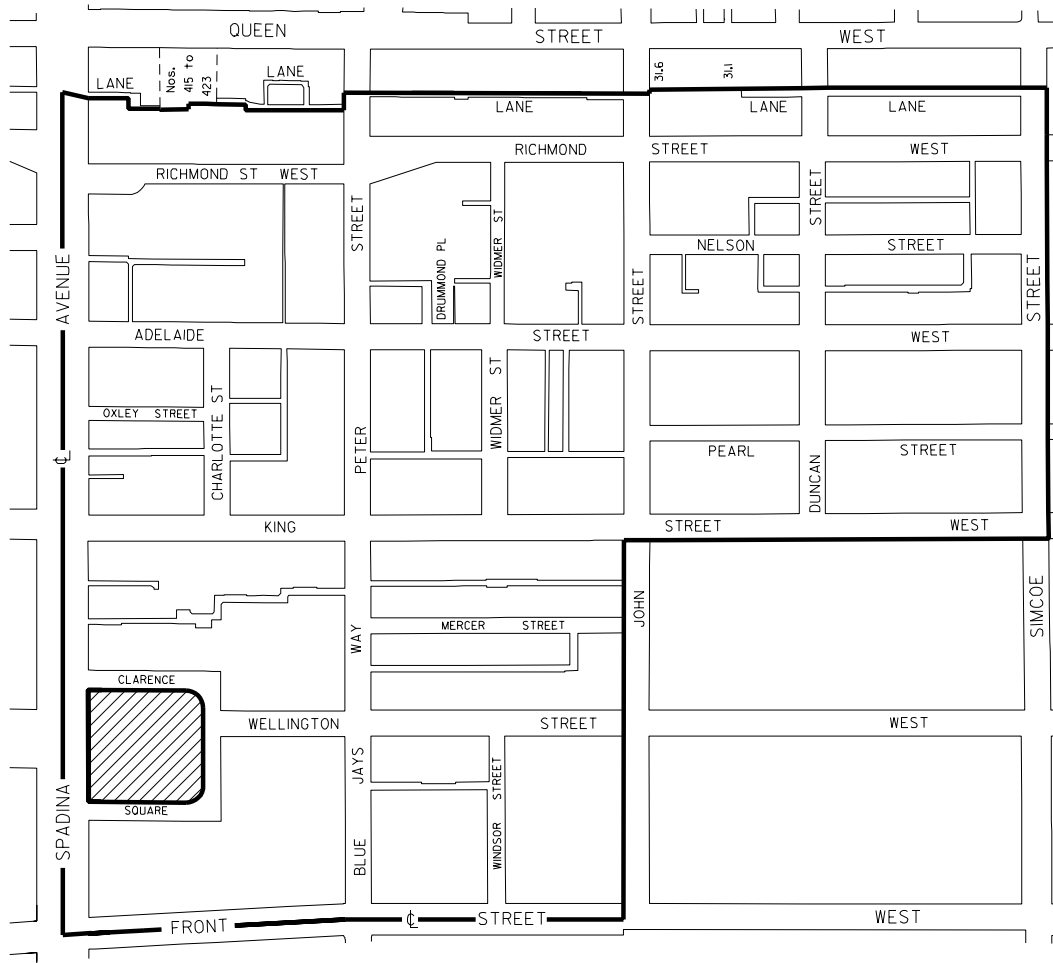

 EXCLUDED LANDS
(CLARENCE SQUARE PARK)

☐ - CENTRE LINE

50 0 50
METRES



SURVEY AND MAPPING SERVICES
TORONTO MAY, 2005
INTOS/BATFRON3.DGN
FILE: 2402.46
MAP No. 50G-322 DRAWN: VG