

CITY OF TORONTO

BY-LAW No. 464-2005(OMB)

To amend former City of Scarborough Zoning By-law No. 15907, as amended, with respect to the Rouge Community By-law.

WHEREAS authority is given to the Ontario Municipal Board by Section 34 of the *Planning Act*, R.S.O. 1990, c.P. 13, as amended, the Ontario Municipal Board orders as follows:

1. **SCHEDULE “A”**, is amended by deleting the current zoning and replacing it with the following zoning, so that the amended zoning shall read as follows on Schedule “1”:

MF – 69 – 133 – 253 – 419 – 456 – 502

2. **SCHEDULE “B”, PERFORMANCE STANDARDS CHART**, as amended, is hereby further amended by adding the following Performance Standards:

INTENSITY OF USE

69. The total number of **dwelling units** shall not exceed 43.

MAIN WALL SETBACKS FROM STREETS

133. Minimum 3.0 meters from the **street lot line** of Tideswell Boulevard.

MAIN WALL SETBACKS FROM LOT LINES OTHER THAN STREET LINES

253. Minimum building **setback** from the north **lot line** and the south **lot line**, not including the south **lot line** abutting Highway #401, 6.8 m.
3. **SCHEDULE “C” Exceptions Map**, is amended by deleting Exception Number 15 from lands shown on Schedule “2” to this By-law and by adding Exception 39 to the lands shown on Schedule “2” to this By-law.
4. **SCHEDULE “C”, EXCEPTIONS LIST**, is amended by incorporating the following Exception 39:
 39. On those lands identified as Exception No. 39 on the accompanying Schedule “2” map, the following provisions shall apply:
 1. The provision of CLAUSE VI, Sub-Clause 2 **FOR SPECIFIC ZONES**, Section (1) **Landscaping**, shall not apply.
 2. Notwithstanding the maximum projections permitted by the definition of **Main Wall** as contained in **CLAUSE II - DEFINITIONS**, **balconies**, unenclosed porches and cellars together with the roof overhang of such structures may project to a maximum distance of 2.0 meters within the required minimum **street yard**.

PURSUANT TO DECISION/ORDER NO. 0028 OF THE ONTARIO MUNICIPAL BOARD
ISSUED ON JANUARY 10, 2005 IN BOARD FILE NO. PL040014.

SCHEDULE "1"

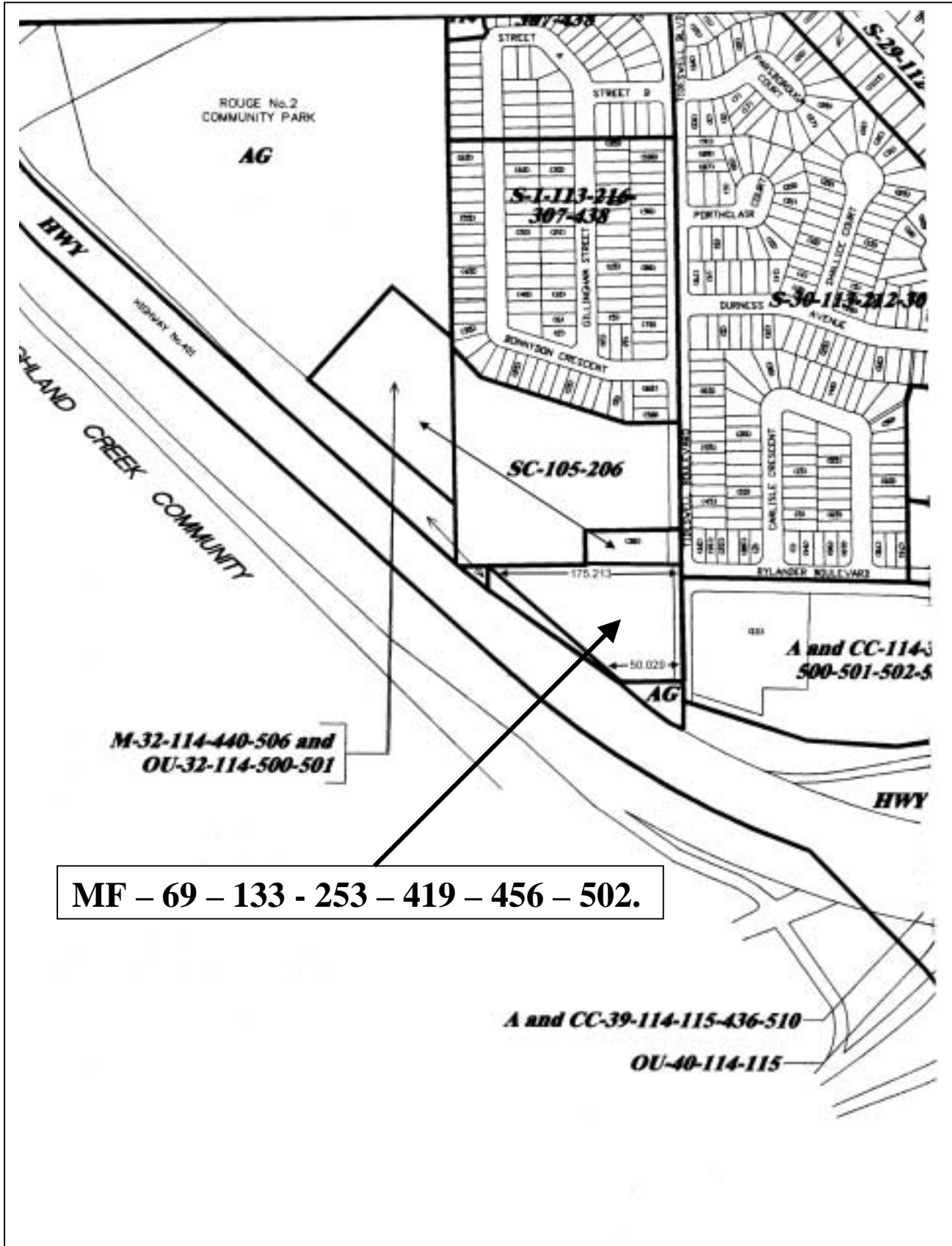

SCHEDULE “2”