

CITY OF TORONTO

BY-LAW No. 1313-2011(OMB)

To adopt Amendment No. 141 to the Official Plan for the City of Toronto with respect to the lands municipally known as 2 True Davidson Drive.

WHEREAS the Ontario Municipal Board pursuant to its Order issued November 9, 2011 deemed it advisable to amend the City of Toronto Official Plan with respect to certain lands municipally known as 2 True Davidson Drive;

THEREFORE the Official Plan for the City of Toronto is hereby amended by the Ontario Municipal Board as follows:

1. Amendment No. 141 of the Official Plan for the City of Toronto consisting of the attached text and map is hereby approved.

PURSUANT TO THE ORDER/DECISION OF THE ONTARIO MUNICIPAL BOARD ISSUED NOVEMBER 9, 2011 UNDER BOARD FILE NO. PL100346.

AMENDMENT NO. 141 TO THE OFFICIAL PLAN
LANDS MUNICIPALLY KNOWN IN THE YEAR 2011
AS 2 TRUE DAVIDSON DRIVE

The Official Plan of the City of Toronto is amended as follows:

1. Land Use Plan Map 17 is amended to redesignate the lands municipally known in the year 2011 as 2 True Davidson Drive from *Parks and Open Space Areas- Natural Areas* to *Neighbourhoods*, as shown on attached Schedule 1.
2. Chapter 7, Site and Area Specific Policies, is amended by adding Site and Area Specific Policy No. 352 for the lands municipally known in the year 2011 as 2 True Davidson Drive as follows:

"352. 2 True Davidson Drive

Development will be setback a minimum of 6-metres from the top-of-bank as detailed in the zoning by-law."

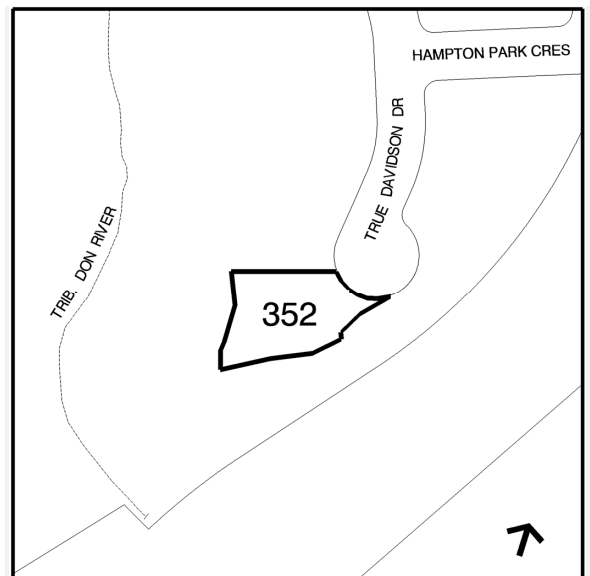

3. Maps 28 and 29, Site and Area Specific Policies, are amended for the lands municipally known in the year 2011 as 2 True Davidson Drive, as shown on the map above as Site and Area Specific Policy No. 352.

SCHEDULE "1"

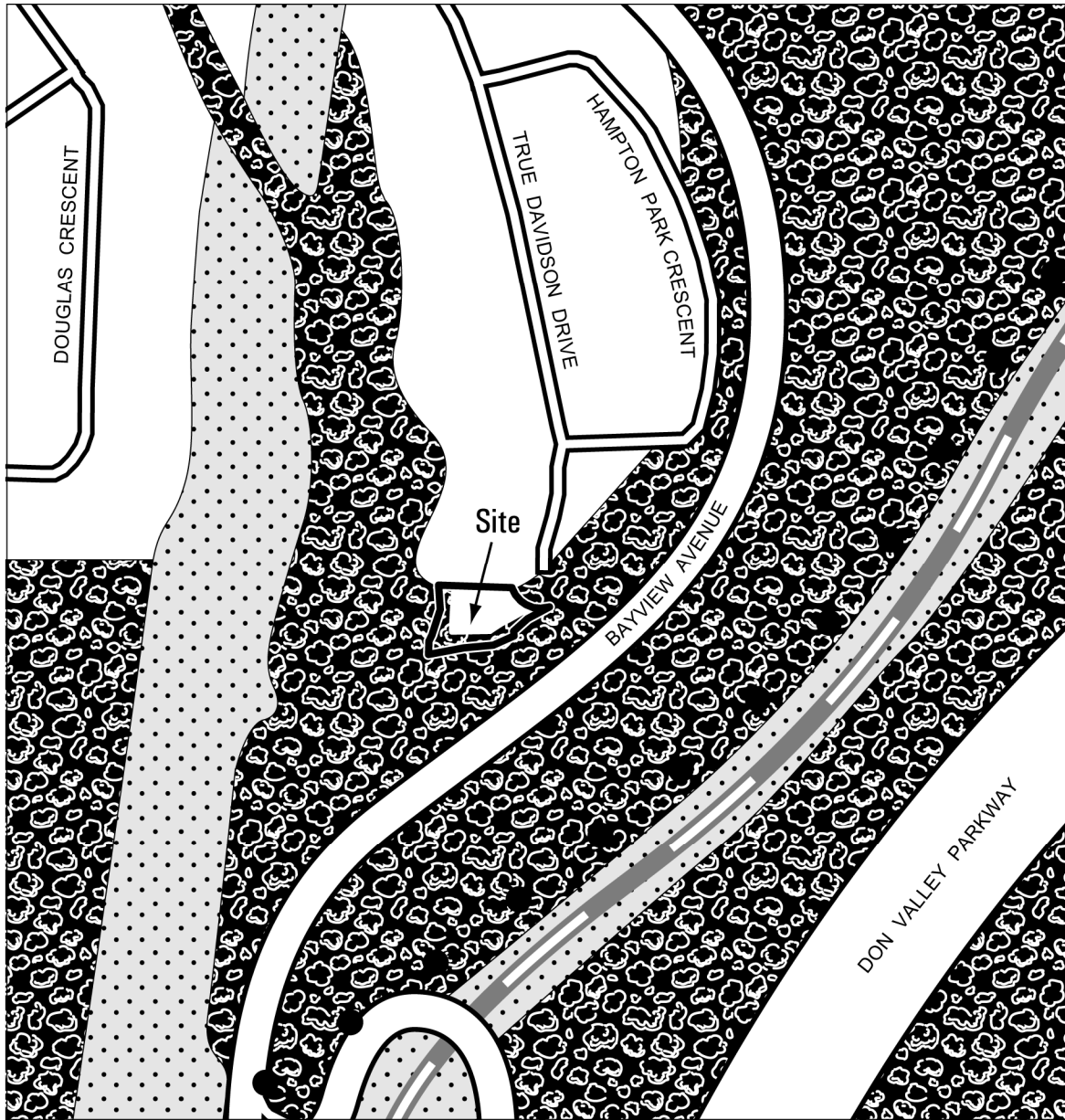

Toronto City Planning

2 True Davidson Drive

Official Plan Amendment #141

Revisions to Land Use Map 17 to Redesignate lands from Natural Areas to Neighbourhoods

File # 05_102723



↑
Not to Scale
06/15/11