

Authority: Etobicoke York Community Council Item 25.17,  
as adopted by City of Toronto Council on July 16, 17, 18 and 19, 2013

**CITY OF TORONTO**

**BY-LAW No. 73-2014**

**To designate the property at 150 Symes Road (Symes Road Incinerator) as being of  
cultural heritage value or interest.**

Whereas the *Ontario Heritage Act* authorizes the Council of a municipality to enact by-laws to designate real property, including all buildings and structures thereon, to be of cultural heritage value or interest; and

Whereas authority was granted by Council to designate the property at 150 Symes Road (Symes Road Incinerator) as being of cultural heritage value or interest; and

Whereas the Council of the City of Toronto caused to be served upon the owners of the land and premises known as 150 Symes Road and upon the Ontario Heritage Trust, Notice of Intention to designate the property and caused the Notice of Intention to be posted on the City's web site for a period of 30 days in accordance with Municipal Code Chapter 162, Notice, Public, Article II, § 162-4.1. Notice requirements under the *Ontario Heritage Act*; and

Whereas no notice of objection was served upon the Clerk of the municipality; and

Whereas the reasons for designation are set out in Schedule "A" to this by-law;

The Council of the City of Toronto enacts:

1. The property at 150 Symes Road, more particularly described in Schedule "B" and shown on Schedule "C" attached to this by-law, is designated as being of cultural heritage value or interest.
2. The City Solicitor is authorized to cause a copy of this by-law to be registered against the property described in Schedule "B" to this by-law in the proper Land Registry Office.
3. The City Clerk is authorized to cause a copy of this by-law to be served upon the owners of the property at 150 Symes Road and upon the Ontario Heritage Trust and to cause notice of this by-law to be posted on the City's web site for a period of 30 days in accordance with Municipal Code Chapter 162, Notice, Public, Article II, § 162-4.1. Notice requirements under the *Ontario Heritage Act*.

Enacted and passed on January 30, 2014.

Frances Nunziata,  
Speaker

Ulli S. Watkiss,  
City Clerk

(Seal of the City)

**SCHEDULE "A"**  
**REASONS FOR DESIGNATION**  
**STATEMENT OF SIGNIFICANCE**

Description

The property at 150 Symes Road is worthy of designation under Part IV, Section 29 of the *Ontario Heritage Act* for its cultural heritage value, and meets the criteria for municipal designation prescribed by the Province of Ontario under the three categories of design, associative and contextual values. Located on the southwest corner of Symes Road and Glen Scarlett Road, the Symes Road Incinerator (1933) is a three-storey public works building.

Statement of Cultural Heritage Value

The Symes Road Incinerator is a well-crafted excellent representative example of a public works building designed with Art Deco features, which is particularly distinguished by its pyramidal massing, banding and linear decoration that are hallmarks of the style. It is part of a collection of civic architecture in the former City of Toronto with Art Deco styling that dates to the early 1930s and includes the landmark Horse Palace at Exhibition Place.

The Office of the City Architect designed the Symes Road Incinerator in collaboration between Chief Architect J. J. Woolnough, his assistant and successor K. S. Gillies, and their chief designer, architect Stanley J. T. Fryer. During the early 1930s, this team produced an impressive series of civic buildings that were characterized and distinguished by Art Deco styling and included the Symes Road Incinerator.

Contextually, the property at 150 Symes Road is historically associated with its surroundings as a notable survivor from the industrial enclave anchored by the former Ontario Stockyards that developed in the early 20<sup>th</sup> century along St. Clair Avenue West, west of Weston Road in West Toronto.

Heritage Attributes

The heritage attributes of the property at 150 Symes Road are:

- The Symes Road incinerator
- The materials, with brick cladding and brick, stone, metal and glass detailing
- The scale, form and massing of the near-square three-storey plan, with the two-storey section set back from and rising above the single-storey podium that is angled at the northeast corner
- The base with window openings, which is raised on the rear (west) elevation with ramps and openings for cargo doors
- The cornices along the rooflines of the first and third stories and, at the east end, the chimney
- On the principal (east) façade, the entrance block where the main entry is asymmetrically placed

- The main (east) entry, which is set in a stone frontispiece where paired doors and a transom are flanked by narrow sidelights and surmounted by a metal canopy, the datestone incised "1933", and linear stone detailing
- The secondary opening at the north end of the east façade
- The fenestration on all elevations, with flat-headed openings and, in the third storey, distinctive round windows
- The Art Deco detailing that includes the distinctive horizontal banding
- The original placement and setback of the Symes Incinerator near the southwest corner of Symes Road and Glen Scarlett Road where it is viewed from both streets

**SCHEDULE "B"**  
**LEGAL DESCRIPTION**

Part of PIN 10515-0536 (LT)

Part of Block A on Plan 2707 designated as PART 2 on Plan 64R-12028 and part of Lot 36 in Concession 3 FTB designated as PART 1 on Plan 63R-4262

City of Toronto (former City of York and City of Toronto) and Province of Ontario  
Land Titles Division of the Toronto Registry Office (No. 66)

The hereinbefore described land being delineated by heavy outline on Sketch No. PS-2013-100 dated October 22, 2013, as set out in Schedule "C".

## SCHEDULE "C"

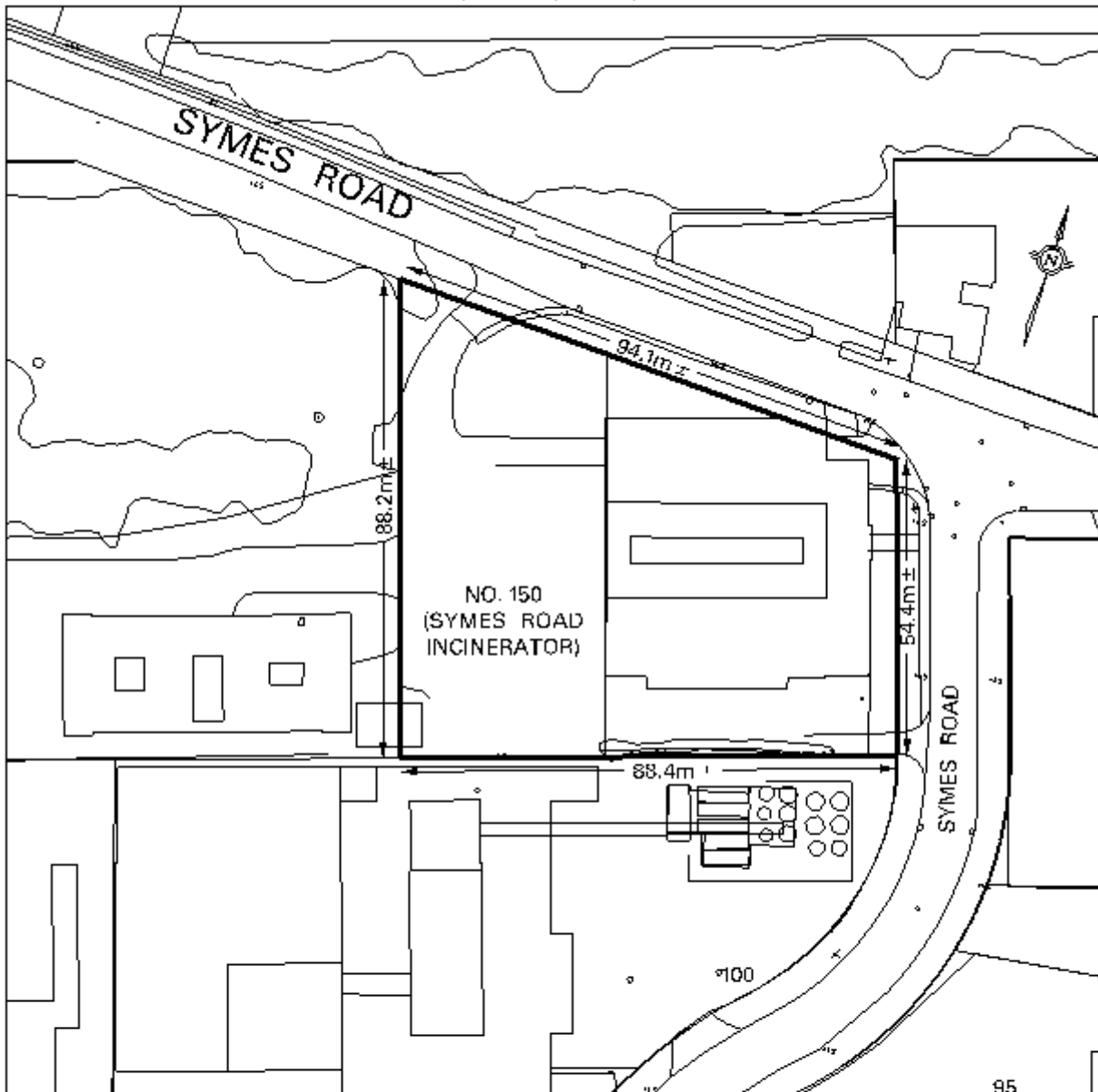
**Toronto**
INCORPORATED 1998, 2010, 2012, 2013, 2014  
 4370-4380 KENNEDY RD.  
 TORONTO, ONTARIO M3J 1K6
NOTE: THIS SKETCH IS NOT  
 A PLAN OF SURVEY  
 AND HAS BEEN COMPILED  
 FROM SURVEY RECORDS AND  
 OFFICE RECORDS. IT SHALL  
 NOT BE USED FOR ANY  
 THE PURPOSE INDICATED  
 IN THE TITLE BLOCK.
C-HERO 30.00M. FOUR  
 PREPARED BY: DWAYNE P.T.

## PROPERTY INFORMATION SHEET

NO. 150 SYMES ROAD (SYMES ROAD INCINERATOR)  
 LAND DESIGNATED AS BEING OF  
 CULTURAL HERITAGE VALUE AND INTEREST

(NOT TO SCALE)

WARD 11 - YORK SOUTH-WESTON  
 DATE: OCTOBER 22 2013

SKETCH No. PS 2013 100