

Authority: North York Community Council Item NY18.1
as adopted by City of Toronto Council on November 13
and 14, 2024
City Council voted in favour of this by-law on
November 14, 2024
Written approval of this by-law was given by Mayoral
Decision 21-2024 dated November 14, 2024

CITY OF TORONTO

BY-LAW 1209-2024

To adopt Amendment 752 to the Official Plan for the City of Toronto respecting the lands known municipally in the year 2023 as 10 Elmwood Avenue.

Whereas authority is given to Council under the Planning Act, R.S.O. 1990, c. P.13, as amended, to pass this By-law; and

Whereas Council of the City of Toronto has provided adequate information to the public and has held at least one public meeting in accordance with the Planning Act;

The Council of the City of Toronto enacts:

1. The attached Amendment 752 to the Official Plan is hereby adopted pursuant to the Planning Act, as amended.

Enacted and passed on November 14, 2024.

Frances Nunziata,
Speaker

John D. Elvidge,
City Clerk

(Seal of the City)

AMENDMENT 752 TO THE OFFICIAL PLAN
LANDS MUNICIPALLY KNOWN IN THE YEAR 2023 AS 10 ELMWOOD AVENUE

The Official Plan of the City of Toronto is amended as follows:

1. Chapter 6, Section 8, North York Centre Secondary Plan is amended by adding the following subsection to Section 12, North York Centre South Site and Area Specific Policies:

'37. 10 Elmwood Avenue

Zero (0) parking spaces shall be required for a building not exceeding 200 square metres of gross floor area and 85 square metres of outdoor patio.'

2. Map 8-12, North York Centre Secondary Plan, North York Centre South Site Specific Policies, is amended to show the lands known municipally in 2023 as 10 Elmwood Avenue as Site and Area Specific Policy Area Number 37, as shown on the attached Schedule 1.

Schedule 1

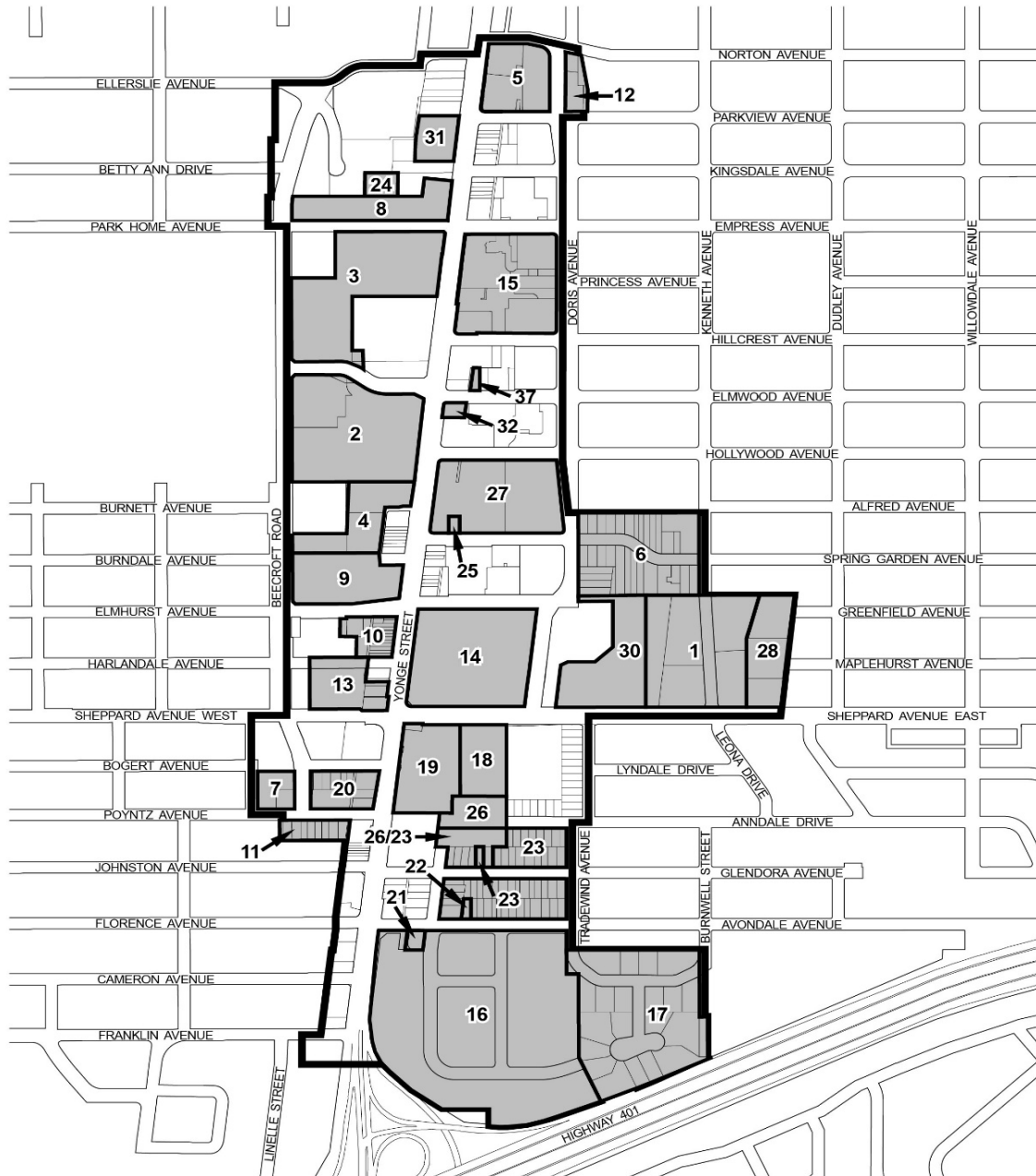

TORONTO Official Plan Amendment #752

North York Centre Secondary Plan

MAP 8-12 North York Centre South Site Specific Policies

-  Secondary Plan Boundary
-  Site Specific Policy Areas*

* The shaded areas on this map are subject to the specific policies set out in the North York Centre Secondary Plan, Section 12.

This map forms part of the Official Plan and should be interpreted in conjunction with the written text.



November 2015