

Authority: Item EY27.6, as adopted by Etobicoke York Community Council on November 26, 2025  
Etobicoke York Community Council voted in favour of this by-law on November 26, 2025

## CITY OF TORONTO

### BY-LAW 1405-2025

**To amend City of Toronto Municipal Code Chapter 950, Traffic and Parking, respecting Augustus Terrace, Edward Horton Crescent and Thomas Fisher Drive and in respect to the designation of Ward 2 (Area 3, Area 4, Area 5, Area 6, Area 7, Area 8, Area 9, Area 10, Area 11, Area 12, Area 13, Area 14, Area 15) and Ward 3 (Area 5) Boundary Area designated area and 30 kilometres per hour for public lanes and roads within the designated area.**

The Etobicoke York Community Council enacts:

1. Municipal Code Chapter 950, Traffic and Parking, is amended as follows:
  - A. By deleting from Schedule XXXV (Speed Limits on Public Highways) in § 950-1334, the following in alphabetical order by street name:

(From Column 1 Highway)	(From Column 2 Between)	(From Column 3 Speed Limit (km/h))
Abilene Drive	Princess Margaret Boulevard and Aylesbury Road	40
Abinger Crescent	Lloyd Manor Road and Princess Margaret Boulevard	40
Ainsley Gardens	Islington Avenue and the west end of Ainsley Gardens	40
Allanhurst Drive	Edenvale Crescent (west intersection) and Edenbridge Drive	40
Alma Drive	Scarlett Road and Penhale Drive	40
Arcade Drive	La Rose Avenue and Chapman Road	40
Ashfield Drive	Gentian Drive and Rangoon Road	40
Ashford Drive	Longfield Road and Princess Margaret Boulevard	40
Ashwood Crescent	Princess Margaret Boulevard and Abilene Drive	40
Aylesbury Road	Twysford Road and Islington Avenue	40

---

(From Column 1 Highway)	(From Column 2 Between)	(From Column 3 Speed Limit (km/h))
Ballantyne Court	Twyford Road and the east end of Ballantyne Court	40
Baskerville Crescent	Rayside Drive and Leavenworth Crescent	40
Beaver Bend Crescent	West Deane Park Drive and the northeast end of Beaver Bend Crescent	40
Beaverbrook Avenue	Ravenscrest Drive and Kipling Avenue	40
Bemersyde Drive	Eglinton Avenue	40
Benbow Road	The Westway and Saskatoon Drive (west intersection)	40
Benedict Road	Princess Anne Crescent (west intersection) and Princess Anne Crescent (east intersection)	40
Bigham Crescent	Elmbrook Crescent (east intersection) and Elmbrook Crescent (west intersection)	40
Birchcroft Road	Rathburn Road and Bywood Drive	40
Blackdown Crescent	Lloyd Manor Road and Farningham Crescent	40
Blair Athol Crescent	Prince George Drive and Abilene Drive	40
Bournemouth Road	Princess Anne Crescent and Bemersyde Drive	40
Bowness Court	Longfield Road and the north end of Bowness Court	40
Braecrest Avenue	Royal York Road and Westona Street	40
Brampton Road	The south end of Brampton Road and Sunvale Drive	40
Bridgewater Road	Wimbleton Road and Lambeth Road	40
Brockmount Court	Longfield Road and the north end of Brockmount Court	40
Brougham Crescent	The Westway and Wincott Drive	40

---

(From Column 1 Highway)	(From Column 2 Between)	(From Column 3 Speed Limit (km/h))
Burkston Place	Ashford Drive and the west end of Burkston Place	40
Burnhamill Place	Old Burnhamthorpe Road and Mill Road	40
Byland Road	Kipling Avenue and Princess Anne Crescent	40
Bywood Drive	Kipling Avenue and Islington Avenue	30
Cedarland Drive	Rathburn Road and Orrell Avenue	40
Celestine Drive	Dixon Road and The Westway	40
Centennial Park Road	Rathburn Road and Centennial Park Gate	40
Centennial Park Road	Centennial Park Gate and the northwest end of Centennial ark Road	30
Chapman Road	Arcade Drive and Royal York Road	40
Chestnut Hills Parkway	Chestnut Hills Crescent and Reigate Road	40
Cheviot Place	Princess Anne Crescent and the northwest end of Cheviot Place	40
Clement Road	Callowhill Drive and Kipling Avenue	40
Cobble Hills	Royal York Road and Ripplewood Road/Lincoln Woods Court	40
Colwood Road	Royal York Road and Edgehill Road	40
Country Club Drive	Royal York Road and Edenbrook Hill	40
Crediton Court	Ashford Drive and the east end of Crediton Court	40
Crendon Drive	Guernsey Drive and Botley Road	40
Darlingbrook Crescent	Royal York Road and Edenbrook Hill	40
Denfield Street	Widdicombe Hill Boulevard and Clement Road	40

---

(From Column 1 Highway)	(From Column 2 Between)	(From Column 3 Speed Limit (km/h))
Dixfield Drive	Wellesworth Drive (north intersection) and Wellesworth Drive (south intersection)	40
Dixington Crescent	Dixon Road (west intersection) and Dixon Road (east intersection)	40
Dunrobin Drive	Ravencrest Drive and Glen Agar Drive	40
Edenbridge Drive	The Kingsway and Scarlett Road	40
Edenbrook Hill	Edenbridge Drive and the north end of Edenbrook Hill	40
Edenvale Crescent	Royal York Road and Allanhurst Drive (east intersection)	40
Elmbrook Crescent	Renforth Drive (north intersection) and Renforth Drive (south intersection)	40
Elmcrest Road	Rathburn Road and Eglinton Avenue West	40
Evesham Court	Ravensbourne Crescent and the north end of Evesham Court	40
Farningham Crescent	Lloyd Manor Road and Ashford Drive (south intersection)	40
Finchley Road	Islington Avenue and Hilldowntree Road	40
Fontenay Court	Allanhurst Drive and Scarlett Road	40
Forfar Court	Bournemouth Road and the west end of Forfar Court	40
Freemont Avenue	Lawrence Avenue West and Lockheed Boulevard	40
Friars Lane	Thorncrest Road (east intersection) and Thorncrest Road (west intersection)	40
Fulford Place	Shadwick Drive and The Westway	40
Garbutt Crescent	Elmbrook Crescent (south intersection) and Elmbrook Crescent (north intersection)	40
Glen Agar Drive	Ravenscrest Drive and Agatha Road	40

---

(From Column 1 Highway)	(From Column 2 Between)	(From Column 3 Speed Limit (km/h))
Golfcrest Road	Islington Avenue and the west end of Golfcrest Road	40
Graywood Drive	Remington Drive and Cedarland Drive	40
Great Oak Drive	Kipling Avenue and Remington Drive (west intersection)	40
Great Oak Drive	Remington Drive (west intersection) and Islington Avenue	40
Greening Crescent	Kipling Avenue and Great Oak Drive	40
Grimsby Court	Orkney Crescent and the south end of Grimsby Court	40
Hagersville Court	Rangoon Road (south intersection) and Rangoon Road (north intersection)	40
Haliburton Avenue	Rathburn Rd and Wingrove Hill	40
Hartfield Road	Royal York Road and Anglesey Boulevard	40
Hartsdale Drive	The Westway and Wincott Drive	40
Hawthorne Road	Kipling Avenue and Marblehead Road	40
Herne Hill	Chestnut Hills Parkway (southwest intersection) and Reigate Road	40
Hillavon Drive	Martin Grove Road and Ravencrest Drive	40
Hilldowntree Road	Islington Avenue and Wimbleton Road	40
Hunthill Court	Ripplewood Road and the north end of Hunthill Road	40
Hunting Ridge	Kipling Avenue and Wincott Drive	40
Ireland Court	Bournemouth Road and the northwest end of Ireland Court	40
Kingsfold Court	Princess Anne Crescent and the northeast end of Kingsfold Court	40
La Rose Avenue	Royal York Road and Scarlett Road	40

---

(From Column 1 Highway)	(From Column 2 Between)	(From Column 3 Speed Limit (km/h))
La Rush Drive	The west end of La Rush Drive and Scarlett Road	40
Lambeth Crescent	Anglesey Boulevard and Lambeth Road	40
Lambeth Road	Anglesey Boulevard and The Kingsway	40
Lavington Drive	Celestine Drive and Martin Grove Road	40
Learmont Drive	Sandwell Drive and Kipling Avenue	40
Leavenworth Crescent	Rayside Drive and Bloor Street West	40
Leggett Avenue	Scarlett Road and the west end of Leggett Avenue	40
Lincoln Woods Court	Ripplewood Road/Cobble Hills and the north end of Lincoln Woods Court	40
Lloyd Manor Road	Rathburn Road and Eglinton Avenue West	40
Lockheed Boulevard	Scarlett Road and Roxaline Street	40
Longfield Road	Kipling Avenue and Lloyd Manor Road	40
Lorraine Gardens	Burnhamthorpe Road and Martin Grove Road	40
Ludstone Drive	Celestine Drive and Lavington Drive	40
Mayland Avenue	Bridgetown Drive and the east end of Mayland Avenue	40
Mill Road	Bloor Street West and Markland Drive (south intersection)	40
Mulham Place	Allanhurst Drive and Lemonwood Drive	40
Norby Crescent	Summitcrest Drive and Sun Row Drive	40
North Drive	Royal York Road and Edenbridge Drive	40
Nottingham Drive	Chestnut Hills Parkway and Dundas Street West	40

---

(From Column 1 Highway)	(From Column 2 Between)	(From Column 3 Speed Limit (km/h))
Old Burnhamthorpe Road	Burnhamthorpe Road (west intersection) and Burnhamthorpe Road (east intersection)	30
Oldham Road	The Kingsway and Bemersyde Drive (north intersection)	40
Orkney Crescent	Princess Margaret Boulevard (west intersection) and Princess Margaret Boulevard (east intersection)	40
Orrell Avenue	Islington Avenue and the west end of Orrell Avenue	40
Palace Arch Drive	Princess Margaret Boulevard and Islington Avenue	40
Perry Crescent	Orrell Crescent and the south end of Perry Crescent	40
Pheasant Lane	The west end of Pheasant Lane and Rathburn Road	40
Pippin Place	Great Oak Drive and the west end of Pippin Place	40
Plumbstead Court	Sir Williams Lane and the east end of Plumbstead Court	40
Poplar Heights Drive	Islington Avenue and Eden Valley Drive (north intersection)	40
Poynter Drive	Wincott Drive and Fenley Drive (east intersection)	40
Prince George Drive	Kipling Avenue and Palace Arch Drive	40
Princess Anne Crescent	Bournemouth Road (east intersection) and Prince George Drive	40
Princess Of Wales Court	Tromley Drive and the east end of Princess of Wales Court	40
Rangoon Road	Eringate Drive and Ashfield Drive	40

---

(From Column 1 Highway)	(From Column 2 Between)	(From Column 3 Speed Limit (km/h))
Ravensbourne Crescent	Princess Anne Crescent (north intersection) and Princess Anne Crescent (south intersection)	40
Ravenscrest Drive	Dunrobin Drive and Agatha Drive	40
Raymore Drive	Scarlett Road and the east end of Raymore Drive	40
Remington Drive	Rathburn Road and Bywood Drive	40
Renault Crescent	Royal York Road and Chapman Road	40
Richdale Court	Longfield Road and the north end of Richdale Court	40
Richland Crescent	Entire length	40
Ripplewood Road	Edenbrook Hill and Cobble Hills/Lincoln Woods Court	40
Riverbank Drive	Dundas Street West and Islington Avenue	40
Riverlea Drive	Scarlett Road and Westona Street	40
Robin Hood Road	Chestnut Hills Parkway and Wimbleton Road	40
Rockingham Drive	Remington Drive and Rathburn Road	40
Romney Road	Royal York Road and Edgevalley Drive	40
Rosburn Drive	Sealcove Drive and Mayland Avenue	40
Roxaline Street	Lockheed Boulevard and Lawrence Avenue West	40
Saskatoon Drive	The Westway and Winnipeg Road	40
Saturn Road	The south end of Saturn Road and Burnhamthorpe Road	40
Shadowbrook Drive	Rathburn Road and Beaverbrook Avenue	40
Sir Williams Lane	Abilene Drive and Thorncrest Road (east intersection)	40

---

(From Column 1 Highway)	(From Column 2 Between)	(From Column 3 Speed Limit (km/h))
Stanthorpe Court	Longfield Road and the south end of Stanthorpe Court	40
Stapleton Drive	Northcrest Drive and Epping Street	40
Stoneham Road	Mill Road and Old Burnhamthorpe Road	40
Streatham Place	Winterton Drive and the south end of Streatham Place	40
Sun Row Drive	Summitcrest Drive and Saskatoon Drive	40
Tallon Road	Trehorne Drive and Sun Row Drive	40
Tettenhall Road	Princess Anne Crescent and Bemersyde Drive	40
The Wynd	Thorncrest Road and Rathburn Road	40
Thicket Road	Stoneglenn Drive and Arbroath Crescent (southeast intersection)	40
Thornbury Crescent	Aylesbury Road and Thorncrest Road	40
Thorncrest Road	Kipling Avenue and Islington Avenue	40
Tilden Crescent	Scarlett Road and Raymore Drive	40
Toledo Road	Renforth Drive and Mill Road	40
Torrington Drive	Renforth Drive and Wellesworth Drive	40
Totteridge Road	Prince George Drive and Abilene Drive	40
Trehorne Drive	A point 32 metres north of Tallon Road and Royal York Road	40
Tromley Drive	Winterton Drive and Lloyd Manor Road	40
Twyford Court	Princess Anne Crescent and the northeast end of Twyford Court	40
Ulverston Road	Crendon Drive and Wareside Road	40
Valecrest Drive	Edenbridge Drive and Valecrest Drive	40
Wainwright Drive	Rathburn Road and Great Oak Drive	40

(From Column 1 Highway)	(From Column 2 Between)	(From Column 3 Speed Limit (km/h))
Warbeck Place	Nugent Road (east intersection) and Nugent Road (west intersection)	40
Warrender Avenue	Lloyd Manor Road and Longfield Road	40
Waterford Drive	Wincott Drive and Holgate Street	40
Wellesworth Drive	The West Mall and Inverdon Road	40
West Deane Park Drive	The East Mall and Archerhill Drive (west intersection)	40
Westmount Park Road	Royal York Road and Munhall Road	40
Westona Street	Lawrence Avenue West and Yorkleigh Avenue	40
Westridge Road	Royal York Road and Edgehill Road	40
Westroyal Road	The Westway and Saskatoon Drive	40
Wimbleton Road	Dundas Street West and The Kingsway	40
Wincott Drive	Eglinton Avenue West and Nugent Road	40
Winesap Place	Bywood Drive and the north end of Winesap Place	40
Wingrove Hill	Haliburton Avenue and Kipling Avenue	40
Winterbourne Court	Bournemouth Road and the northwest end of Winterbourne Court	40
Winterton Drive	Martin Grove Road and Lloyd Manor Road	40
Woodcrest Drive	North Drive and Allanhurst Drive	40
Woodmere Court	Edenbrook Hill and the west end of Woodmere Court	40
Yorkleigh Avenue	Scarlett Road and Royal York Road	40

- B. By inserting in Schedule XXXV (Speed Limits on Public Highways) in § 950-1334, the following in alphabetical order by street name:

(In Column 1 Highway)	(In Column 2 Between)	(In Column 3 Speed Limit (km/h))
Hunting Ridge	Widdicombe Hill and Wincott Drive	40
Lloyd Manor Road	Eglinton Avenue West and Princess Margaret Boulevard	40
Rangoon Road	Eringate Drive and Wellesworth Drive	40
Wellesworth Drive	The West Mall and Rangoon Road	40
Wincott Drive	Eglinton Avenue West and The Westway	40

- C. By deleting from Schedule XLV (Part 1): Designated Areas – Reduced Speed Areas in § 950-1344, the following in alphabetical order by designated area name:

(From Column 1 Designated Area Name)	(From Column 2 East Limit/West Limit of Designated Area)	(From Column 3 North Limit/South Limit of Designated Area)	(From Column 4 Excluded Highways or Bridges)	(From Column 5 Speed (km/h))	(From Column 6 Designated Area Map)
(Area 5) in Ward 3	West side of Islington Avenue / east side of Kipling Avenue	South side of Bloor Street West / north side of The Queensway	Augustus Terrace between Edward Horton Crescent and Thomas Fisher Drive Edward Horton Crescent between Thomas Fisher Drive and (north) and Thomas Fisher Drive (south) Thomas Fisher Drive between Norseman Street and Islington Avenue	30	(Area 5) in Ward 3

## City of Toronto By-law 1405-2025

D. By inserting in Schedule XLV (Part 1): Designated Areas – Reduced Speed Areas in § 950-1344, the following in alphabetical order by designated area name

(In Column 1 Designated Area Name)	(In Column 2 East Limit/West Limit of Designated Area)	(In Column 3 North Limit/South Limit of Designated Area)	(In Column 4 Excluded Highways or Bridges)	(In Column 5 Speed (km/h))	(In Column 6 Designated Area Map)
(Area 3) in Ward 2	West Side of Kipling Avenue and East Side of Martin Grove Road	North Side of Burnhamthorpe Road and South of Rathburn Road		30	(Area 3) in Ward 2
(Area 4) in Ward 2	West side of Islington Avenue and east side of Kipling Avenue	South side of Eglinton Avenue West and north side of Mimico Creek	Princess Margaret Boulevard between Kipling Avenue and Islington Avenue Rathburn Road between Kipling Avenue and Islington Avenue The Kingsway between Kipling Avenue and Islington Avenue Dundas Street West between Islington Avenue and Mimico Creek	30	(Area 4) in Ward 2

## City of Toronto By-law 1405-2025

(In Column 1 Designated Area Name)	(In Column 2 East Limit/West Limit of Designated Area)	(In Column 3 North Limit/South Limit of Designated Area)	(In Column 4 Excluded Highways or Bridges)	(In Column 5 Speed (km/h))	(In Column 6 Designated Area Map)
(Area 5) in Ward 2	West side of Highway 427 and east side of Etobicoke Creek	South side of Bloor Street West and north side of Dundas Street West; Dundas Street West between Etobicoke Creek and Highway 427; Etobicoke Creek between Bloor Street West and Dundas Street West	Neilson Drive between Dundas Street West and Bloor Street West  The West Mall between Dundas Street West and Bloor Street West	30	(Area 5) in Ward 2

## City of Toronto By-law 1405-2025

(In Column 1 Designated Area Name)	(In Column 2 East Limit/West Limit of Designated Area)	(In Column 3 North Limit/South Limit of Designated Area)	(In Column 4 Excluded Highways or Bridges)	(In Column 5 Speed (km/h))	(In Column 6 Designated Area Map)
(Area 6) in Ward 2	West side of Highway 427 and east side of Etobicoke Creek	South side of Burnhamthorpe Road and north side of Bloor Street West	Eva Road between The West Mall and Highway 427 Ramp Mill Road between Burnhamthorpe Road and Bloor Street West Renforth Drive between Bloor Street West and Burnhamthorpe Road The West Mall between Burnhamthorpe Road and Bloor Street West Silver Shadow Path between Burnhamthorpe Road (west intersection) and Burnhamthorpe Road (east intersection)	30	(Area 6) in Ward 2

---

(Area 7) in Ward 2	West side of Highway 427 and east side of Etobicoke Creek	South side of Rathburn Road between Highway 427 and a point 57 metres west of Mill Road and north side of Burnhamthorpe Road	<p>Applewood Lane between Holiday Drive and its entirety</p> <p>Donegal Path between Permfield Path (west intersection) and Permfield Path (east intersection)</p> <p>Holiday Drive between The West Mall and Highway 427 Ramp</p> <p>Mill Road between Burnhamthorpe Road and Rathburn Road</p> <p>Permfield Path between Holiday Drive and its entirety</p> <p>Raintree Path between Mill Road (north intersection) and Mill Road (south intersection)</p> <p>Redstone Path between Mill Road (north intersection) and Mill Road (south intersection)</p> <p>Renforth Drive between Burnhamthorpe Road and Rathburn Road</p> <p>The West Mall between Burnhamthorpe Road and Rathburn Road</p>	30	(Area 7) in Ward 2
-----------------------	---	---	--	----	-----------------------

(In Column 1 Designated Area Name)	(In Column 2 East Limit/West Limit of Designated Area)	(In Column 3 North Limit/South Limit of Designated Area)	(In Column 4 Excluded Highways or Bridges)	(In Column 5 Speed (km/h))	(In Column 6 Designated Area Map)
(Area 8) in Ward 2	West side of Humber River between Eglinton Avenue West and Dundas Avenue Street  West and east side of Royal York Road	South side of Eglinton Avenue West and north side of Dundas Street West	Edenbridge Drive between Royal York Road and Scarlett Road  Scarlett Road between Eglinton Avenue West and Humber River  Brin Drive between Ackley Heights (north intersection) and Ackley Heights (south intersection)	30	(Area 8) in Ward 2
(Area 9) in Ward 2	West side of Royal York Road and east side of Islington Avenue	South side of Eglinton Avenue West and north side of Dundas Street West	Anglesey Boulevard between Islington Avenue and Royal York Road  Ashley Road between Royal York Road and The Kingsway  The Kingsway between Dundas Street West and Islington Avenue	30	(Area 9) in Ward 2

## City of Toronto By-law 1405-2025

(In Column 1 Designated Area Name)	(In Column 2 East Limit/West Limit of Designated Area)	(In Column 3 North Limit/South Limit of Designated Area)	(In Column 4 Excluded Highways or Bridges)	(In Column 5 Speed (km/h))	(In Column 6 Designated Area Map)
(Area 10) in Ward 2	West side of Kipling Avenue and east side of Martin Grove Road	South side of Eglinton Avenue West and north side of Rathburn Road	Princess Margaret Boulevard between Kipling Avenue and Martin Grove Road  Lloyd Manor Road between Eglinton Avenue West and Princess Margaret Boulevard	30	(Area 10) in Ward 2

## City of Toronto By-law 1405-2025

(In Column 1 Designated Area Name)	(In Column 2 East Limit/West Limit of Designated Area)	(In Column 3 North Limit/South Limit of Designated Area)	(In Column 4 Excluded Highways or Bridges)	(In Column 5 Speed (km/h))	(In Column 6 Designated Area Map)
(Area 11) in Ward 2	West side of Martin Grove Road and east side of Etobicoke Creek	South side of Highway 427; Eglinton Avenue West between Etobicoke Creek and Renforth Drive; Eglinton Avenue West between Highway 427 and Martin Grove Road and North side of Rathburn Road between Centennial Park Boulevard and Martin Grove Road	Centennial Park Boulevard between Rathburn Road and Eglinton Avenue West Eringate Drive between Renforth Drive and Highway 427 Ramp Gentian Drive between Wellesworth Drive and Renforth Drive The East Mall between Eglinton Avenue West and Rathburn Road Ramage Lane between Wellesworth Drive and Renforth Drive The West Mall between Rathburn Road and Wellesworth Drive Wellesworth Drive between The West Mall and Rangoon Road Rangoon Road between Wellesworth Drive and Eringate Drive	30	(Area 11) in Ward 2

## City of Toronto By-law 1405-2025

(In Column 1 Designated Area Name)	(In Column 2 East Limit/West Limit of Designated Area)	(In Column 3 North Limit/South Limit of Designated Area)	(In Column 4 Excluded Highways or Bridges)	(In Column 5 Speed (km/h))	(In Column 6 Designated Area Map)
(Area 12) in Ward 2	West side of Kipling Avenue and east side of Martin Grove Road	South side of Dixon Road and north side of Eglinton Avenue West	The Westway between Martin Grove Road and Kipling Avenue Widdicombe Hill Boulevard between Eglinton Avenue West and Kipling Avenue	30	(Area 12) in Ward 2
(Area 13) in Ward 2	West side of Islington Avenue and east side of Kipling Avenue	South side of Dixon Road and north side of Eglinton Avenue West	Wincott Drive between The Westway and Eglinton Avenue West Hunting Ridge between Widdicombe Hill and Wincott Drive Widdicombe Hill between Hunting Ridge and Kipling Avenue	30	(Area 13) in Ward 2
(Area 14) in Ward 2	West side of Royal York Road and east side of Islington Avenue	South side of Dixon Road and north side of Eglinton Avenue West	Summitcrest Drive between Islington Avenue and Royal York Road Tamarack Circle between Dixon Road and the end of Tamarack Circle The Westway between Islington Avenue and Royal York Road	30	(Area 14) in Ward 2

## City of Toronto By-law 1405-2025

---

(In Column 1 Designated Area Name)	(In Column 2 East Limit/West Limit of Designated Area)	(In Column 3 North Limit/South Limit of Designated Area)	(In Column 4 Excluded Highways or Bridges)	(In Column 5 Speed (km/h))	(In Column 6 Designated Area Map)
(Area 15) in Ward 02	West side of Humber River and east side of Royal York Road	South side of Dixon Road between Royal York Road and Scarlett Road; a point 143 metres east of Dixon Road and Scarlett Road and north side of Eglinton Avenue West between Humber River and Royal York Road	La Rose Avenue between Royal York Road and Scarlett Road  Lawrence Avenue West between Royal York Road and Humber River	30	(Area 15) in Ward 02

---

(Area 5) in Ward 03	West side of Islington Avenue / east side of Kipling Avenue	City of Toronto By-law 1405-2025 South side of Bloor Street West / north side of The Queensway	Fieldway Road between Green Lanes and Munster Avenue  Green Lanes between Fieldway Road and Bloor Street West  Munster Avenue between Kipling Avenue and Shawbridge Avenue  Bering Avenue between Shawbridge Avenue and Islington Avenue  Olivewood Road between Kipling Avenue and Shawbridge Avenue  Shawbridge Avenue between Munster Avenue and Advance Road  Advance Road between Kipling Avenue and Islington Avenue  Norseman Street between Kipling Avenue and Islington Avenue  Titan Road between Goodrich Road and Islington Avenue  Goodrich Road between Titan Road and Jutland Road	30	(Area 5) in Ward 03

## City of Toronto By-law 1405-2025

(In Column 1 Designated Area Name)	(In Column 2 East Limit/West Limit of Designated Area)	(In Column 3 North Limit/South Limit of Designated Area)	(In Column 4 Excluded Highways or Bridges)	(In Column 5 Speed (km/h))	(In Column 6 Designated Area Map)
			Jutland Road between Kipling Avenue and Islington Avenue  Dundas Street West between Bloor Street West and Kipling Avenue		

- E. By inserting in Schedule XLV (Part 2): Designated Areas – Maps in § 950-1344, the following maps in Appendix A to this by-law in alphabetical order by designated area map.

Enacted and passed on November 29, 2025.

Stephen Holyday,  
Chair

John D. Elvidge,  
City Clerk

(Seal of the City)

**Appendix A**

2. Inset the following into Schedule XLV (Part 2) in § 950-1344 as follows:

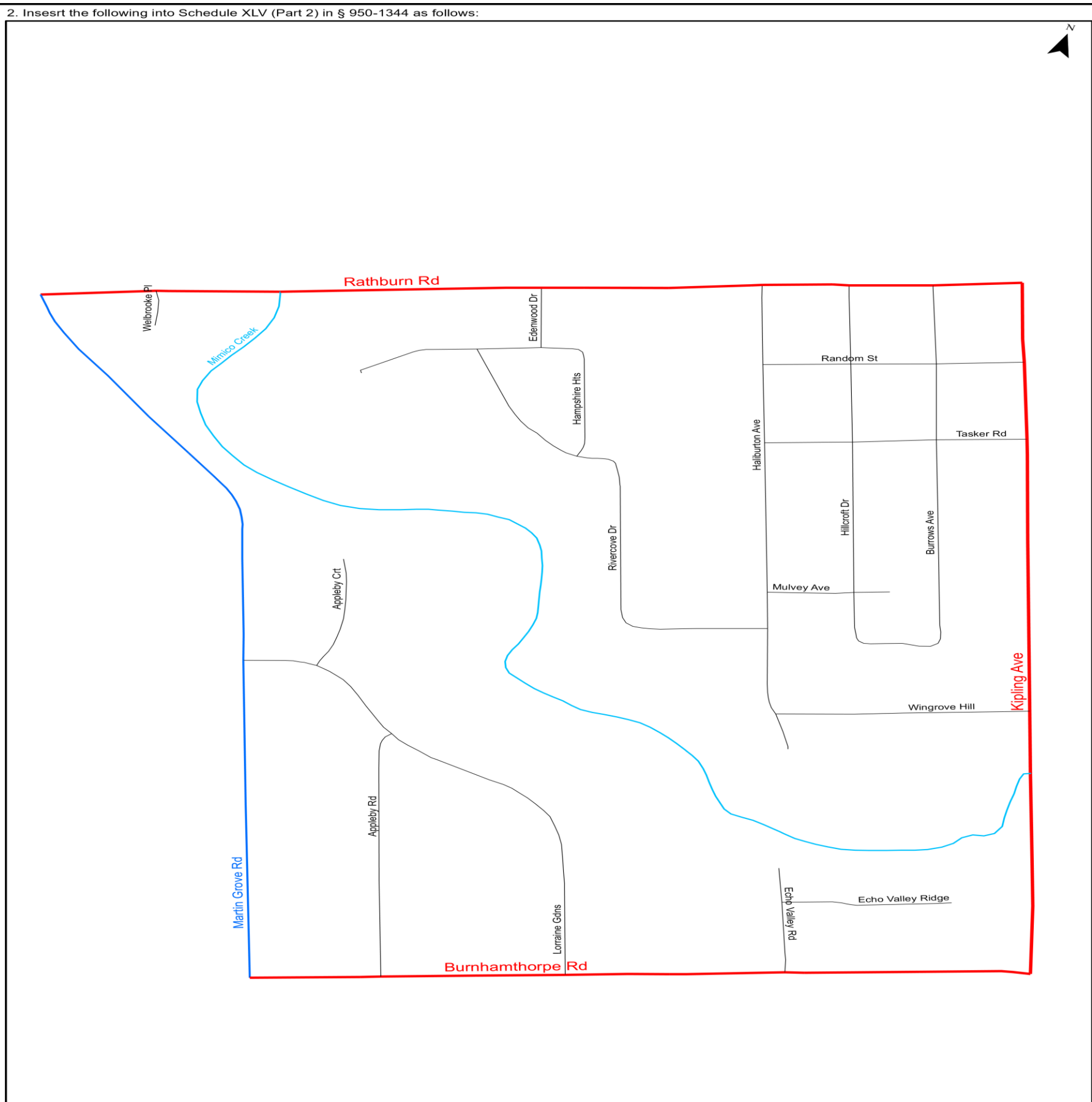

**Local Road Speed Limit Reduction  
 (Area 3) in Ward 2**

**Legend**

- Major Arterial; Minor Arterial
- Collector
- Local; Laneway
- River

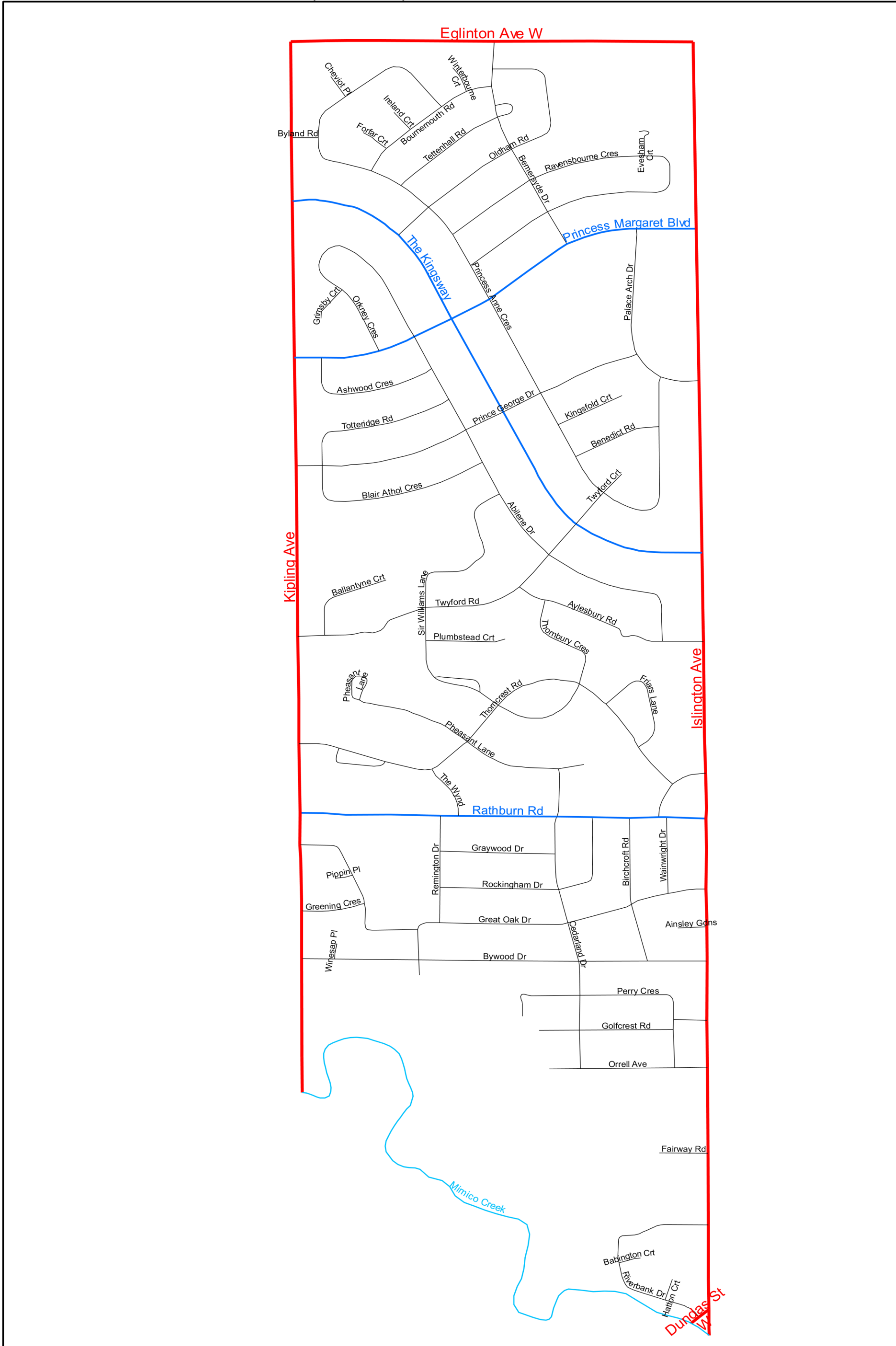

**Legend**

- Major Arterial; Minor Arterial
- Collector
- Local; Laneway
- River

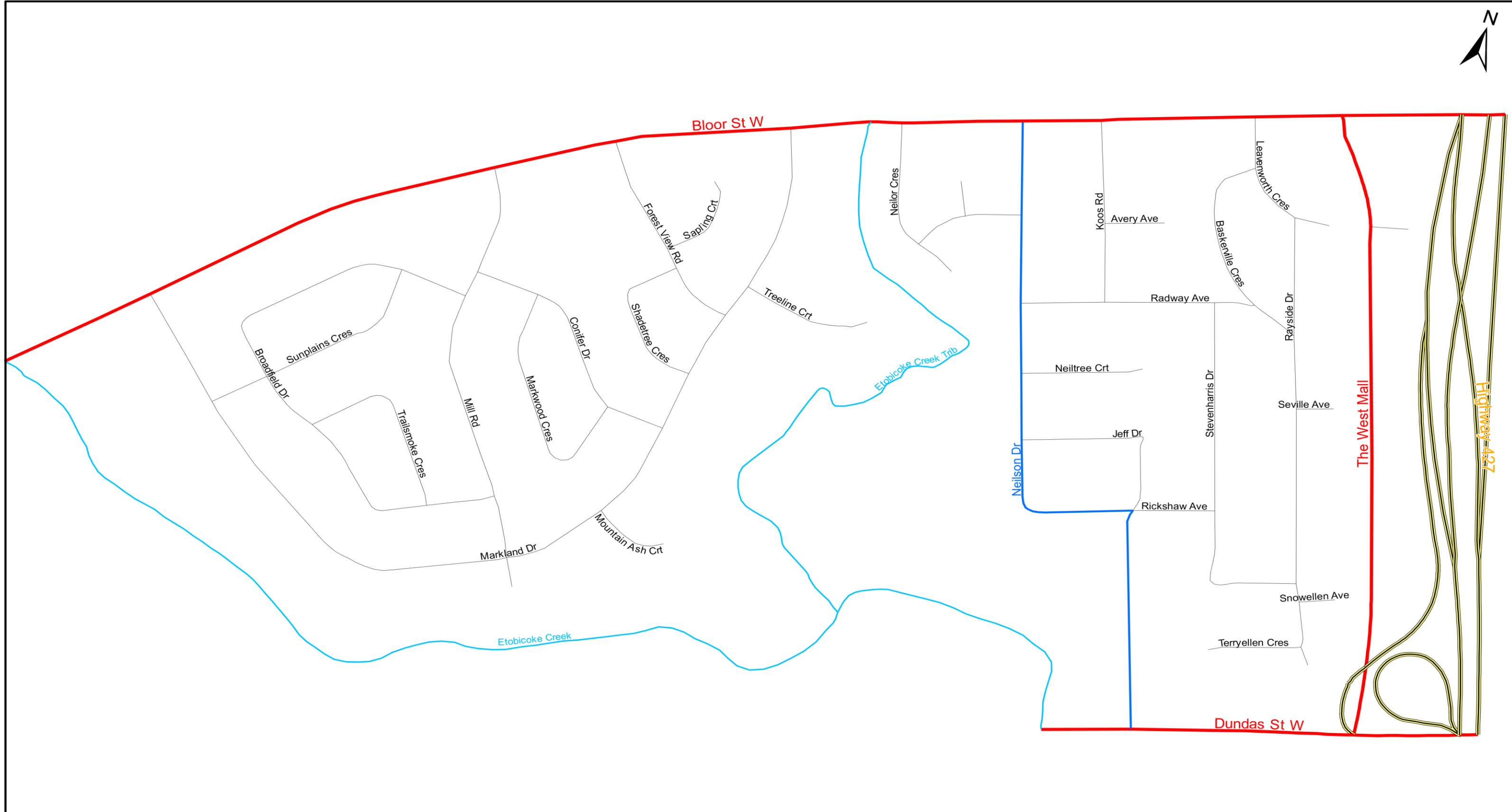

**Legend**

-  Expressway
-  Collector
-  River
-  Major Arterial; Minor Arterial
-  Local; Laneway

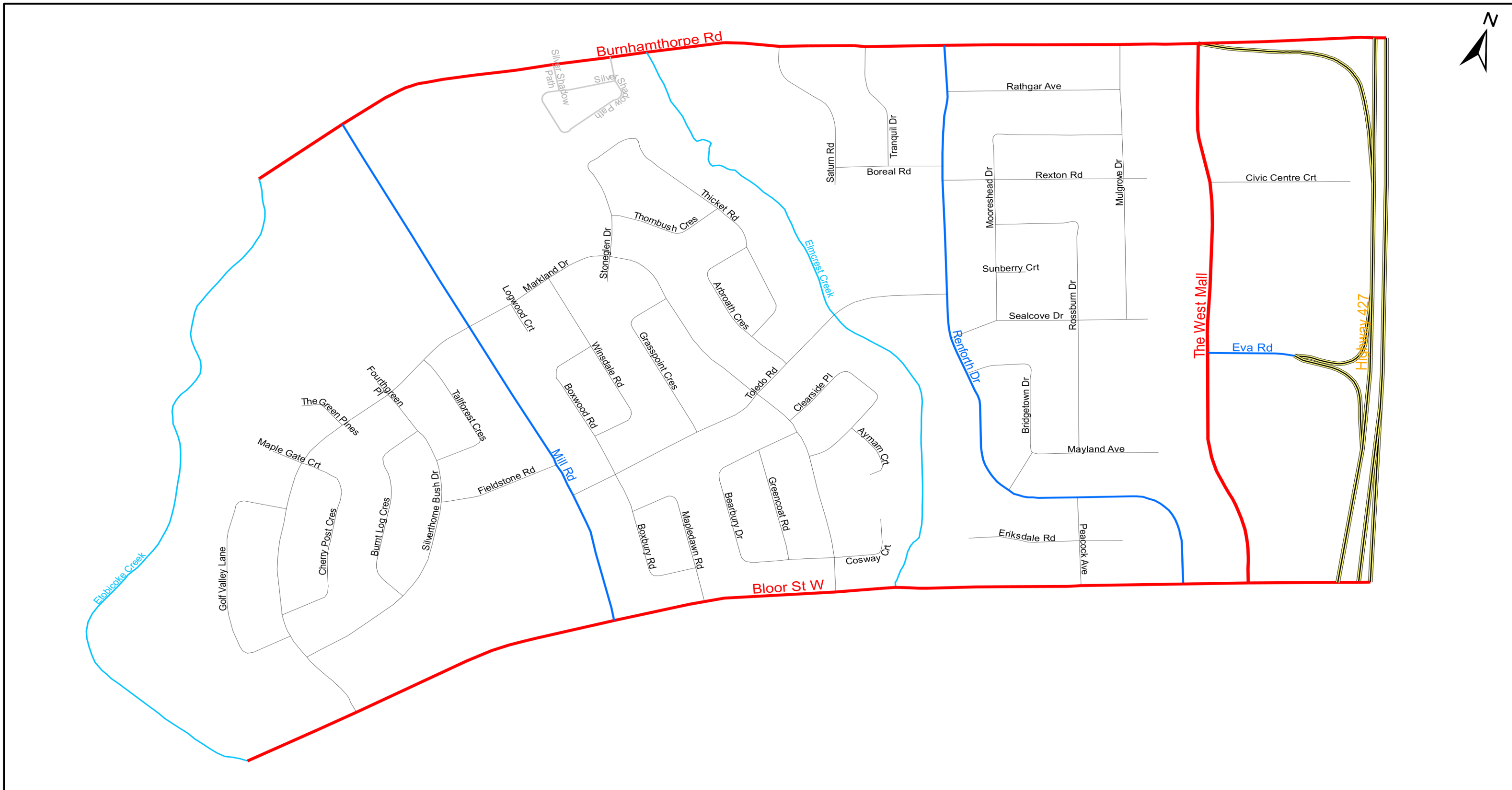

**Legend**

-  Expressway
-  Collector
-  Other; Pending
-  Major Arterial; Minor Arterial
-  Local; Laneway
-  River

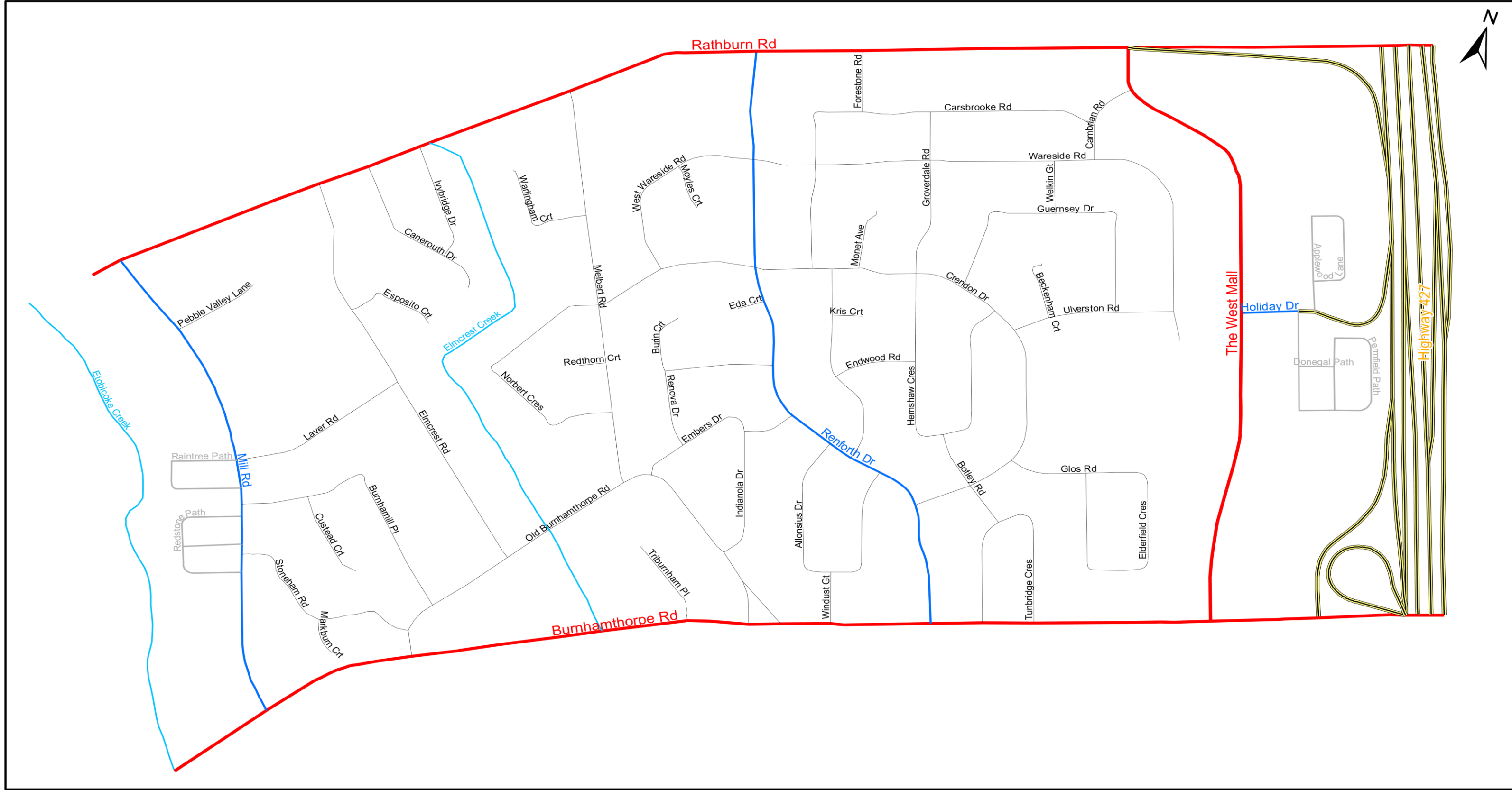

**Legend**

- Expressway; Expressway Ramp
- Collector
- Pending; Other
- Major Arterial; Minor Arterial
- Local; Laneway
- River

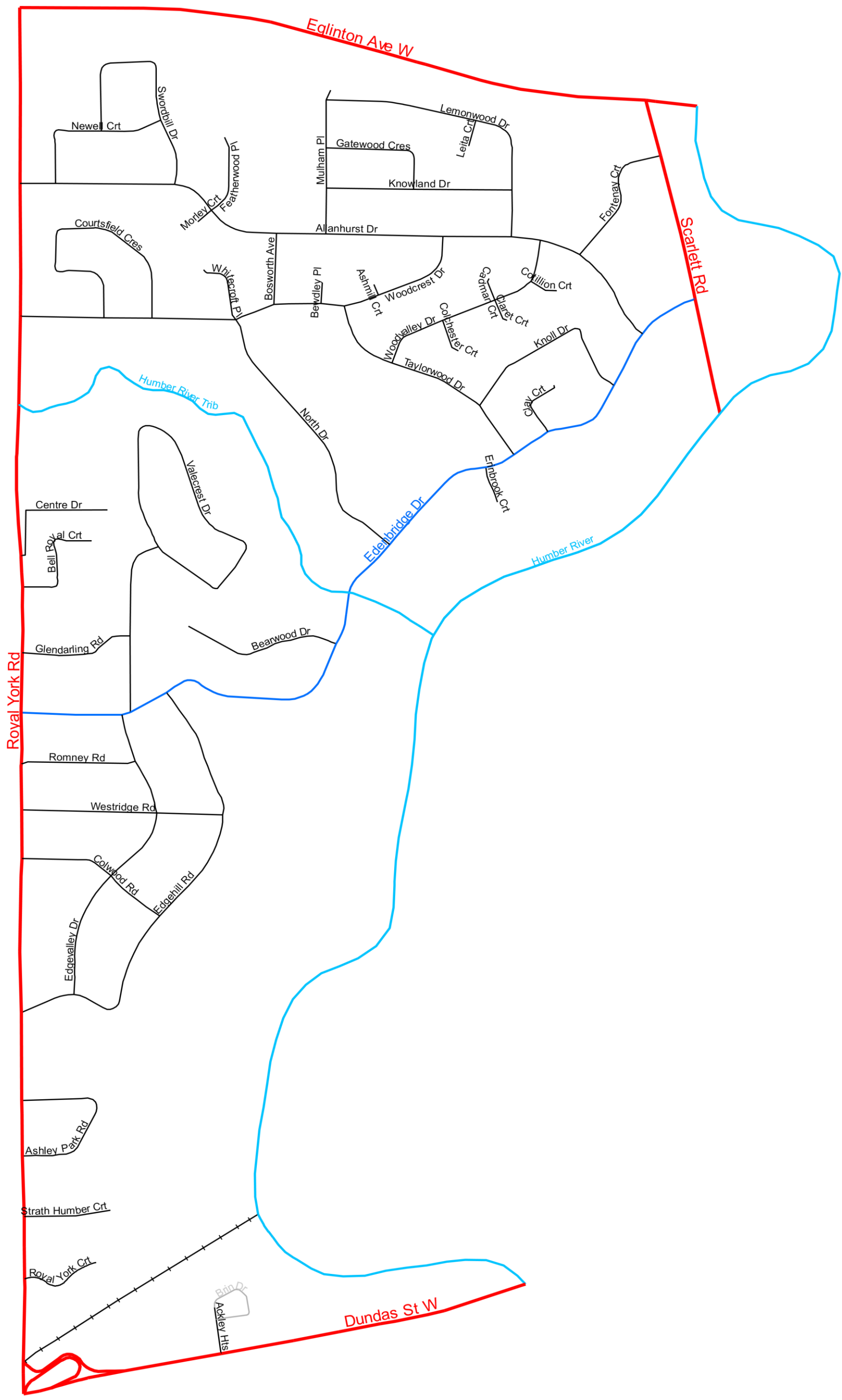



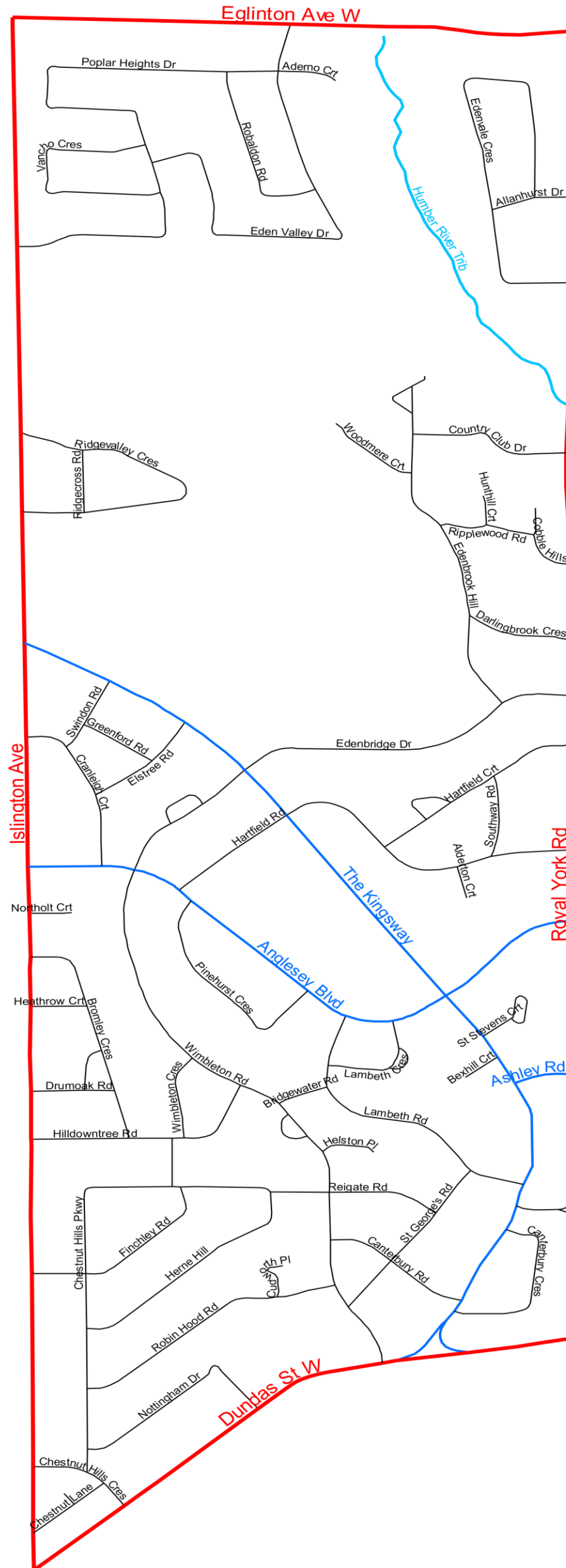

**Legend**

- Major Arterial; Minor Arterial
- Collector
- Local; Laneway
- Pending
- River
- + + Major Railway



**Legend**

-  Major Arterial; Minor Arterial
-  Local; Laneway
-  Collector
-  River

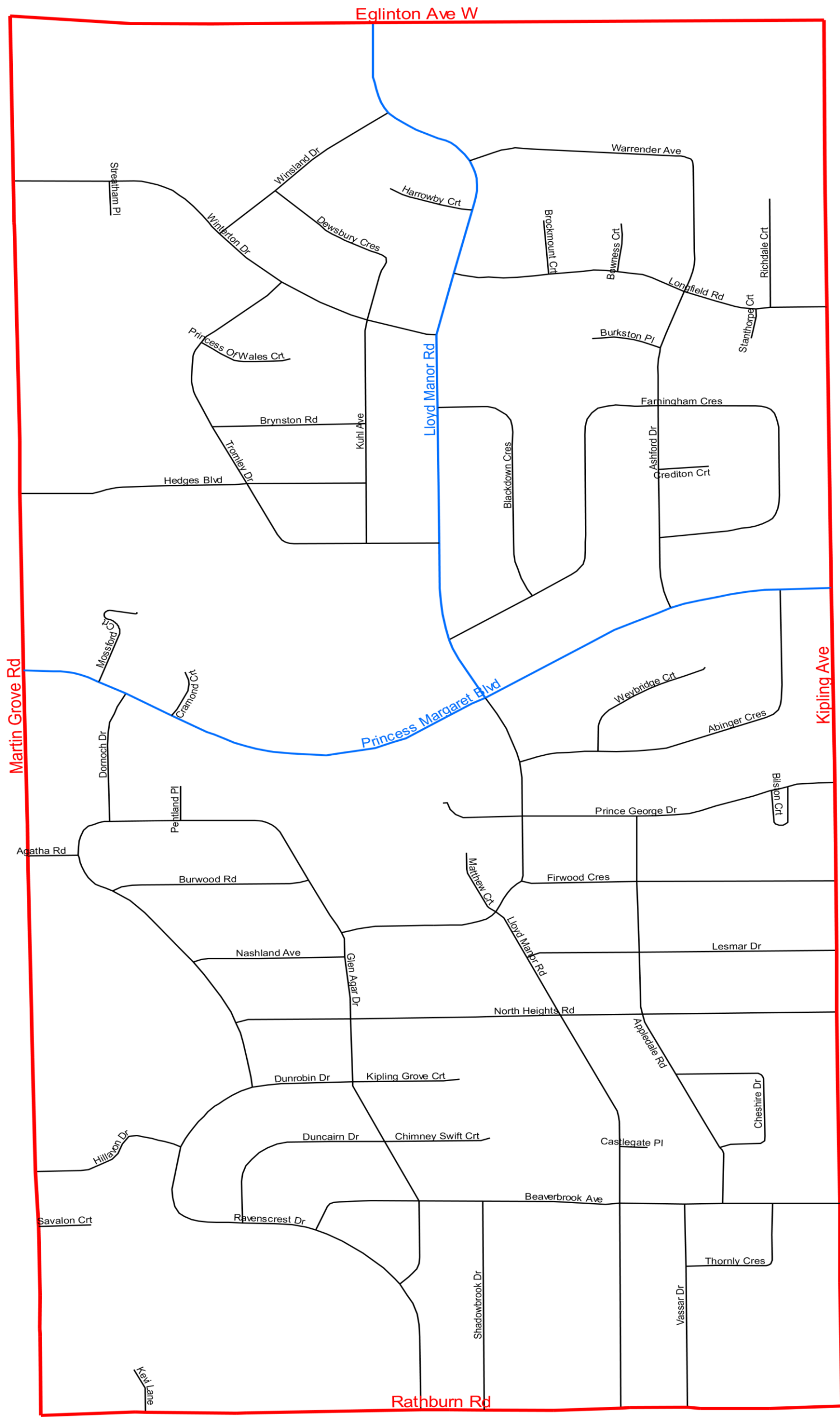

**Legend**

- Major Arterial; Minor Arterial
- Collector
- Pending; Other

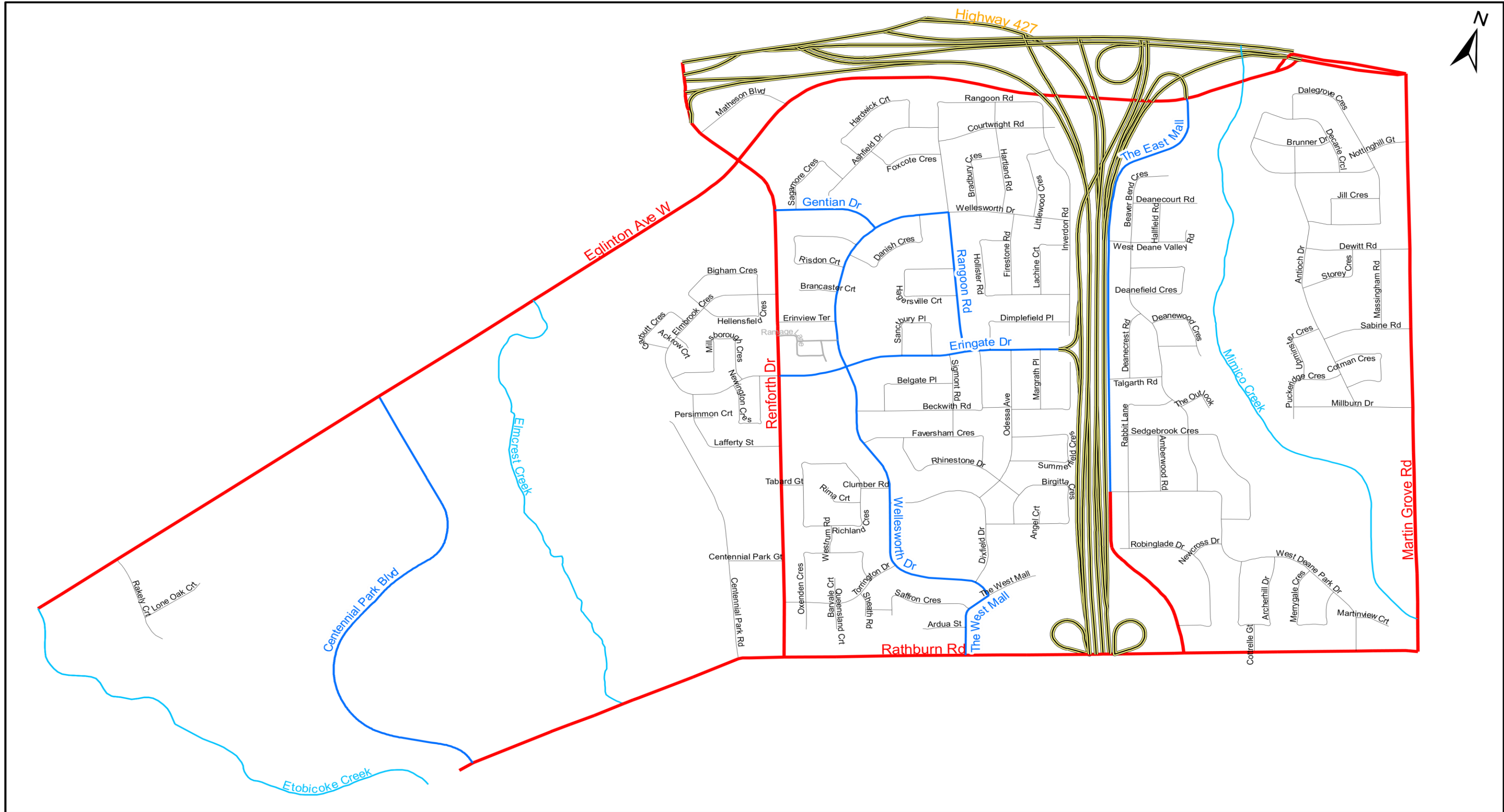

**Legend**

- Expressway
- Major Arterial; Minor Arterial
- Collector
- Local; Laneway
- Pending; Other
- River

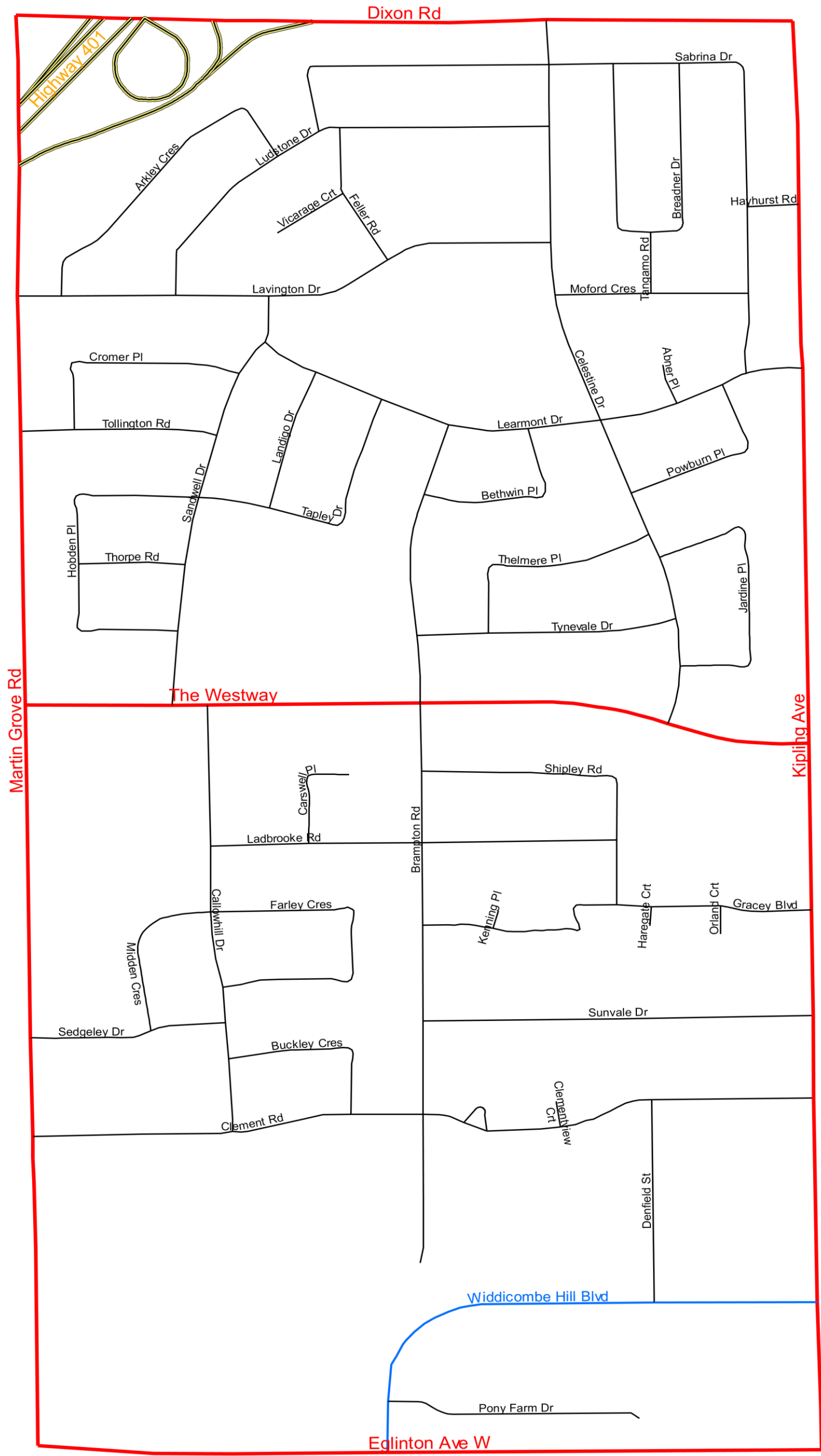

**Legend**

- Expressway
- Pending; Other
- Major Arterial; Minor Arterial
- Local; Laneway

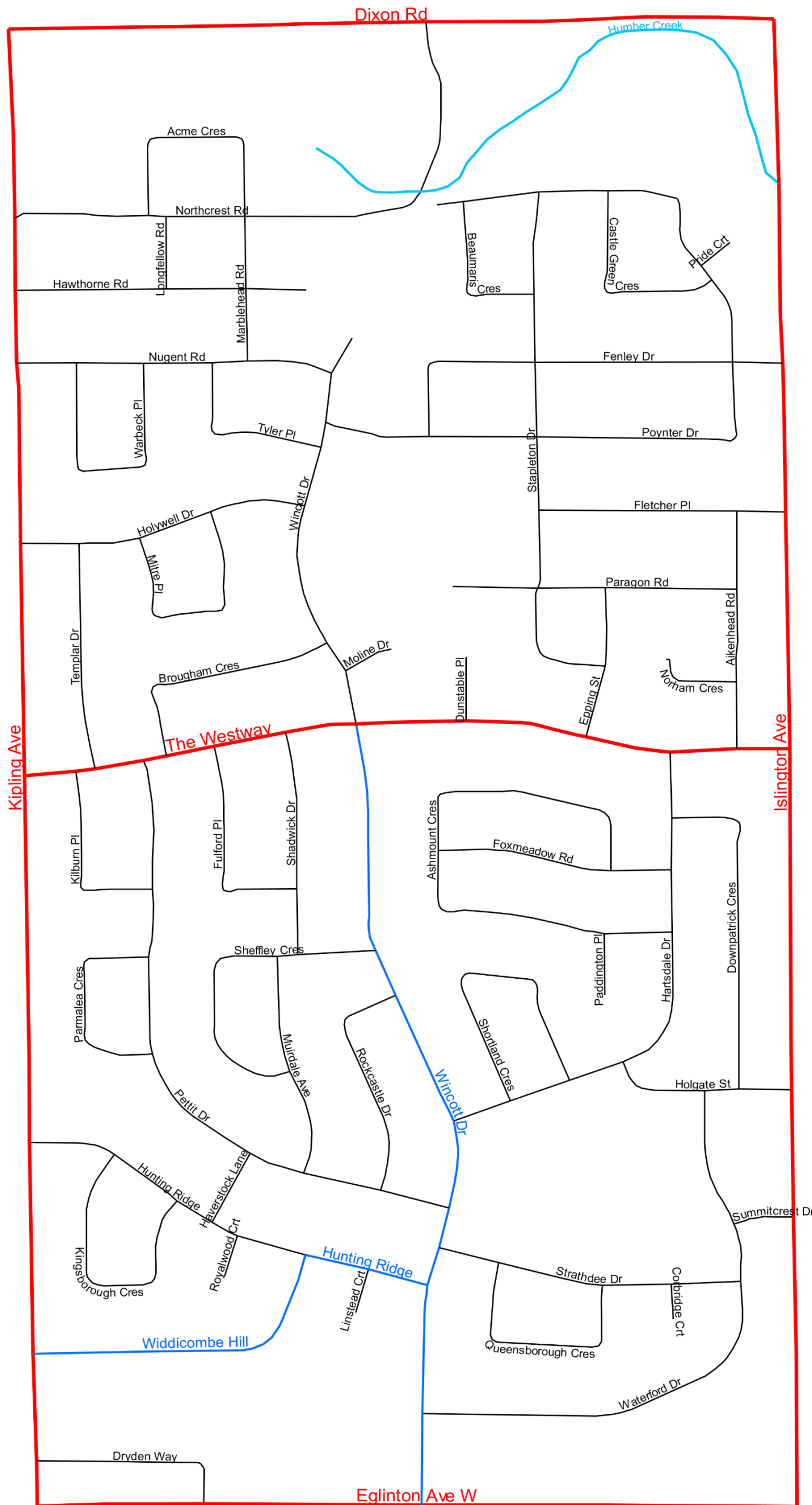

**Legend**

- Major Arterial; Minor Arterial
- Collector
- Pending
- River

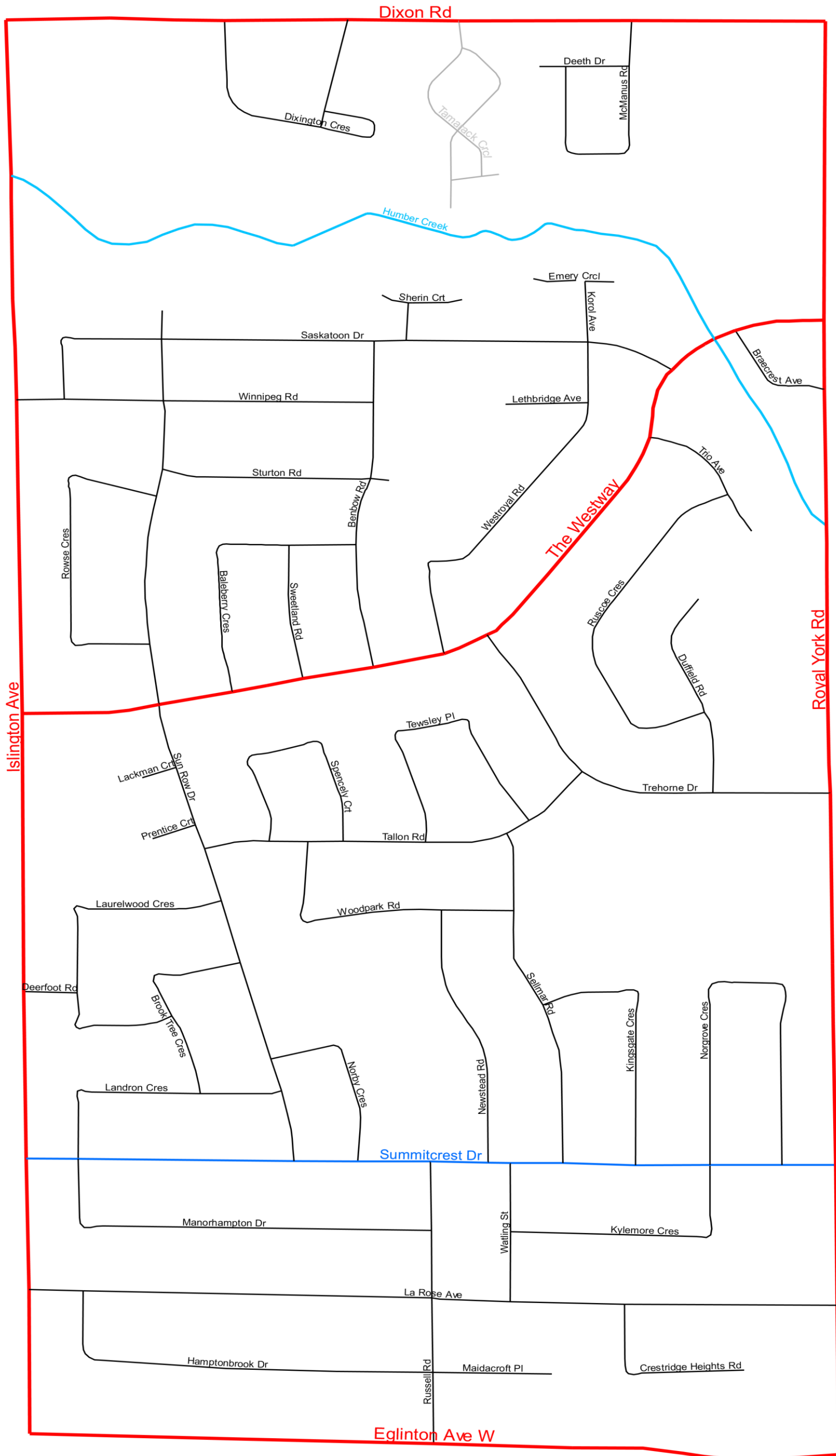

**Legend**

- Major Arterial; Minor Arterial
- Collector
- River
- Pending; Other

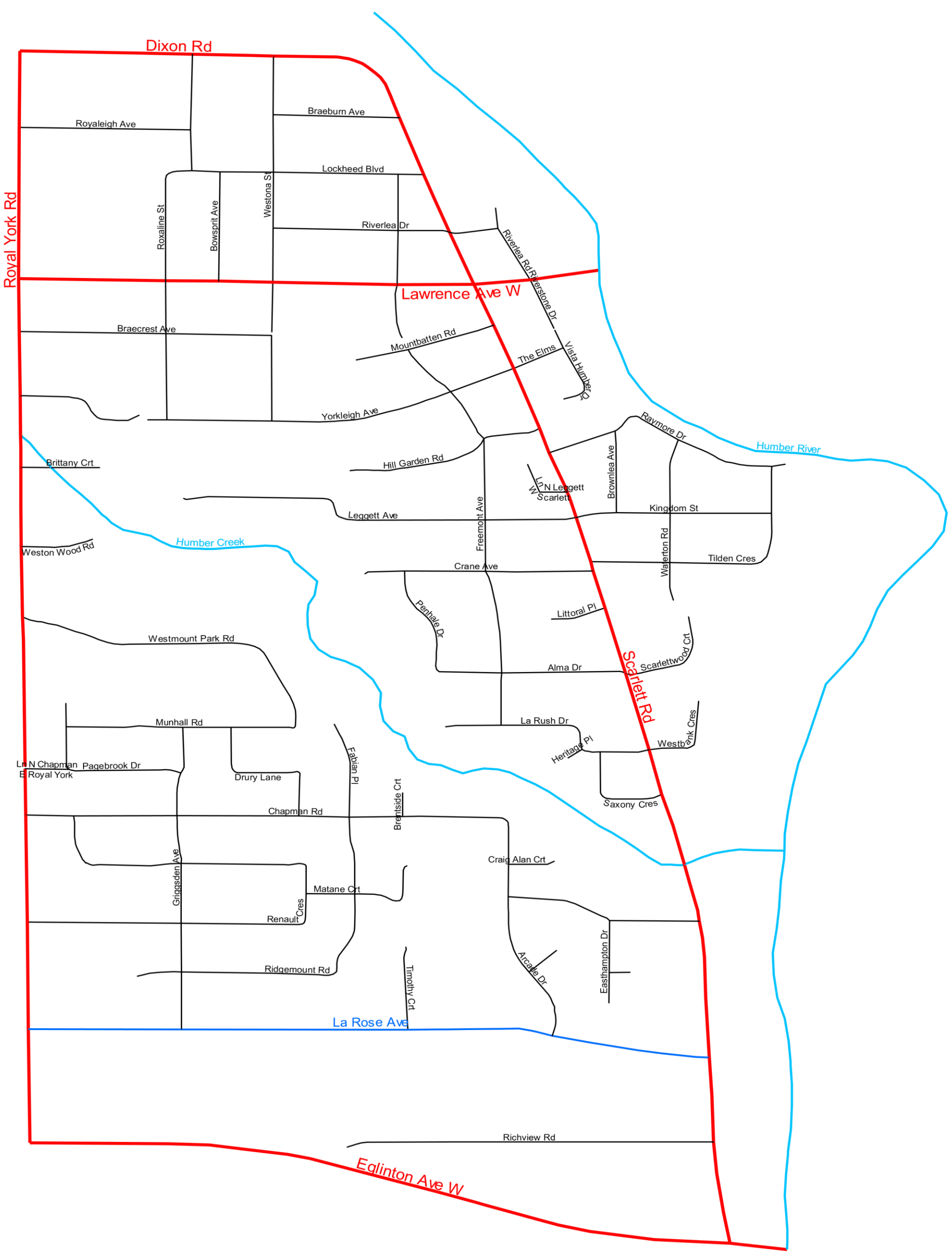

**Legend**

- Major Arterial; Minor Arterial
- Collector
- Local; Laneway
- River

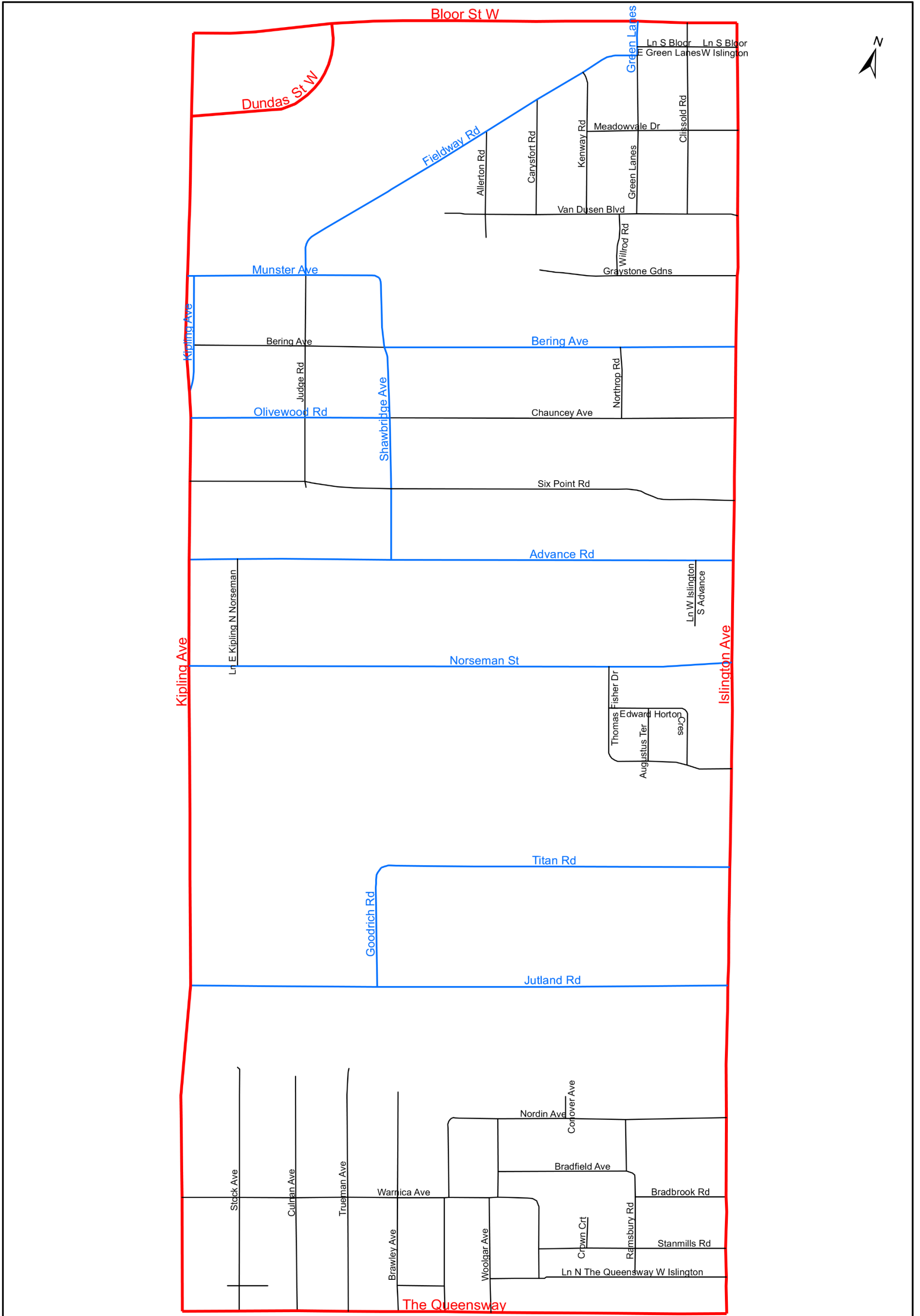

**Legend**

- Pending
- Laneway; Local