

FRONT YARD PARKING APPEAL - 10 GLENAYR ROAD

APPENDIX 'A'

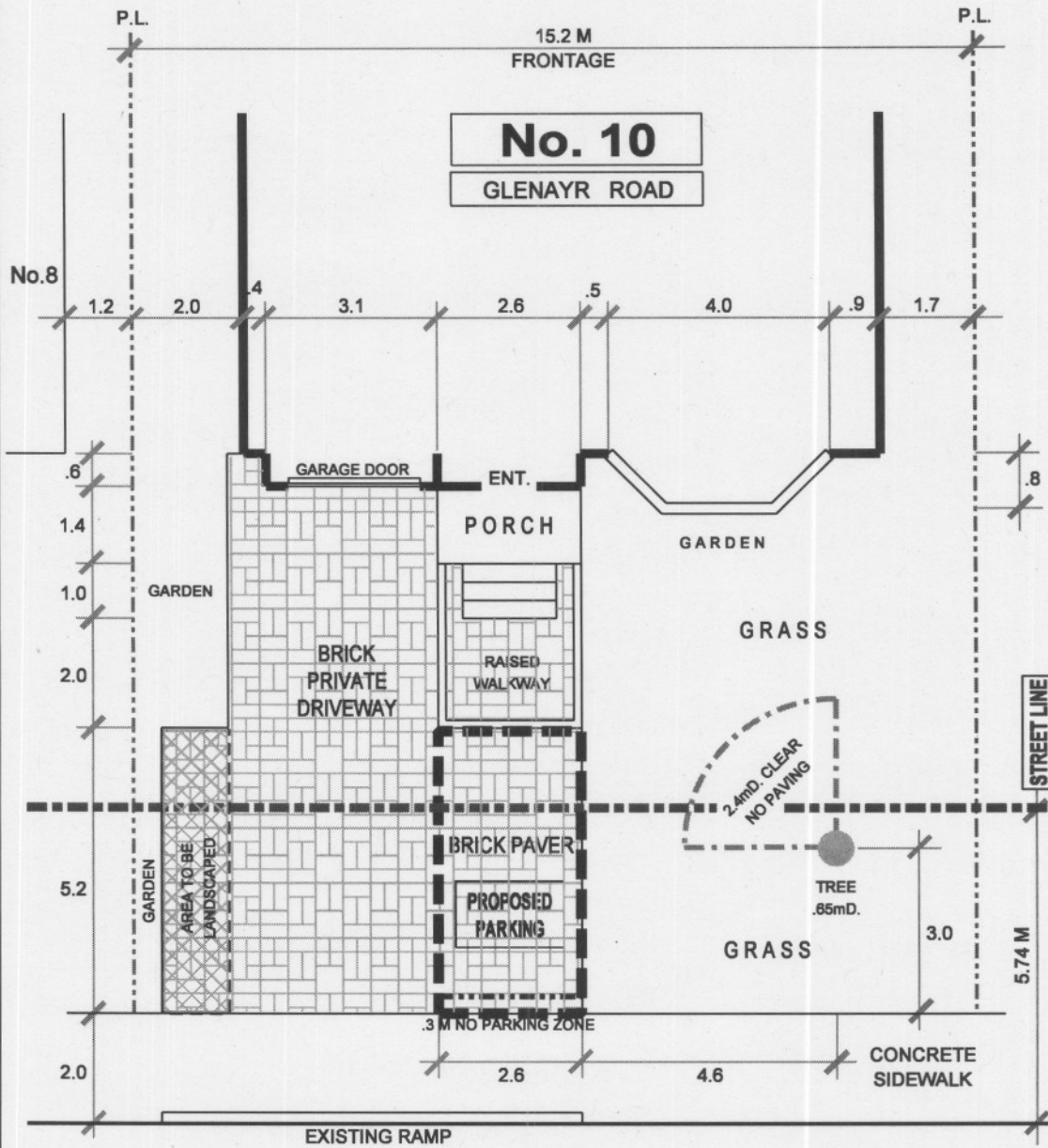

GLENAYR ROAD



TRANSPORTATION SERVICES DIVISION
TORONTO AND EAST YORK DISTRICT
RIGHT OF WAY MANAGEMENT OFF STREET PARKING



FRONT YARD PARKING CHAPTER 918 F.Y.P. - 105120

TOTAL PARKING AREA ON STREET ALLOWANCE	9.7 M ²	PRIVATE PROPERTY			STREET ALLOWANCE		
		AREA M ²	%	CODE	AREA M ²	%	CODE
TOTAL AREA		88.1	—	—	56.6	—	—
LANDSCAPED OPEN SPACE		86.0	75	50% min.	35.1	62	50% min.
PAVED AREA		22.1	25	50% max.	21.5	38	50% max.
SOFT LANDSCAPING		53.5	81	75% min.	32.5	83	75% min.

REVISIONS	
DATE	BY
AUG. 14' 07	R.A.M.
NOV. 24' 10	R.A.M.

DRAWN BY: R. MUNSON

DATE: APRIL 20' 07

SCALE: 1:100