

FRONT YARD PARKING APPEAL - 33 TILSON ROAD

APPENDIX 'D'

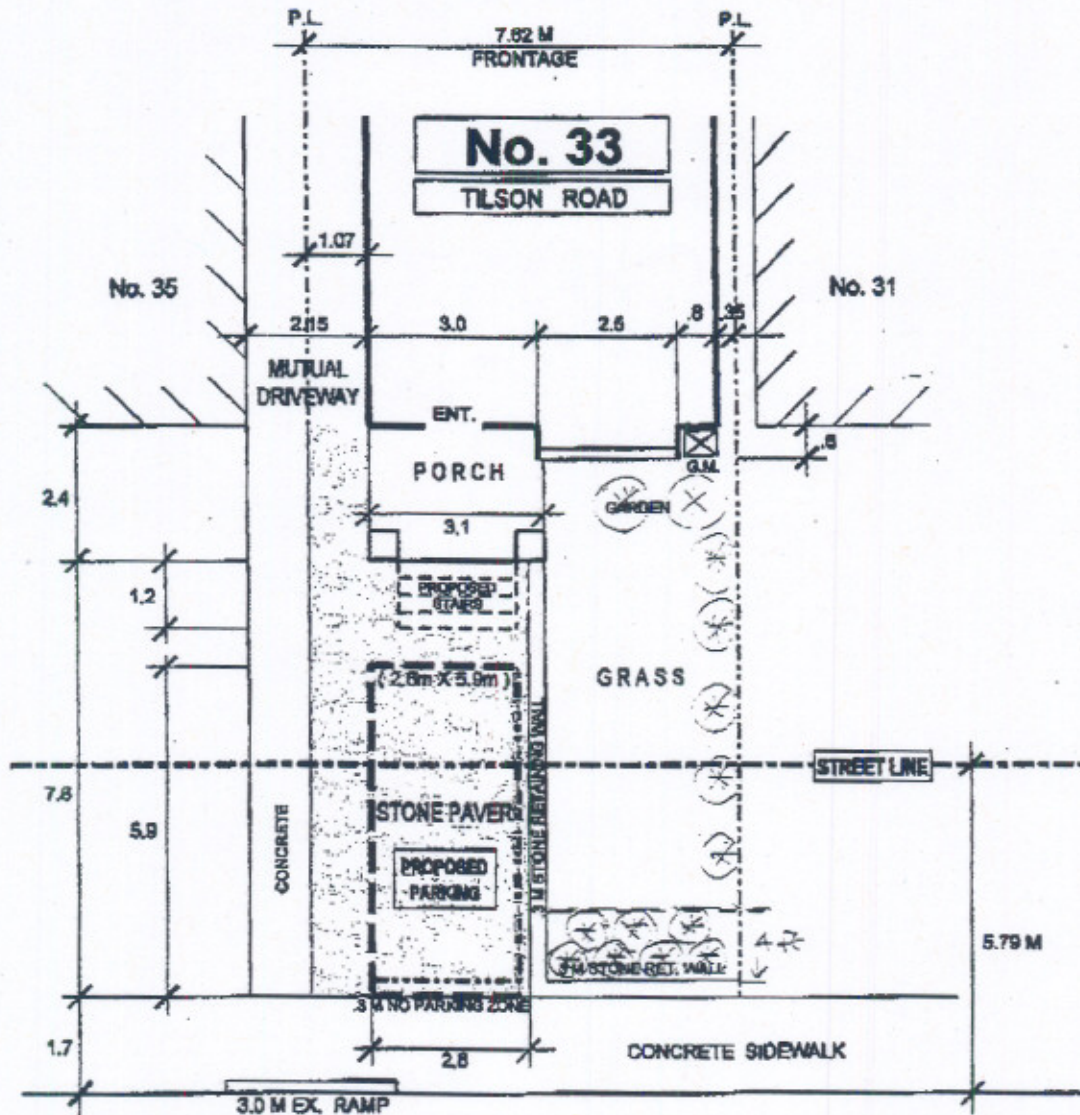

TILSON ROAD

NOTE:
 PERMIT PARKING ON SAME SIDE
 NO LOSS OF PERMIT PARKING SPACE
 DUE TO USE OF EXISTING RAMP



TRANSPORTATION SERVICES DIVISION TORONTO AND EAST YORK DISTRICT RIGHT OF WAY MANAGEMENT - OFF STREET PARKING

NORTH



FRONT YARD PARKING CHAPTER 918 F.Y.P. - 92870

TOTAL PARKING AREA ON STREET ALLOWANCE	10.6 M ²	PRIVATE PROPERTY			STREET ALLOWANCE		
		AREA M ²	%	CODE	AREA M ²	%	CODE
TOTAL AREA		37.4	100		31.1	100	
LANDSCAPED OPEN SPACE		28.2	70	60% min.	19.1	52	80% min.
PAVED AREA		11.2	30	60% max.	15.0	48	80% max.
SOFT LANDSCAPING		19.7	75	75% min.	13.0	81	75% min.

REVISIONS	
Date	By
FEB. 04 10	R.A.M.
FEB. 24 10	R.A.M.
JUNE 24 10	R.A.M.

DRAWN BY: R. MUNSON

DATE: JAN. 30 10

SCALE: 1:100