

NY17.36.3



Parks, Forestry and Recreation

CITY CLERK'S OFFICE  
SECRETARIAT SECTION

Leaside Curling Club  
1073A Millwood Road  
Toronto, ON  
M4G 1X6

Tel: 416-338-4793  
Fax: 416-338-4808  
E-Mail: tplumme@toronto.ca

2012 JUN 29 A 7:48

June 22, 2012

Francine Adamo  
Community/Council Administrator  
City Clerk's Office  
5100 Yonge Street  
Toronto, ONT. M5H 2N2  
416 395-0480  
416 395-7337 (f)

Dear Francine:

RE: 50<sup>th</sup> Anniversary Celebration  
Leaside Curling Club  
1073A Millwood Road  
Toronto, ONT M4G 1X6

Please be advised that the Leaside Curling club will be hosting a 50<sup>th</sup> Anniversary Celebration on Saturday, October 20, 2012.

The event will be taking place at 1073A Millwood Road with a licensed outside area. The event will start at 12:00 pm until 1:00 am.

In order to get a temporary extension of our liquor license, we must provide a letter from the Municipal Clerk stating that there is "no objection" to the proposed extended licensed area.

We are attaching a sketch of the proposed area for your reference.

Our deadline for submitting the application is July 31<sup>st</sup>, 2012 and we would greatly appreciate receiving same at your earliest convenience.

Thank you for your assistance herein.

Respectfully,

Trudi Plummer  
Club Manager/Community Recreation Programmer  
Encls

LOUNGE (UPPER LEVEL) LAYOUT - EXISTING LICENCED AREA (measurements in metres)

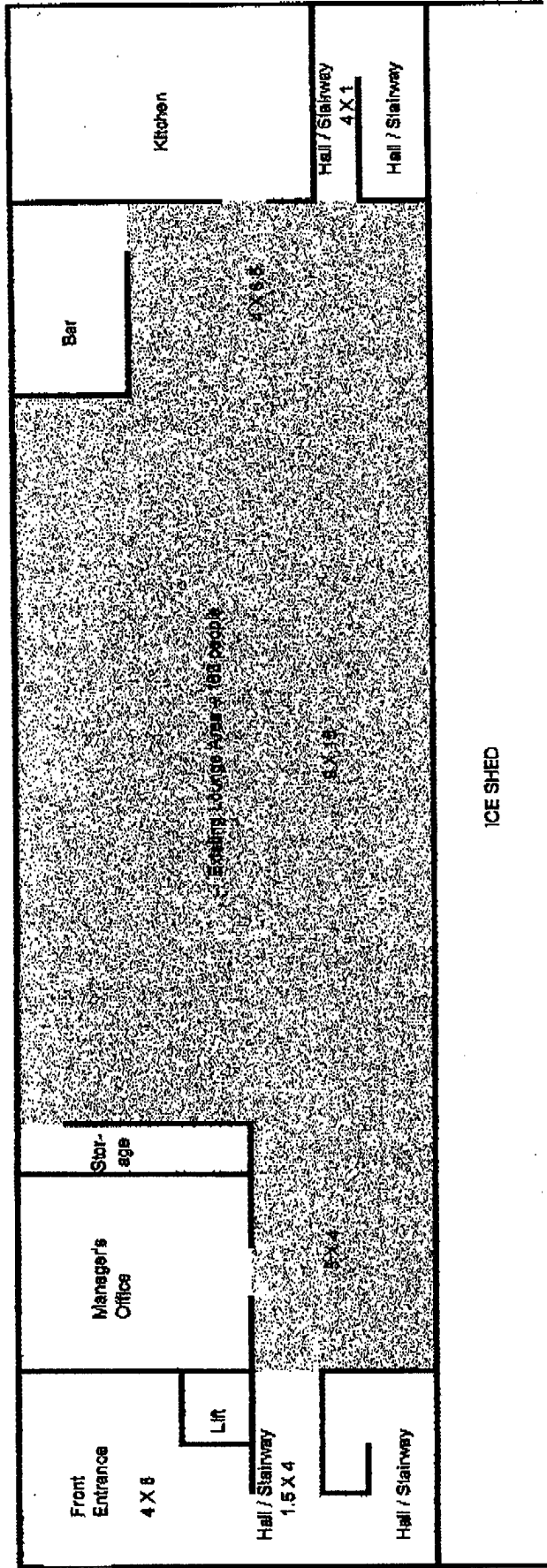

ICE SHED

LOUNGE (UPPER LEVEL) LAYOUT - PROPOSED ADDITIONAL LICENCED AREA (measurements in metres)

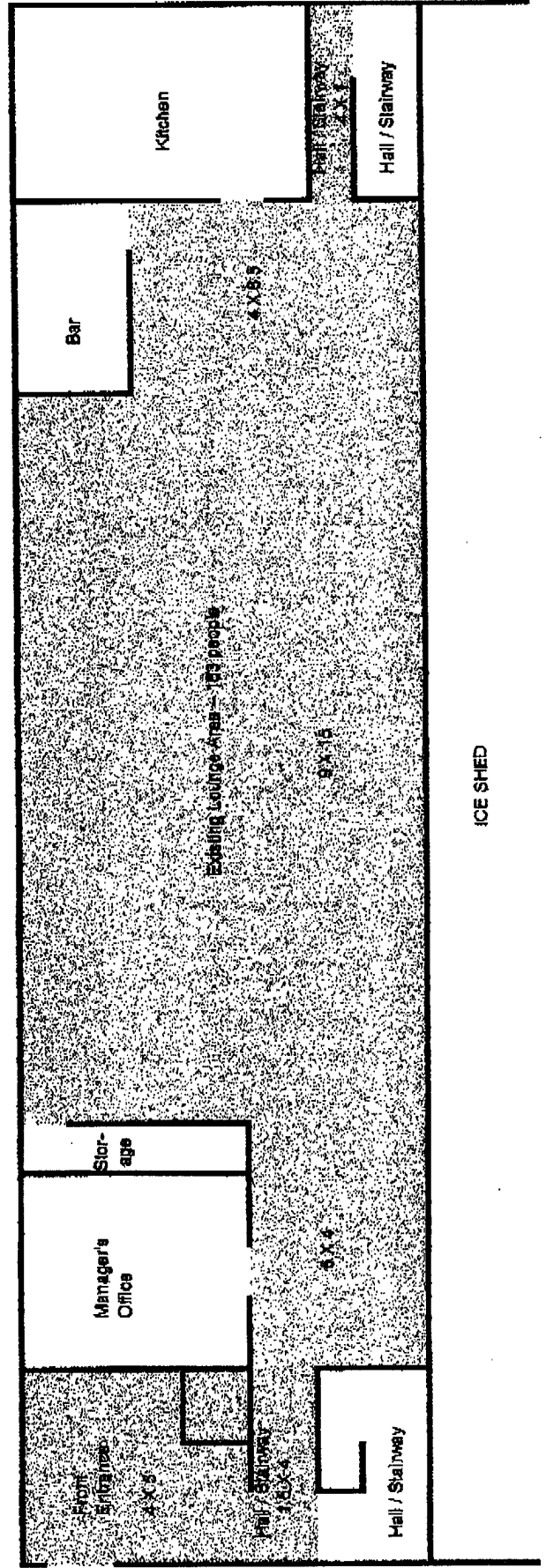

ICE SHED

LOCKER ROOM / WASHROOM (LOWER LEVEL) - EXISTING LICENCED AREA

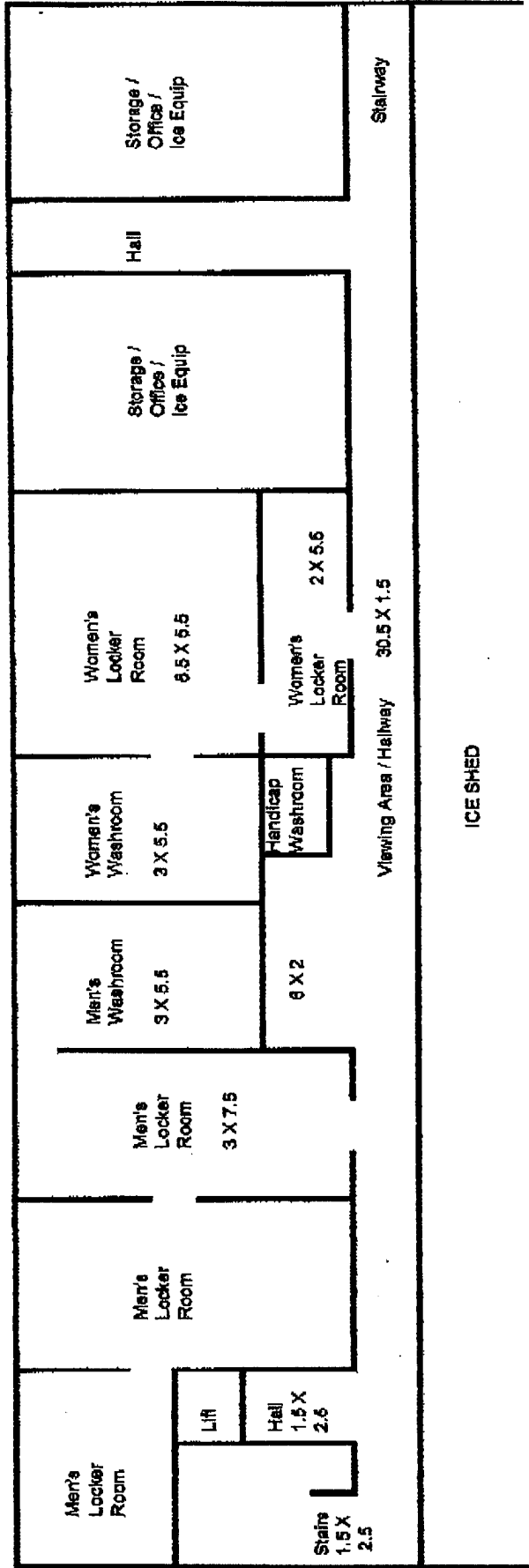

ICE SHED

LOCKER ROOM / WASHROOM (LOWER LEVEL) - PROPOSED ADDITIONAL LICENCED AREA

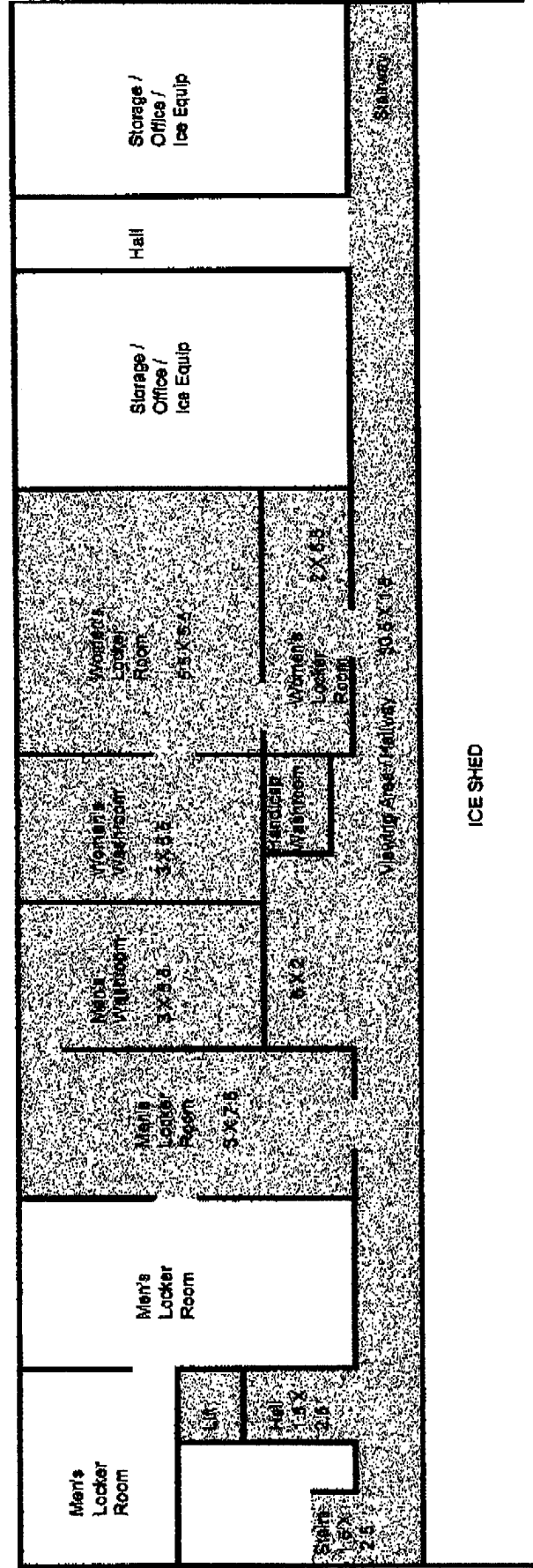

ICE SHED

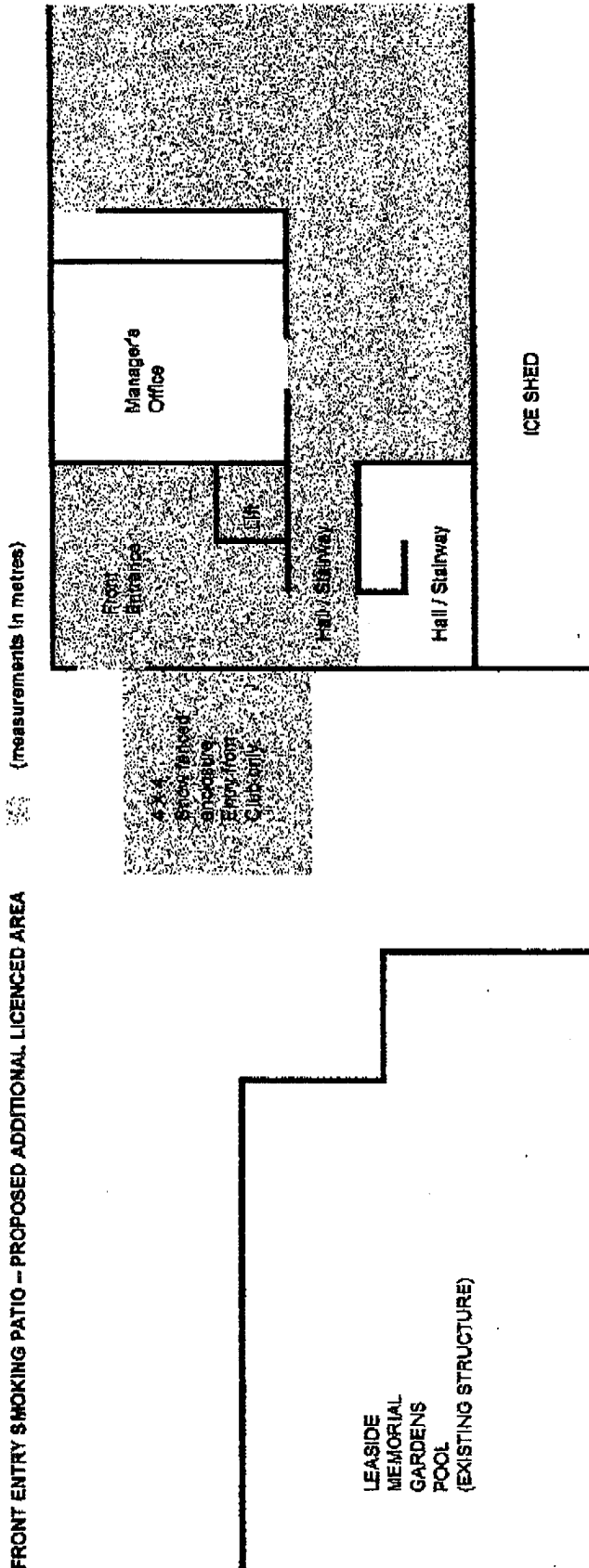

**NOTES:**

Extension of licence to accommodate expected 300+ members attending the 50<sup>th</sup> Anniversary Celebration. Extension includes stairways, hallways and washroom areas to ensure safety of patrons (control of drinks).

Drinks will only be served from the existing bar.

Smoking area at the front of the Club will only be accessible from inside the Club.

Existing licenced area is 181 sq metres and licenced for 183 people.

Extension covers 208 sq metres (interior and exterior) for an additional 187 people.